

Pack 7

LaFerrari

1:8 SCALE

THE ULTIMATE HYPERCAR
ULTIMATE PERFORMANCE
ULTIMATE STYLE

AGORA
MODELS®



STAGE 49 THE REAR LEFT SIDE PANELS

THE VENTILATION SYSTEM LOCATED NEAR THE REAR LEFT WHEEL REMAINS HIDDEN FROM VIEW, PROTECTED BY ELEGANT TAPERED SIDE PANELS TINTED IN THE UNMISTAKABLE RED

PARTS LIST

NO.	PART	QUANTITY	MATERIAL
1	Lower rear left side panel	1	Metal
2	Upper rear left side panel	1	ABS
3	Screw type H	4	Metal
4	Screw type E	2	Metal

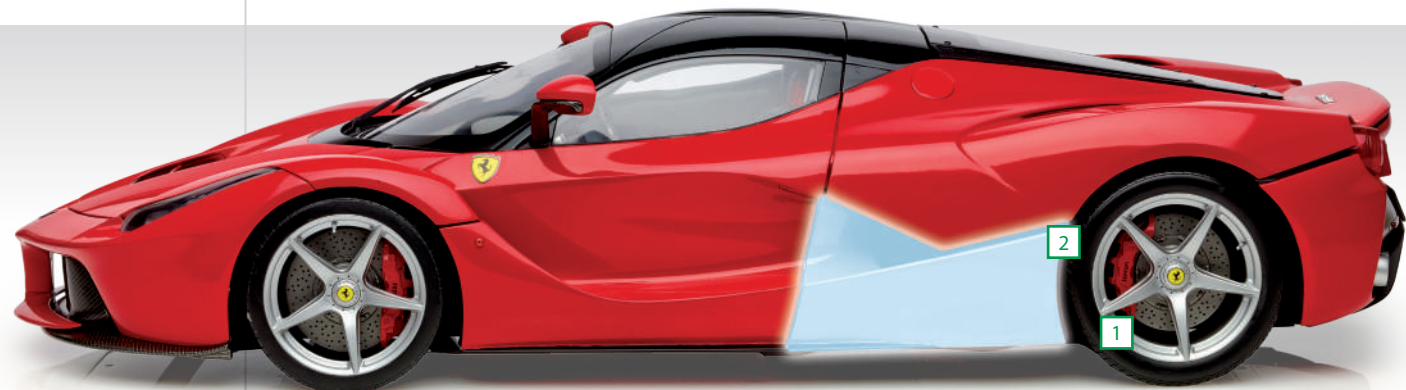
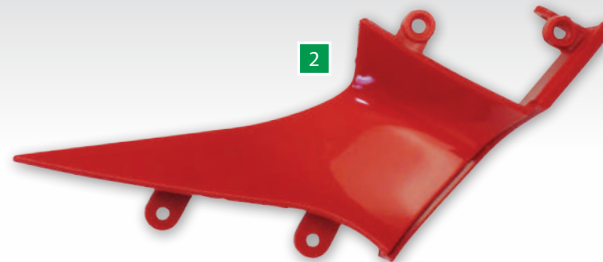

STEP 1

Fit the two assemblies from stages 46 and 47 together, pressing the indicated pins into the holes as shown.

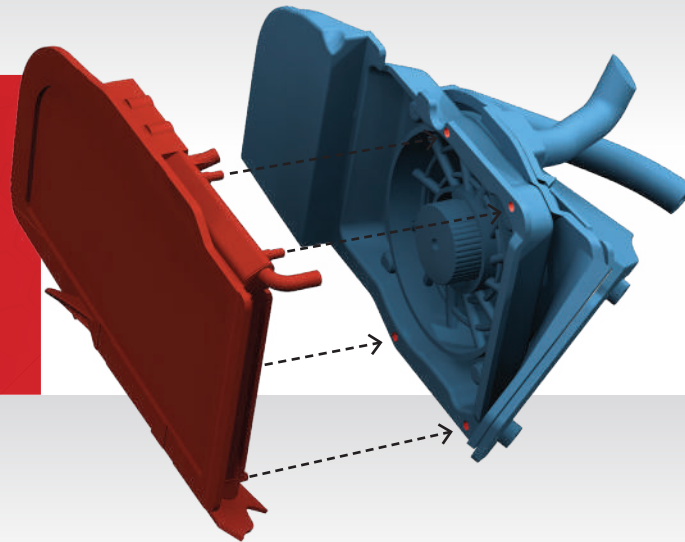

STEP 2

Fix the cover plate (from stage 48) onto the lower rear left side panel (1) using two type H screws (3).

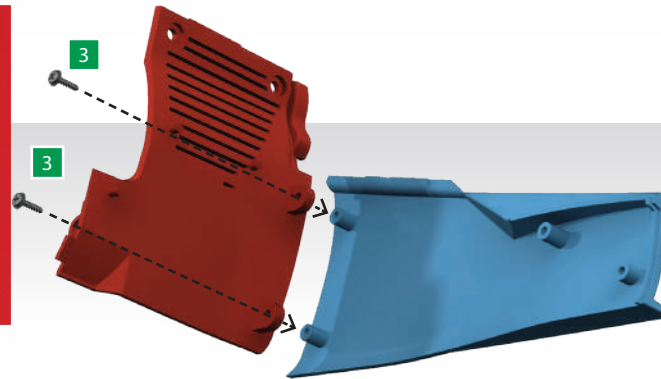

1 Lower rear left side panel



STEP 3

Fit the assemblies from steps 1 and 2 together, then position the upper rear left side panel (2) as shown. Secure using two type H screws (3) and two E type screws (4).

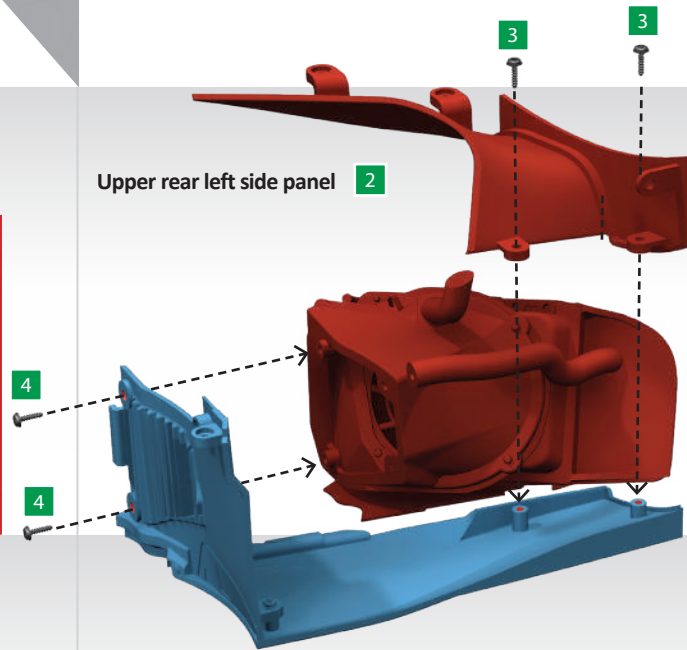

STAGE COMPLETE

The rear left side panel assembly is complete. Store it away safely until it is needed in a later stage.



STAGE 50 THE REAR RIGHT SIDE PANELS

THE VENTILATION SYSTEM LOCATED NEAR THE RIGHT REAR WHEEL IS ALSO COVERED AND PROTECTED BY TWO RED SIDE PANELS, WHICH BLEND SEAMLESSLY WITH THE STREAMLINED BODY DESIGN

PARTS LIST

NO.	PART	QUANTITY	MATERIAL
1	Lower rear right side panel	1	Metal
2	Upper rear right side panel	1	ABS
3	Screw type H	3	Metal
4	Screw type M	1	Metal
5	Screw type E	2	Metal



1

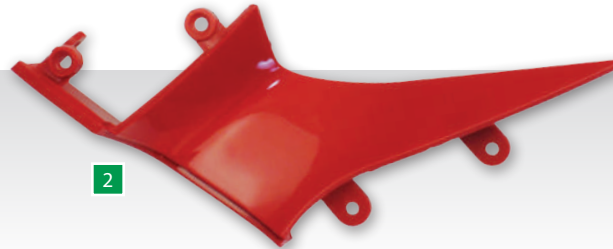

2



3



4



5

STEP 1

Fix the cover plate (from stage 46) to the lower rear right panel (1) using two type H screws (3).

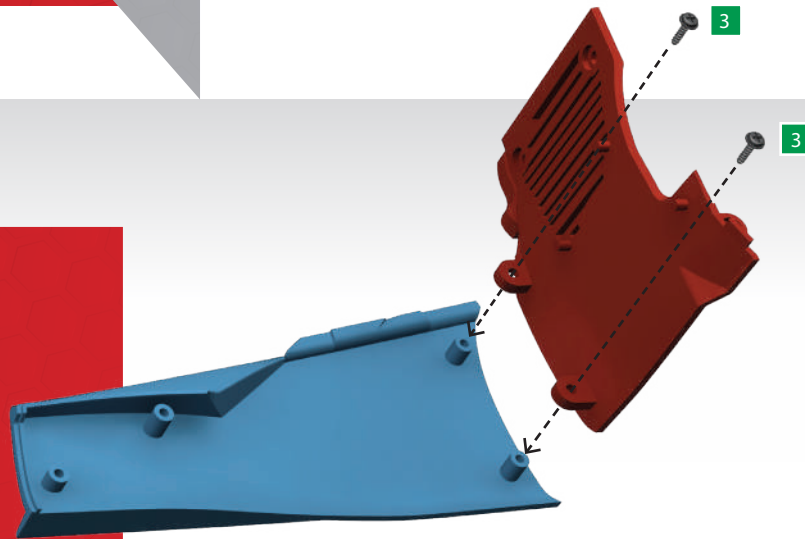

1 Lower rear right side panel



STEP 2

Fit the assembly from step 1 with the assembly from stage 48 as shown, then secure using two type E screws (5).

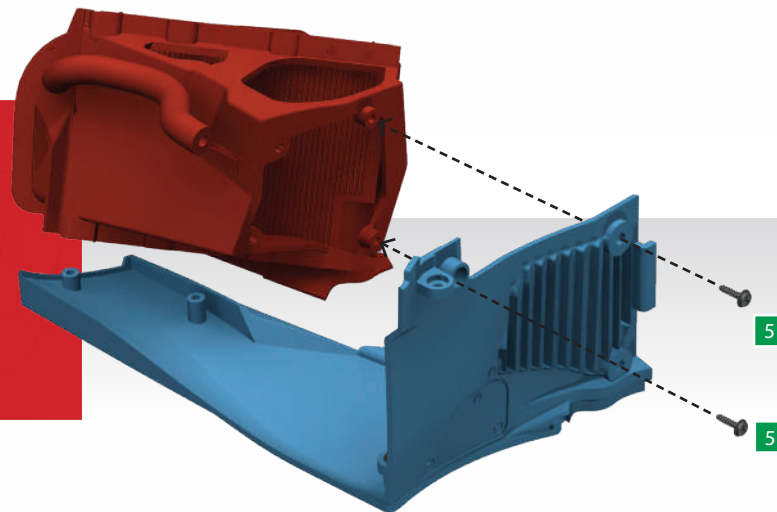

STEP 3

Fix the upper rear right side panel (2) in place using one type H (3) and one type M screw (4).

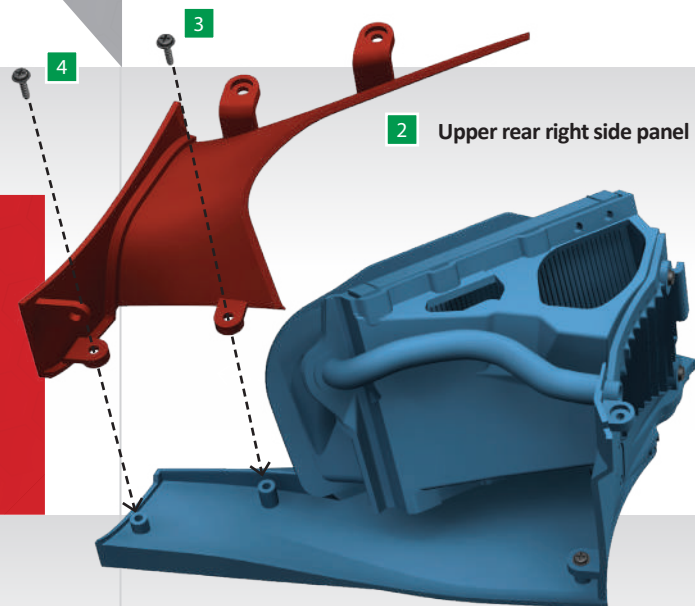

STAGE COMPLETE

The rear right side panel assembly has been built. Store it safely away, along with the left side panel assembly, until it is time to install them onto your model.



STAGE 51 THE MAIN CHASSIS

A HIGHLY STURDY FRAME, DESIGNED TO FACILITATE THE ATTACHMENT OF MECHANICAL AND ELECTRICAL COMPONENTS, FORMS THE BACKBONE OF THE PRANCING HORSE'S TWO-SEATER

PARTS LIST

NO.	PART	QUANTITY	MATERIAL
1	Front plate	1	ABS
2	Main chassis	1	Metal
3	Front left side panel	1	ABS
4	Front right side panel	1	ABS
5	Screw type E	2	Metal
6	Screw type G	6	Metal



STEP 1

Retrieve the fan assembly from stage 20 and position it on the main chassis (2) as shown. Secure using two E type screws (5).

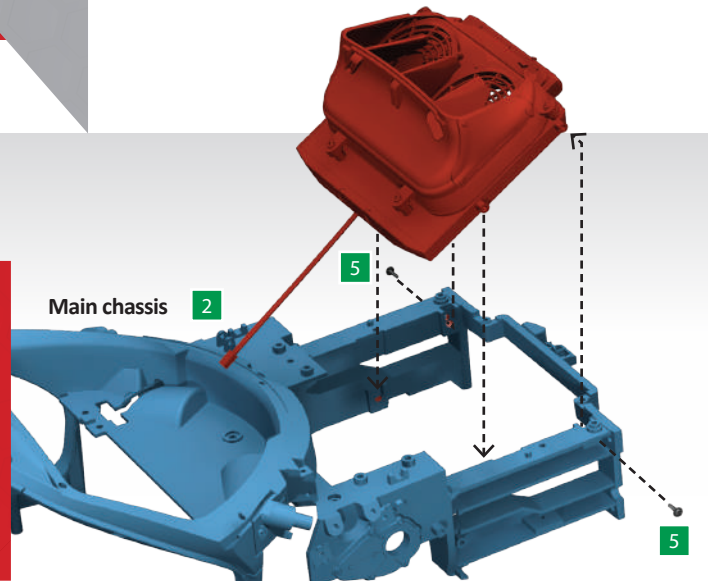

STEP 2

Fix the cooling system base (from stage 20) under the fan assembly and onto the chassis using two G type screws (6). Secure the front plate (1) using four G type screws (6).

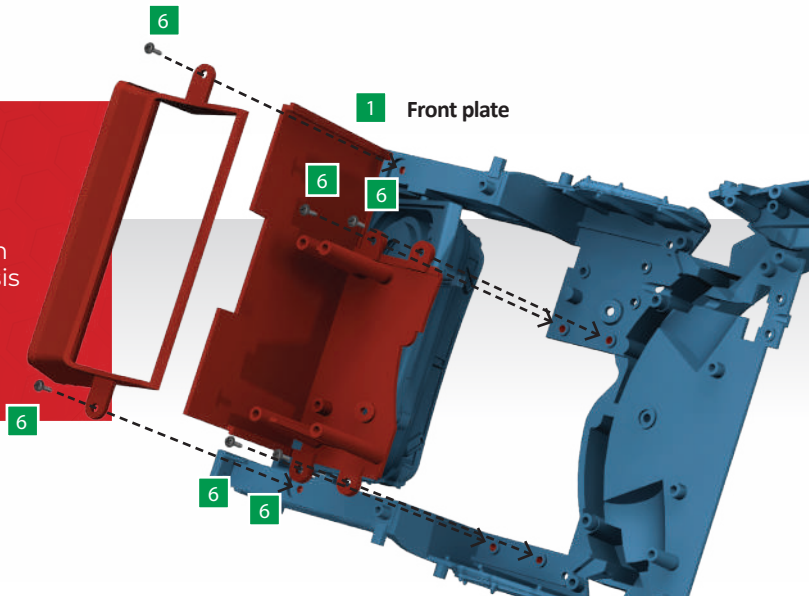

STAGE COMPLETE

The model is now starting to take shape with the start of assembly on the main chassis. You will continue work on it in the next stage.



STAGE 52 THE STEERING SYSTEM

POWERFUL AND RELIABLE, THE MARANELLO-BUILT SPORTS CAR FEATURES AN EPS-TYPE POWER STEERING SYSTEM, CAPABLE OF ENHANCING FUEL EFFICIENCY AS WELL AS VEHICLE CONTROL

PARTS LIST

NO.	PART	QUANTITY	MATERIAL
1	Steering rod	1	Varied
2	Steering shaft	1	Metal+ABS
3	Rack shaft	1	Metal+ABS
4	Rack shaft guard	1	ABS
5	Rack shaft guard (detail A)	1	ABS
6	Detail A	1	ABS
7	Upper rear subframe	1	Metal
8	Detail B	1	ABS
9	Rack shaft guard (detail B)	1	ABS
10	Screw type FF	1	Metal
11	Screw type G	1	Metal
12	Screw type B	1	Metal



STEP 1

Position the rack shaft (3) and rack shaft guard (detail A, 5) in place on the underside of the main chassis as shown. One end of the shaft needs to go through the chassis (arrow). Secure the guard using a type G screw (11).

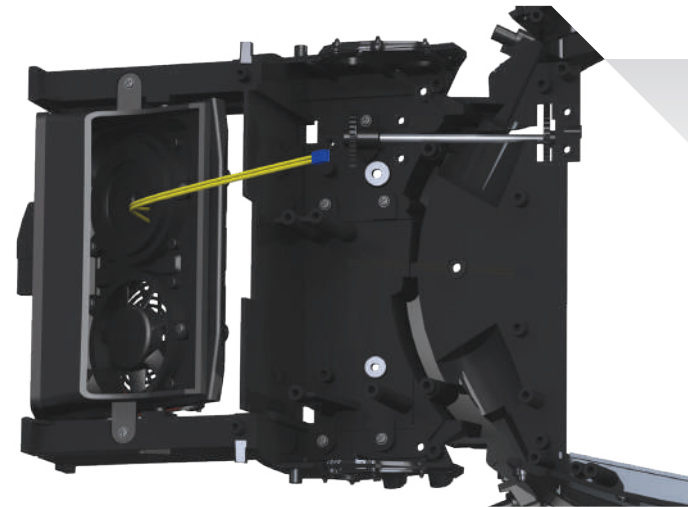
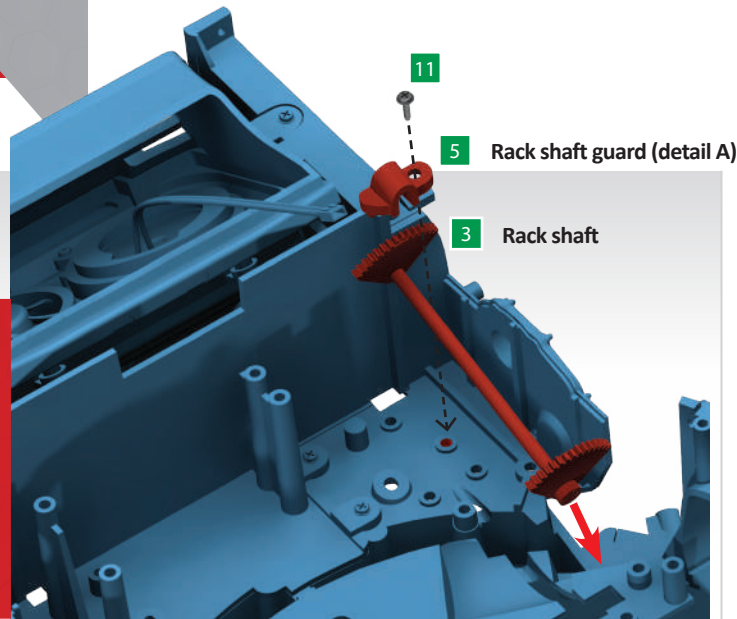

STEP 2

Insert the steering rod (1) transversely through the chassis. Its toothed section (arrow) should engage with the rack shaft (circled).

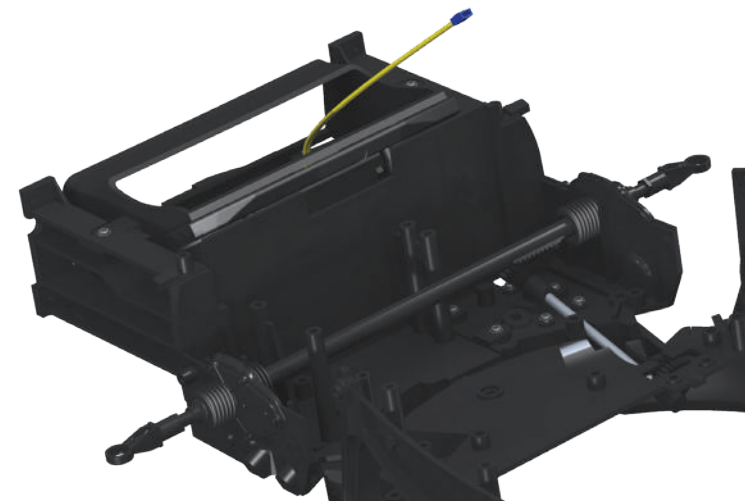
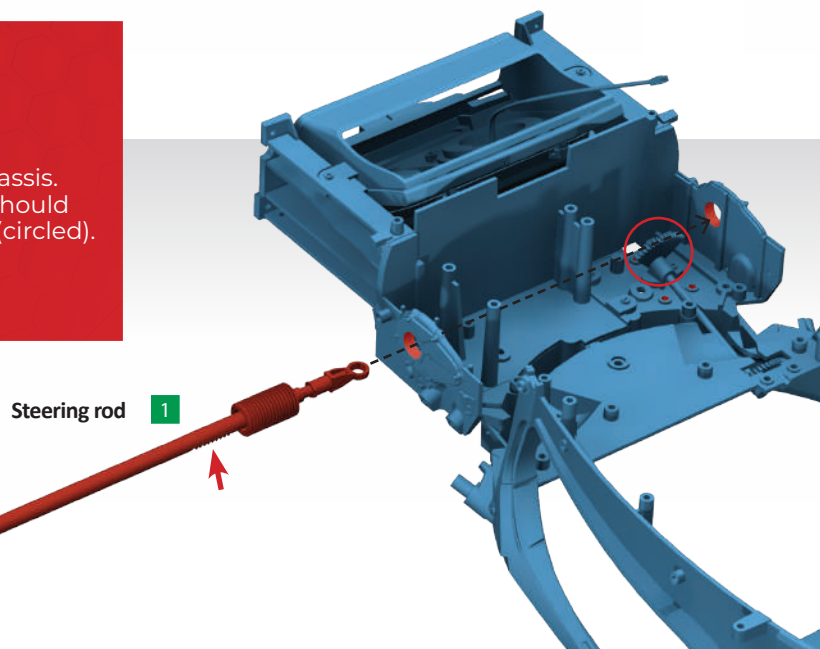

STEP 3

Fit the rack shaft guard (4) over the steering rod and shaft as shown in the image, then secure using three type G screws (11).

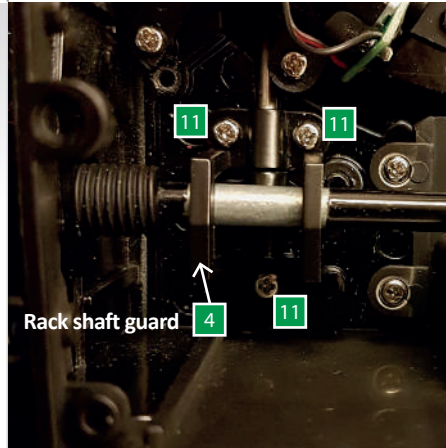

STEP 4

Turn the main chassis over and fit detail A (6) and B (8) in position as shown, then attach the luggage compartment assembly (stage 21) using a type FF screw (10) and a type B screw (12).

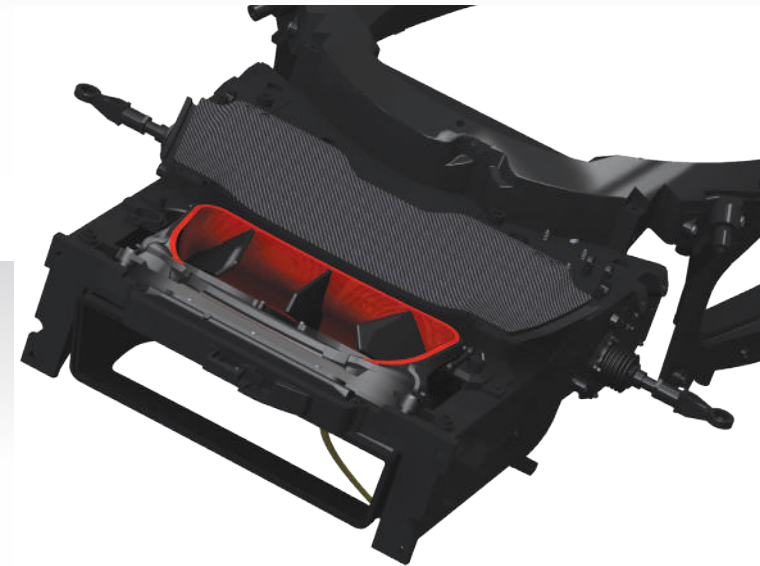
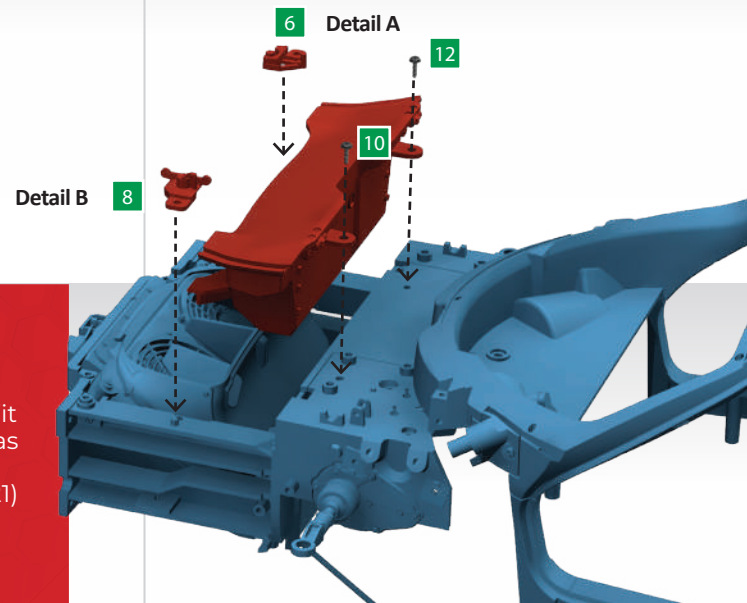

STAGE COMPLETE

Assembly of the steering system has begun, and the luggage compartment has been fitted to the main chassis. The upper rear subframe will be fitted in stage 67, store it safely for now.



STAGE 53 THE FRONT SUSPENSION

THANKS TO THE 4-WHEEL
INDEPENDENT SUSPENSION, THE
FERRARI SUPERCAR OFFERS
EXCELLENT ROAD GRIP, EFFECTIVE
TRACTION, AND UTMOST
PRECISION IN STEERING

PARTS LIST

NO.	PART	QUANTITY	MATERIAL
1	Lower control arm	2	Metal
2	Upper control arm	2	Metal
3	Front shock absorber	2	Varied
4	Spherical joint	4	ABS
5	Front spring	2	Metal
6	Shock absorber bushing	2	ABS
7	Flange	4	ABS
8	Hinge	8	Metal
9	Screw type BB	2	Metal
10	Screw type N	2	Metal
11	Screw type M	4	Metal

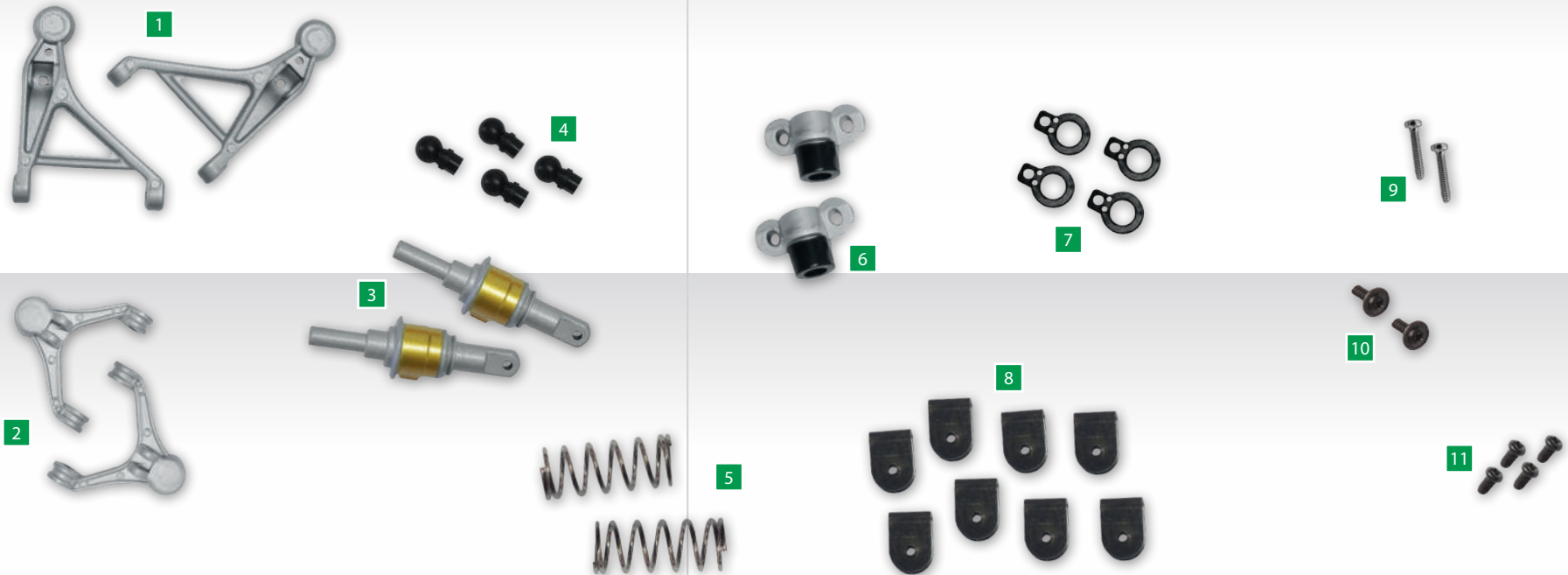

STEP 1

Attach each front shock absorber (3) to the respective lower control arm (1) using a type BB screw (9).

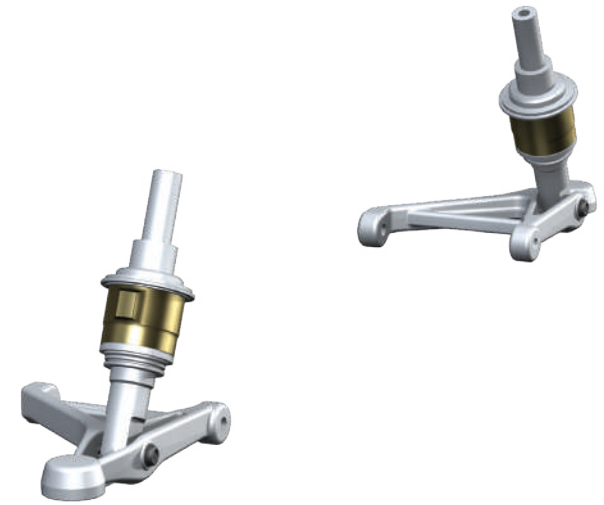
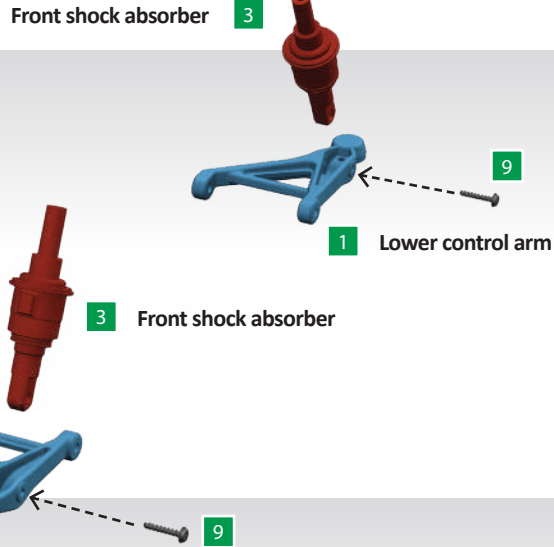

STEP 2

Install a front spring (5) and a shock absorber bushing (6, labelled 'L' and 'R') onto the corresponding piece. Secure using a type N screw (10). Fit two spherical joints (4) in flanges (7) and secure one to each control arm using a type M screw (11).

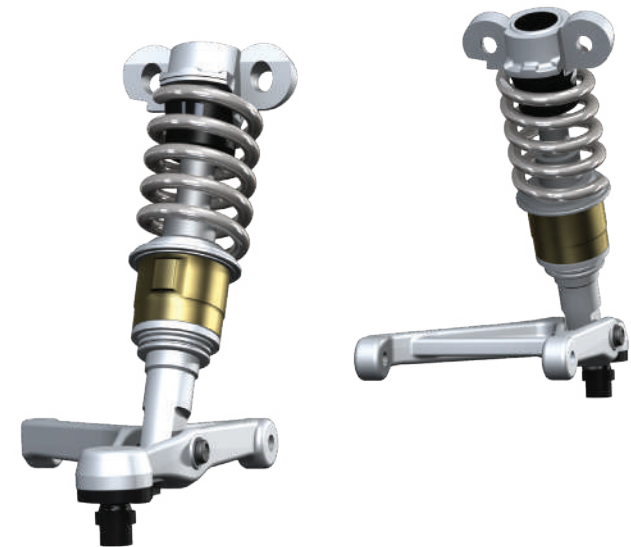
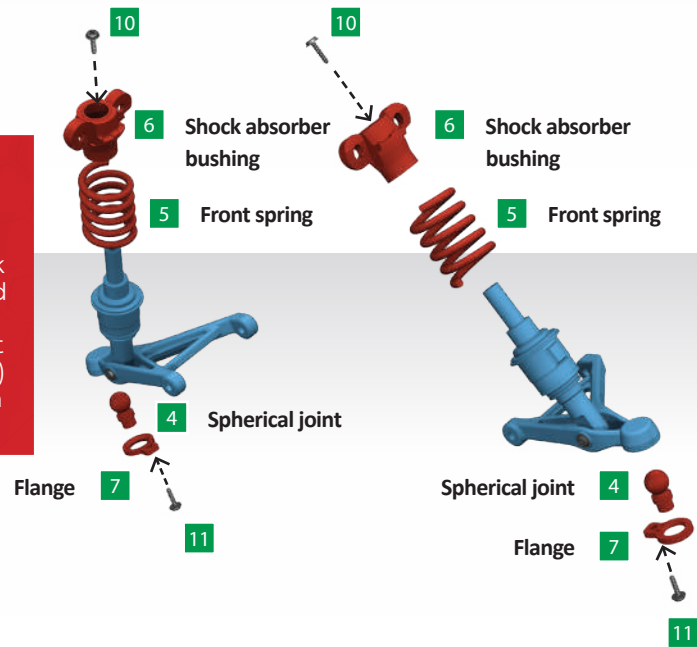

STEP 3

Fit a spherical joint (4) into the housing of each upper control arm (2) then position a flange (7) to hold in place and secure using a type M screw (11).

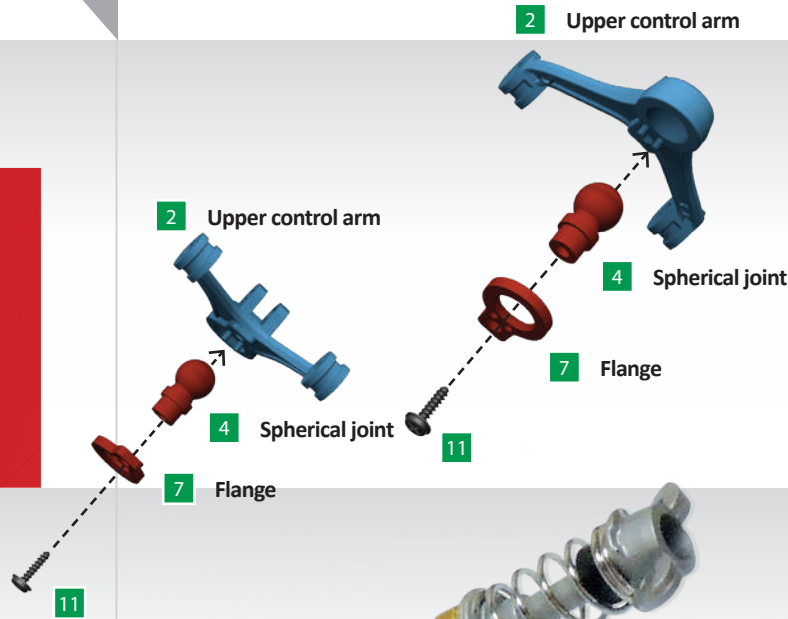

STAGE COMPLETE

The initial components of the front suspension have been built. Store the control arms until they are needed later.



STAGE 54 THE FRONT LEFT BRAKE

LIKE ALL CARS IN ITS CATEGORY, THE LAFERRARI IS EQUIPPED WITH HIGH-PERFORMANCE DISC BRAKES ON ALL FOUR WHEELS, WHICH ARE VENTILATED AND PERFORATED TO PREVENT OVERHEATING

PARTS LIST

NO.	PART	QUANTITY	MATERIAL
1	Front left brake disc	1	Varied
2	Anti-roll bar	1	ABS
3	Screw type L	2	Metal
4	Screw type K	4	Metal

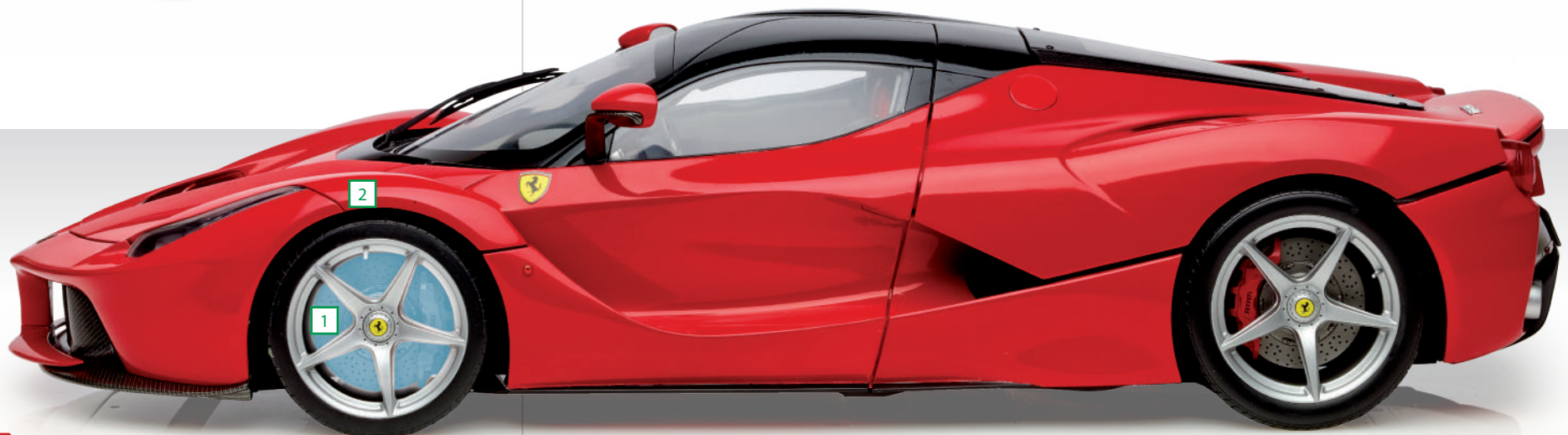
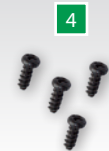

STEP 1

Fix two hinges (stage 53) onto the front left and right side panels (stage 51) using type K screws (4) as shown. Note the raised holes are facing each other (arrows).

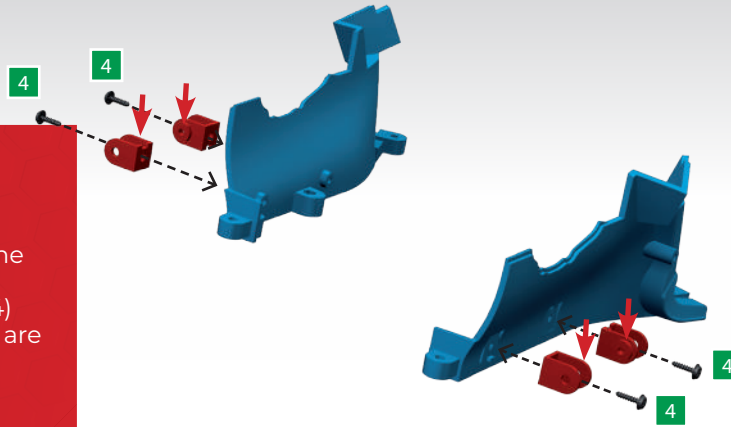

STEP 2

Secure the upper control arm (stage 53) to the front left brake disc (1) using a type L screw (3).

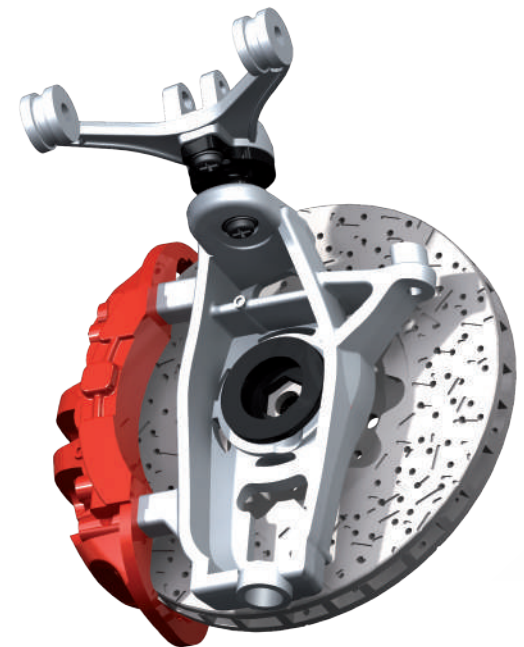
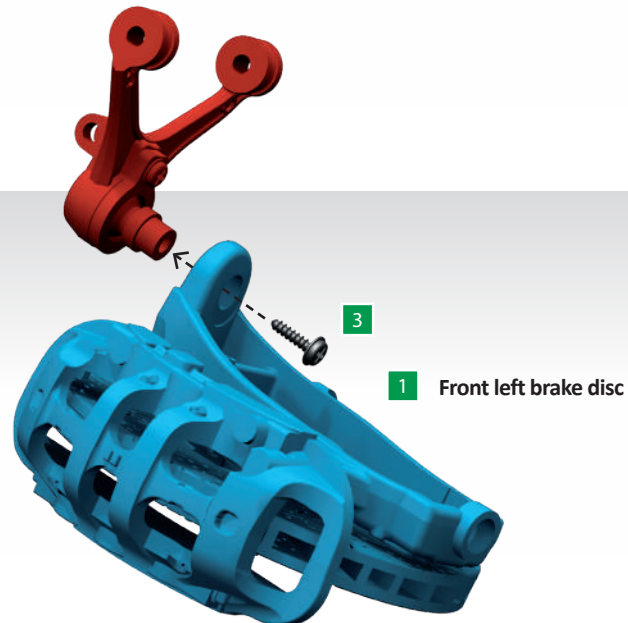

STEP 3

Attach the lower control arm (stage 53) to the front left brake disc (1) using a type L screw (3).

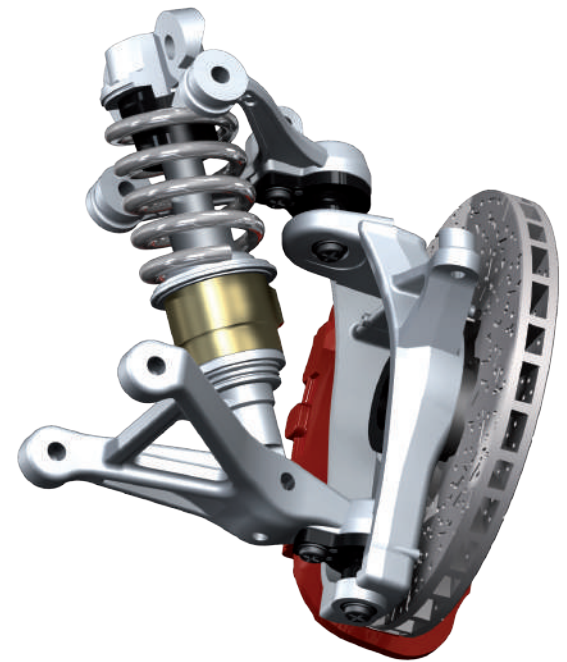
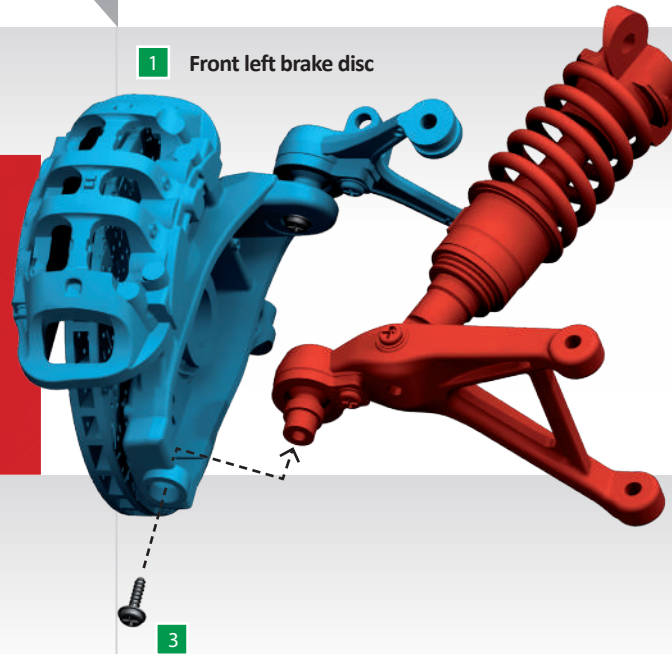

STAGE COMPLETE

The two lower front side panels and the front left brake disc have been prepared for installation. Store them away safely until they are needed later.

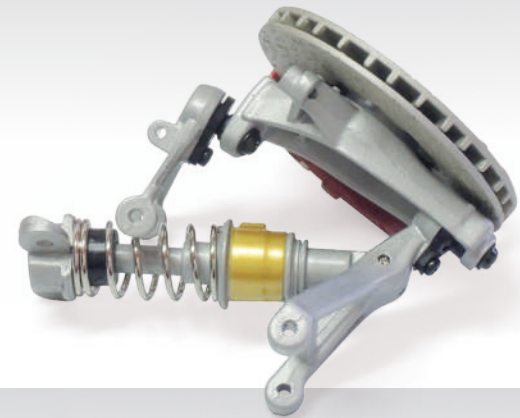

STAGE 55 THE FRONT RIGHT BRAKE

BEAUTIFUL AND EFFECTIVE, THE 1:8 SCALE LAFERRARI'S DISC BRAKES ARE EQUIPPED WITH A STRIKING RED CALIPER. THE DISC'S DESIGN ENHANCES COOLING IN THE REAL CAR

PARTS LIST

NO.	PART	QUANTITY	MATERIAL
1	Front right brake disc	1	Varied
2	Screw type M	4	Metal
3	Screw type CC	2	Metal
4	Screw type L	2	Metal
5	Screw type O	4	Metal
6	Screw type C	2	Metal
7	Screw type H	2	Metal

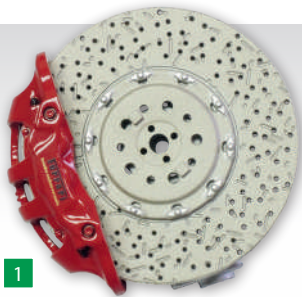

STEP 1

Fix four hinges (stage 53) to the main chassis using four type M screws (2) so that the raised holes are facing each other (arrows). Construct the front right brake disc (1) by following steps 2 and 3 from stage 54. Fix the shock absorber bushings of the discs to the chassis using four type CC screws (3).

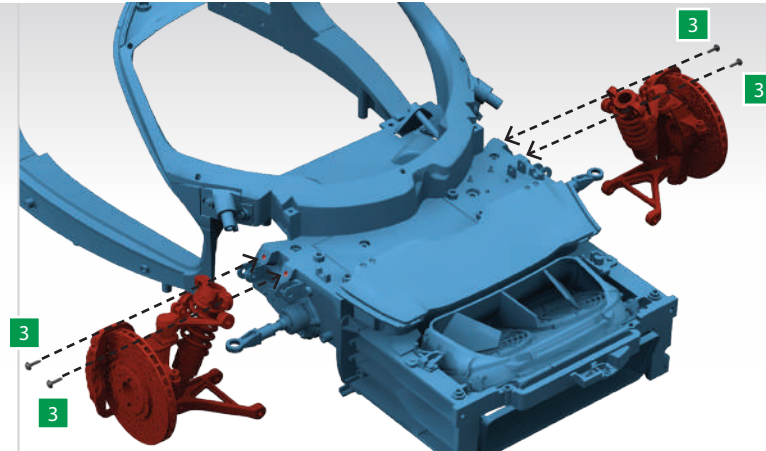
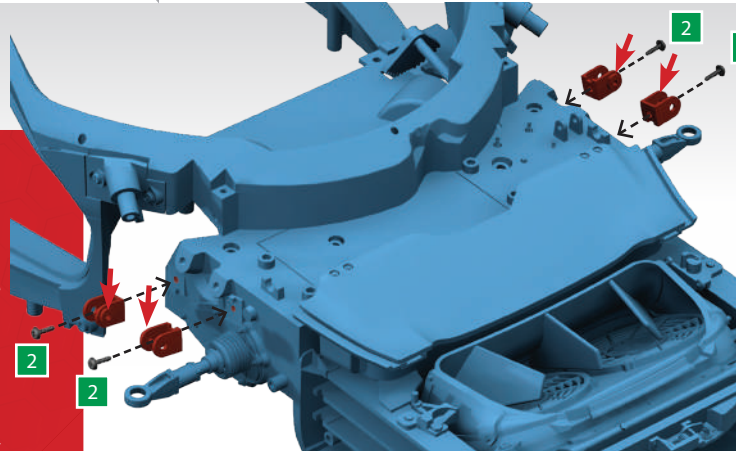

1 Front right brake disc

STEP 2

Use four type O screws (5) to fix the upper control arms. Then use two type C screws (6) to connect the ends of the steering rod to the brake discs.

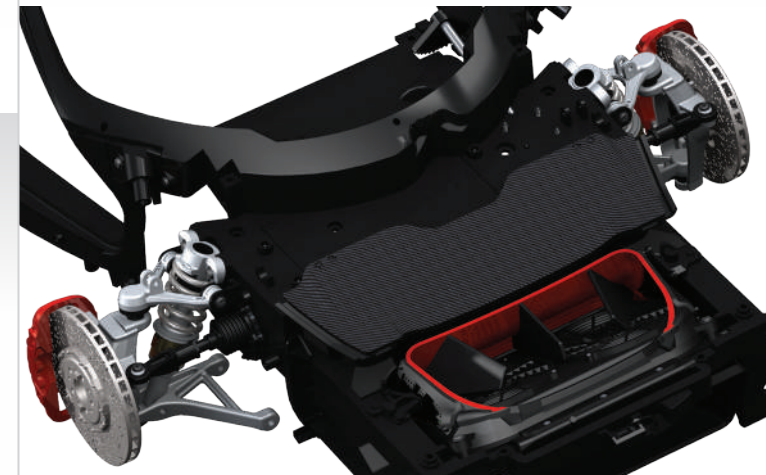
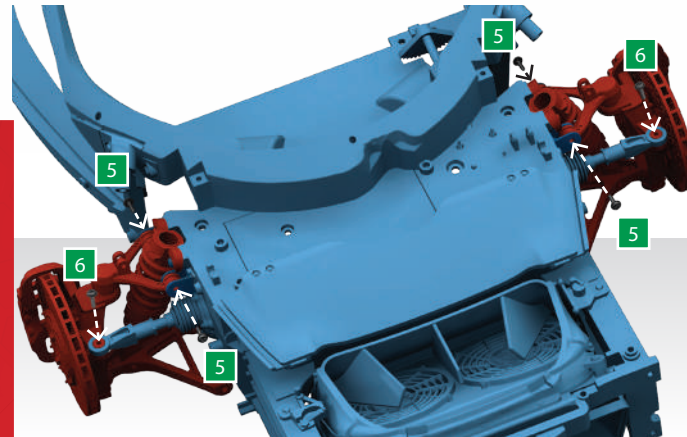

STEP 3

Fit the anti-roll bar (stage 54) into the upper control arms as shown then secure using two type H screws (7).

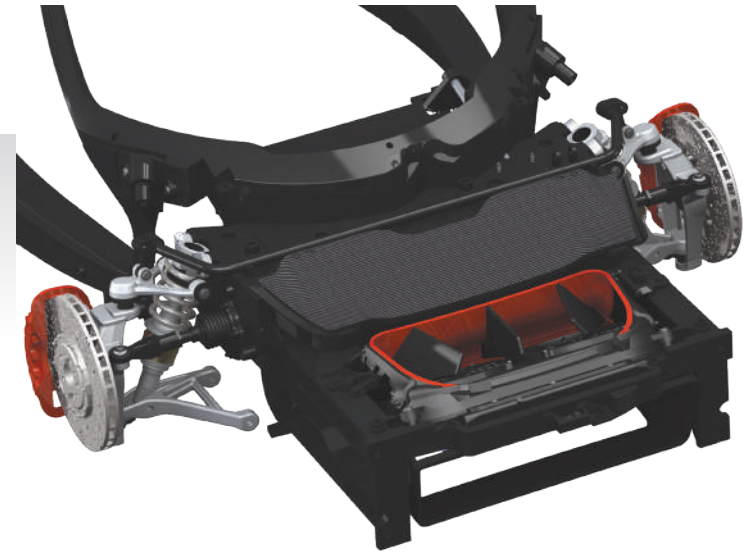
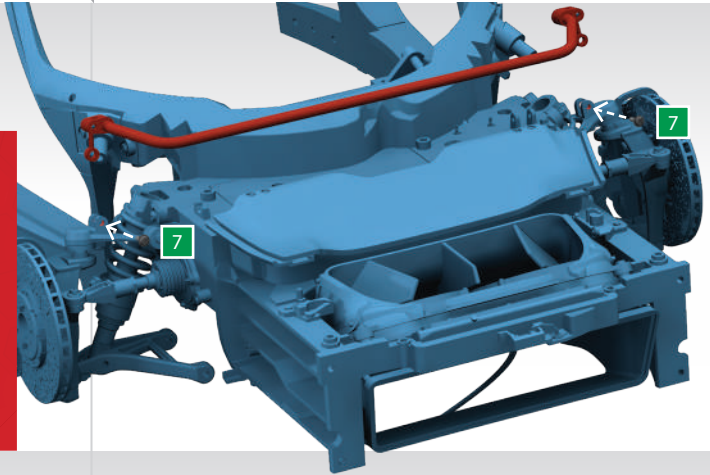

STAGE COMPLETE

Construction of the front suspension is almost complete. The lower control arms will be fixed in a later stage.

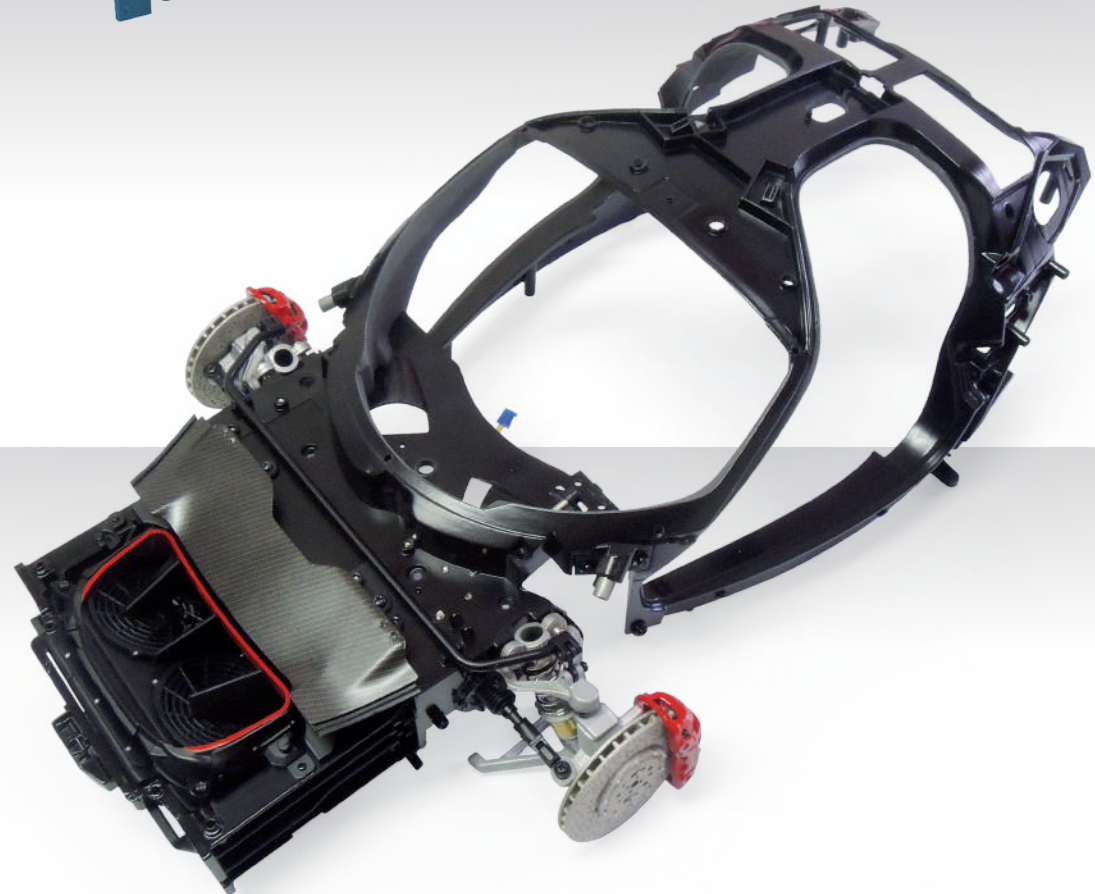

STAGE 56 THE INTERIOR LIGHT AND SWITCHES

THE PURSUIT OF MAXIMUM PERFORMANCE THAT GUIDED THE DESIGN OF LAFERRARI HAS BY NO MEANS COMPROMISED THE COMFORT FEATURES, SUCH AS THE USEFUL INTERIOR LIGHTS OF THE TWO-SEATER CABIN

PARTS LIST

NO.	PART	QUANTITY	MATERIAL
1	Door switch	1	Varied
2	LED light	1	Varied
3	Ceiling light mount	1	ABS
4	LED support bracket	1	ABS
5	Lower rear right side panel	1	ABS
6	Lower rear left side panel	1	ABS
7	Right switch plate	1	ABS
8	Left switch plate	1	ABS
9	Upper cover panel	1	ABS
10	Screw type AA	2	Metal



STEP 1

Fit the LED light (2) into the support bracket (4) and press into the ceiling light mount (3), then fit into position at the top of the chassis. Insert the cable into the opening (arrow, right image).

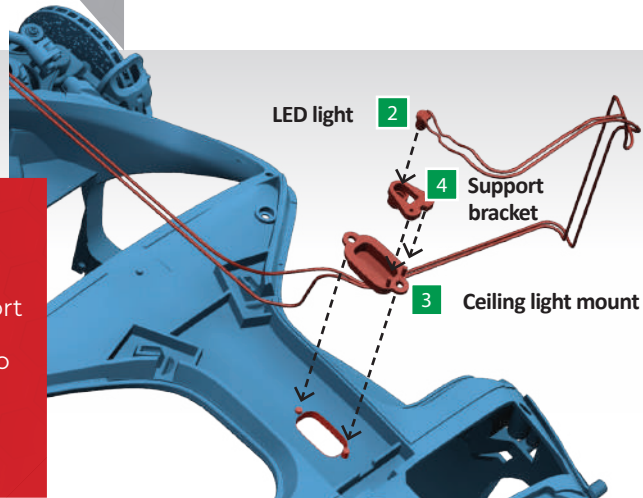

This image shows the terminal in place with the wire fitted into the lower opening behind the switch.



STEP 2

Thread one of the terminals of the door switch (1) through the rectangular opening from the inside, as shown by the dashed arrow. Fit it into the shaped recess and angle the wire into the opening behind the switch. Repeat this process to fit the second terminal to the opposite side. Cover the terminals with the right and left switch plates (7 and 8) then secure using two type AA screws (10).

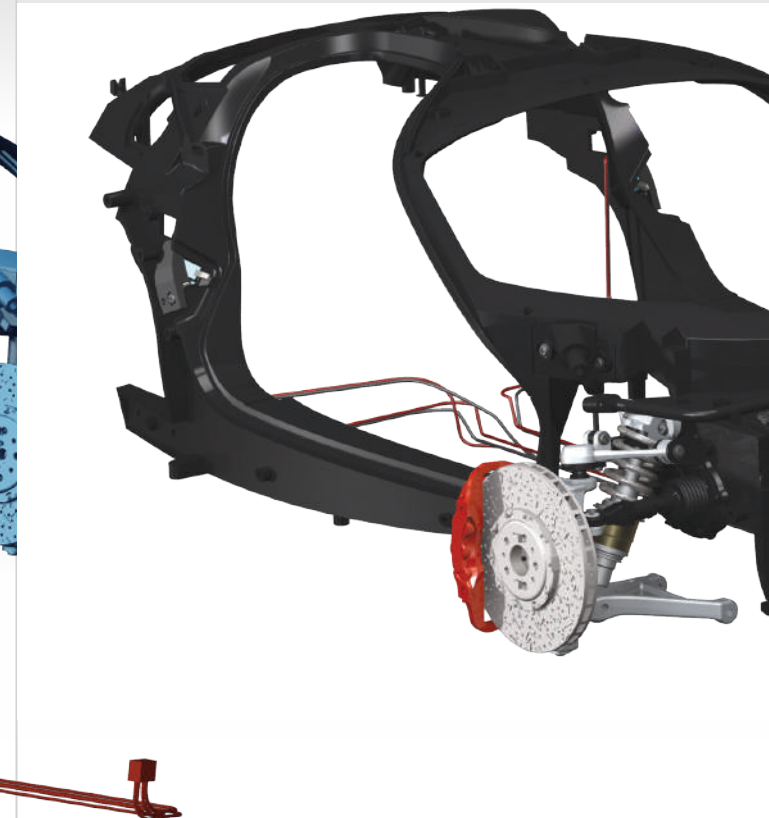
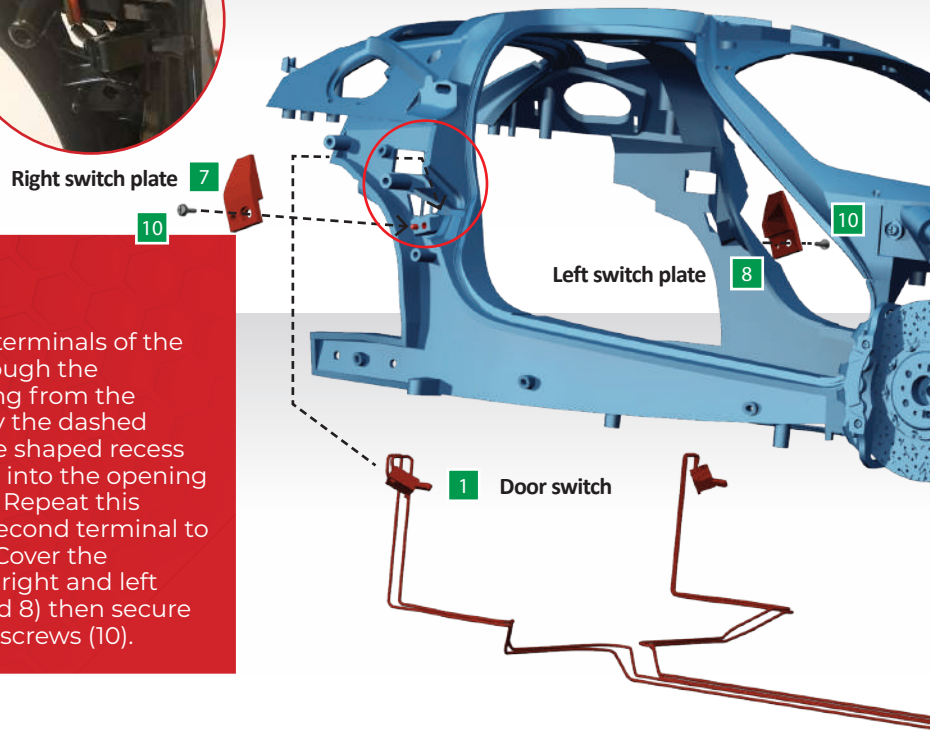

STEP 3

Press the lower rear left (6) and right (7) side panels into the chassis as shown.

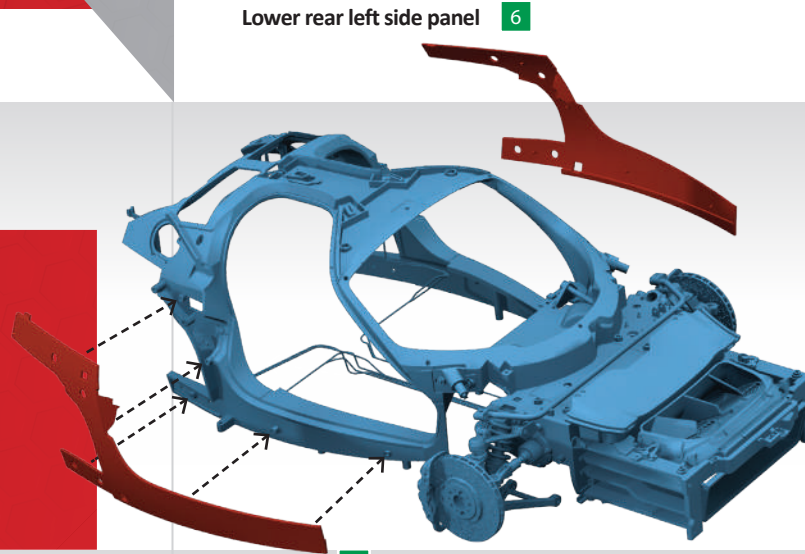

Lower rear left side panel 6



5 Lower rear right side panel

STAGE COMPLETE

Before storing the assembly, gather the loose ends of the wires at the front of the model and secure them using a piece of adhesive tape.

