

Pack 5

# LaFerrari

**1:8 SCALE**

THE ULTIMATE HYPERCAR  
ULTIMATE PERFORMANCE  
ULTIMATE STYLE

**AGORA**  
MODELS®



# STAGE 33 THE CENTRAL TRANSMISSION

LAFERRARI'S LARGE REAR COMPARTMENT HOUSES THE POWERFUL BICYLINDER PROPULSION AND ALL THE COMPONENTS OF THE CENTRAL TRANSMISSION, WHICH WILL BE BUILT IN THIS STAGE.

## PARTS LIST

NO.	PART	QUANTITY	MATERIAL
1	Transmission (C)	1	ABS
2	Cover 1	1	ABS
3	Cover 2	1	ABS
4	Cover 3	1	ABS
5	Screw type I (silver)	2	Metal

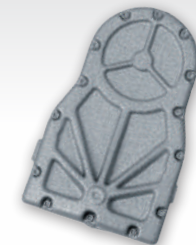
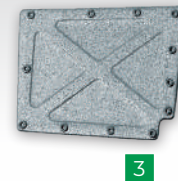
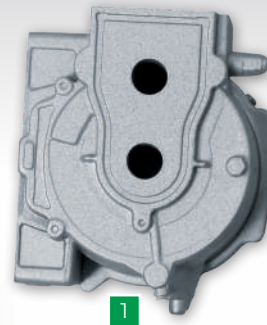



## STEP 1

Install the transmission part C (1) in the orientation shown and secure in place using two type I screws (5). Fit cover 3 (4) in place, using glue to hold it if needed.

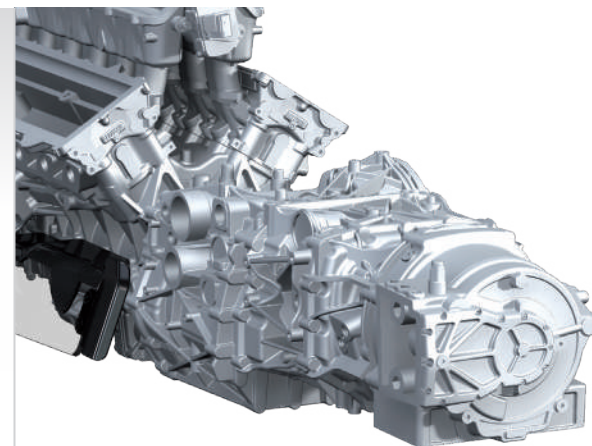
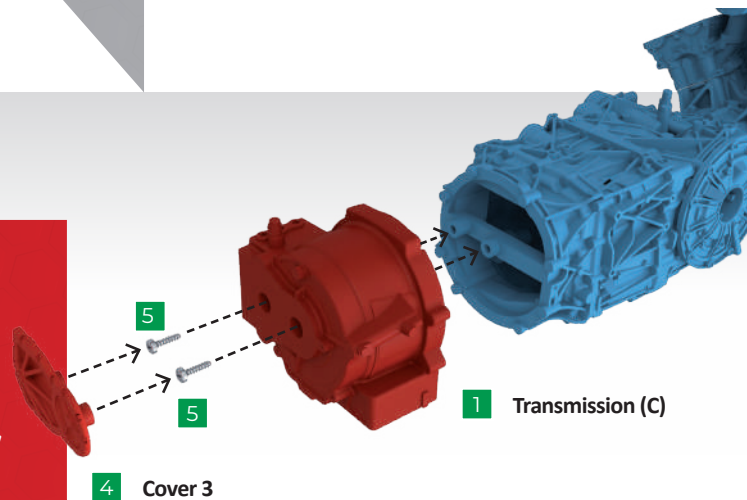

## STEP 2

Push-fit cover 1 (2) into the holes underneath the transmission (1) as shown.

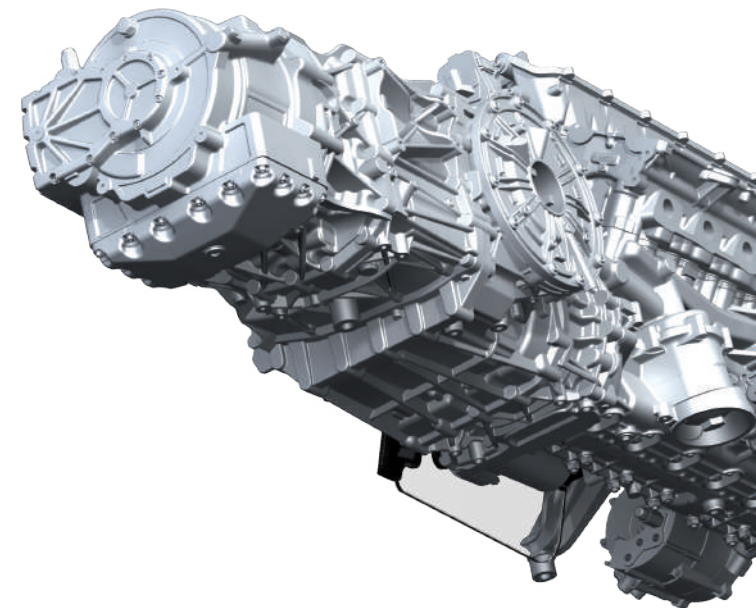
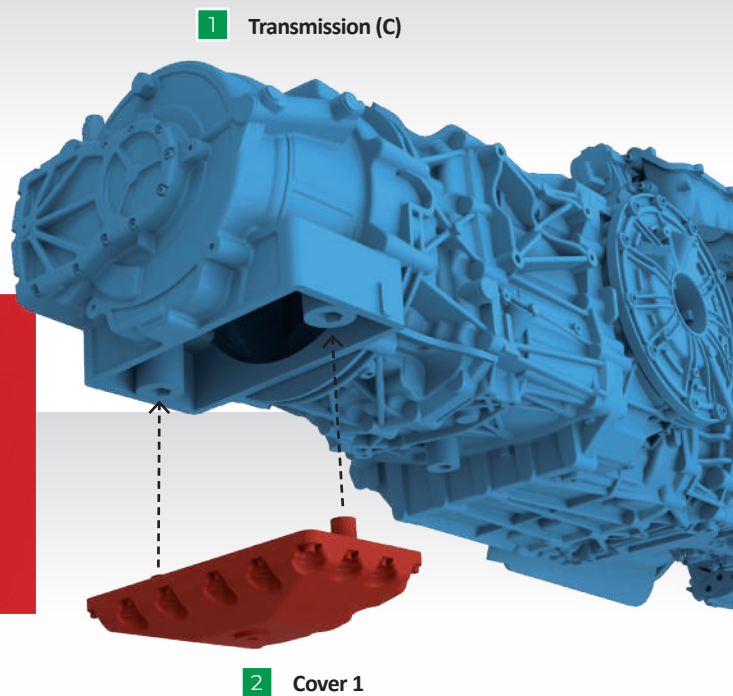

## STEP 3

Fix cover 2 (3) onto the side of the transmission.

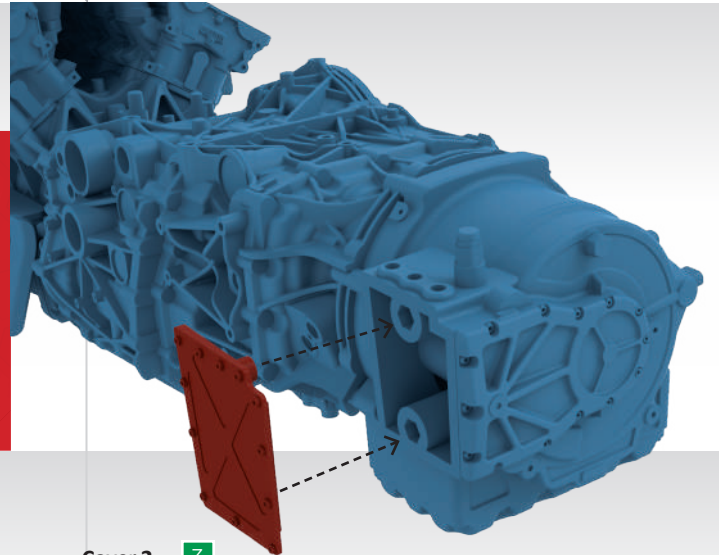

Cover 2 **3**

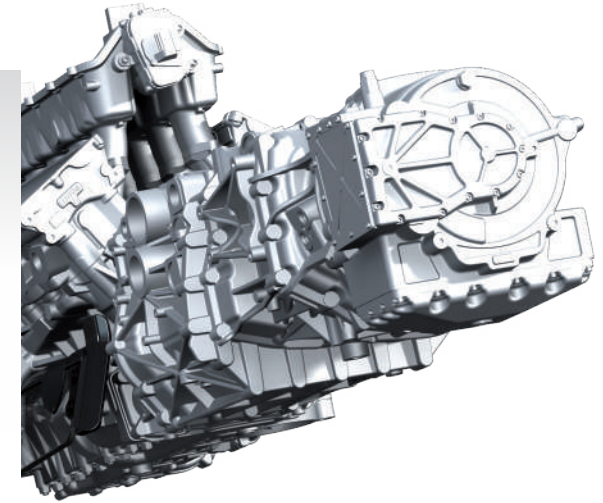

## STAGE COMPLETE

The central transmission has now been fixed onto the engine of your 1:8 scale LaFerrari. Store the assembly away safely for now.

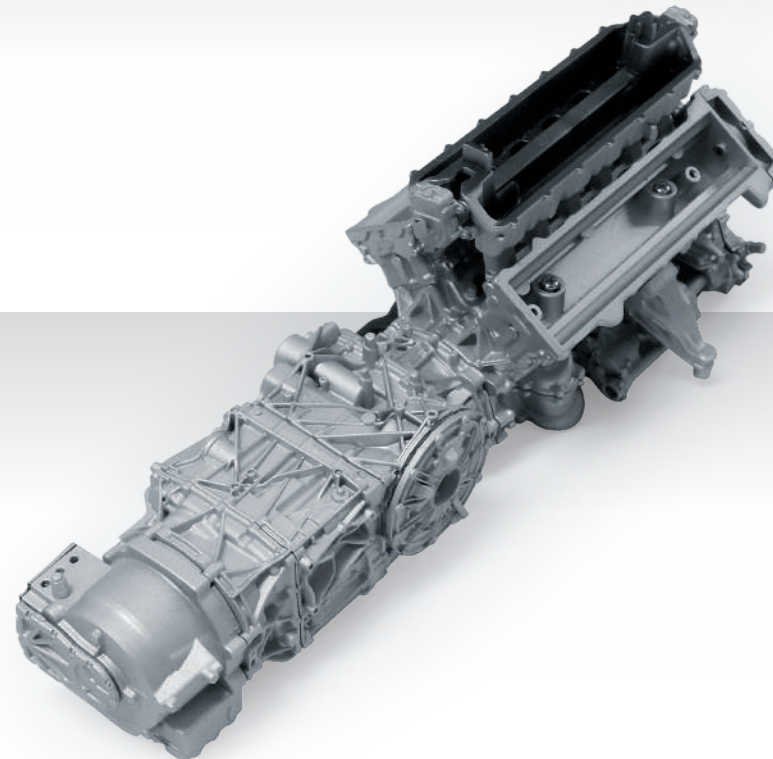



# STAGE 34 CRANKSHAFT PULLEY AND WATER PUMP

THE PARTS SUPPLIED WITH THIS STAGE CAN BE KEPT ASIDE FOR NOW. FIRST YOU WILL INSTALL THE CRANKSHAFT PULLEY, WATER PUMP AND JOINT ONTO THE ENGINE USING THE PARTS FROM STAGE 31

## PARTS LIST

NO.	PART	QUANTITY	MATERIAL
1	Manifold connection flange	1	ABS
2	Manifold connector	1	ABS
3	Right manifold B	1	ABS
4	Right manifold A	1	ABS
5	Right manifold C	1	ABS



1



2



3



4



5



## STEP 1

Fit the crankshaft pulley (stage 31) then install the belt (stage 31) in the orientation shown.

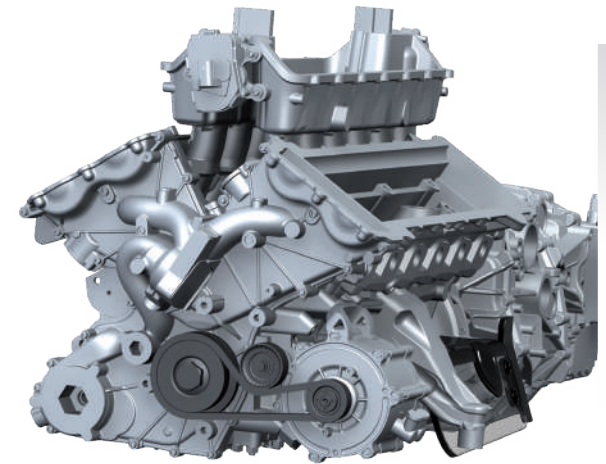
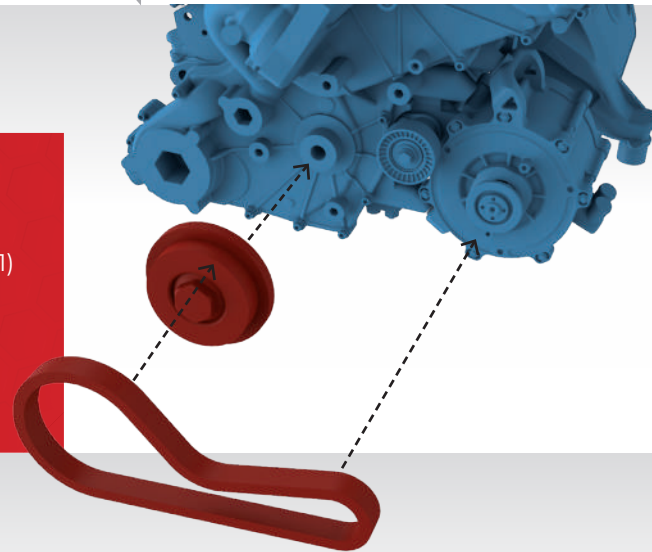

## STEP 2

Press the water pump and belt cover (stage 31) into the indicated holes.

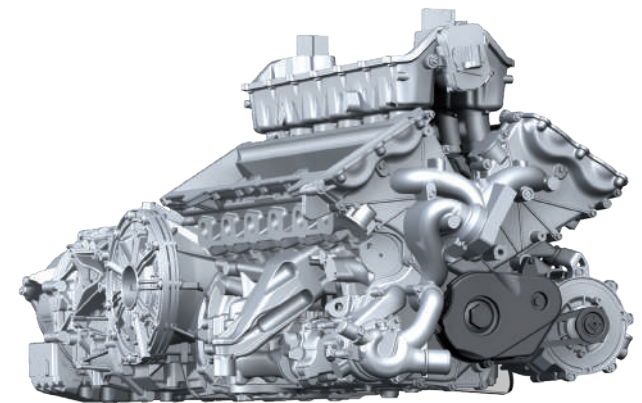
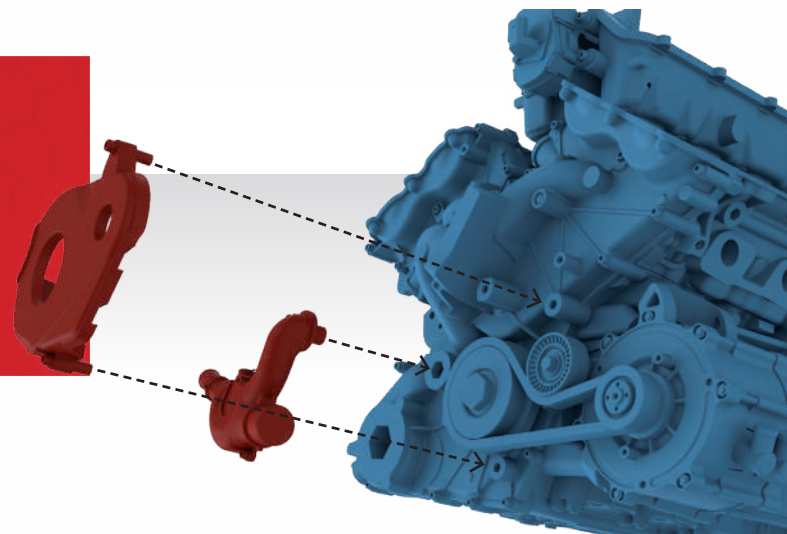



### STEP 3

Push the joint (stage 31) in place as shown.

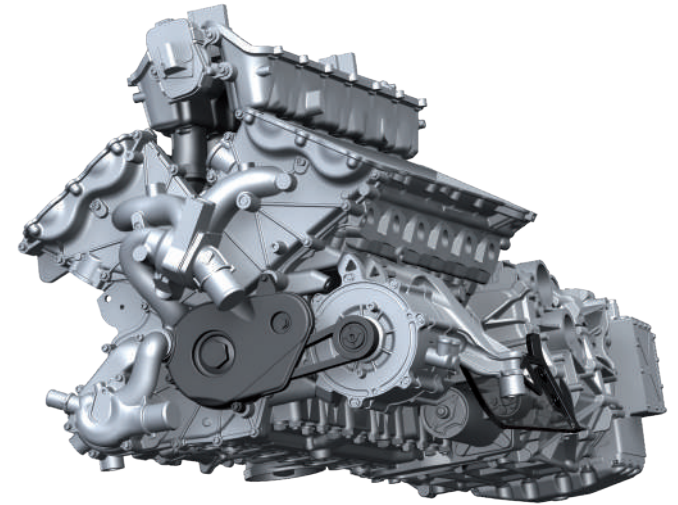
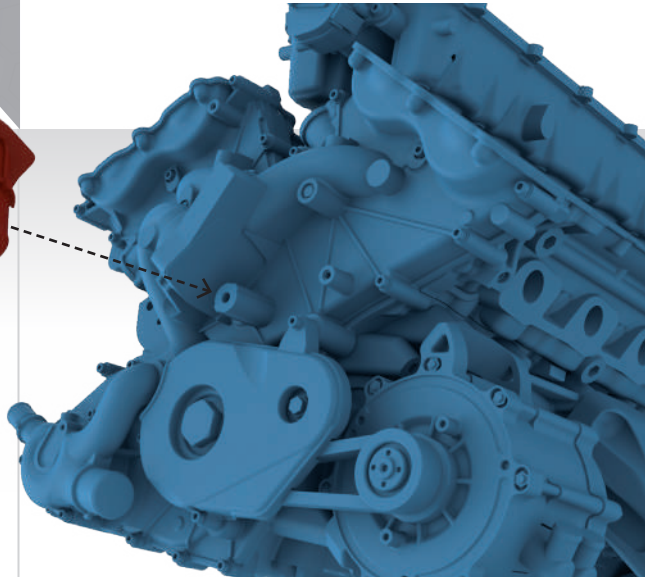

### STAGE COMPLETE

New parts have been fitted to the engine. The parts supplied with this stage will be needed in Stage 35.

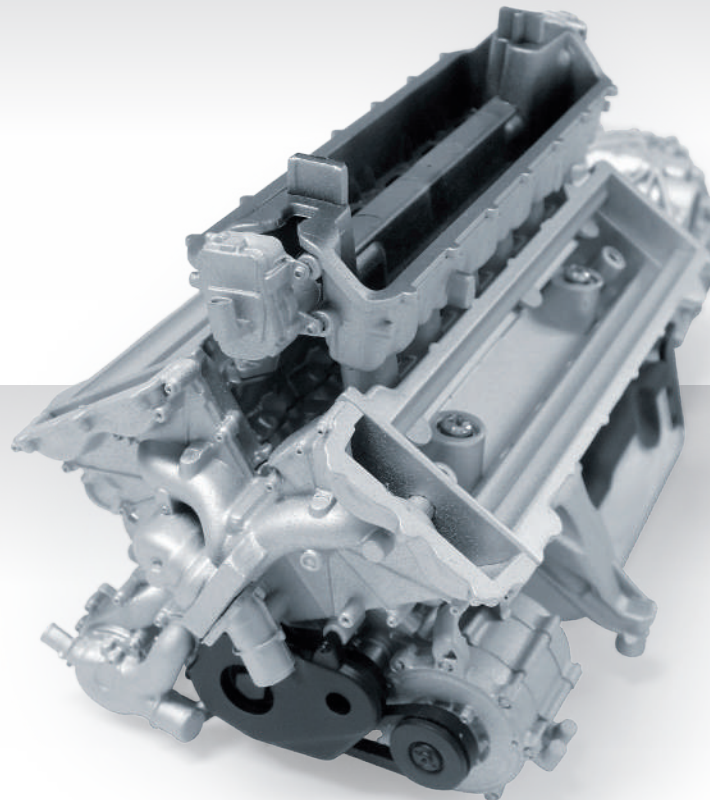

# STAGE 35 THE RIGHT EXHAUST MANIFOLD

THE TWISTING SHAPES OF  
LAFERRARI'S EXHAUST MANIFOLD  
HAVE BEEN CAREFULLY DESIGNED  
FOR MAXIMUM PERFORMANCE

## PARTS LIST

NO.	PART	QUANTITY	MATERIAL
1	Manifold connection flange	1	ABS
2	Manifold connector	1	ABS
3	Right manifold E	1	ABS
4	Right manifold F	1	ABS
5	Right manifold D	1	ABS



1



2



3



4



5



## STEP 1

In clockwise order, firmly press the right manifolds D (5) and E (3) into the manifold connector (stage 34).

Right manifold E **3**

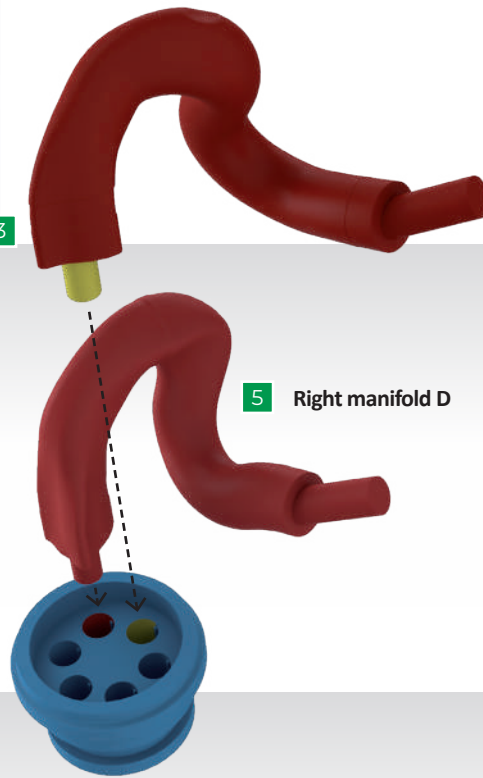

**5** Right manifold D



## STEP 2

Next push the right manifolds F (4) and A (stage 34) firmly into position as shown.

Right manifold A

**4** Right manifold F

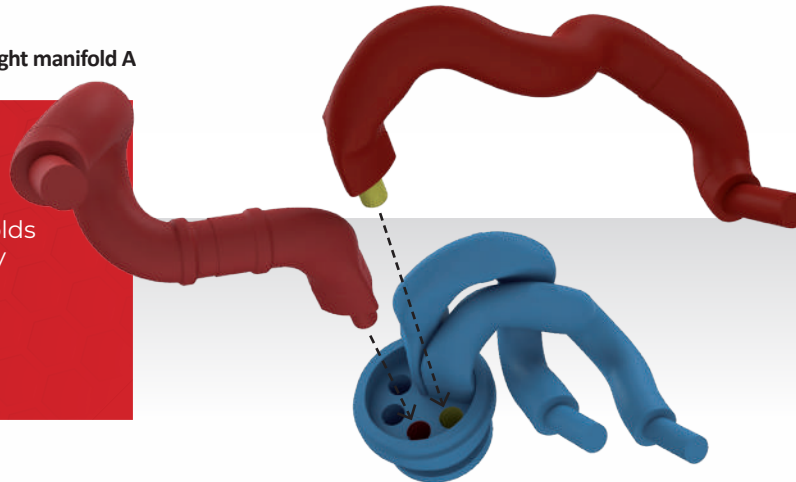

## STEP 3

Finish by installing the right manifolds B and C (stage 34) in place as shown.

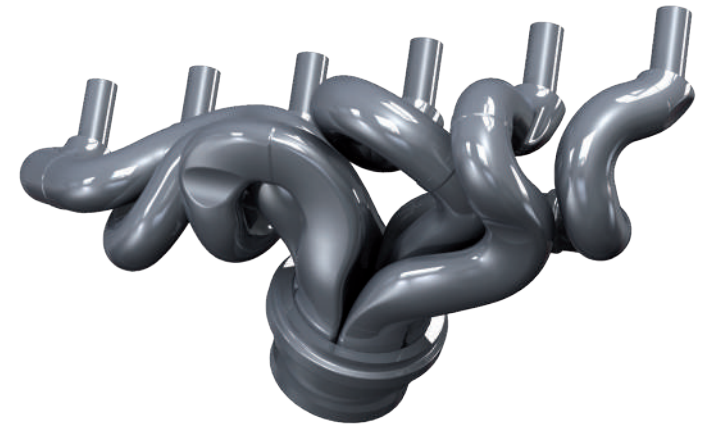
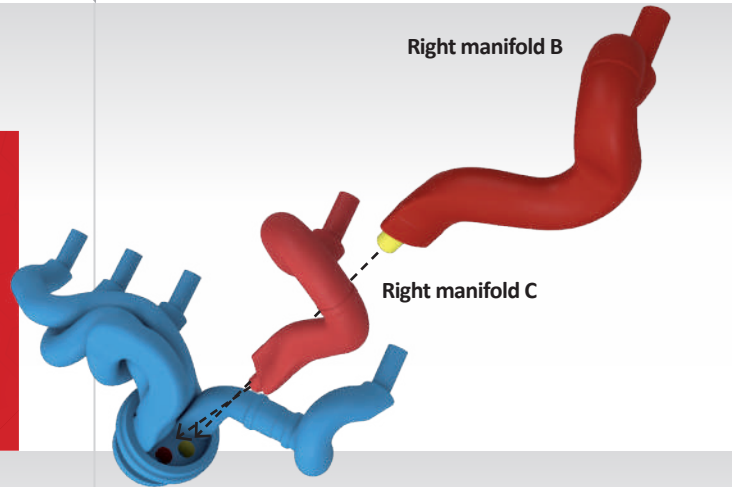

## STAGE COMPLETE

The right manifolds have been installed into the connector. The parts may be loose for now, so store the assembly carefully until it is fitted to the engine in a later stage.

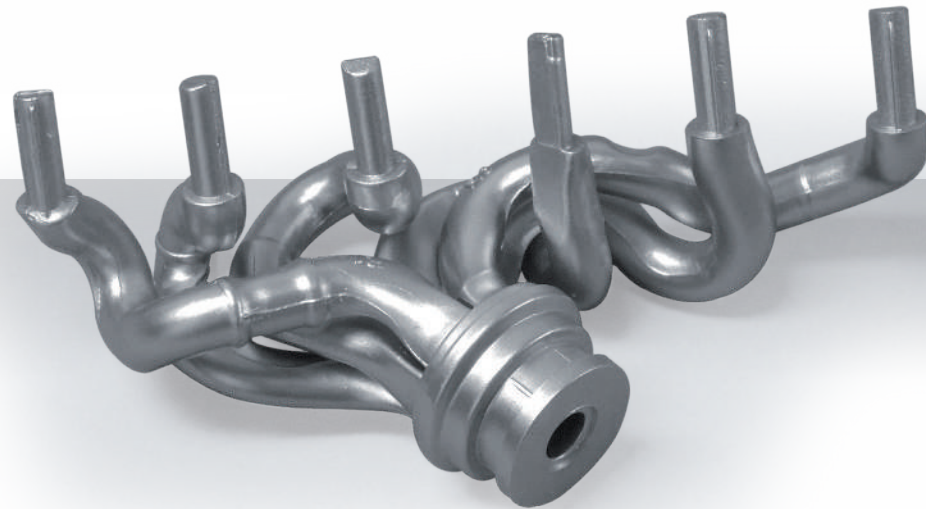



# STAGE 36 THE LEFT EXHAUST MANIFOLD

EXHAUST MANIFOLDS NOT ONLY PERFORM THE FUNCTION OF CARRYING COMBUSTION GASES OUT OF THE ENGINE, THEY CAN ALSO SIGNIFICANTLY AFFECT THE CAR'S PERFORMANCE

## PARTS LIST

NO.	PART	QUANTITY	MATERIAL
1	Left manifold E	1	ABS
2	Left manifold C	1	ABS
3	Left manifold D	1	ABS
4	Left manifold B	1	ABS
5	Left manifold A	1	ABS
6	Left manifold F	1	ABS

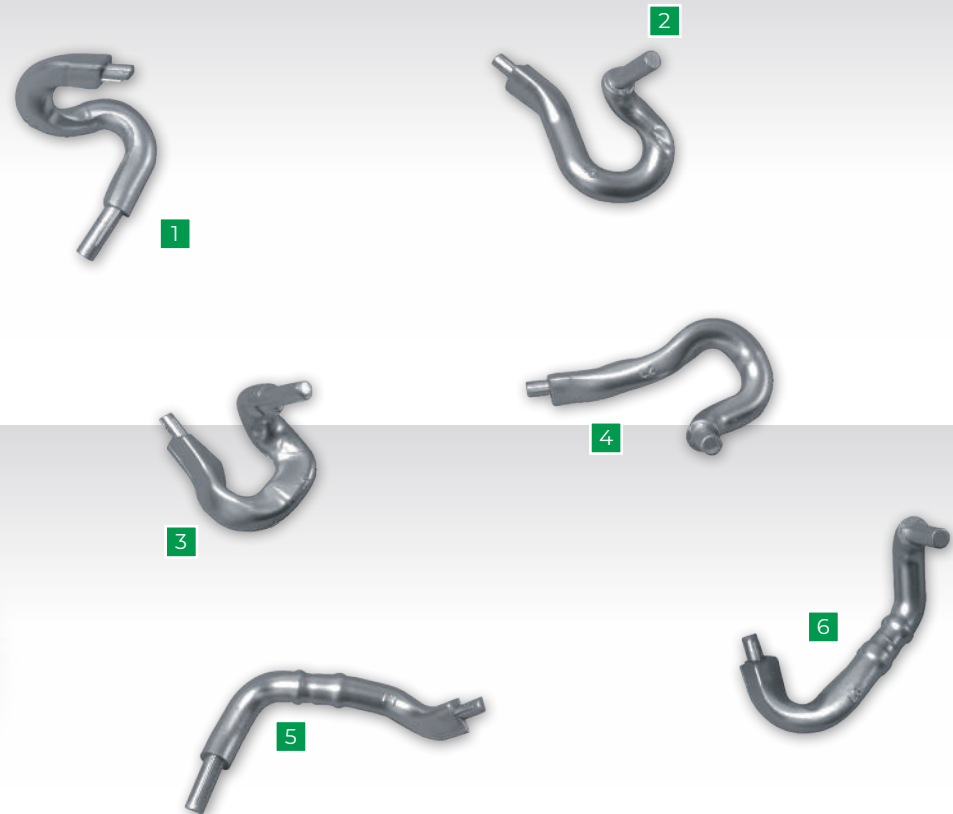

## STEP 1

In anti-clockwise order, firmly press the left manifolds B (4) and C (2) into the manifold connector (stage 35).

Left manifold B 4

2 Left manifold C

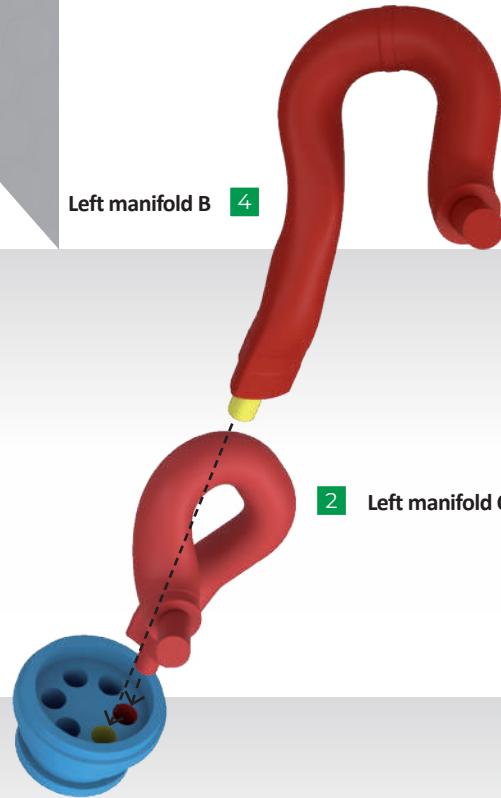

## STEP 2

Continue by pushing the left manifolds A (5) and D (3) into position as shown.

Left manifold A 5

Left manifold D 3

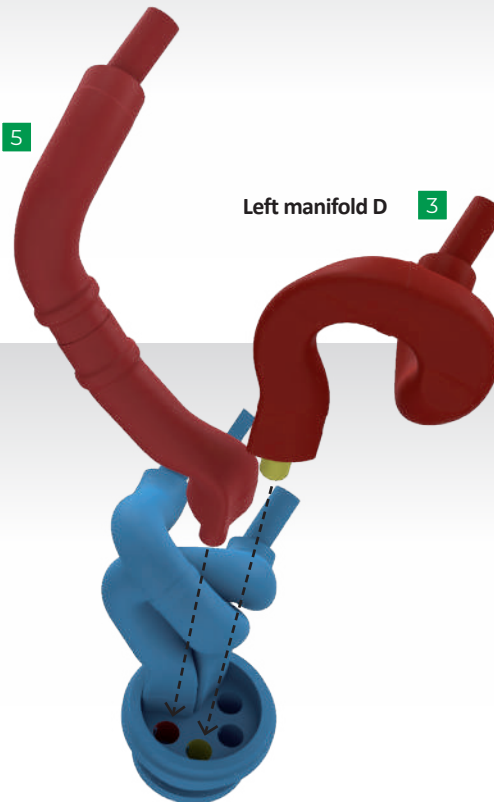



### STEP 3

Finally, fit the left manifolds E (1) and F (6) in place.

Left manifold F **6**

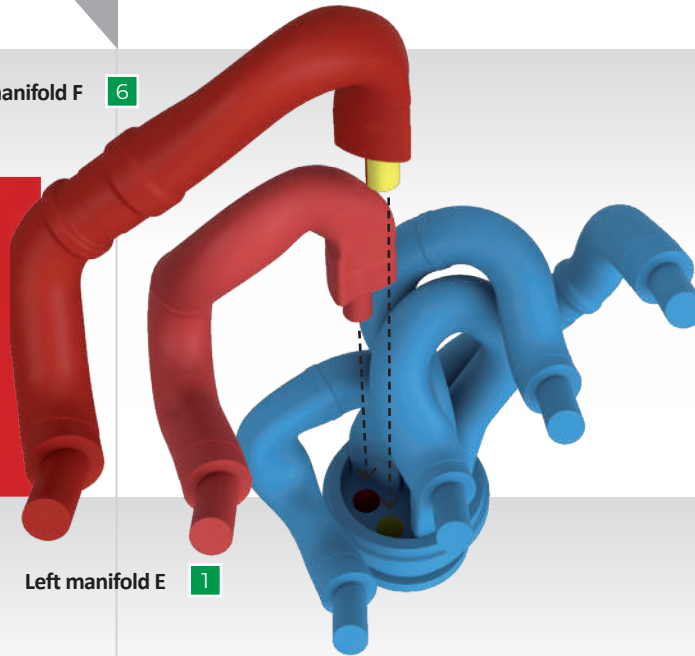

Left manifold E **1**



### STAGE COMPLETE

Store the left manifold assembly carefully away until it is needed for installing onto the engine.

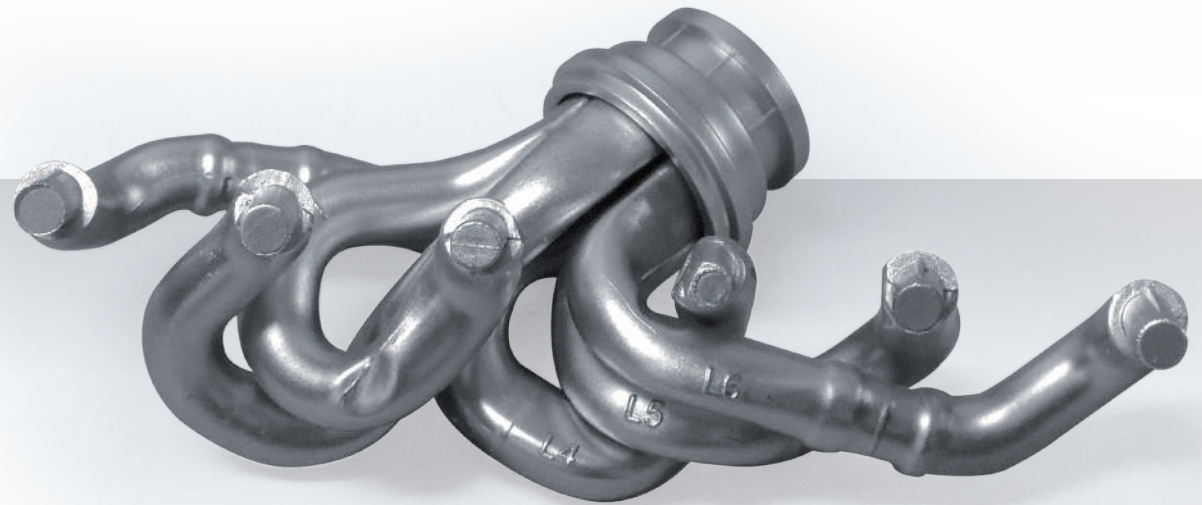

# STAGE 37 THE LEFT EXHAUST SYSTEM

IN ADDITION TO PERFORMING A FUNDAMENTAL TASK FOR THE FUNCTIONING OF THE ENGINE, THE EXHAUST SYSTEM GIVES THE ROAR OF THE ENGINE - THE 'VOICE' THAT FERRARI ENTHUSIASTS ADORE.

## PARTS LIST

NO.	PART	QUANTITY	MATERIAL
1	Left catalytic converter (A)	1	ABS
2	Left catalytic converter (B)	1	ABS
3	Left rear exhaust (A)	1	ABS
4	Left rear exhaust (B)	1	ABS
5	Left terminal	1	ABS
6	Screw type I (silver)	3	Metal



1



2



3



4



5



6

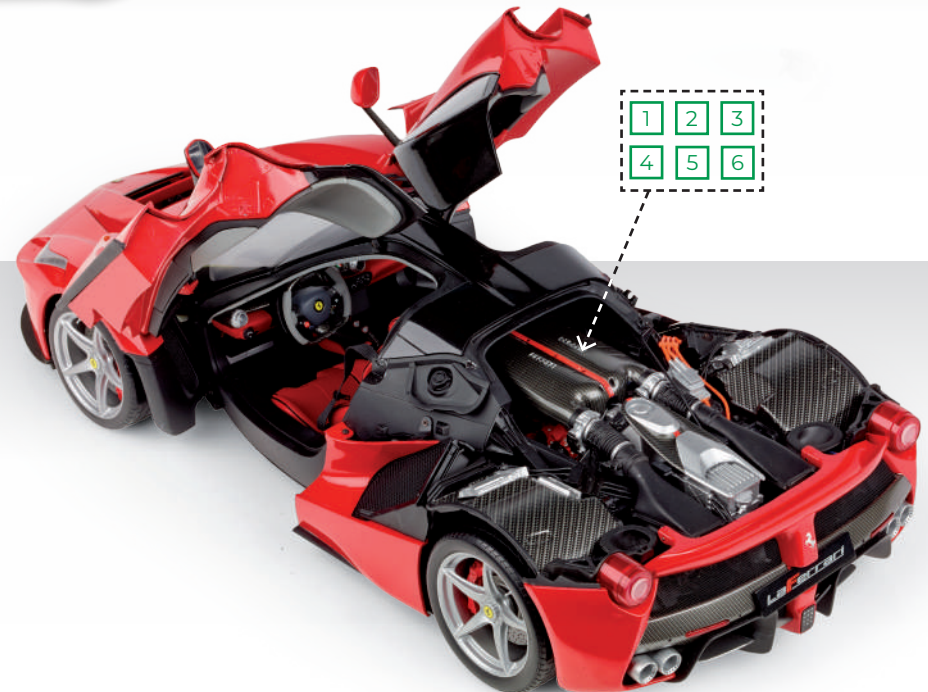



## STEP 1

Join the two parts of the left rear exhaust (3 and 4) together then fit the left terminal (5) in place as shown.

Left rear exhaust (A) **3**

Left rear exhaust (B) **4**

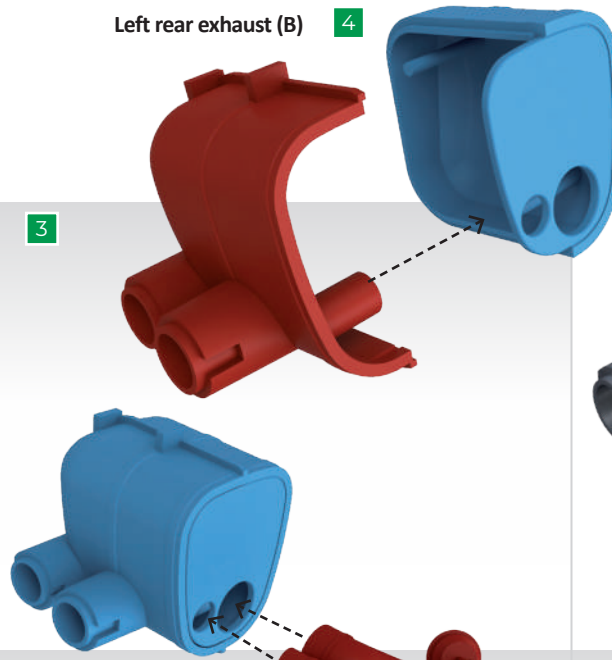

Left terminal **5**

## STEP 2

Close the two parts of the left catalytic converter (1 and 2) around the left rear exhaust and left manifold assemblies as shown. Secure together using three type I screws (6).

Left catalytic converter (B) **2**

**1** Left catalytic converter (A)

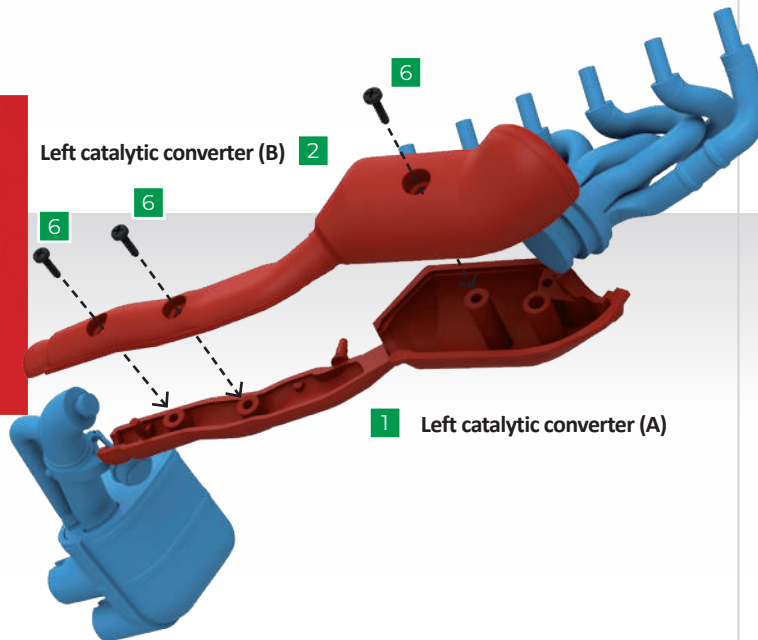

### STEP 3

Pass the ends of the left manifolds through the manifold connection flange (stage 34) – the pipes and holes are each numbered to ensure they are fitted correctly. Then firmly push them into the holes in the left side of the engine.

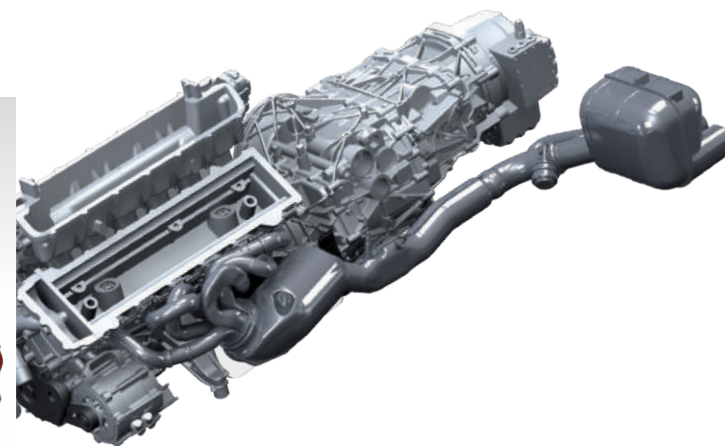
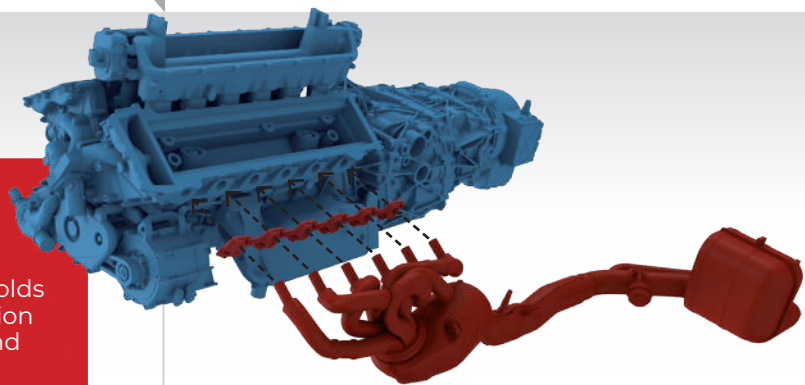

### STAGE COMPLETE

The exhaust system on the left side has been installed onto the engine. Keep the assembly aside until it is needed in the next stage.

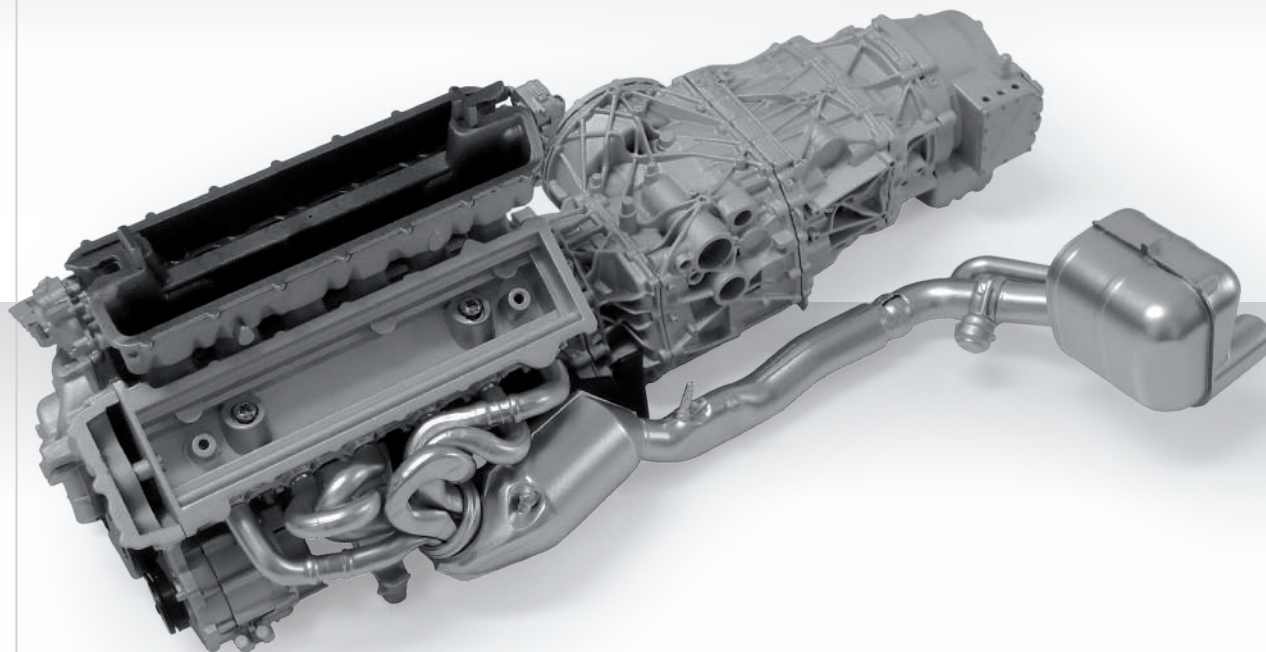



# STAGE 38 THE RIGHT EXHAUST SYSTEM

THE RIGHT EXHAUST SYSTEM  
CONSISTS OF THE SAME  
ELEMENTS AS THOSE FOUND ON  
THE LEFT-HAND SIDE, WITH  
ADDITIONAL HOSES AND CABLES  
THAT MUST BE INSTALLED  
WITH CARE.

## PARTS LIST

NO.	PART	QUANTITY	MATERIAL
1	Right catalytic converter (A)	1	ABS
2	Right catalytic converter (B)	1	ABS
3	Right rear exhaust (A)	1	ABS
4	Right rear exhaust (B)	1	ABS
5	Right terminal	1	ABS
6	Hydraulic hoses A	1	PVC
7	Hydraulic hoses B	1	PVC
8	Electrical cables	1	PVC
9	Screw type I (silver)	3	Metal

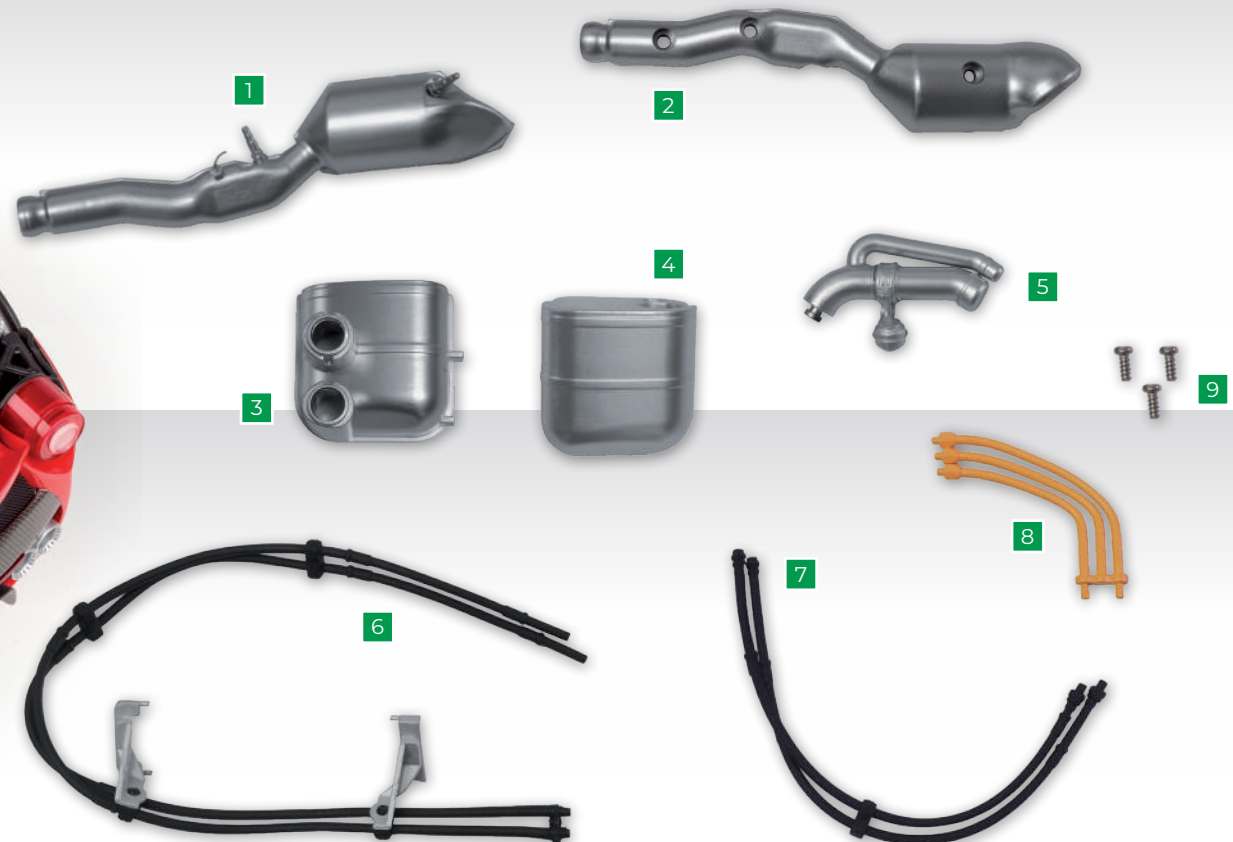

## STEP 1

Join the two parts of the right rear exhaust (3 and 4) together then fit the right terminal (5) in place as shown.

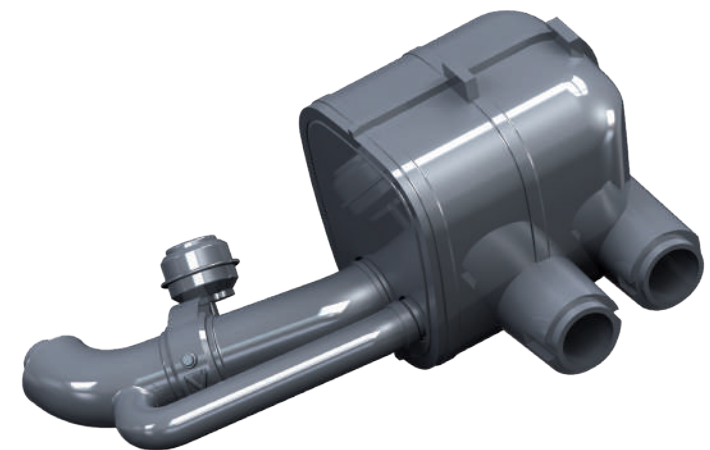
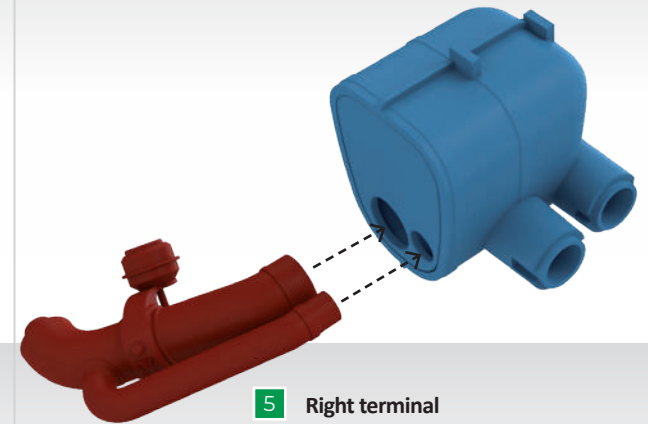
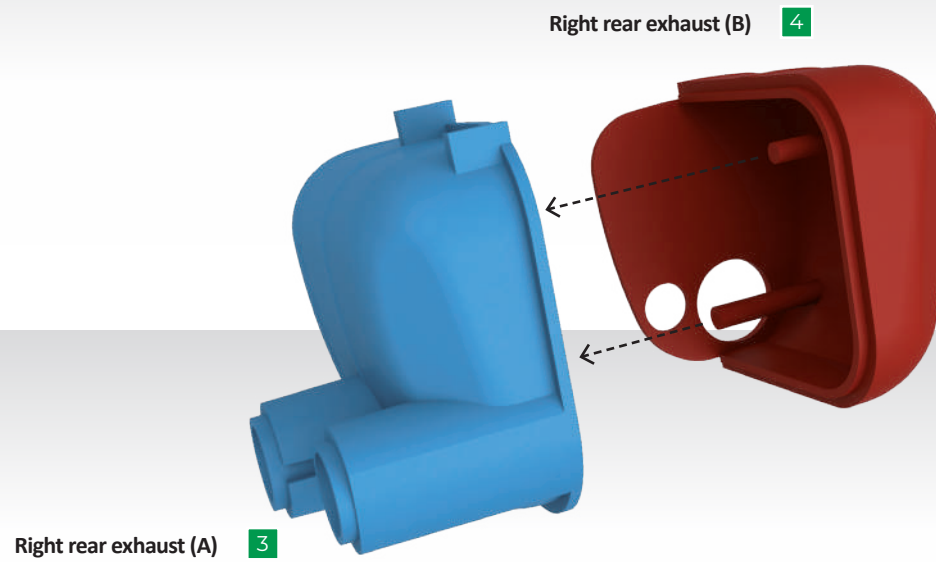



## STEP 2

Join the two parts of the right catalytic converter (1 and 2) around the right rear exhaust and right manifold assemblies, fixing them together using three type I screws (6).

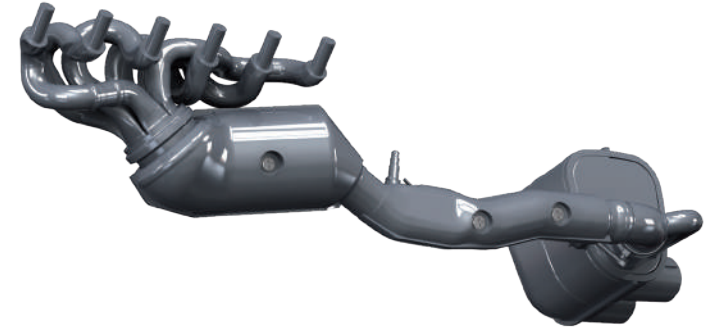
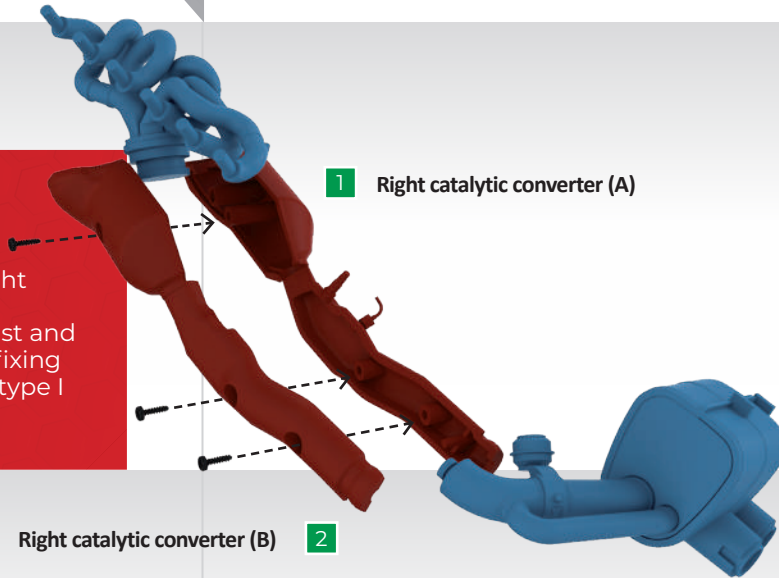

## STEP 3

Pass the ends of the right manifolds through the manifold connection flange (stage 35) – the pipes and holes are each numbered to ensure they are fitted correctly. Then firmly push the pipes into the holes in the right side of the engine.

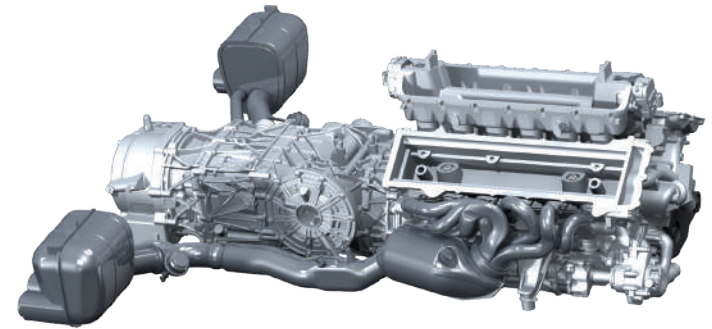
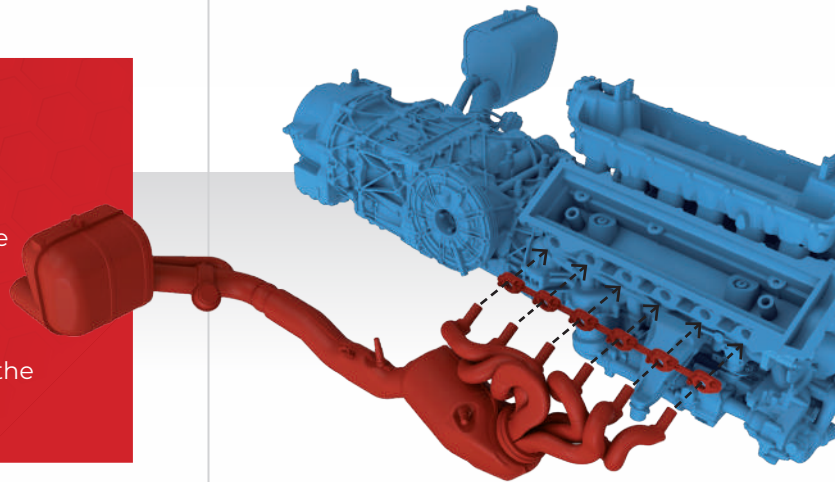

## STEP 4

Take part A of the hydraulic hoses (6) and fit its brackets into the holes on the sides of the engine.

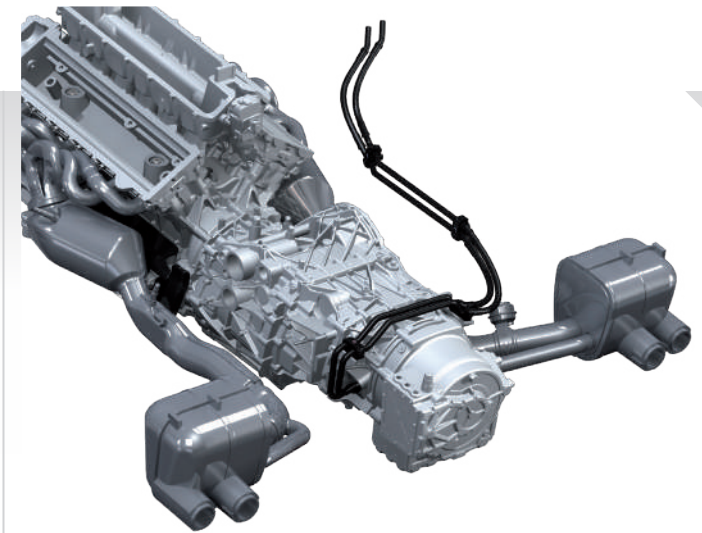
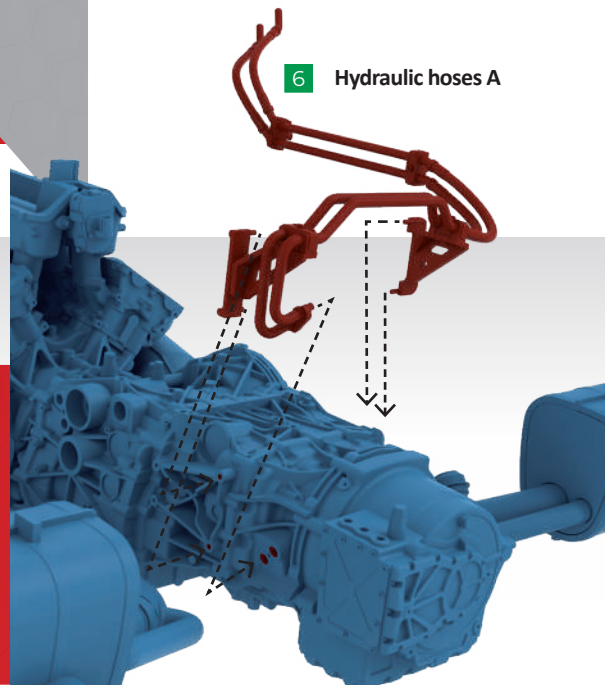

## STEP 5

Push the equal-length ends of remaining hydraulic hoses (7) into the indicated holes as shown.

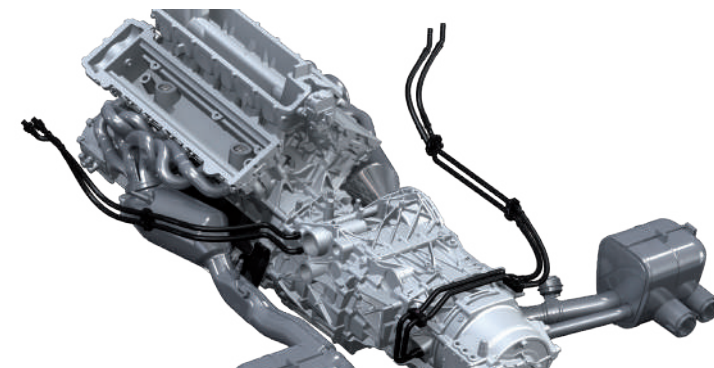
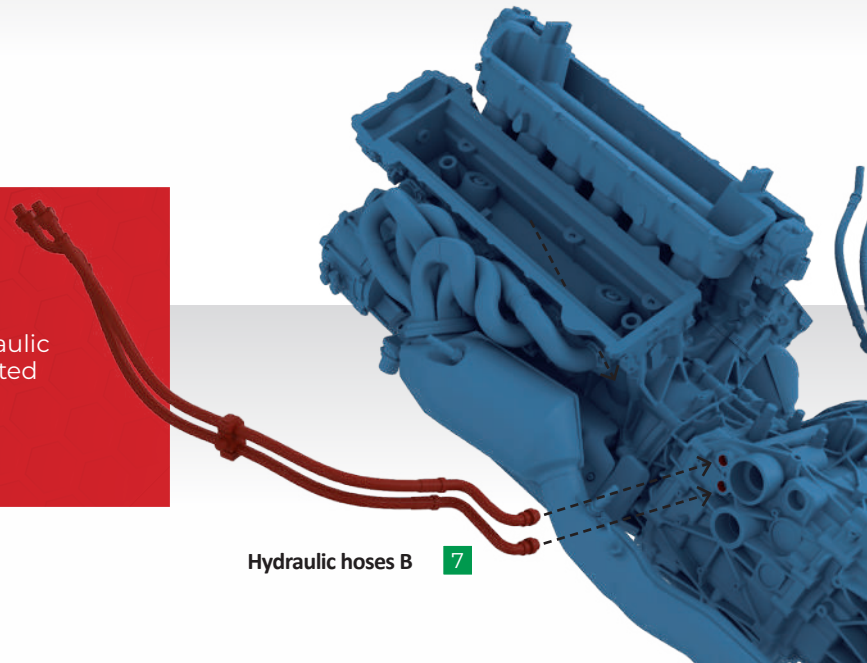



## STEP 6

Fit the electrical cables (8) into the three holes on top of the transmission assembly.

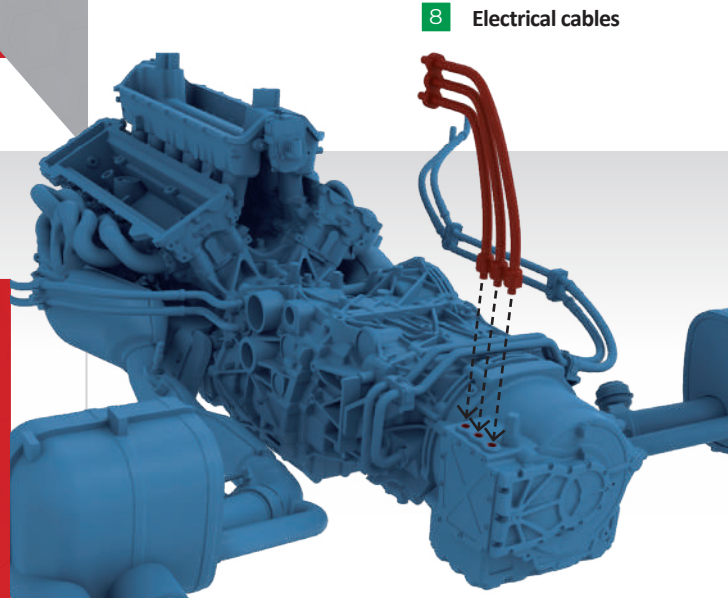

8 Electrical cables

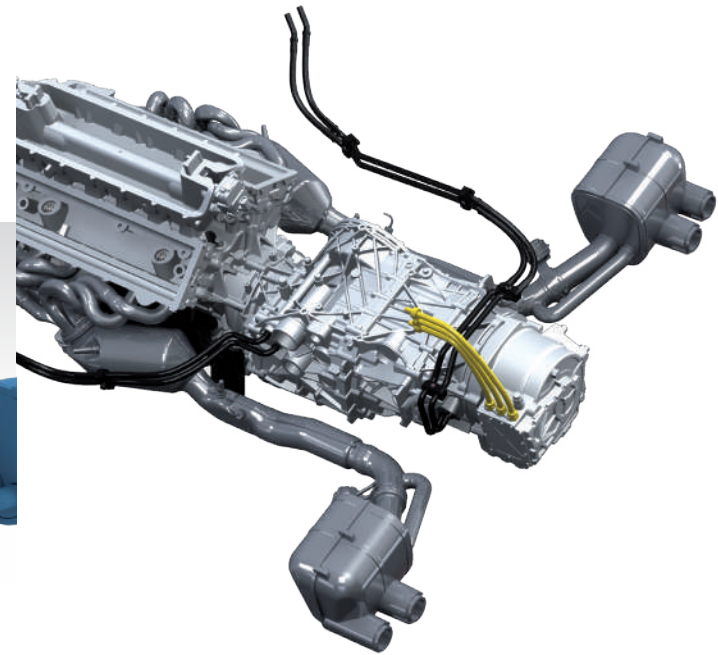

## STAGE COMPLETE

The right exhaust system, along with the hydraulic hoses and electrical cables, have been installed onto the engine.

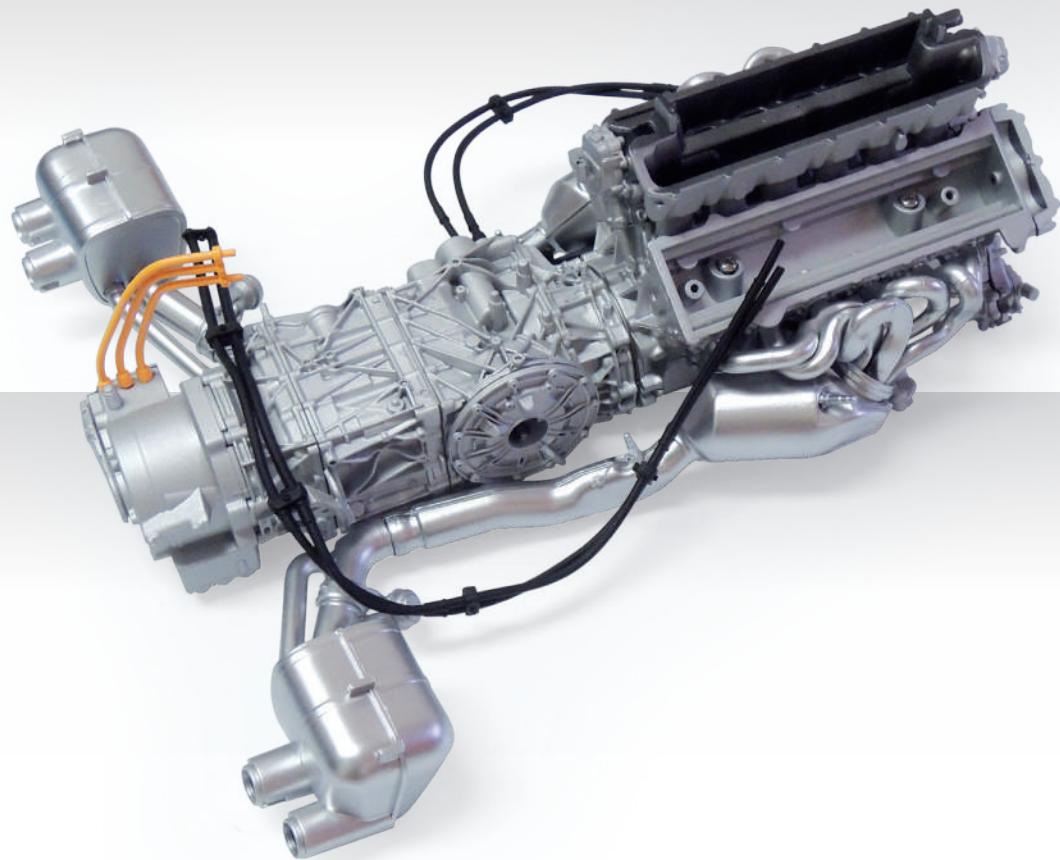

# STAGE 39 THE IGNITION SYSTEM

THE ELECTRIC CABLES CARRYING CURRENT TO THE SPARK PLUGS MUST MEET PRECISE TECHNICAL REQUIREMENTS AS THEY CONDUCT ELECTRICITY AT A VERY HIGH VOLTAGE.

## PARTS LIST

NO.	PART	QUANTITY	MATERIAL
1	Lower left exhaust manifold guard	1	ABS
2	Upper right exhaust manifold guard	1	ABS
3	Upper left exhaust manifold guard	1	ABS
4	Right spark plug cables	1	PVC
5	Left spark plug cables	1	PVC
6	Screw type H	4	Metal

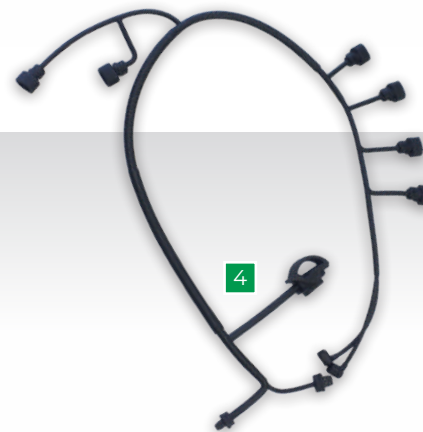
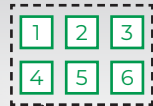



## STEP 1

Fit the left and right head covers (stage 9, marked 'L' and 'R') in position and secure using four type H screws (6). Remember the thin piece of black material that goes between the parts.

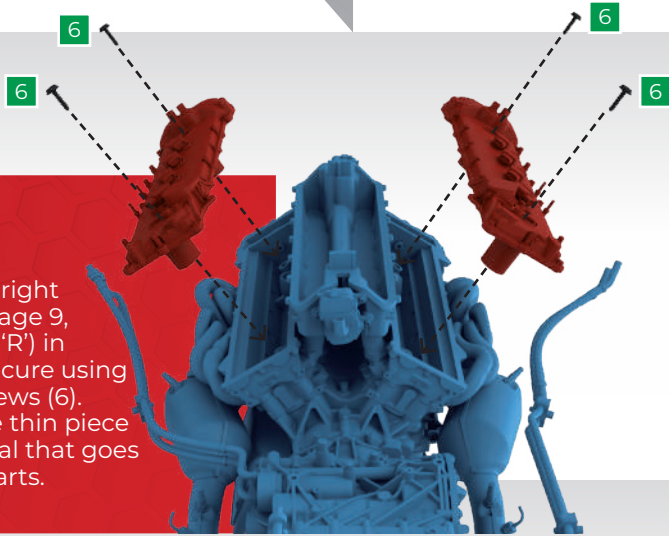

## STEP 2

Press four of the plug caps (stage 8) into the holes to cover the screws as shown.

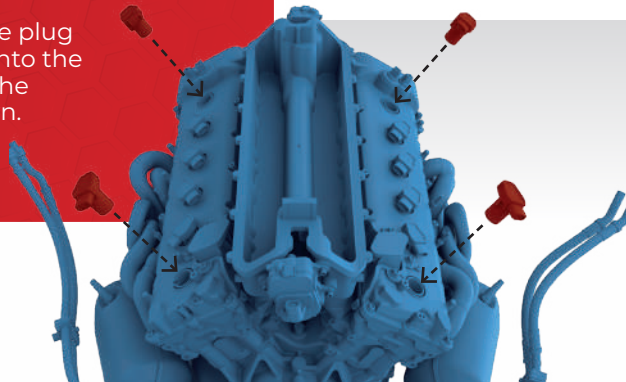

## STEP 3

To mount the spark plug cables (4 and 5), orient them as shown then fit the pins into the holes (circled) and push the hollow ends over the plug caps of the head covers (see image below).

Left spark plug cables **5**

Right spark plug cables **4**

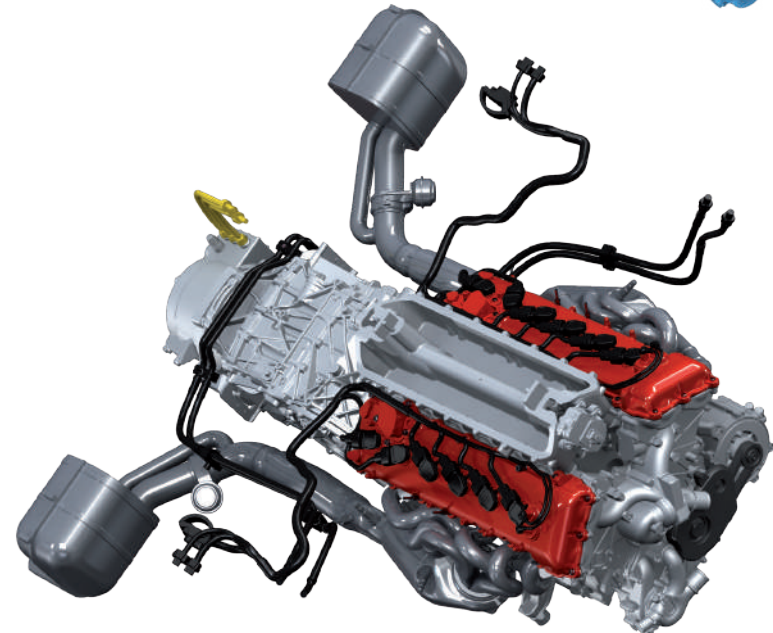
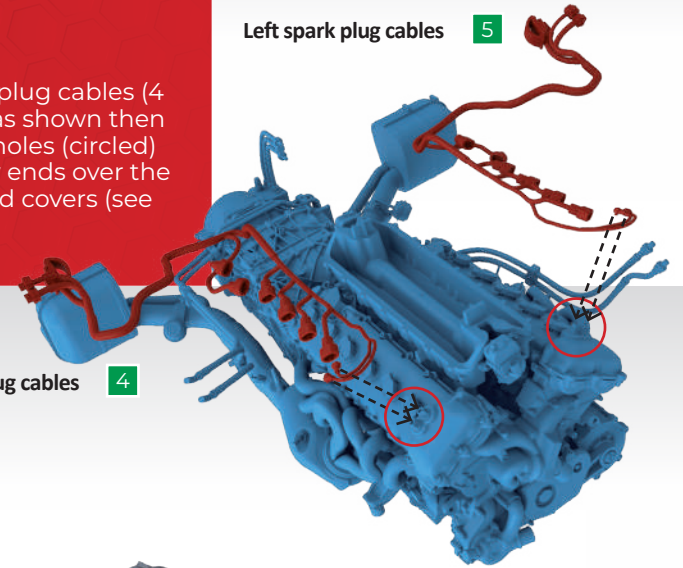



Upper right exhaust manifold guard

2

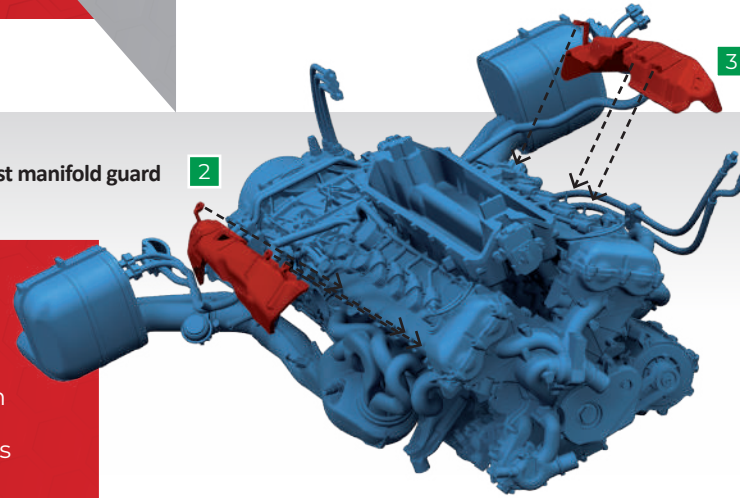

Upper left exhaust manifold guard

3

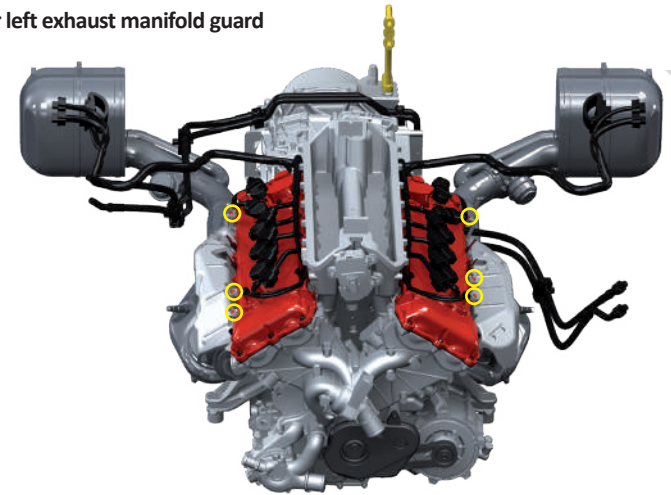

## STEP 4

Fit the upper left (3) and right (2) exhaust manifold guards in place by clipping the three holes of each onto the red pins (see right image, circled).

## STEP 5

Fit the lower left exhaust manifold guard (1) in place as shown.

1

Lower left exhaust manifold guard

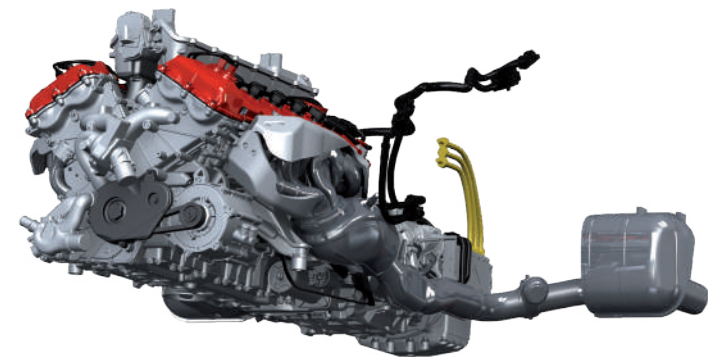
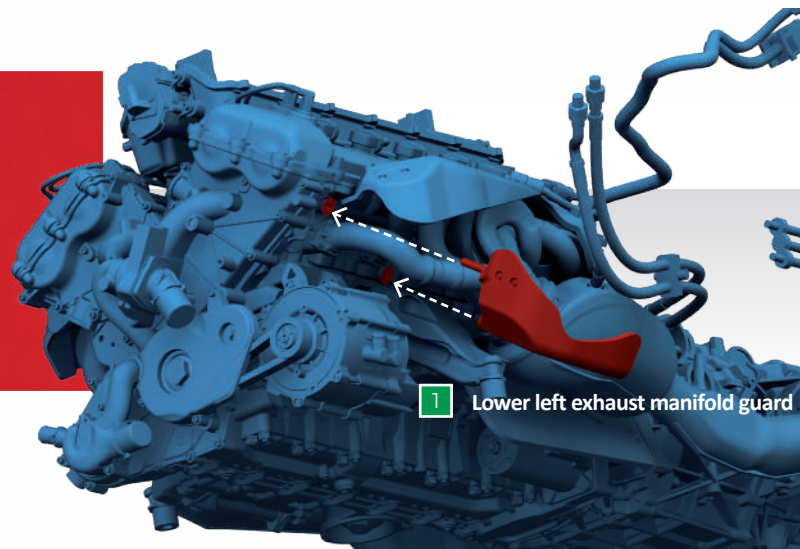

## STEP 6

Orient the air-box (stage 7) as shown and fit it to the top of the power unit.

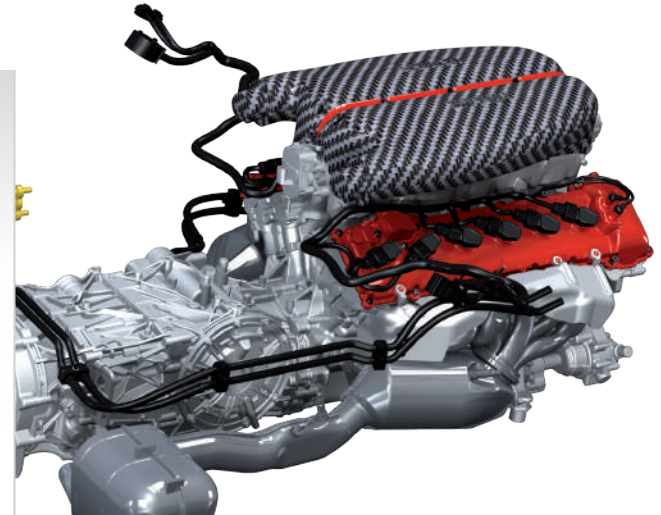
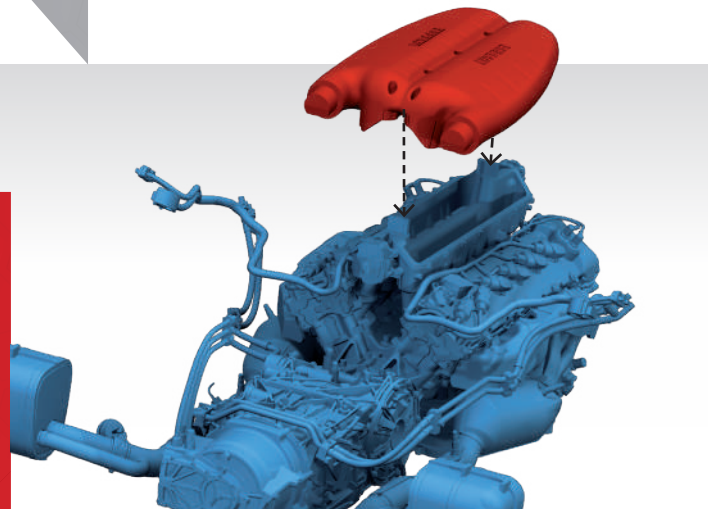

## STAGE COMPLETE

The combustion engine of your 1:8 scale LaFerrari has been enhanced with many new parts and is now almost complete. Store it away carefully until it is needed.

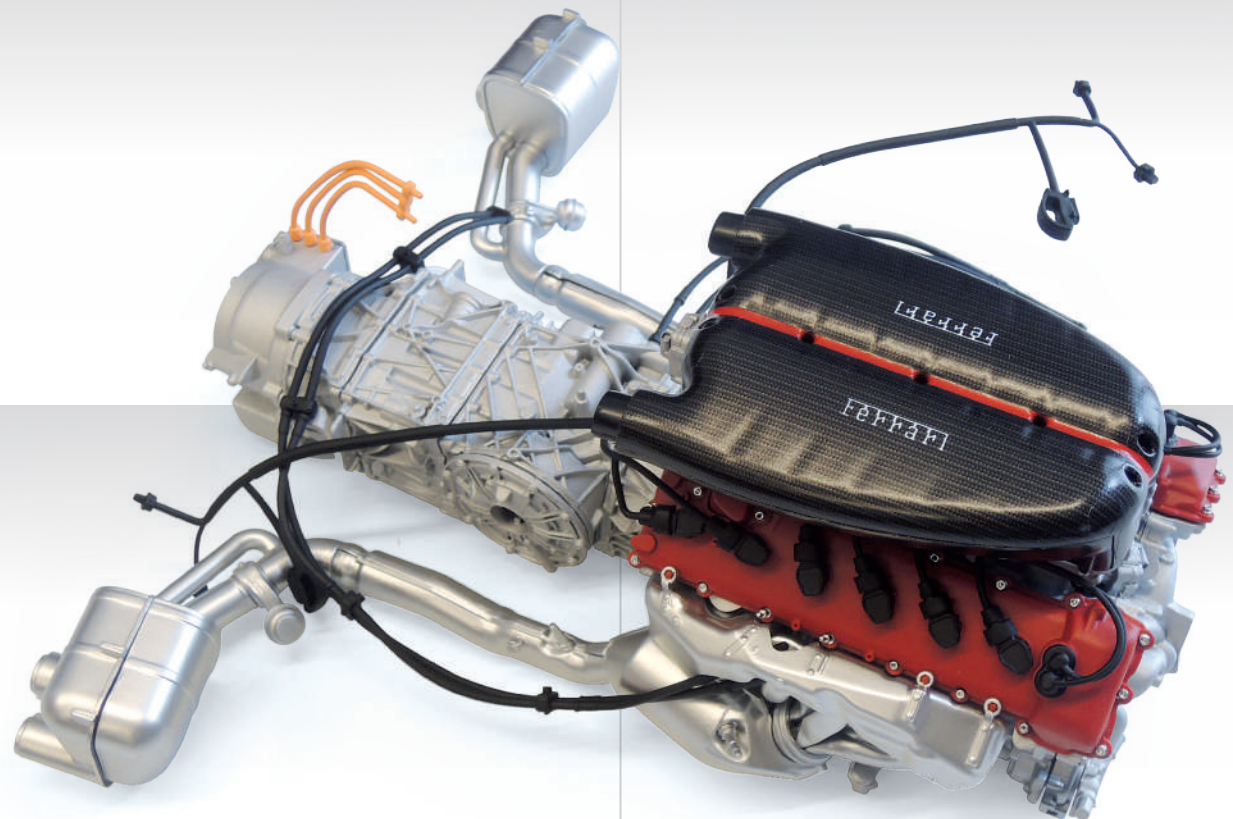



# STAGE 40 THE REAR FRAME

THE NUMEROUS COMPONENTS THAT MAKE UP THE LAFERRARI'S COMBUSTION ENGINE ARE LOCATED INSIDE A STRUCTURE WITH TWO SPECIAL HEAT-RESISTANT WALLS.

## PARTS LIST

NO.	PART	QUANTITY	MATERIAL
1	Rear frame	1	Metal
2	Right engine compartment wall	1	ABS
3	Left engine compartment wall	1	ABS
4	Rear frame bracket	1	ABS
5	Screw type B	3	Metal
6	Screw type D	2	Metal
7	Screw type H	4	Metal

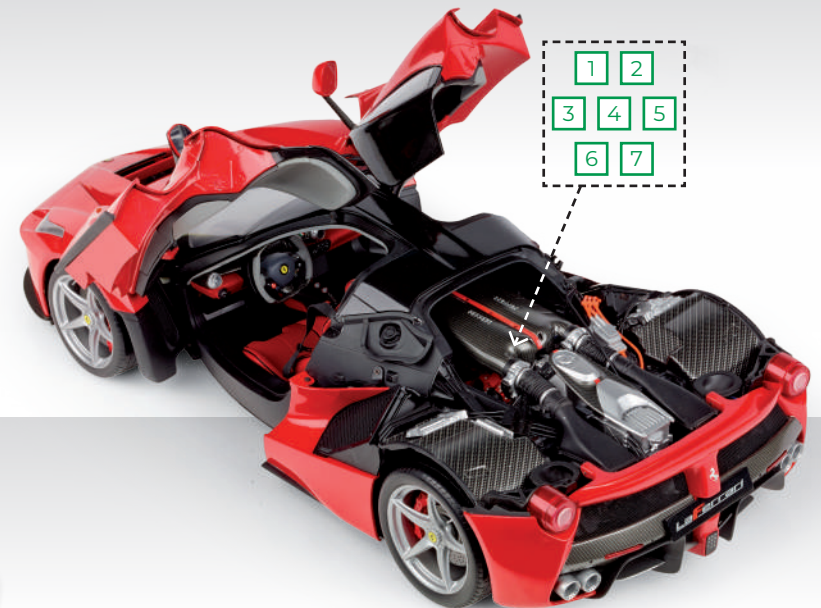
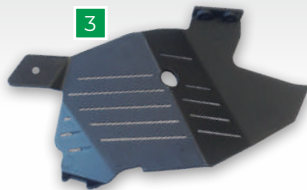
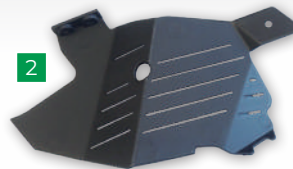



## STEP 1

Fit the right (2) and left (3) engine compartment walls into the rear frame (1), then secure each in place using a type D screw (6) and two type H (7) screws.

Right engine compartment wall

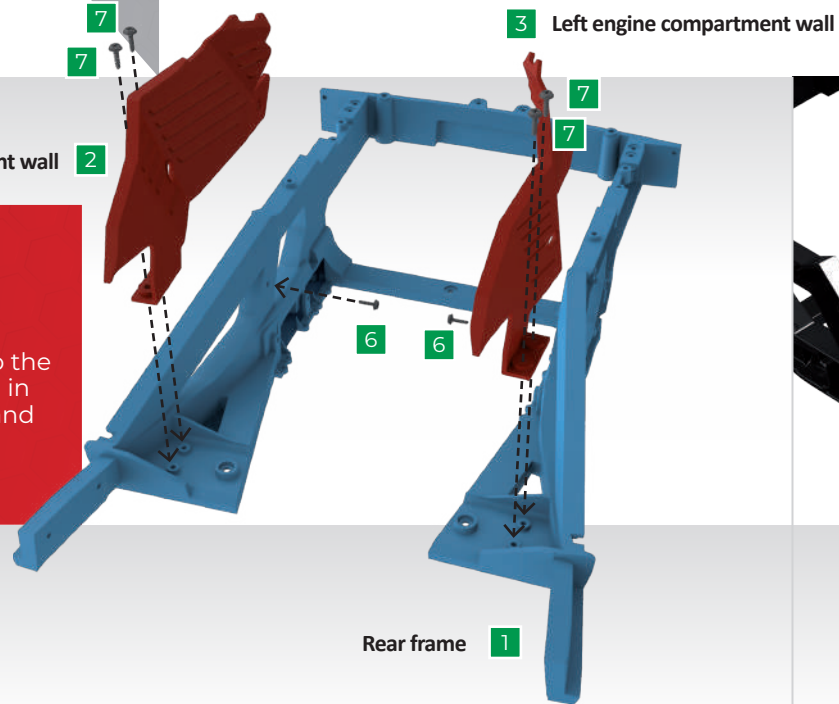

## STEP 2

Place the engine assembly into the frame (1). The exhaust pipes can be swivelled on the joint and be fed through the frame. Once in place, secure the engine using three type B screws (5).

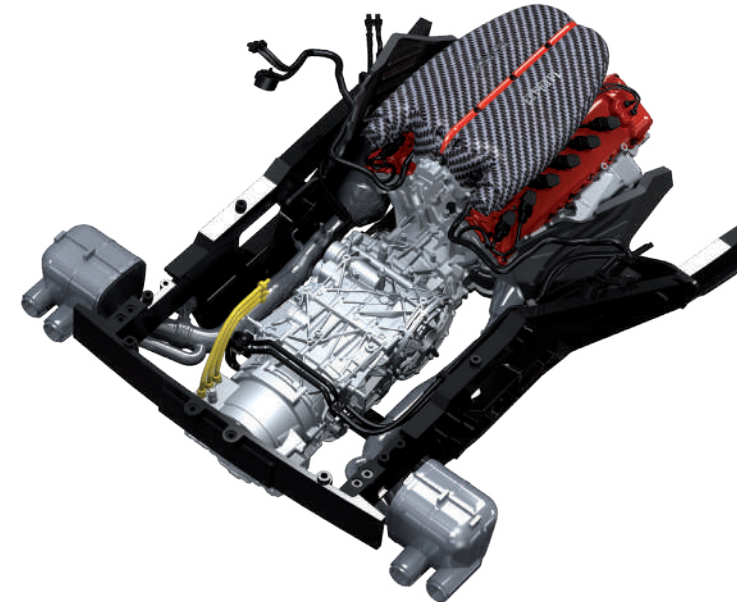
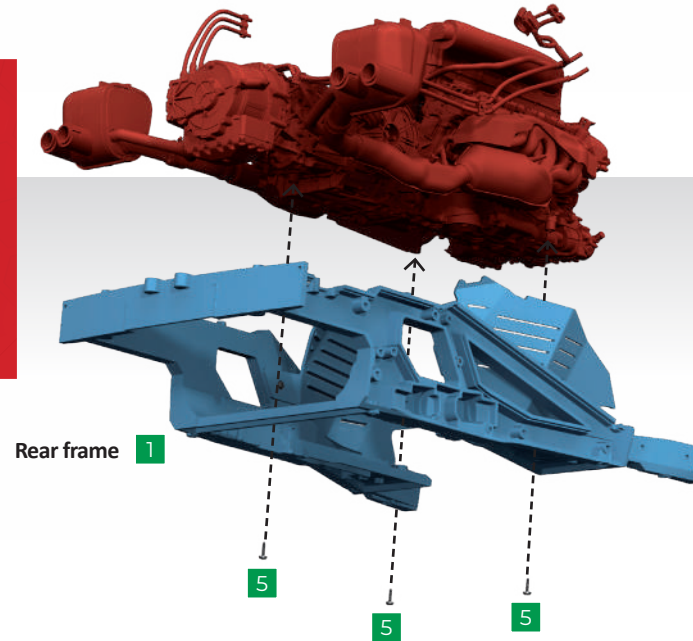

### STEP 3

Orient the rear frame bracket as shown then press-fit it on top of the rear frame.

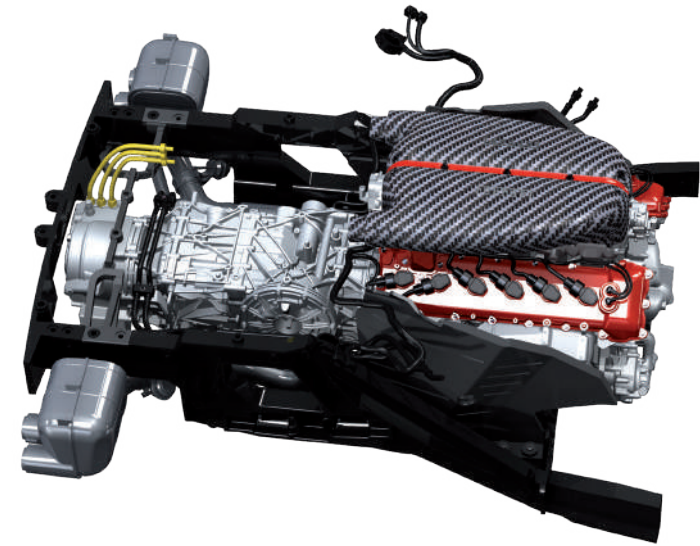
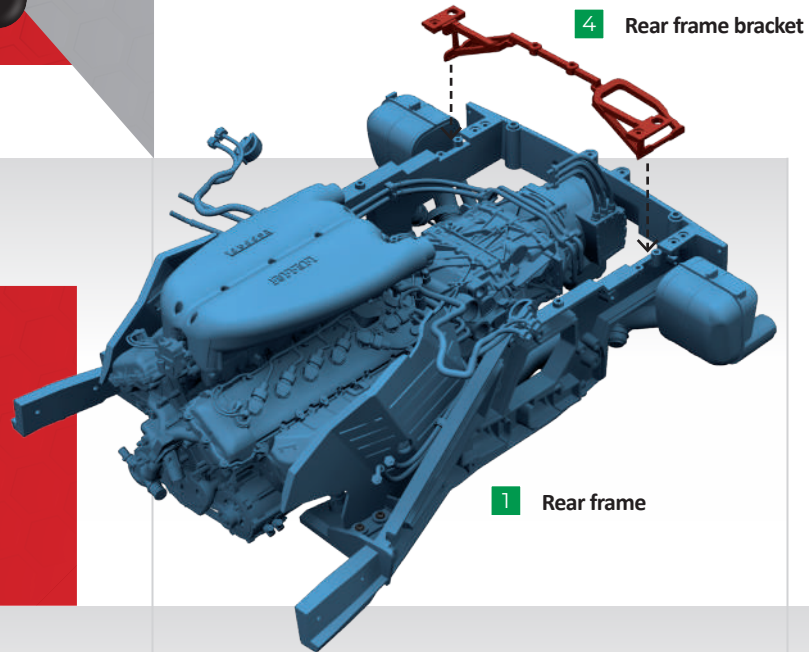

### STAGE COMPLETE

The engine of your 1:8 scale LaFerrari is secured inside the rear frame, making it easier to store.

