



# FDNY®

## FIRE TRUCK TOWER LADDER 9



# Pack 03

## BUILD INSTRUCTIONS

**STAGE 17: JUMP SEAT & FRONT RIGHT LIGHT CLUSTER**

**STAGE 18: FRONT LEFT CAB DOOR & CREW SEAT**

**STAGE 19: COMPONENTS FOR THE DASHBOARD & ROOF**

**STAGE 20: JUMP SEAT, CAB EQUIPMENT & FRONT LEFT LIGHT CLUSTER**

**STAGE 21: MAIN CAB BODY & DETAILS, INSTALLING THE REAR CAB DOORS AND CAB ROOF**

**STAGE 22: ASSEMBLE & FIT THE FRONT LEFT WHEEL**

**STAGE 23: FITTING A CREW SEAT, INSTALLING THE MAIN CIRCUIT BOARD, CONNECTING THE DASHBOARD & LIGHTS, AND FITTING THE FRONT CAB DOORS**

## Advice from the experts

---

 **Please keep ALL unused screws as they will be required in a later stage.**

Please make sure you don't mix up the screws. They look quite similar, but the threads do vary slightly. Using the wrong screws may damage the parts.

When securing parts together using multiple screws, fit each screw loosely to ensure all the parts are correctly aligned before gently tightening them firmly, but not overtight, in the order in which you placed them.

The screwdriver can be magnetized by stroking it with a magnet (fridge magnet, etc.) enabling it to hold the screws and make assembly easier.

If a screw is tight going into a metal part, do not force it as you may shear the head off. Remove it and put a tiny smear of Vaseline, soap or light oil on the thread. That will lubricate it and make it easier to drive home.

During the course of this build, you will receive many pieces that you will assemble immediately – following the instructions in the corresponding stage – and other pieces that you should store safely to one side, for use in future assembly stages.

Left and Right! When building your fire truck, the left or right hand side refers to each side as you are sitting in the cab.



**WARNING:** Some parts are assembled using magnets. These magnets can cause serious injury if they are swallowed. Keep away from children. If you suspect a magnet has been swallowed, seek medical help straight away.

# Stage 17: Jump Seat & Front Right Light Cluster

The first rearward-facing seat, known as the jump seat and typically used by passengers rather than crew, is fitted in this first stage of Pack 03. You'll also fit more accessories to the cab and assemble a front light cluster.



## STAGE 17 PARTS LIST

Name
Light cluster PCB
Jump seat
Front right light cluster
Seat support
Windshield wiper
Flood light
Portable radio
Flashlight
Portable radio charger
Turn signal lens (R)
LED diffuser x3
Headlight lens x2
Type H screws x2
Type M screws x2

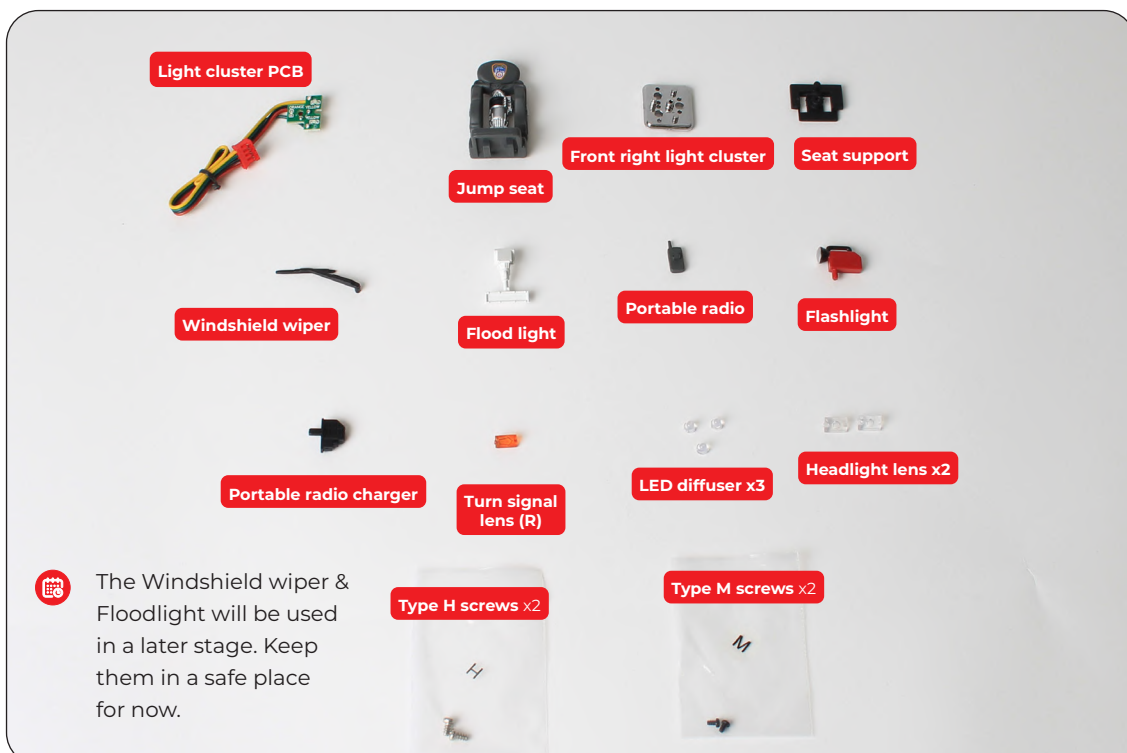

# Stage 17: Jump Seat & Front Right Light Cluster

## STEP 1



### ASSEMBLING THE JUMP SEAT

Apply a little superglue to the underside of the seat, avoiding the two rectangular tabs. Take the seat support and align it with the seat as shown. Check you have the seat support in the correct orientation with the peg aligned with the back of the seat.



Firmly press the two parts together.

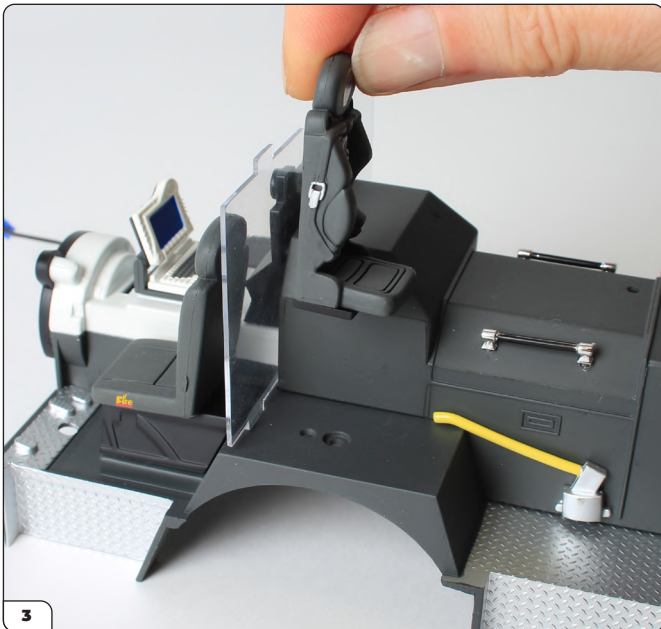

Align the peg and screw holes on the seat support with the corresponding holes in the cab floor, just behind the engineer's seat.

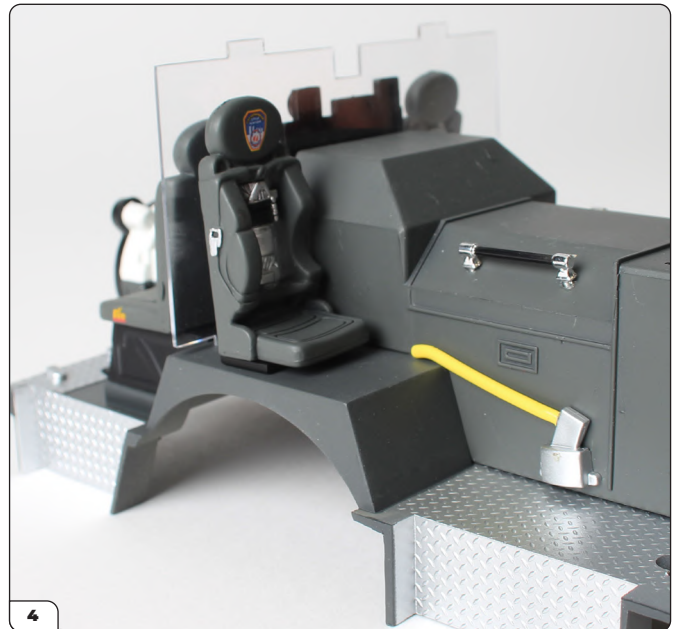

Press the jump seat firmly into position.

# Stage 17: Jump Seat & Front Right Light Cluster

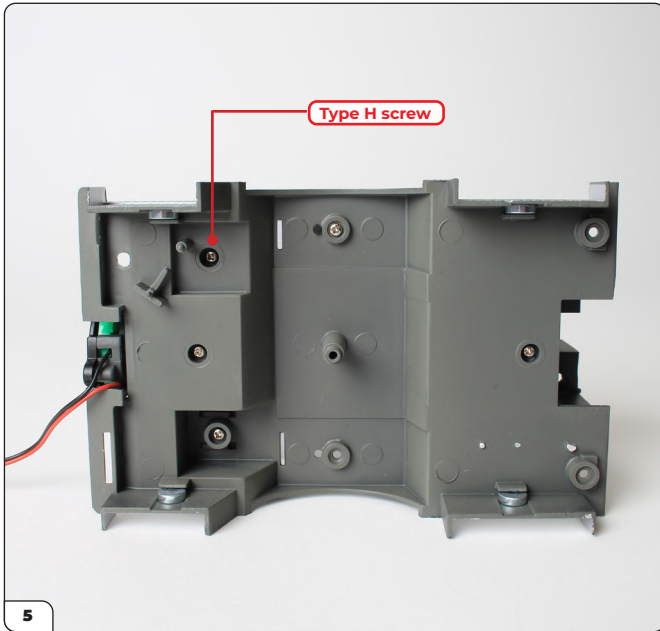

Holding the seat in position, turn the cab floor assembly over and fix it in place from the underside with a type H screw.

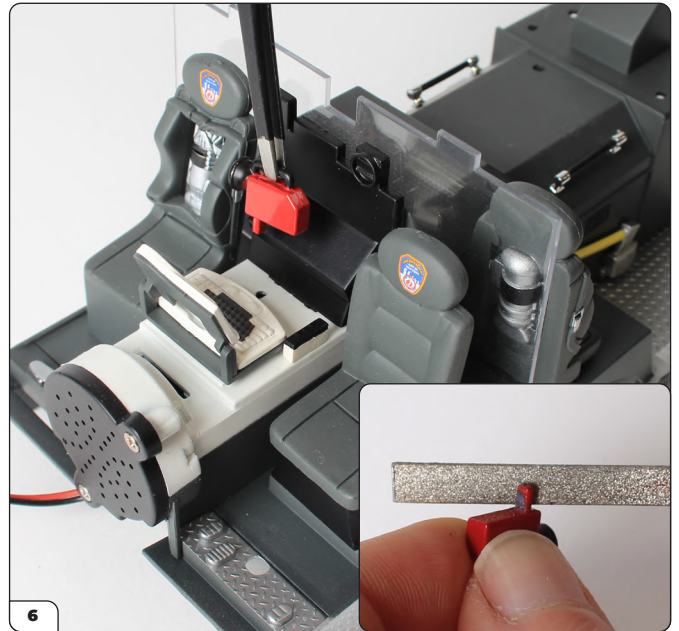

## ATTACHING THE FLASHLIGHT

Align the D-shaped pin on the flashlight with the hole in the center console, just to the rear of the MDT keyboard. If the pin won't fit, try filing off a bit of excess paint (inset).

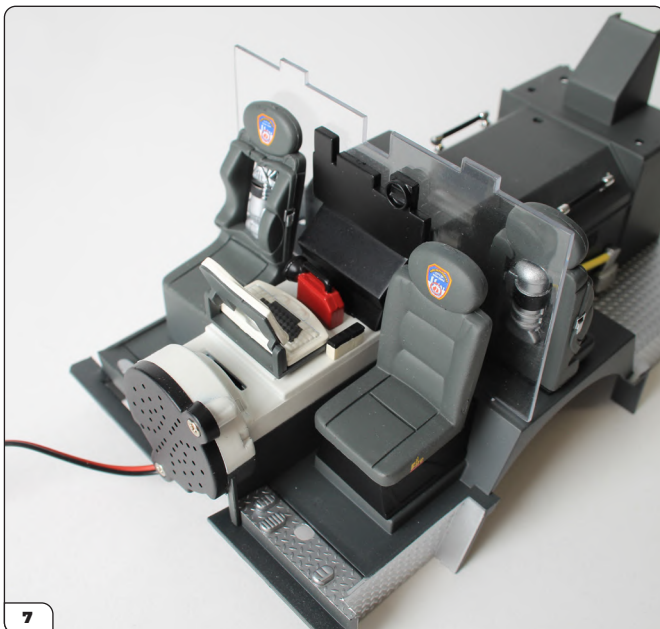

Push the flashlight firmly in place.

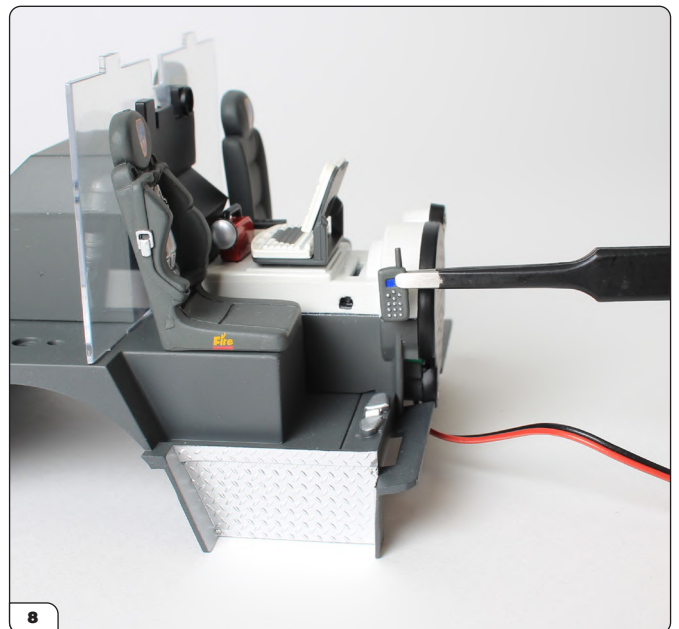

## ATTACHING THE PORTABLE RADIO

Align the D-shaped pin on the back of the portable radio with the D-shaped hole in the side of the center console, in front of the captain's seat.

# Stage 17: Jump Seat & Front Right Light Cluster

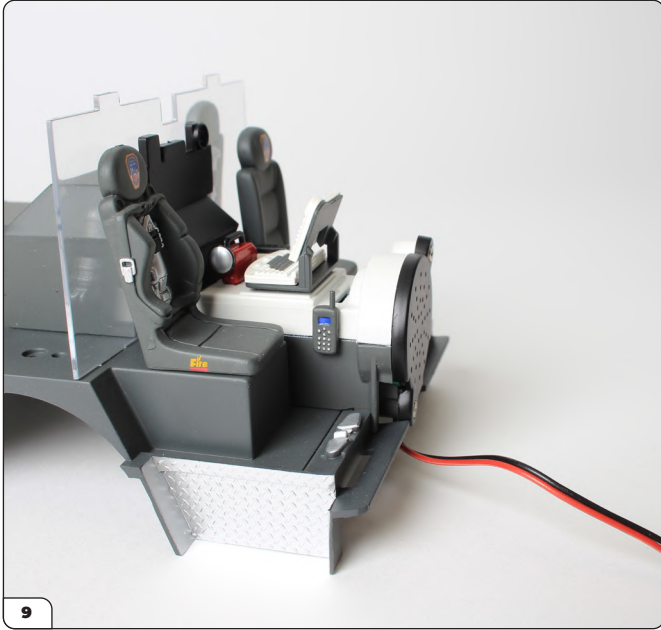

9  
Push firmly to fit.

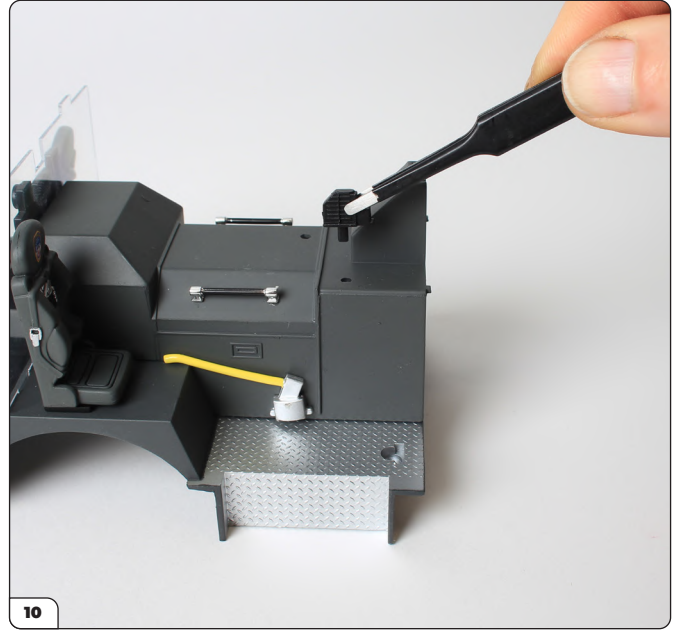

10  
**ATTACHING THE BATTERY CHARGER**  
Align the pin on the portable radio charger with the hole in the center console to the rear of the cab. This is a D-shaped fixing to ensure the correct fit. See also picture 11.

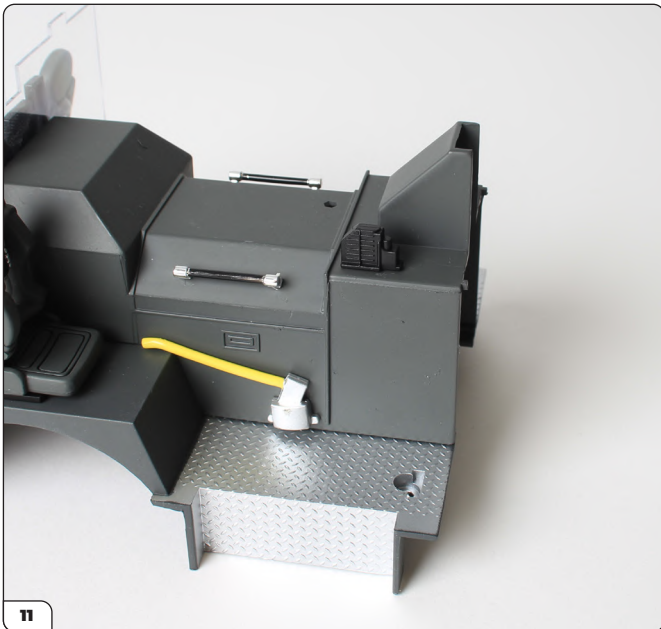

11  
Push firmly to fit. You can glue this with superglue if necessary.



12  
**ASSEMBLING THE FRONT RIGHT LIGHT CLUSTER**  
Take one of the LED diffusers, holding it with the domed side facing outwards, and align with the single hole between two pins on the reverse side of the front light cluster.

## Stage 17: Jump Seat & Front Right Light Cluster



Push the diffuser into position so that the domed side projects through to the other side.

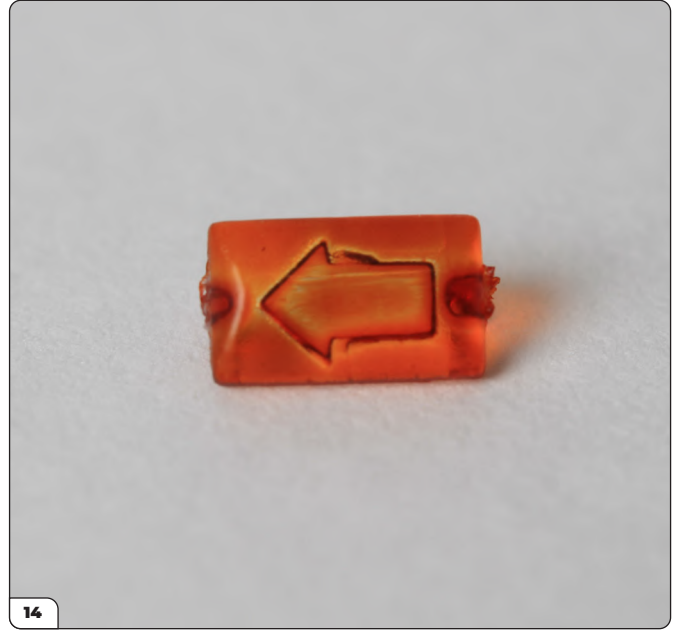

Take the turn signal lens (R) and note the directional arrow.



Place the turn signal lens over the diffuser fixed in picture 13, checking that the arrow is facing the direction shown. Push firmly to fix in position.



Push firmly to fix in position.

## Stage 17: Jump Seat & Front Right Light Cluster



17 Take another diffuser and push it into one of the lower pair of holes at the rear side of the front light cluster.



18 Repeat to fix the third diffuser to the front light cluster.



19 Two more diffusers have been installed on the front light cluster.



20 Turn the front light cluster over so the front side faces up and align a headlight lens over the projecting diffuser.



## Stage 17: Jump Seat & Front Right Light Cluster



Push the headlight lens firmly into position.



Repeat to install the second headlight lens over the remaining diffuser.



Two headlights have now been installed.

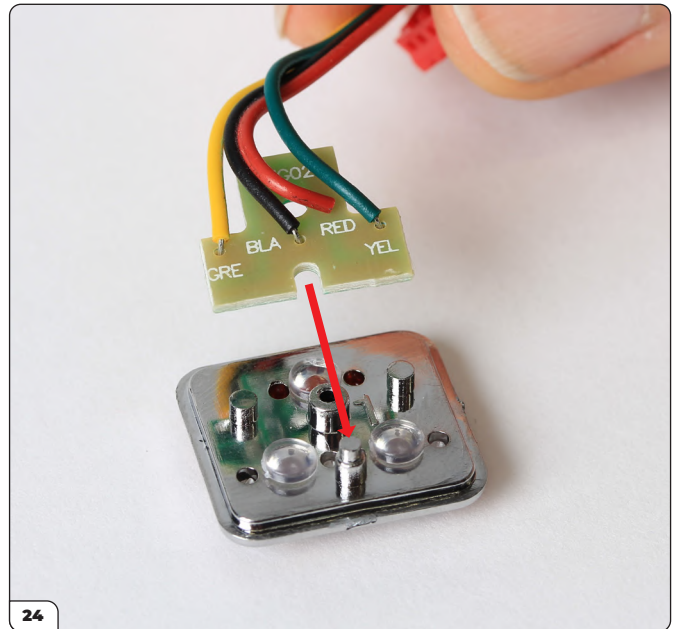

With the reverse side of the front light cluster facing up, line up the light cluster PCB (Printed Circuit Board) so that the U-shaped cut out is in line with the single pin (see picture 25). Check that the circuit board is the correct way up, as shown in the picture.

## Stage 17: Jump Seat & Front Right Light Cluster

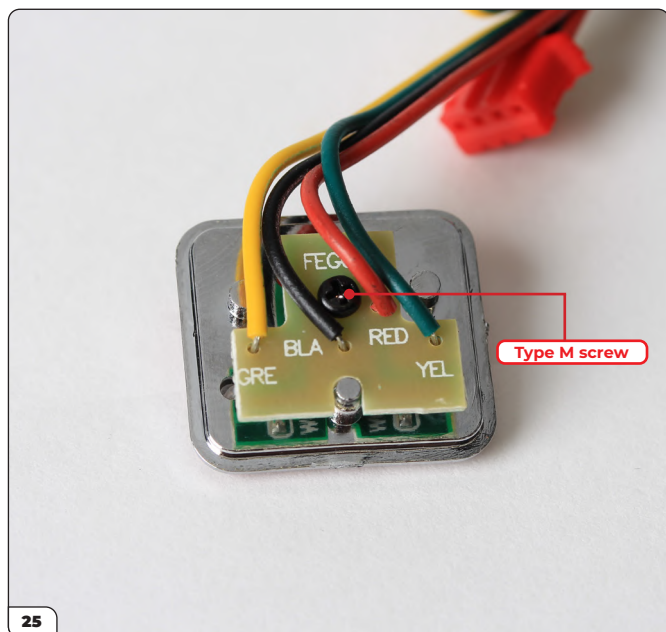

Press the circuit board firmly into place and fix in position with a type M screw.

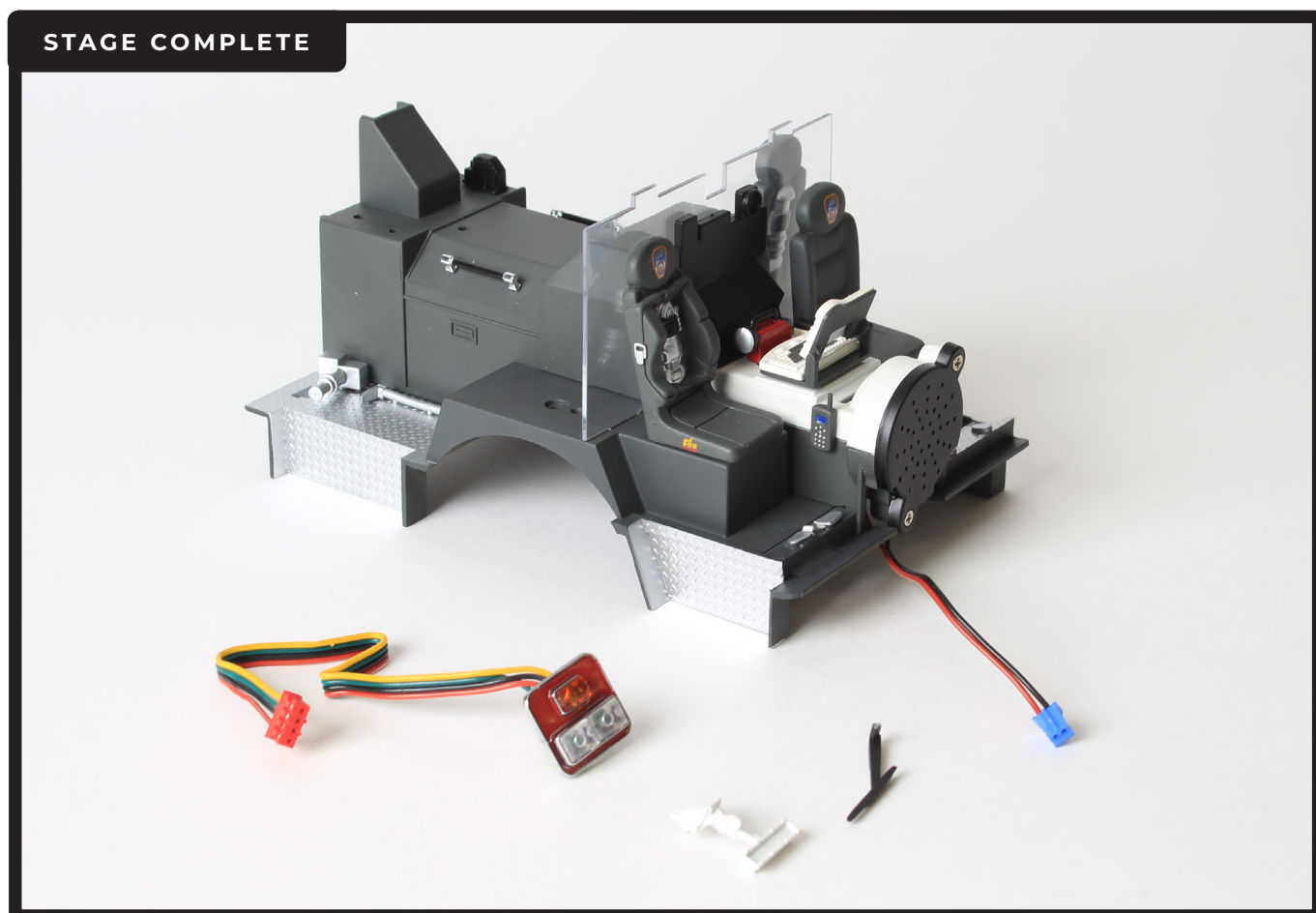

## Stage 18: Front Left Cab Door & Crew Seat

In this next stage, you'll assemble a seat used by the crew, and another cab door.



### STAGE 18 PARTS LIST

Name
Outer door panel
Inner cab panel
Inner door panel
Outer door handle
Window winder
Gear
Crew seat
Seat support
Type H screws x2

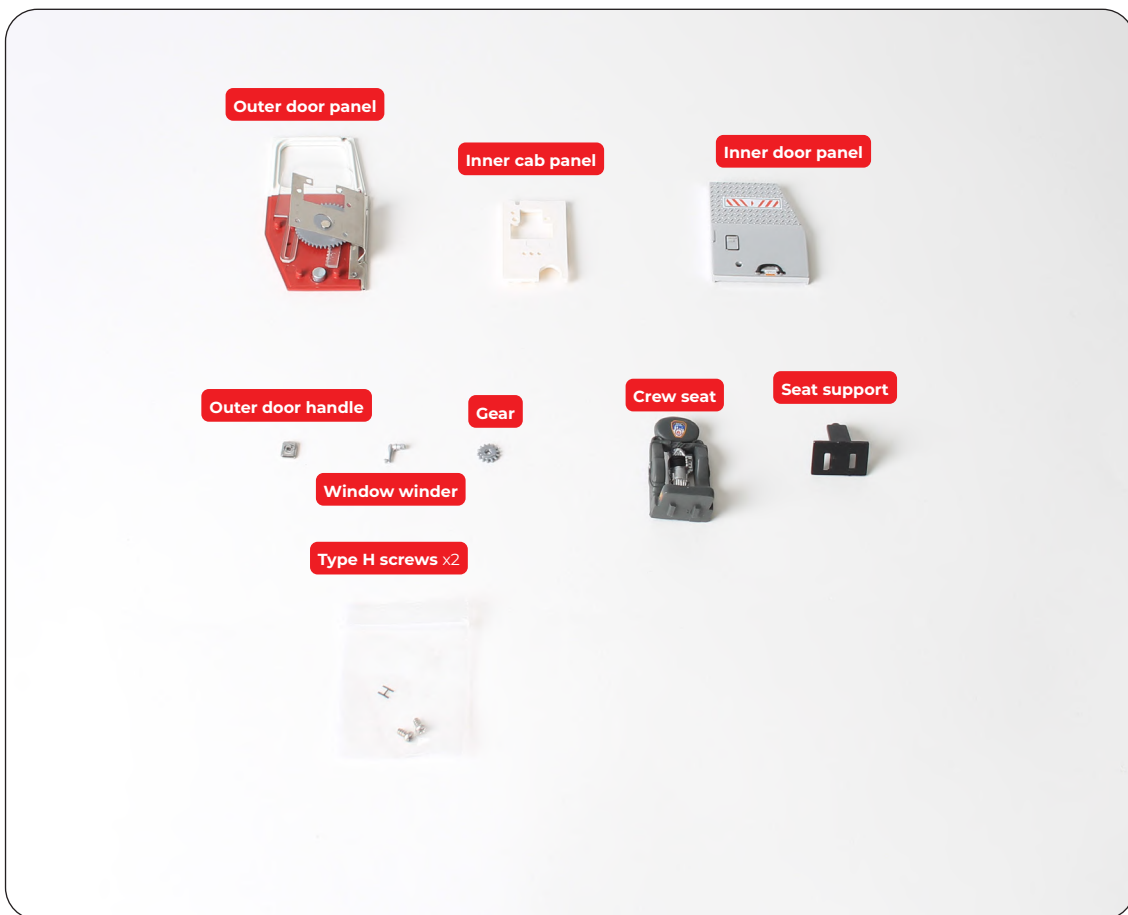

# Stage 18: Front Left Cab Door & Crew Seat

## STEP 1

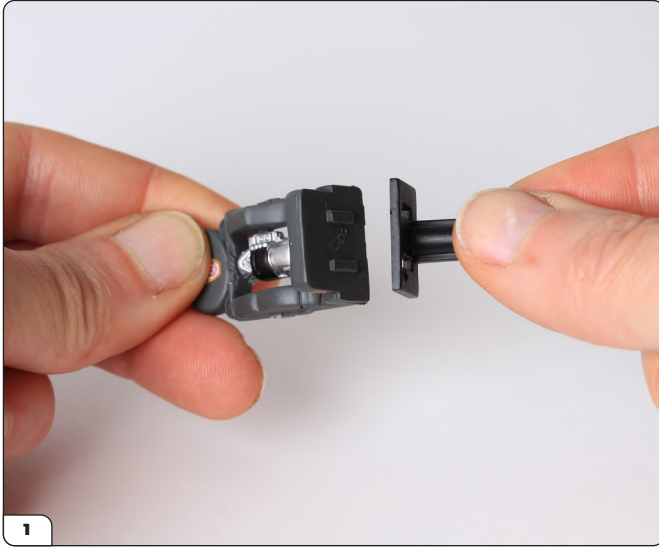

### ASSEMBLING THE SEAT

Apply a little superglue to the underside of the seat, avoiding the two rectangular tabs. Take the seat support and align it with the seat as shown. Check you have the seat support in the correct orientation with the vertical post aligned with the back of the seat.

Firmly press the two parts together.

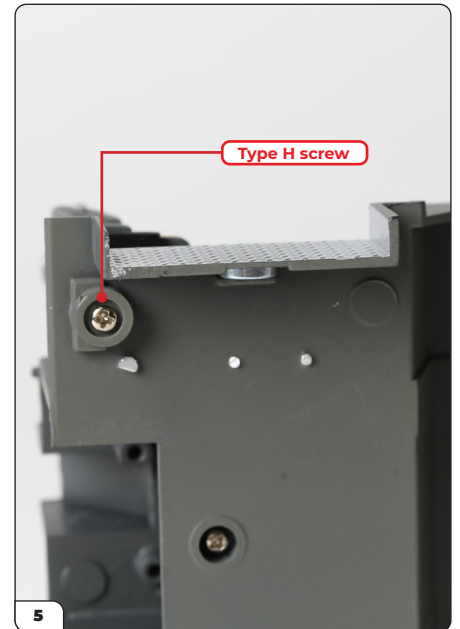

Line up the post of the seat support with the post-shaped hole on the rear right-hand side of the cab floor.

Push the seat firmly into place.

Secure the seat from the underside of the cab floor using a type H screw.

## Stage 18: Front Left Cab Door & Crew Seat

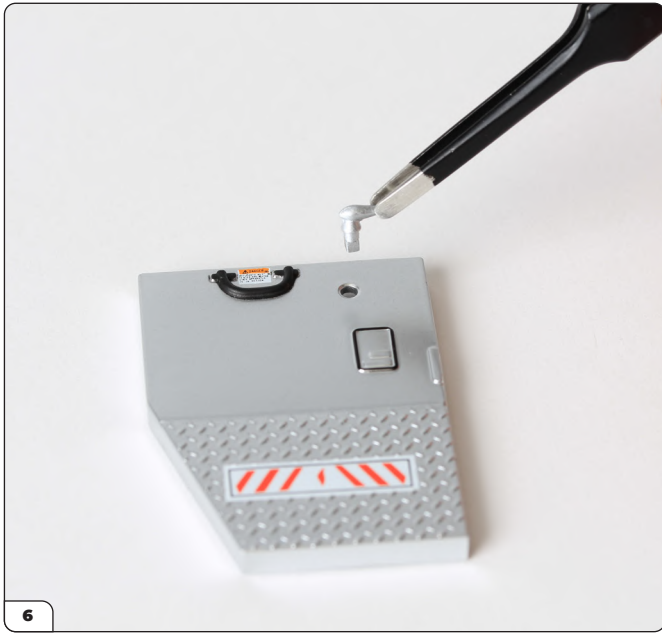

### ASSEMBLING THE FRONT LEFT CAB DOOR

Push the handle into the hole in the inner door panel.



Press firmly until you feel it click into place.

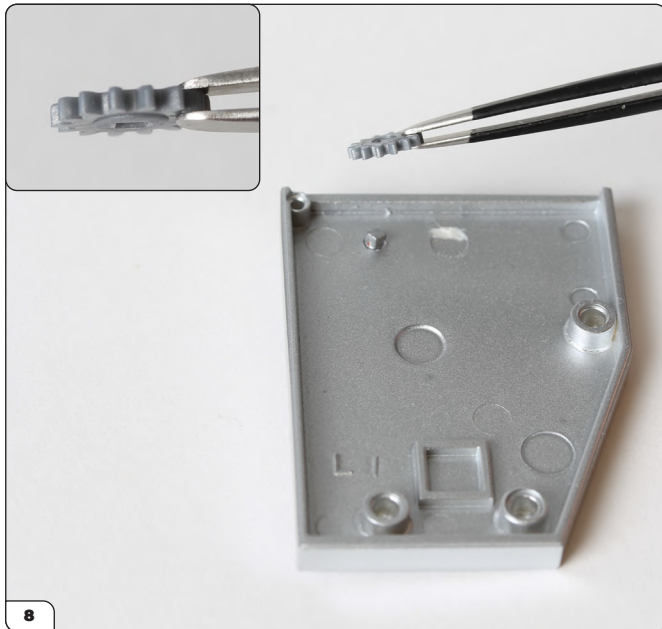

Check that you have the gear the correct way up – the slightly raised surface faces down (inset). Push it onto the square peg on the inside of the inner door panel.



The gear has been correctly fitted.

## Stage 18: Front Left Cab Door & Crew Seat

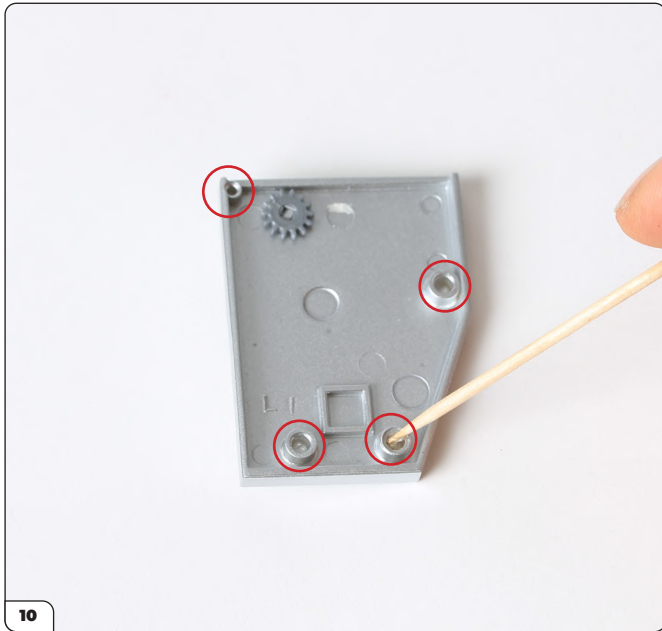

Apply a drop of superglue to each of the four peg holes, as indicated (circled).

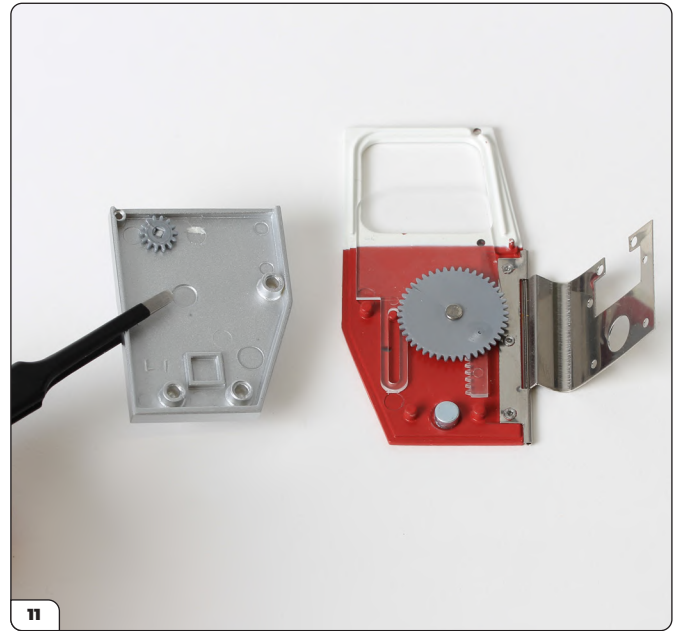

Align the four peg holes on the inner door panel with the four pegs of the inner side of the outer door panel before pressing the parts firmly together.



The inner door panel has been fixed to the outer door panel.

## Stage 18: Front Left Cab Door & Crew Seat



Take the inner cab panel and note that there are four fixing pins that correspond with four small holes on the cab door hinge (circled). It might be easier if you test fit the parts first.

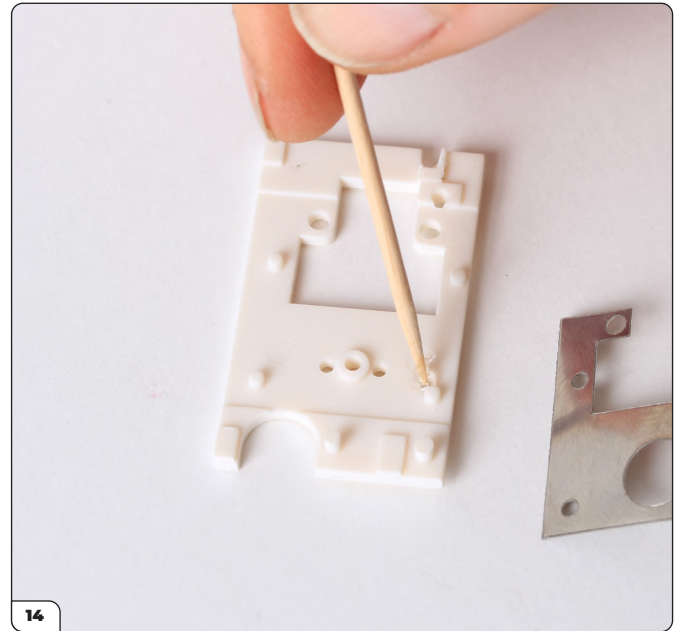

Apply glue around the fixing pins that will push through the hinge.



Align the four holes on the door hinge with the four pins on the inner cab panel. Check that the raised screw hole (arrow) is positioned centrally in the corresponding hole in the hinge before firmly pressing the hinge and cab panel together.



Apply a drop of superglue to the recess for the door handle.

# Stage 18: Front Left Cab Door & Crew Seat



Press the handle into position. This is a D-shaped fitting to ensure the correct fit.



This shows the handle correctly fitted.

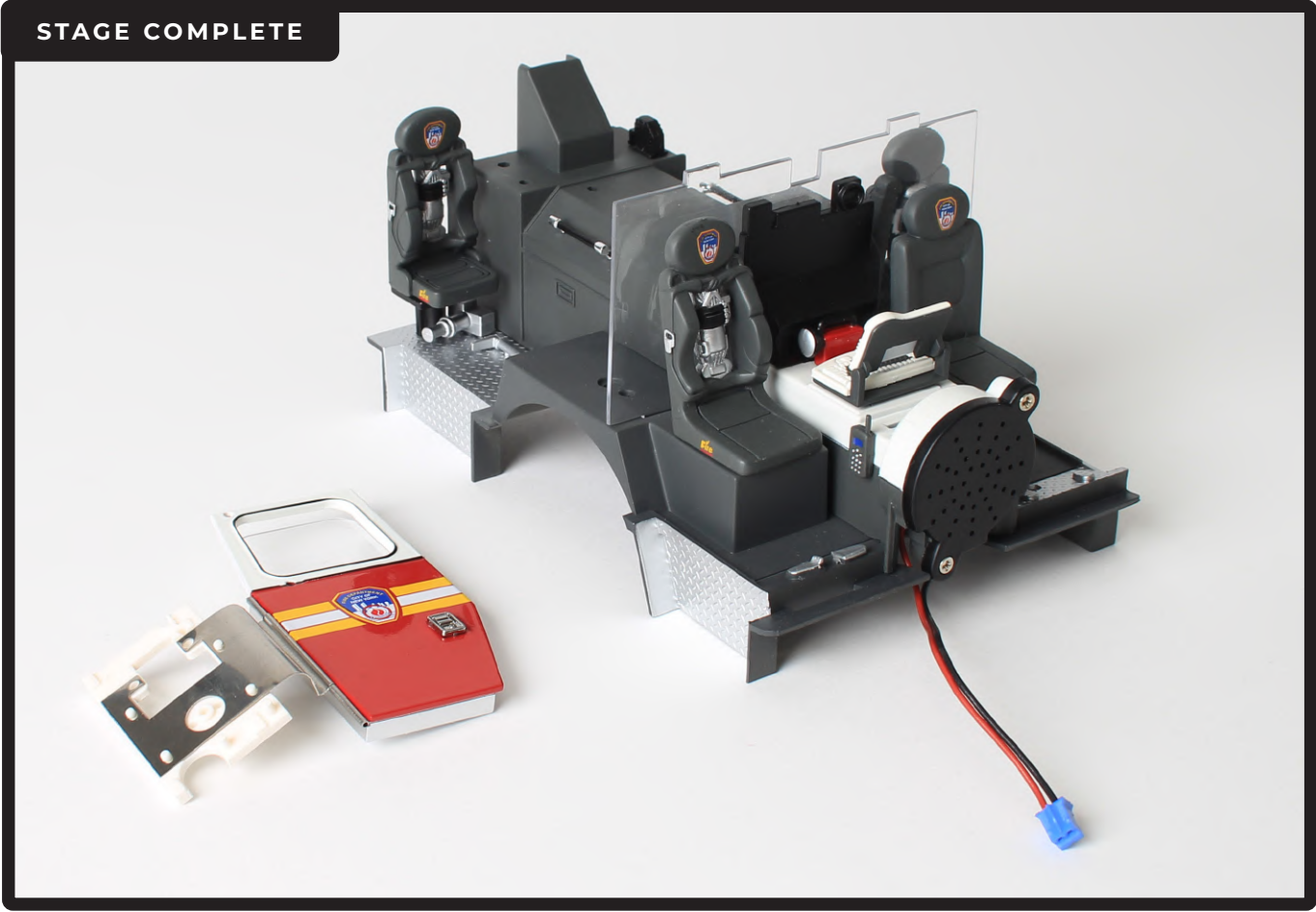



# Stage 19: Components for the Dashboard & Roof

Now you'll start to assemble the dashboard, adding PCBs that will operate the siren, front lights, and horn. You'll also add a few more details to the cab roof.



## STAGE 19 PARTS LIST

Name
Dashboard kick panel
Dashboard
Horn/turn signal PCB
Headlights/emergency lights & siren PCB
Steering column
Circuit board cover
Map light
GPS display
Turn signal button
Roof component d
Roof component c
Radio antenna
Dashboard storage box
Push button x4
Type E screws x2

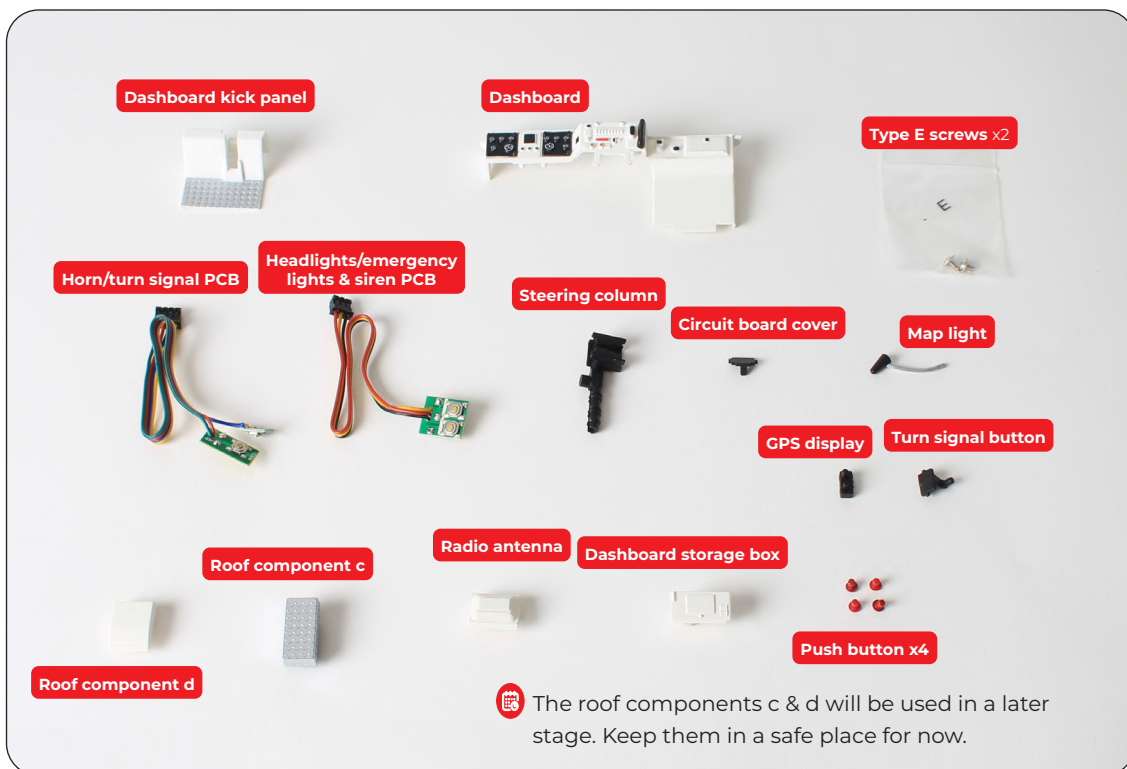

# Stage 19: Components for the Dashboard & Roof

## STEP 1

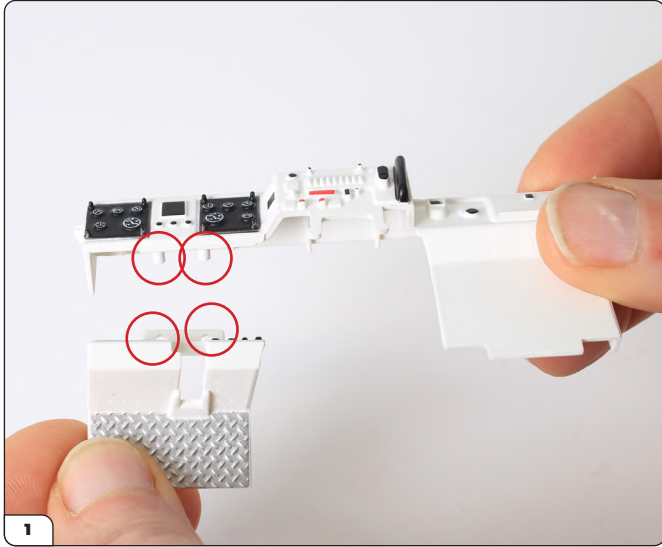

### ASSEMBLING THE DASHBOARD

Align the two pins on the dashboard with the two holes in the dashboard kick panel (circled).

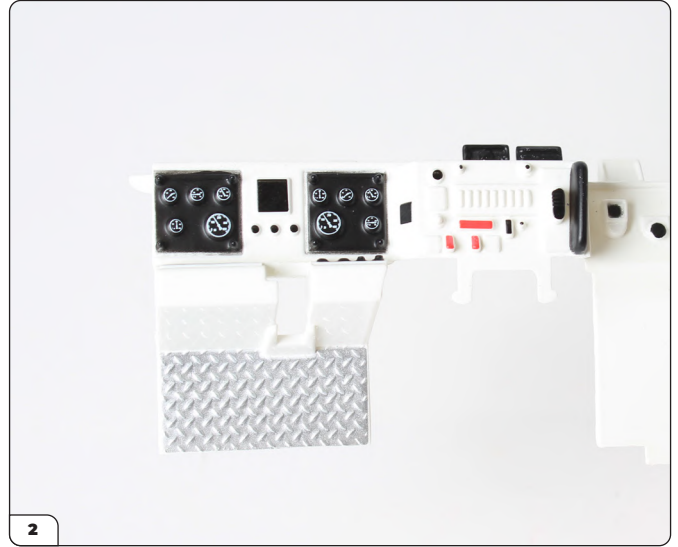

Push the pins firmly into the holes.



Flip the dashboard assembly over and check that the pins are projecting through to the underside.

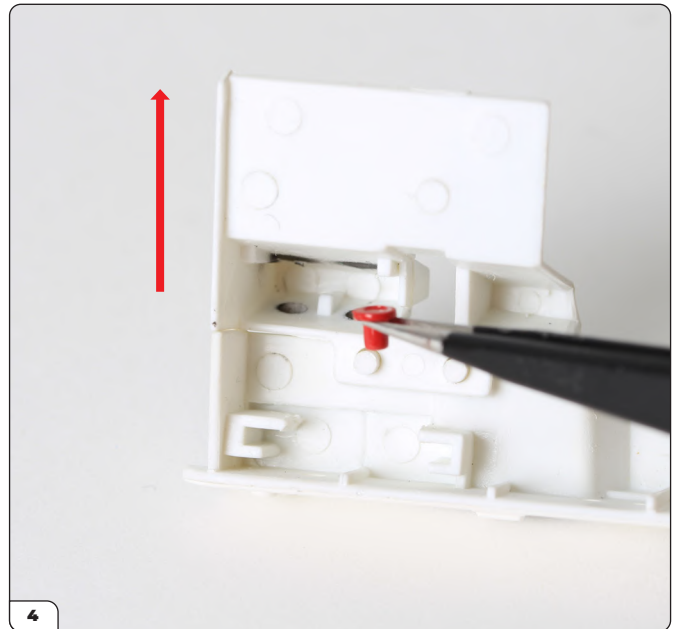

With the dashboard underside still facing you, position it so that the kick panel is uppermost (arrow). Grip one of the push buttons with tweezers and align it with the pair of holes on the kick panel in the orientation shown.

## Stage 19: Components for the Dashboard & Roof

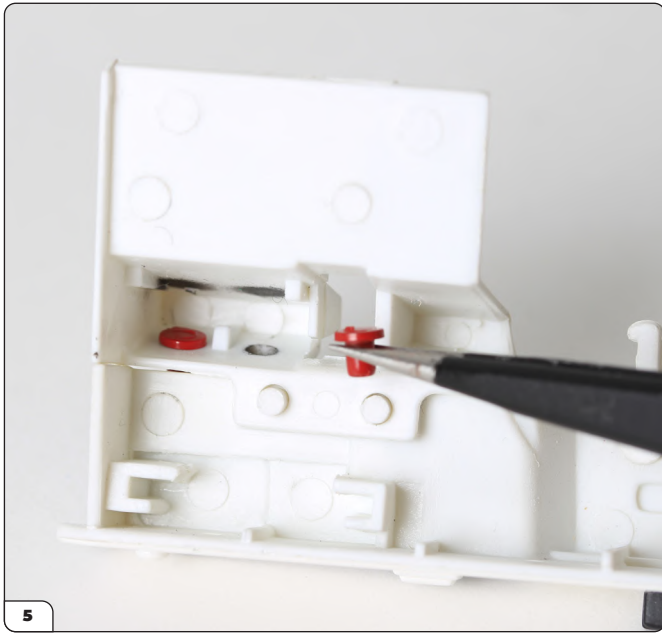

5  
Insert the push button into one of the holes and then repeat to position another push button in the hole alongside.



6  
Two push buttons are now correctly fitted. Once connected, these two push buttons will operate the siren and front lights.

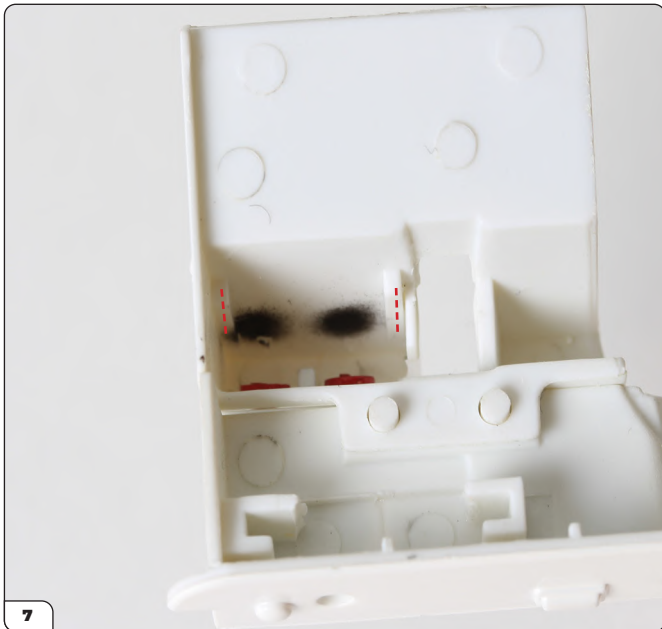

### FIXING THE CIRCUIT BOARD

7  
Test fit the PCB (printed circuit board) with red, yellow & black cables above the two push buttons installed in 4-6. The flat side of the board rests on the two raised supports (dotted line, also see picture 9). When you are happy with the fit, apply a little superglue to the two ledges.

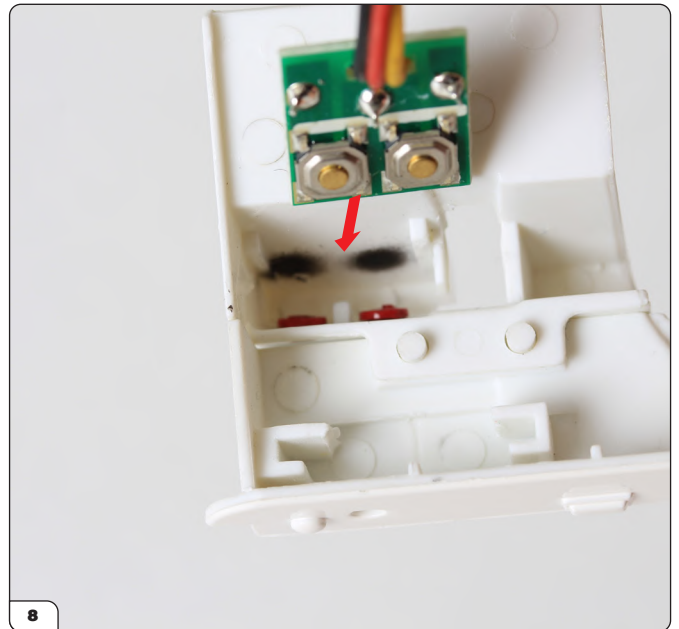

8  
Insert the PCB with the contact points facing down towards the push buttons.

## Stage 19: Components for the Dashboard & Roof

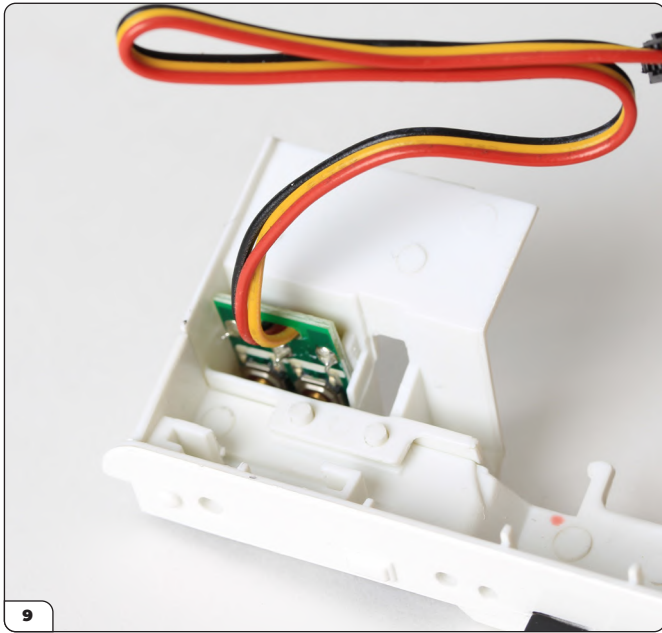

Press the PCB firmly to glue into position. When you press the buttons you should be able to feel the switches on the circuit board working.

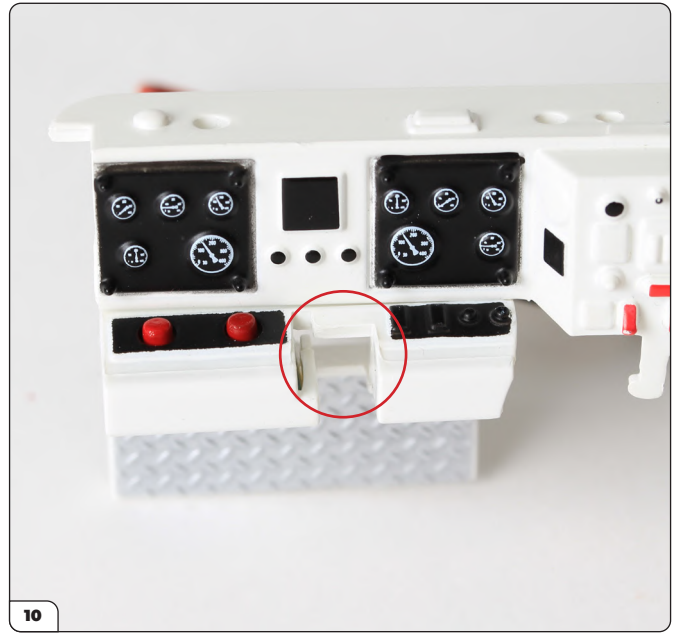

With the dashboard facing you, note that there is an opening to the right of the two push buttons (circled).

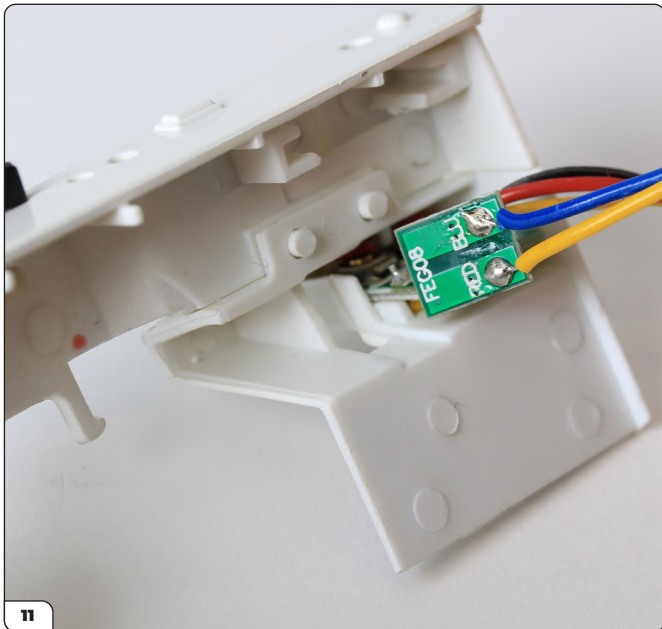

Take the horn/turn signal PCB. Insert the smaller circuit board with blue and yellow cables through the opening from the reverse side to the front side. The larger circuit board with red and green cables should remain on the reverse side. Note: the cables for the two boards can be separated by gently pulling them apart to allow for easier fitting.

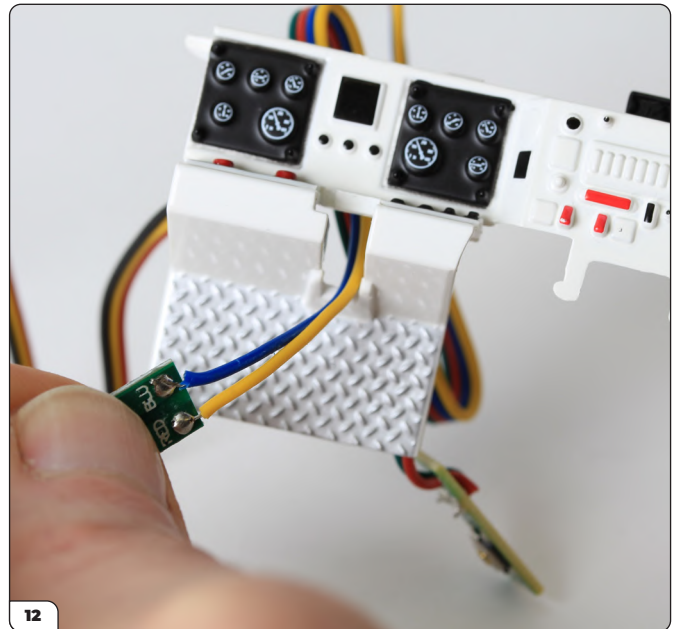

Pull the smaller circuit board through the opening, then put the assembly to one side while you assemble the steering column.

## Stage 19: Components for the Dashboard & Roof

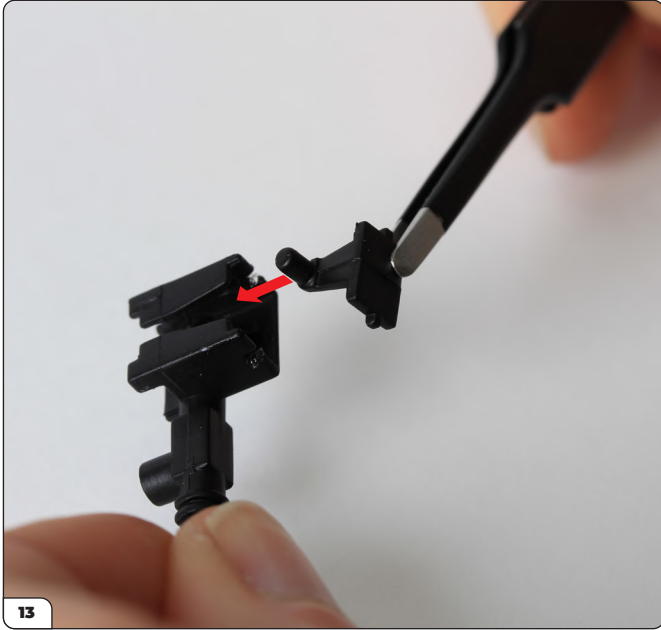

### ASSEMBLING THE STEERING COLUMN

Align the turn signal button with the steering column in the orientation shown.

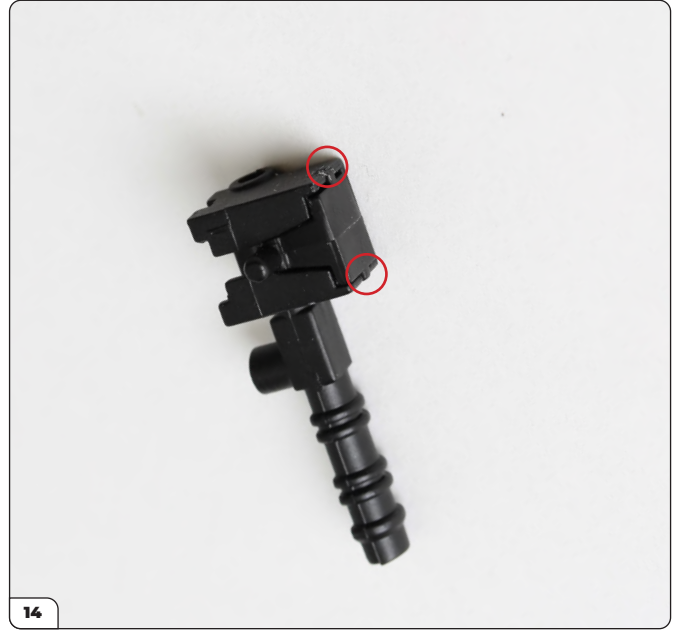

Push the button firmly into place on the steering column until the projecting tabs sit flush (circled). Add a drop of glue to each tab to hold in place.

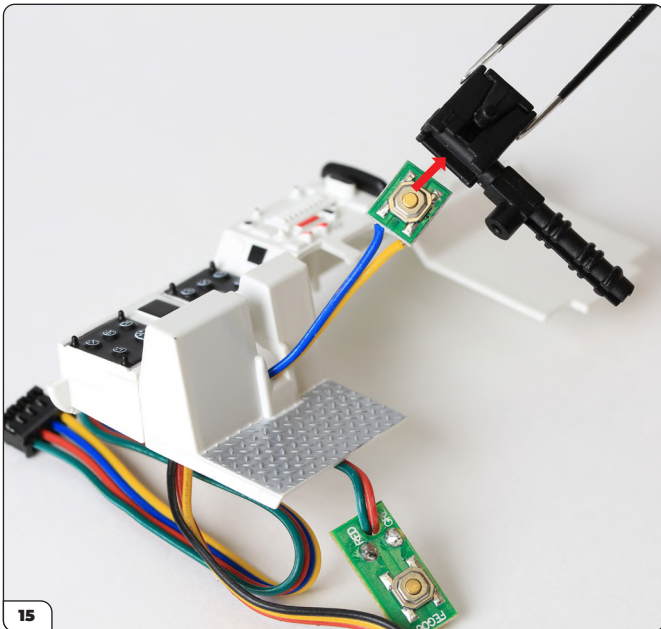

Align the smaller circuit board with the slot in the steering column, checking that the contact point faces outwards, towards the turn signal button.

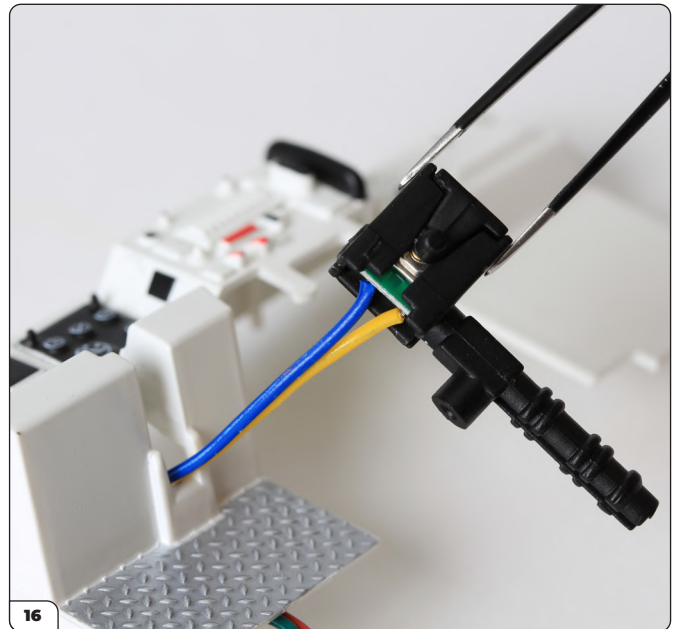

Firmly push the circuit board into the slot, checking that the contact point sits behind the projecting button. This button will operate the turn signals.

## Stage 19: Components for the Dashboard & Roof

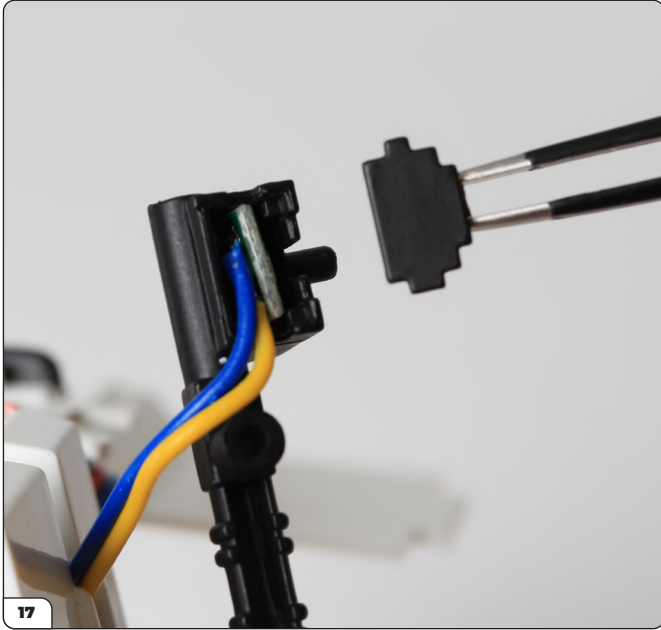

Carefully bend the cables downwards and backwards, away from the button. Holding the cables in place, align the circuit board cover in the orientation shown, ready to fit over the cables.

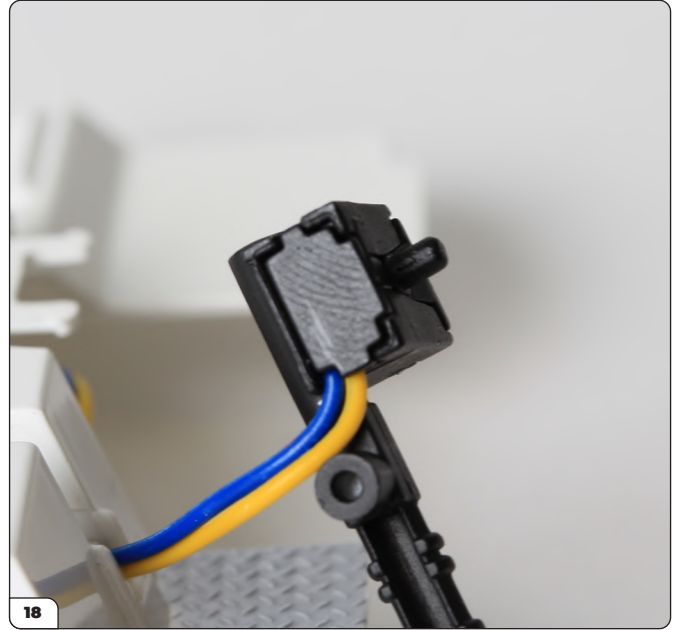

Press the circuit board cover firmly into place to secure everything together. Check that you can feel the click of the switch operating.

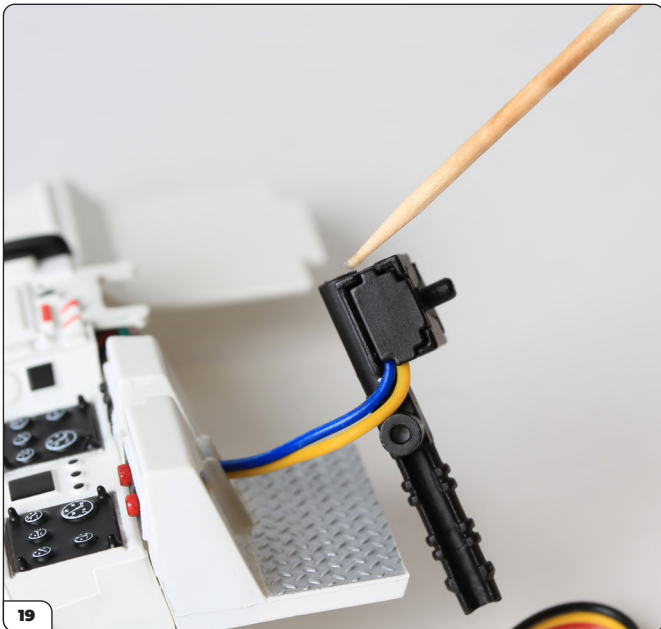

Apply a little glue to the tabs on the cover if necessary.

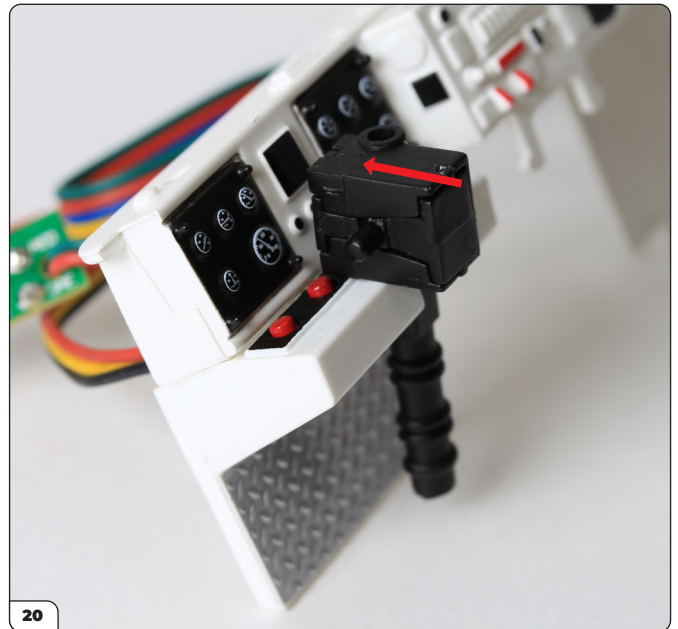

Feed the cables back through to the reverse side of the dashboard as you fit the steering column into the dashboard.

## Stage 19: Components for the Dashboard & Roof

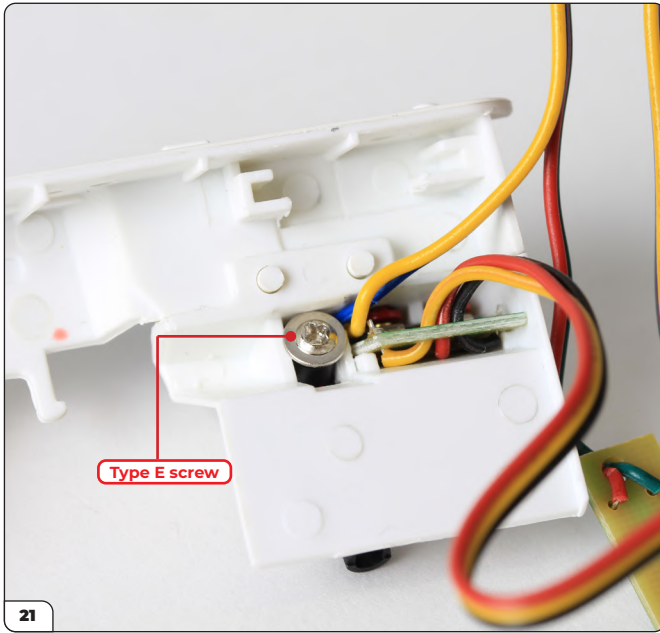

From the reverse side of the dashboard, secure the steering column in place by driving a type E screw into the raised screw hole on the steering column.

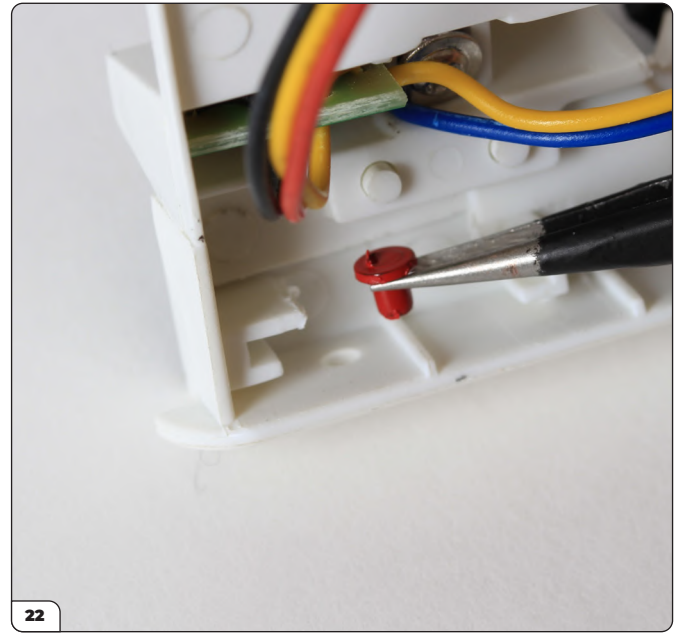

Place the dashboard so that the reverse side is facing you and the kick panel is uppermost. Using tweezers, align another push button with the hole below the circuit board installed in picture 9.

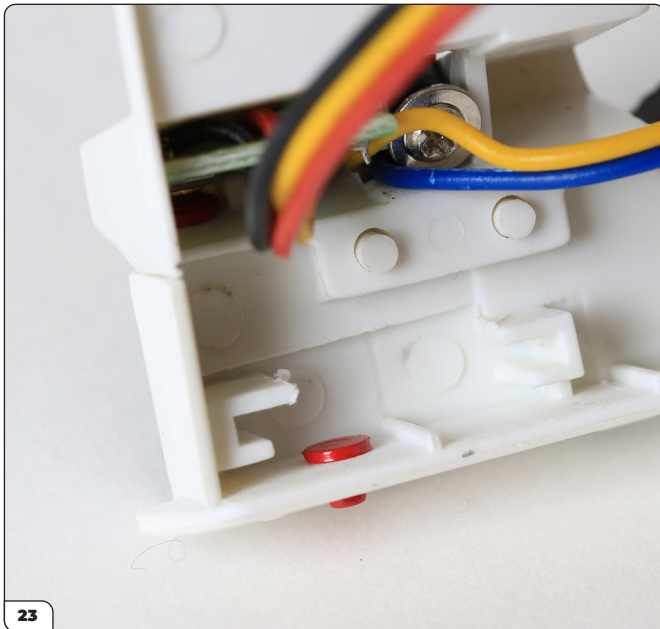

Press the stem of the button into the hole.

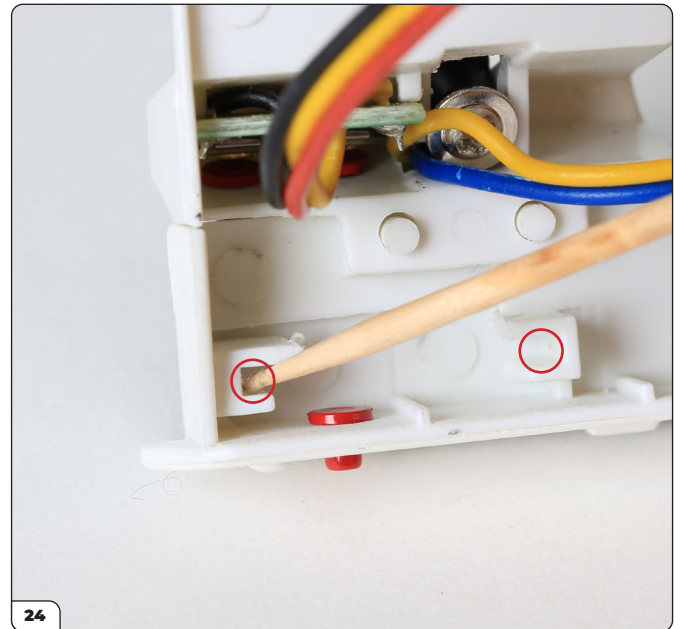

Apply a little glue along the channels either side of the push button.





## Stage 19: Components for the Dashboard & Roof

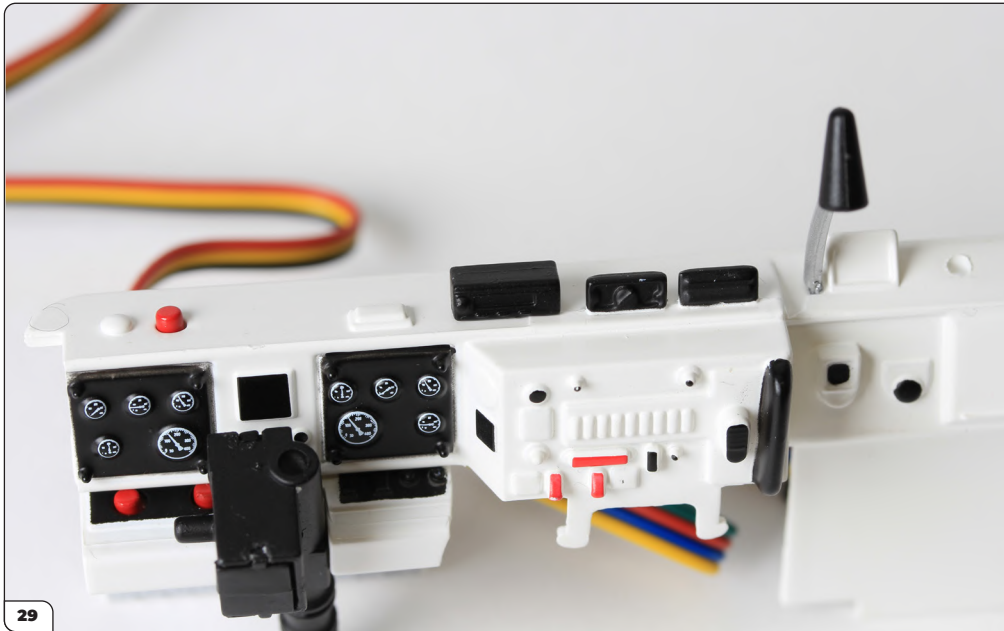

This shows how the dashboard should now look.



Fit the lugs on the dashboard storage box into the holes on the far right-hand side of the dashboard. Note: the two lugs are different sizes. Use a drop of superglue to secure in place.



Push firmly to fit.

## Stage 19: Components for the Dashboard & Roof

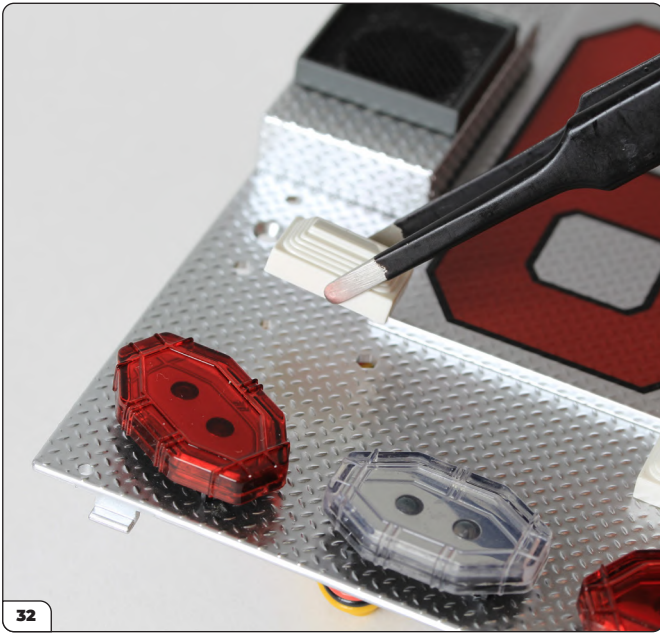

32

### ATTACHING THE RADIO ANTENNA TO THE CAB ROOF

Align the lugs on the radio antenna with the holes in the cab roof.  
Push firmly to fit.

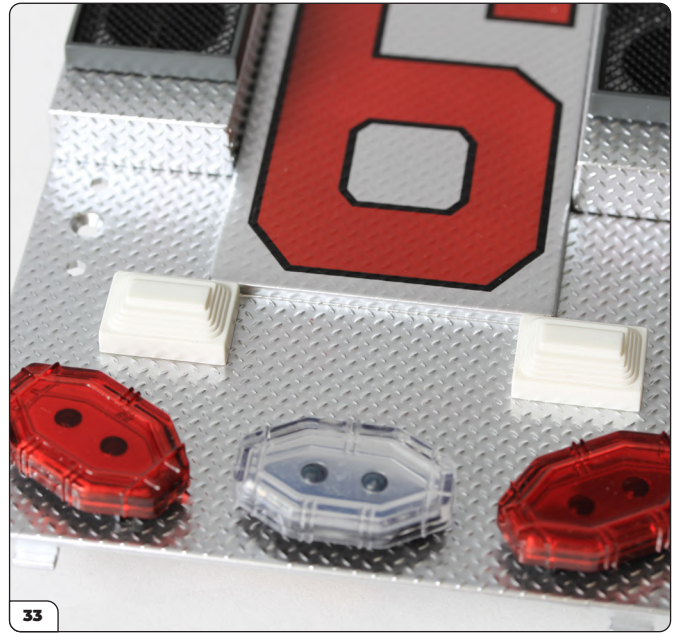

33

The second radio antenna has now been fitted. The remaining cab roof details will be fitted in a later stage.

### STAGE COMPLETE

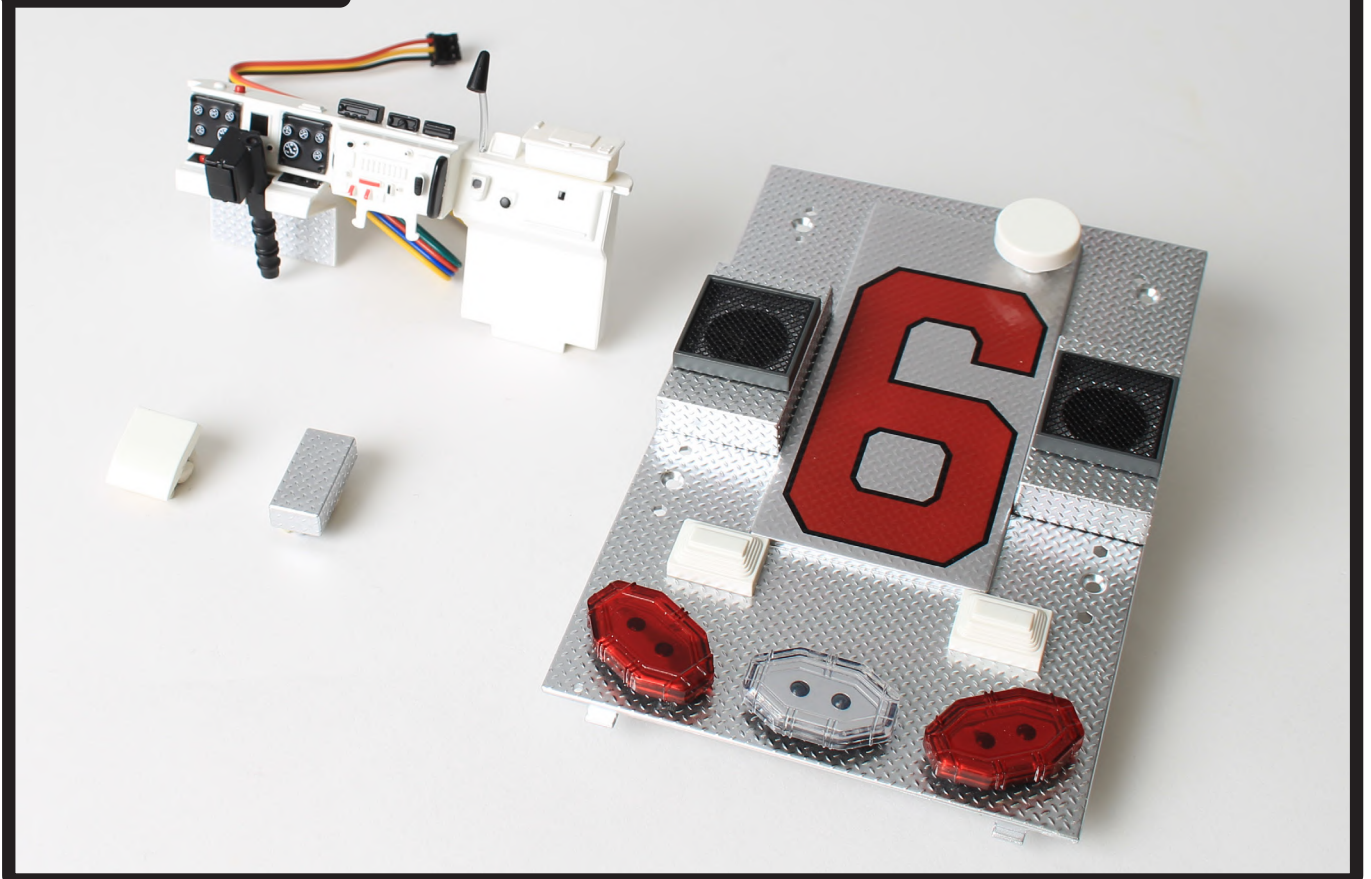

# Stage 20: Jump Seat, Cab Equipment & Front Left Light Cluster

In Stage 20 you'll assemble and fit the second rearward-facing jump seat, add further details to the cab, and construct the front left light cluster.



## STAGE 20 PARTS LIST

Name
Seat support
Jump seat
Water cooler bottom half
Water cooler top half
Cab cylinder
Light cluster PCB
Front left light cluster
Flood light
Portable radio charger
Mirror
Windshield wiper
Turn signal lens (L)
Headlight lens x2
LED diffuser x3
Type M screws x2
Type H screws x2

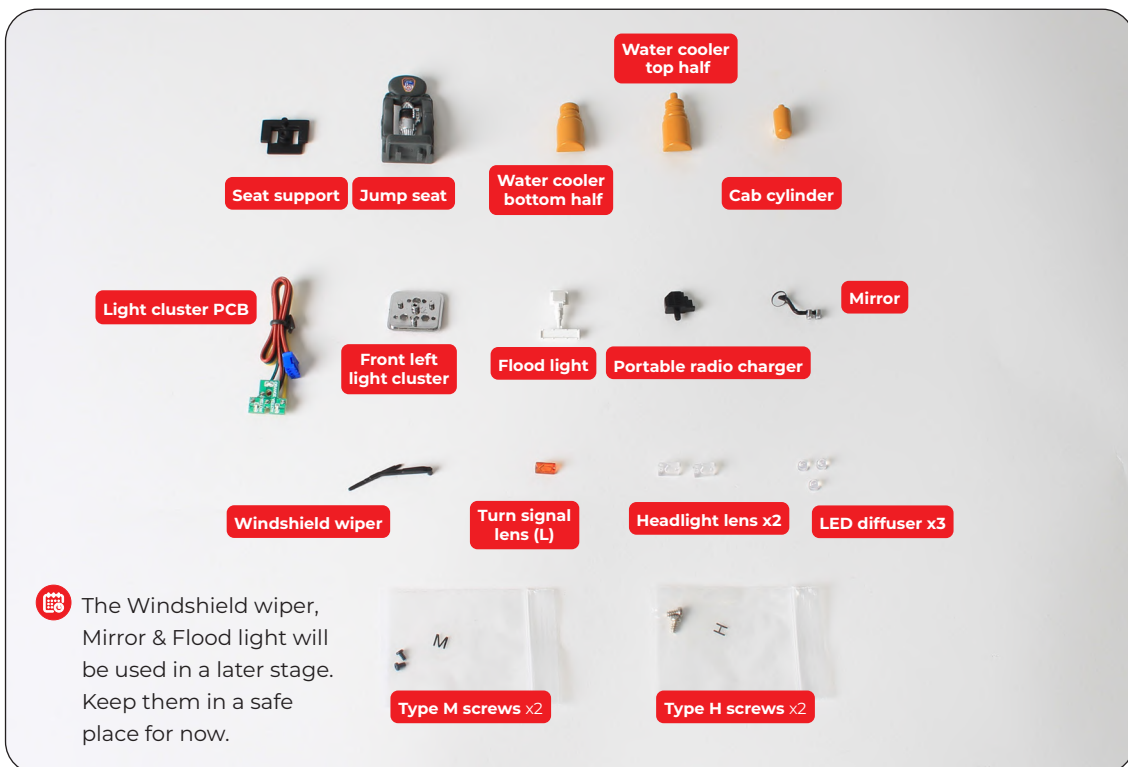

# Stage 20: Jump Seat, Cab Equipment & Front Left Light Cluster

## STEP 1

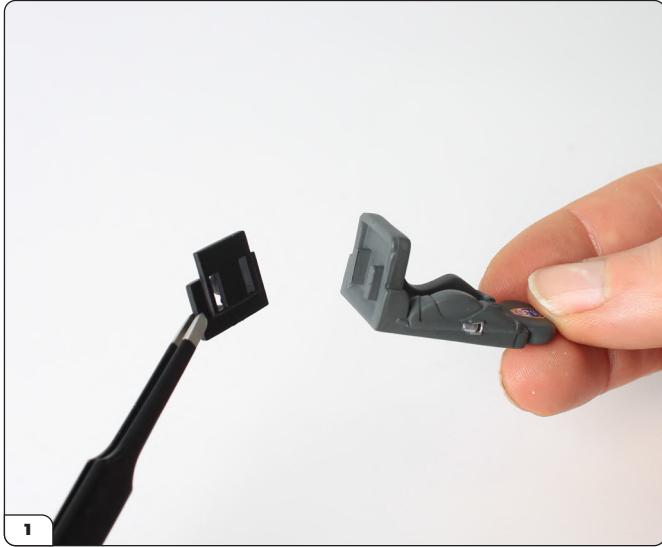

### ASSEMBLING THE SEAT

Apply a little superglue to the underside of the seat, avoiding the two rectangular tabs. Take the seat support and align it with the seat as shown. Check you have the seat support in the correct orientation with the peg aligned with the back of the seat.



Firmly press the two parts together.

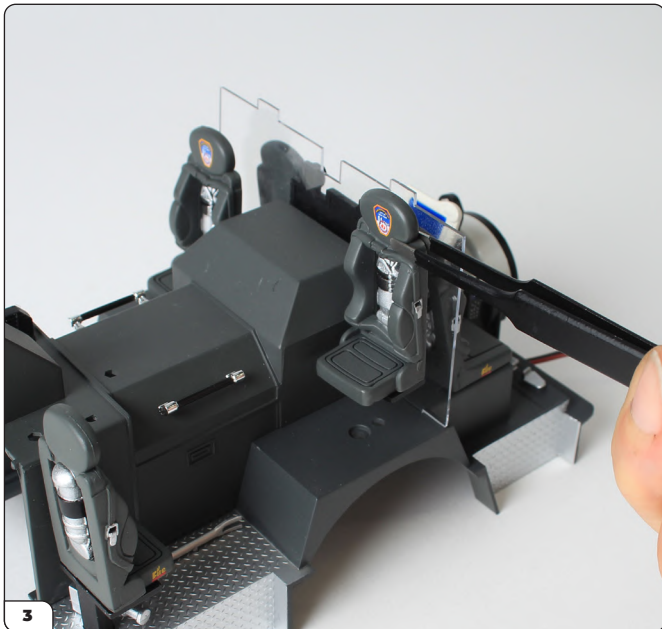

Align the peg and screw holes on the seat support with the corresponding holes in the cab floor, just behind the captain's seat.

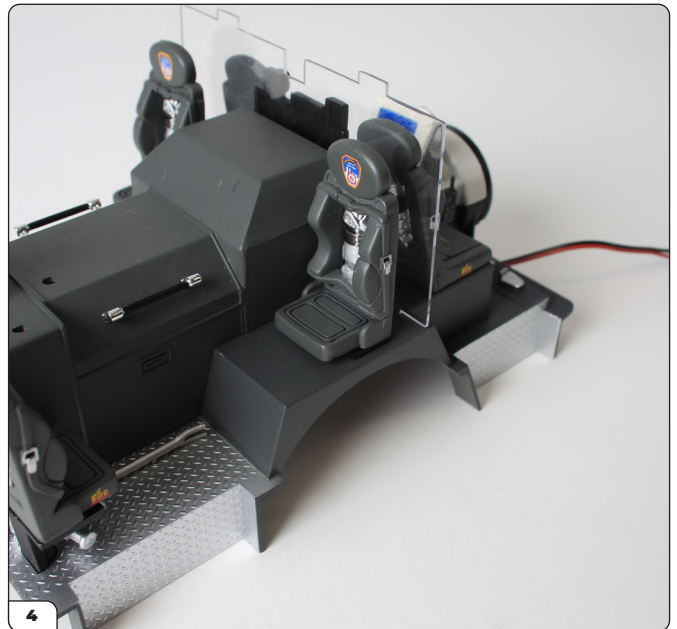

Press firmly.

## Stage 20: Jump Seat, Cab Equipment & Front Left Light Cluster

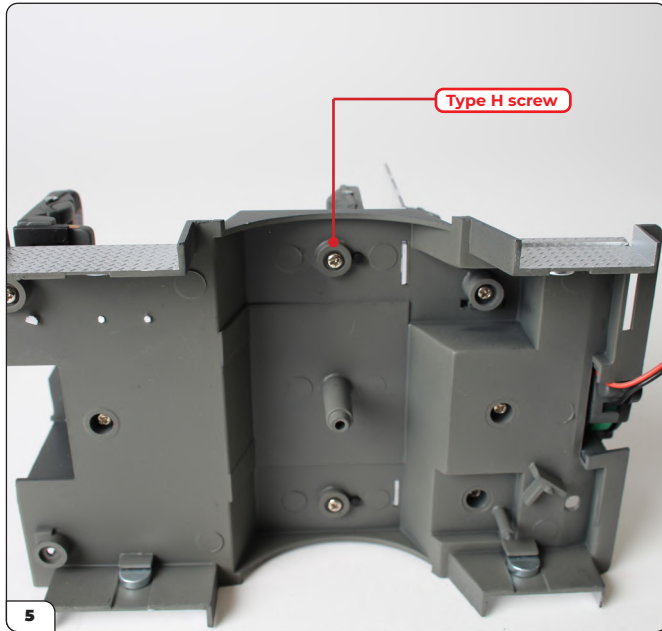

Holding the seat in position, turn the cab floor assembly over and fix it in place from the underside with a type H screw.



### ASSEMBLING THE WATER COOLER

Align the two halves of the water cooler. Note that the large and small lugs correspond with the large and small holes.



Push the two halves firmly together to fit.

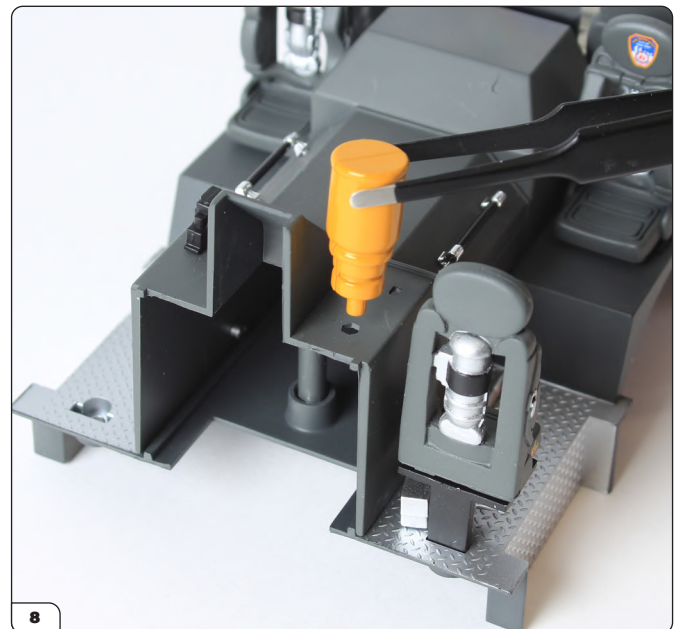

Align the lug at the narrower end of the water cooler with the hole at the back of the center console on the right-hand side.

## Stage 20: Jump Seat, Cab Equipment & Front Left Light Cluster

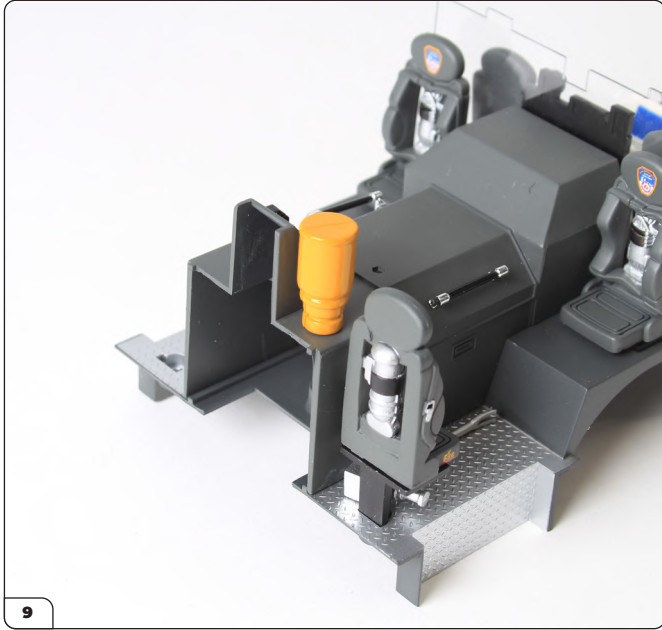

9

Press firmly to fit.

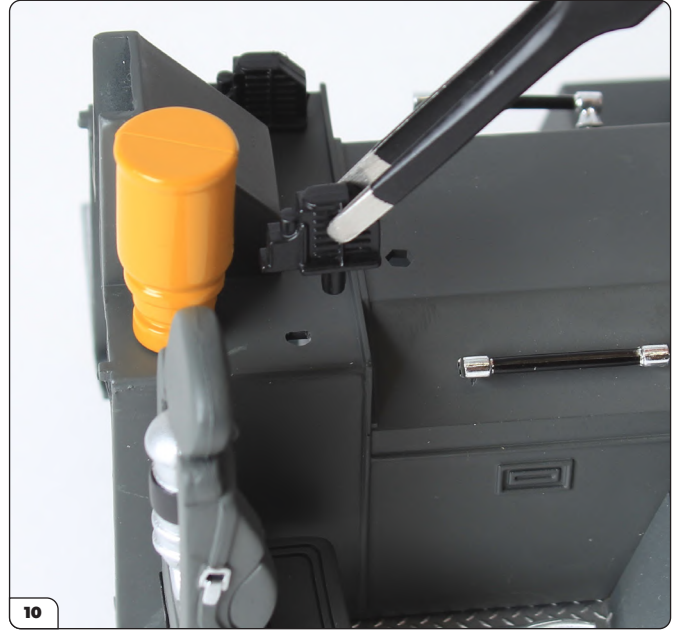

10

Align the portable radio charger with the hole just in front of the water cooler. This is a D-shaped hole to ensure the correct fit – the taller end of the battery charger should face forward.



11

Press firmly to fit.

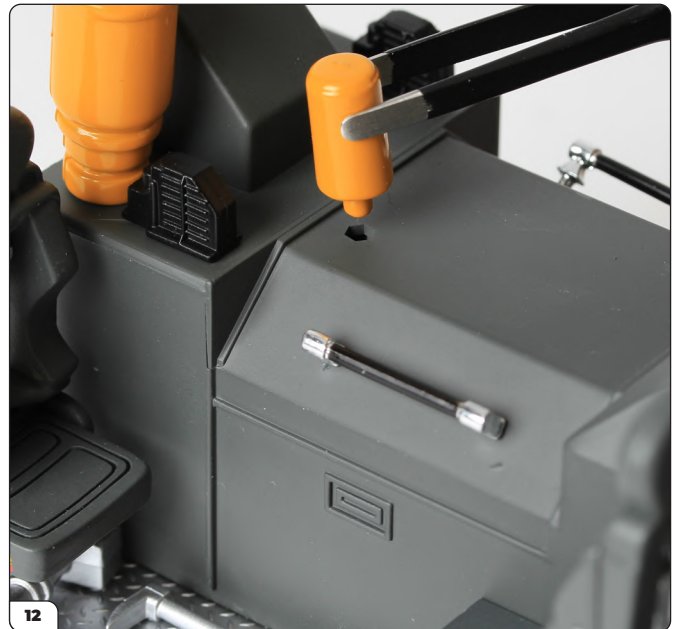

12

Align the cab cylinder with the hexagon-shaped hole in front of the portable radio charger.

## Stage 20: Jump Seat, Cab Equipment & Front Left Light Cluster



Press firmly to fit.



### ASSEMBLING THE FRONT LEFT LIGHT CLUSTER

Take one of the LED diffusers, holding it with the domed side facing outwards, and align with the single hole between two pins on the reverse side of the front light cluster.



Push the diffuser into position so that the domed side projects through to the other side.



Take the turn signal light lens (L) and note the directional arrow.

## Stage 20: Jump Seat, Cab Equipment & Front Left Light Cluster



Place the turn signal lens over the diffuser fixed in picture 15, checking that the arrow is facing the direction shown. Push firmly to fix in position.

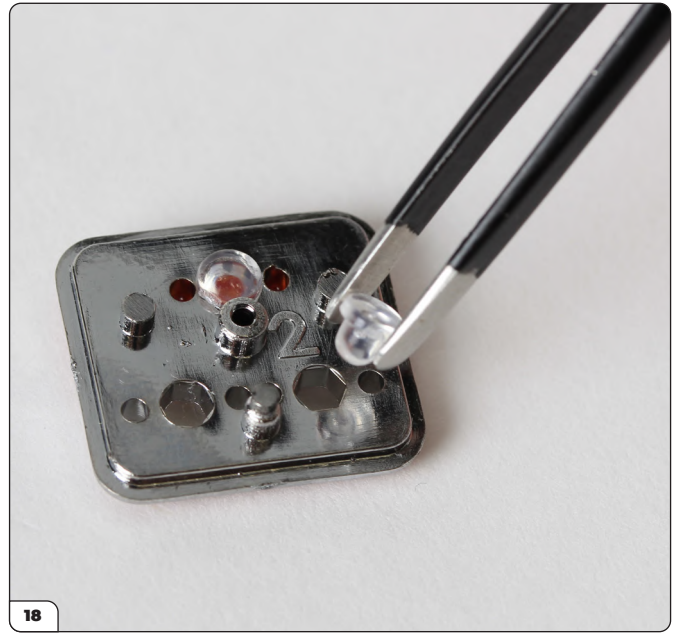

Take another diffuser and push it into one of the lower pair of holes at the rear side of the front light cluster.



Repeat to fix the third diffuser to the front light cluster.



Turn the front light cluster over so the front side faces up and align a headlight lens over the projecting diffuser.



## Stage 20: Jump Seat, Cab Equipment & Front Left Light Cluster



Push the headlight lens firmly into position.



Repeat to install the second headlight lens over the remaining diffuser.

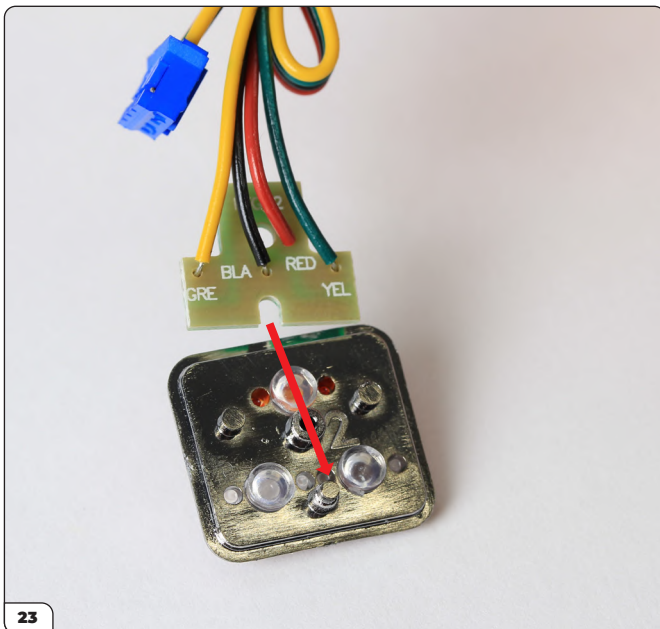

With the reverse side of the front light cluster facing up, line up the light cluster PCB so that the U-shaped cut out is in line with the single pin (see picture 24). Check that the circuit board is the correct way up, as shown in the picture.

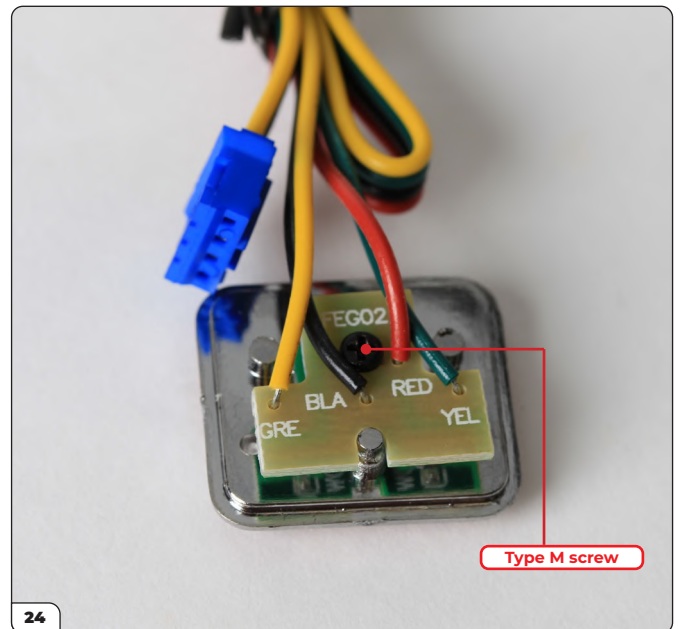

Press the circuit board firmly into place and fix in position with a type M screw.

# Stage 20: Jump Seat, Cab Equipment & Front Left Light Cluster

STAGE COMPLETE

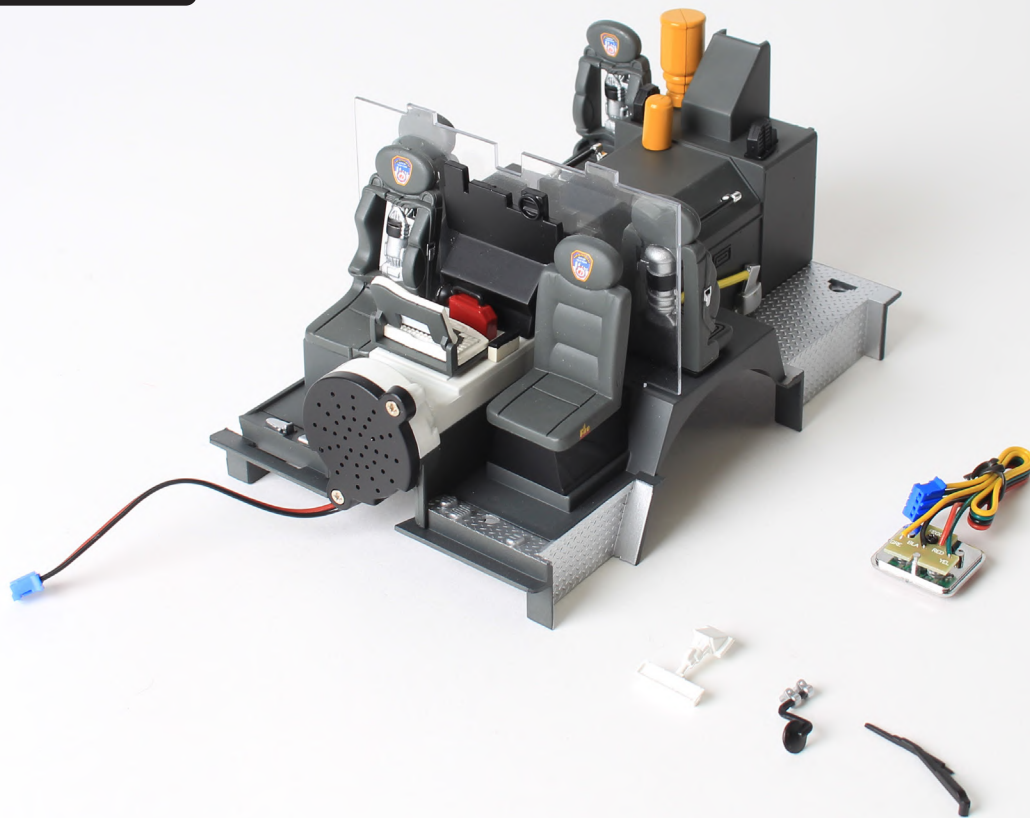

# Stage 21: Main Cab Body & Details, Installing the Rear Cab Doors and Cab Roof

You'll now start to build the main cab body, adding external details, fitting doors and windows, finishing the exterior cab roof, and finally fitting the interior roof. **Note: our photos show the side emergency lights given with this stage fitted before attaching the front & rear cab doors, but we'd recommend fitting these lights after attaching the doors, as directed in the following instructions.**



## STAGE 21 PARTS LIST

Name	Name
Cab main body	Emergency light frame x6
Handles x6	Side marker x2
Rear cab panel x2	Side reflector x2
Rear cab vent	Spotlight lens
Rear cab side panel x2	Spotlight frame
Rear cab window x2	Type C screws x4
Front windshield	Type B screws x2
Folding steps x2	Type J screws x3
Cab side window x2	Type D screws x4
Emergency light lens x6	
External power plug x2	

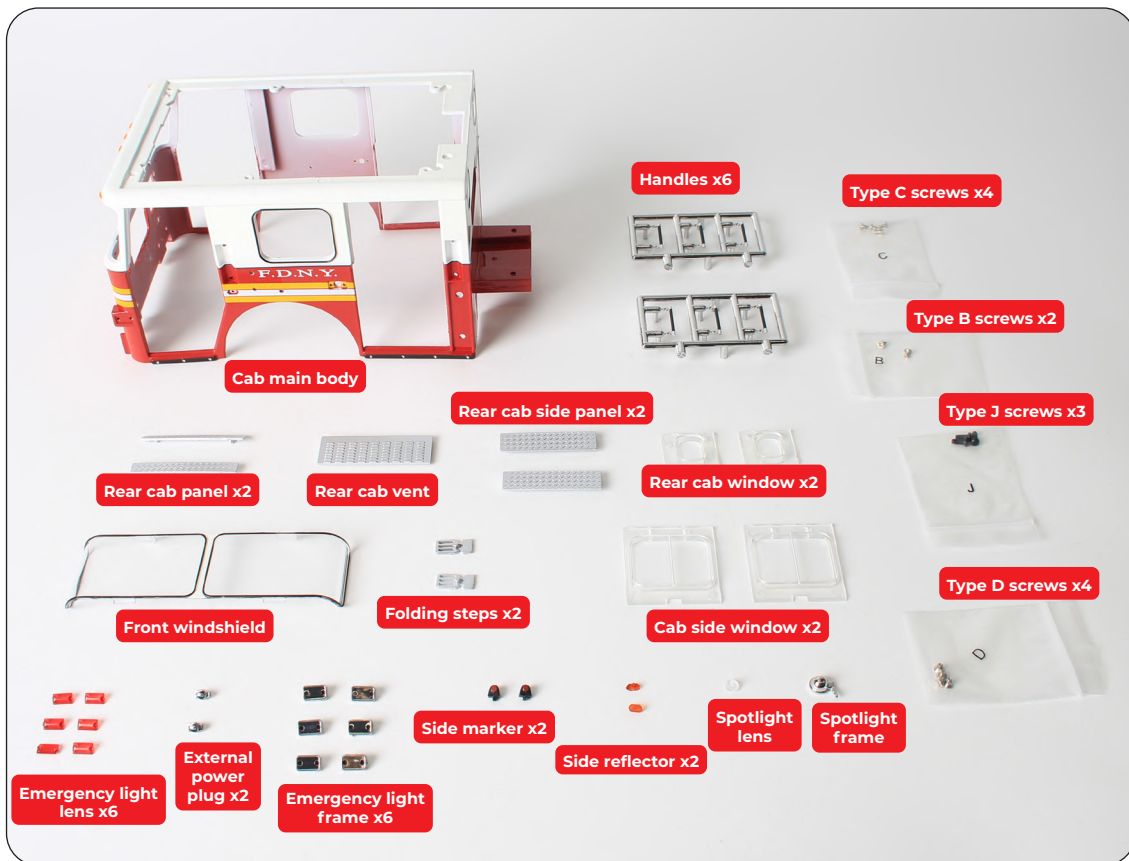

# Stage 21: Main Cab Body & Details, Installing the Rear Cab Doors and Cab Roof

## STEP 1

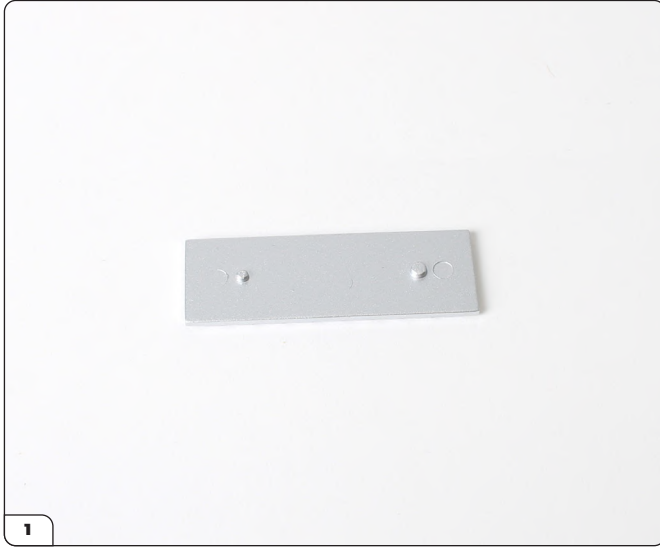

### ATTACHING DETAILS TO THE CAB EXTERIOR

Take the rear cab vent and note the different sized lugs on the reverse side.



Align the lugs with the holes in the recessed panel on the rear exterior wall of the cab, checking the orientation. The different sized holes should match up. If necessary, remove excess paint from the holes in the cab.



Push into place to fit.



Now take a rear cab panel and again, note that there are different sized lugs that match different sized holes on the cab.

# Stage 21: Main Cab Body & Details, Installing the Rear Cab Doors and Cab Roof



Align the rear cab panel with the holes on the very edge of the rear exterior wall of the cab.



Push firmly to fit, adding a little superglue if necessary.

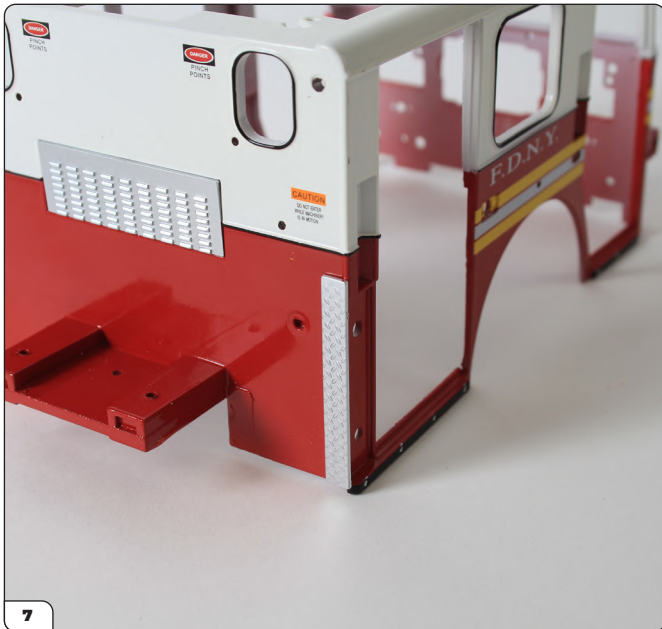

Repeat on the opposite side to fit the remaining rear cab panel.



The rear cab side panels fit in a similar way. First, note the different sized lugs.

# Stage 21: Main Cab Body & Details, Installing the Rear Cab Doors and Cab Roof

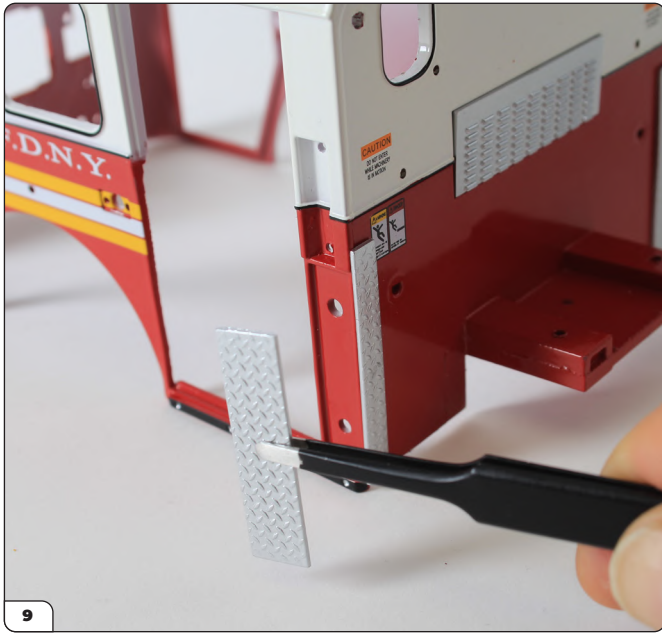

Align the lugs with the matching holes on the side of the cab, adjoining the rear exterior wall.



Push firmly to fit.



Repeat on the opposite side to fit the remaining rear cab side panel.

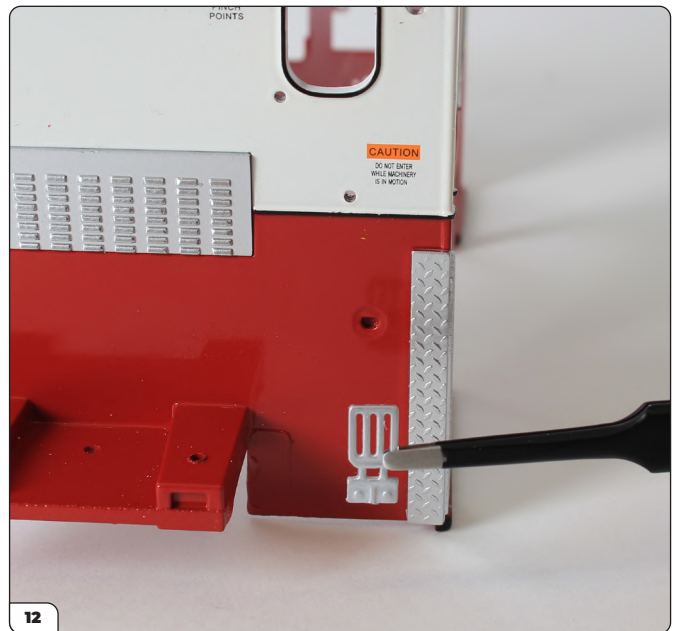

Take a folding step (note: these are both the same). Align the lug with the D-shaped hole next to the rear cab panel.

# Stage 21: Main Cab Body & Details, Installing the Rear Cab Doors and Cab Roof



Fix in place with a tiny drop of superglue.



Repeat on the opposite side to fit the remaining folding step.

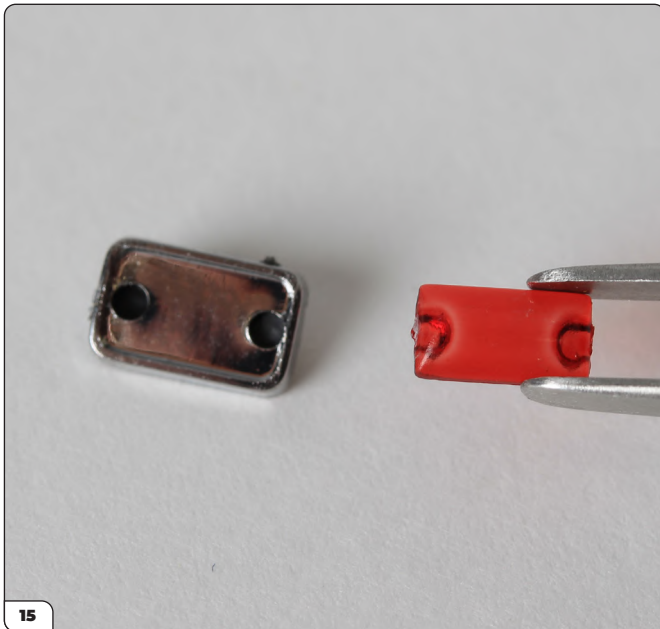

The emergency lights are assembled by pushing an emergency light lens into an emergency light frame.



Make six of these.

## Stage 21: Main Cab Body & Details, Installing the Rear Cab Doors and Cab Roof



Note that each emergency light frame has two lugs of different sizes which match the holes on the cab.



The first emergency light fits onto the left-hand side of the cab as indicated above.



Fit another emergency light on the right-hand side of the cab.



## Stage 21: Main Cab Body & Details, Installing the Rear Cab Doors and Cab Roof



The 2 x side reflectors are positioned along the opening edge of the front doors.



Push firmly to fit.



Repeat on the opposite side to fit the second side reflector.



Fit a side marker into the hole next to the side reflector. This is a D-shaped fitting to ensure the correct orientation. Note: the slot on the side marker faces upwards. Add a drop of glue for a stronger hold.

## Stage 21: Main Cab Body & Details, Installing the Rear Cab Doors and Cab Roof



Push firmly to fit.



Repeat on the opposite side to fit the remaining side marker.



The two power plugs are positioned in between the side reflector and the side marker on the left-hand side of the cab. Holding one of the plugs with tweezers, align the D-shaped lug with the lower hole in the orientation shown. Note: both plugs are the same and can be fitted to either hole.



Press firmly to fit, adding a drop of glue if necessary.

## Stage 21: Main Cab Body & Details, Installing the Rear Cab Doors and Cab Roof



Repeat to fix the remaining plug in the upper hole.



Next, you'll fix the six handles to the exterior cab walls. Start by cutting the handles from the frame, taking care to cut just below the fixing lugs as shown.



Take one of the handles and align the lugs with the holes in the vertical recess next to the front cab door. Push into place. Add a drop of glue to each of the six handles if necessary.



Fix the next handle in the recess above the rear cab side panel. Note: the emergency light seen here will be fitted at a later stage.

# Stage 21: Main Cab Body & Details, Installing the Rear Cab Doors and Cab Roof



Fix two more handles at a diagonal angle on the rear exterior wall of the cab.



Fix the remaining two handles to the recesses in the right hand side of the cab. Note: the emergency light seen here will be fitted at a later stage.

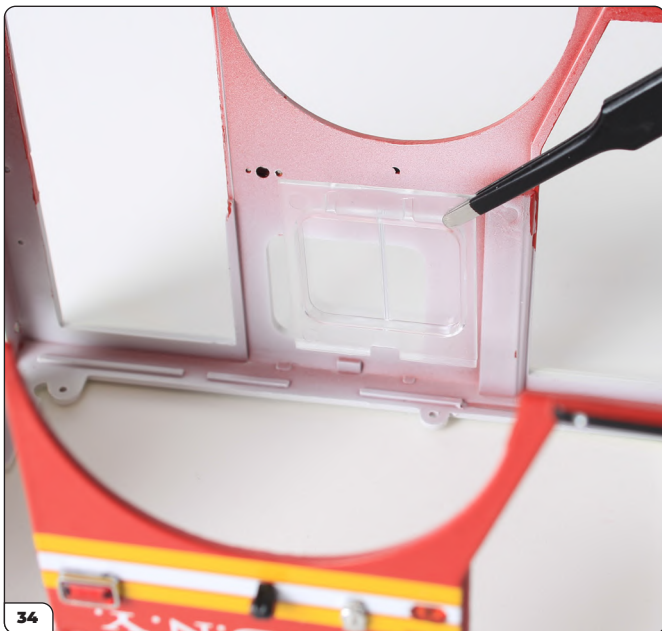

### ATTACHING THE CAB SIDE WINDOWS

Carefully place the cab main body upside down on your work surface. Position one of the cab side windows so that the notch along one side lines up with the tab above the window opening. Check that the raised area of the window projects outwards.

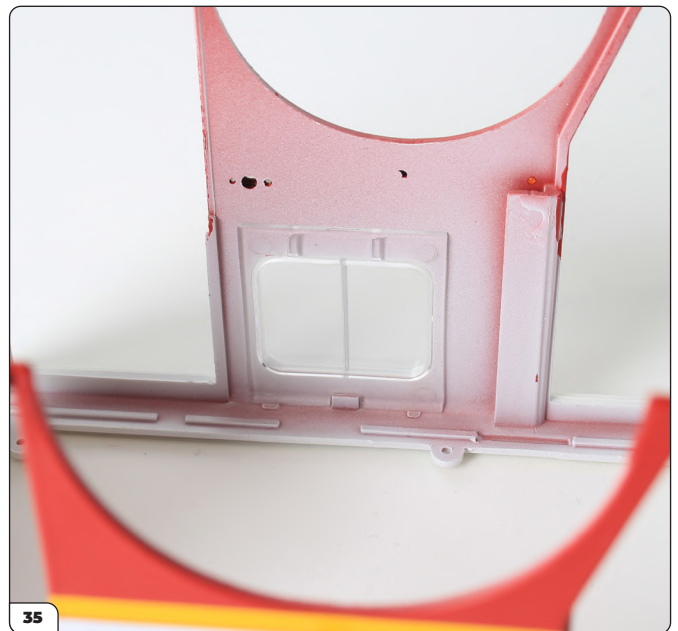

Push firmly to fit.

## Stage 21: Main Cab Body & Details, Installing the Rear Cab Doors and Cab Roof

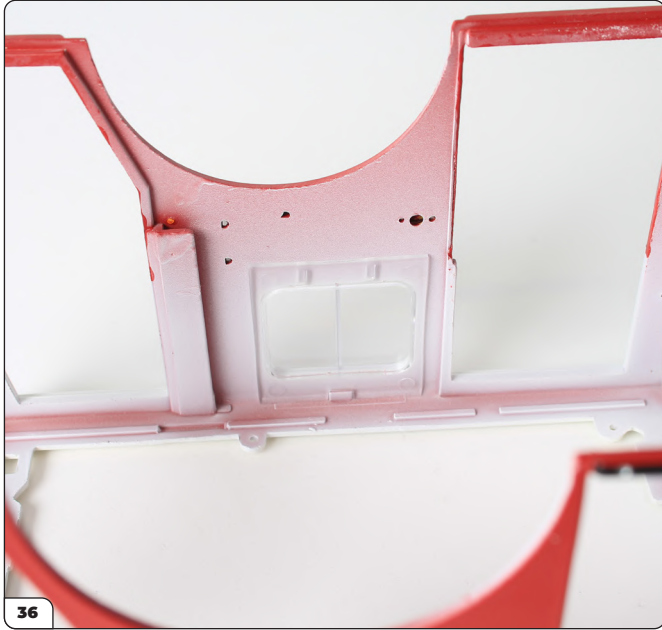

Repeat on the opposite side to fix the remaining cab side window.



The side windows have been fixed in place. The cab can now be turned the right way up.

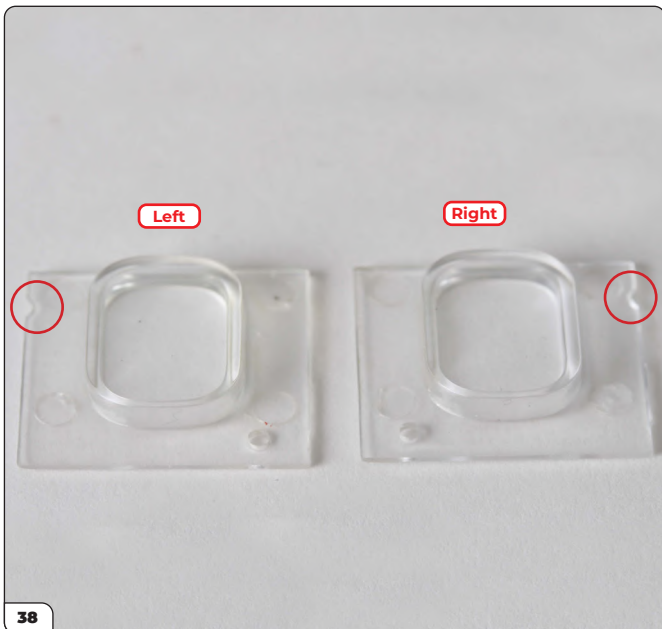

Take the rear cab windows and note there is a left and a right window, indicated by a notch (circled).



The notch of each window fits around the screw hole in each top corner of the rear wall. From the inside of the cab, fit the right-hand window into the window recess on the right-hand side of the cab. Check that the notch and the hole are correctly positioned and aligned (circled). Press to fit. If necessary, use PVA glue to secure these in place.

## Stage 21: Main Cab Body & Details, Installing the Rear Cab Doors and Cab Roof



Repeat to fix the left-hand window into the left hand corner.

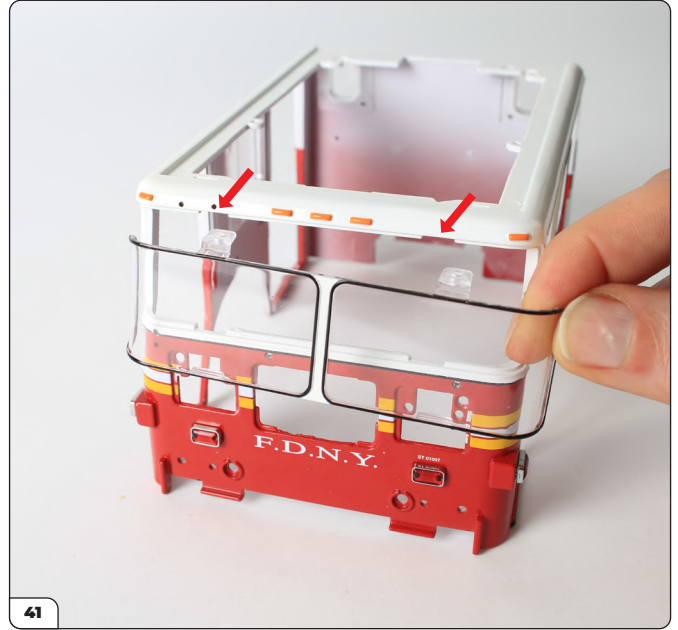

Position the front windshield in front of the cab, lining up the tabs at the top of the windshield with the notches in the cab frame (arrows).

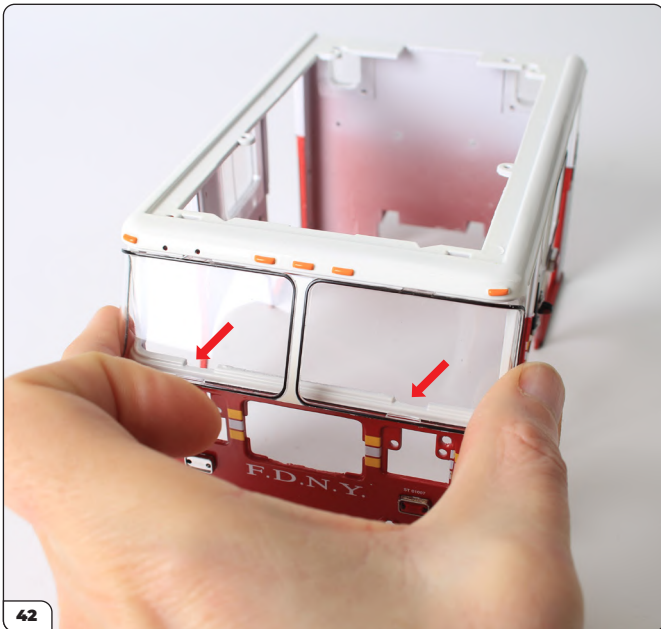

Push the windshield into position in the frame. Fit the tabs at the top of the windshield, then fit the tabs at the bottom, and push gently, but firmly to fit. If necessary, use a little PVA glue to hold the windshield in place, particularly to secure the curved sides in the frame.



Check that the windshield tabs are correctly positioned on the inside of the cab.

# Stage 21: Main Cab Body & Details, Installing the Rear Cab Doors and Cab Roof



The windshield should now sit flush at the front of the cab. Note: the emergency lights seen here will be fitted at a later stage.



## ATTACHING THE FRONT GRILLE

Take the front grille assembled in Stage 03. Push the tabs on the left and right sides of the grille into the recesses in the opening at the front of the cab.



Push firmly to fit.



## ASSEMBLING THE MARKER LIGHT

Line up the pin on the marker light lens with the hole in the marker light frame. Push the parts firmly together. Keep in a safe place until ready to be attached to the cab in a later stage.

# Stage 21: Main Cab Body & Details, Installing the Rear Cab Doors and Cab Roof

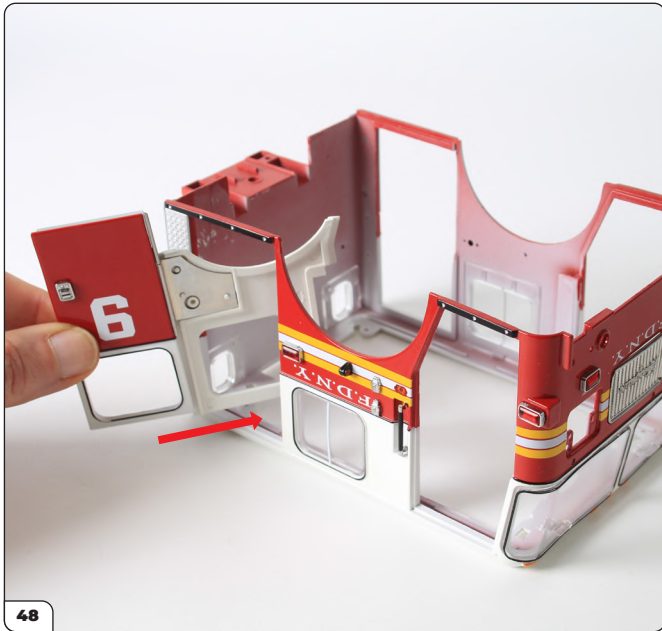

## ATTACHING THE REAR CAB DOORS

Position the cab assembly upside down on your work surface. Holding the rear left cab door from Stage 03 in the orientation shown, feed the inner cab panel from the outside to the inside of the cab.

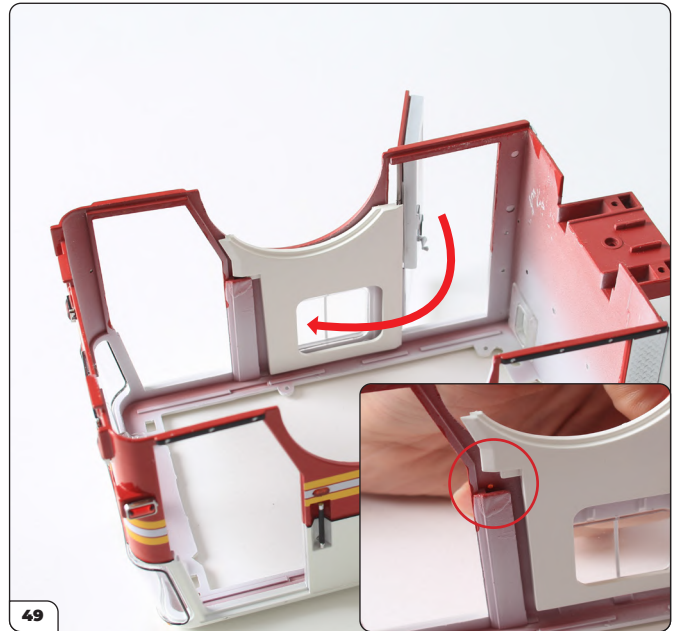

Working from the inside of the cab, press the inner cab panel into place against the inner left-hand side of the cab. Push the inner panel into the fixing point indicated (above inset), and check that the cab door fits well in the closed position.



From the outside, drive a type C screw into the screw hole to secure the door in place.



## Stage 21: Main Cab Body & Details, Installing the Rear Cab Doors and Cab Roof



Fit one of the emergency lights assembled in 15-17 by firmly pushing the lugs into the holes either side of the screw.



The right-hand rear cab door is attached in the same way. Start by feeding the inner cab panel through the door opening from the outside of the cab.

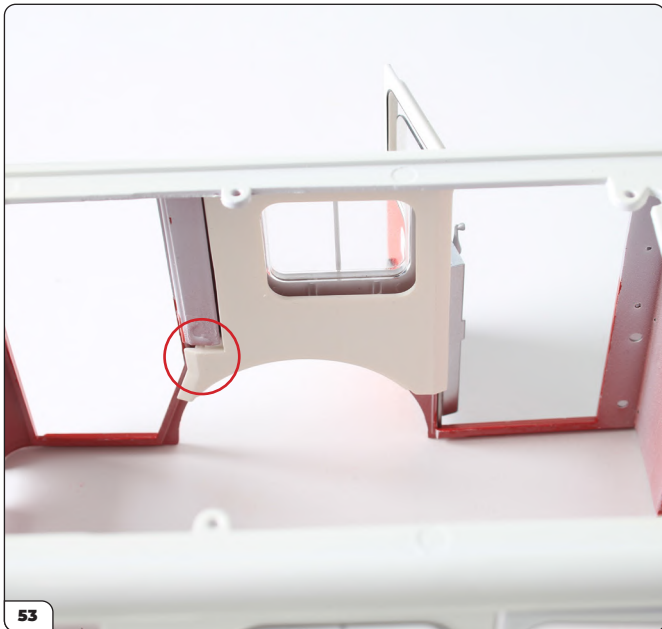

Secure the inner cab panel at the fixing points indicated above, checking that the door is a good fit when closed.



From the outside, drive a type C screw into the screw hole to secure the door in place.

# Stage 21: Main Cab Body & Details, Installing the Rear Cab Doors and Cab Roof



Fit another emergency light by firmly pushing the lugs into the holes either side of the screw. Note: the doors may not stay in the closed position until the base of the cab is fitted which includes the magnets that hold the four cab doors closed.

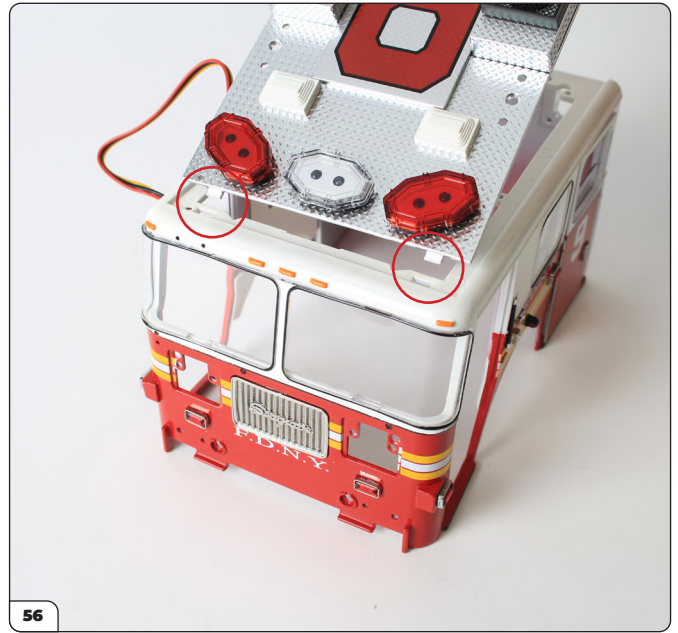

## ATTACHING THE ROOF

Take the cab roof from Stage 19, aligning the tabs along the front edge with the recesses in the cab main body.



Push the tabs firmly into the recesses.

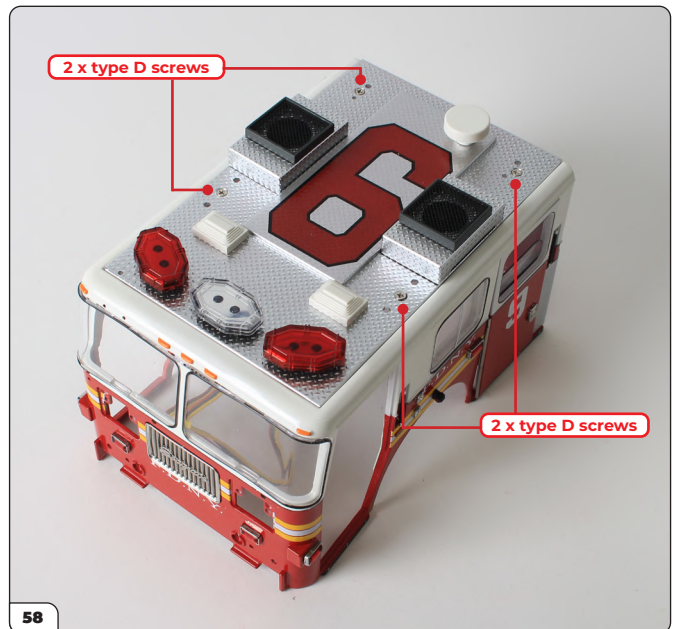

Press firmly along all four edges of the roof to fit it into the main body. Secure in place with 4 x type D screws. Be careful not to over tighten these screws.

## Stage 21: Main Cab Body & Details, Installing the Rear Cab Doors and Cab Roof



Fit roof component (c) from Stage 19 into the roof, covering the screw hole.



Push the two lugs firmly to fit.

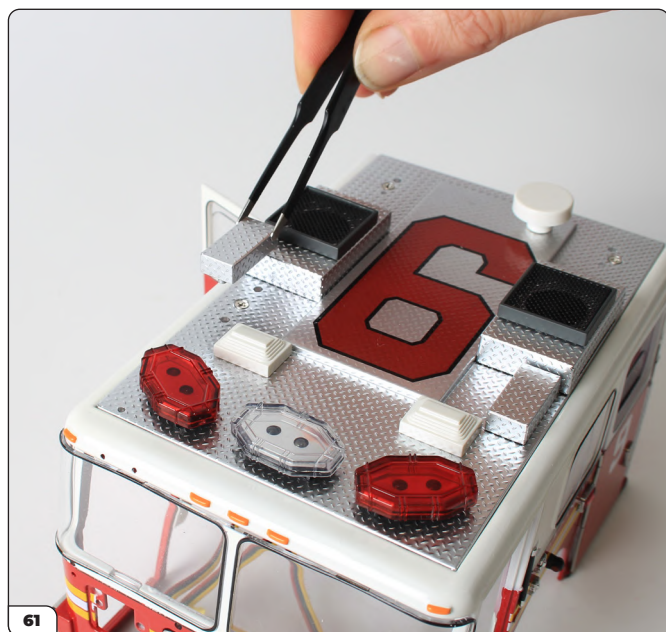

Repeat to fit roof component (c) from Stage 05 on the opposite side of the roof.



Push firmly to fit.

## Stage 21: Main Cab Body & Details, Installing the Rear Cab Doors and Cab Roof

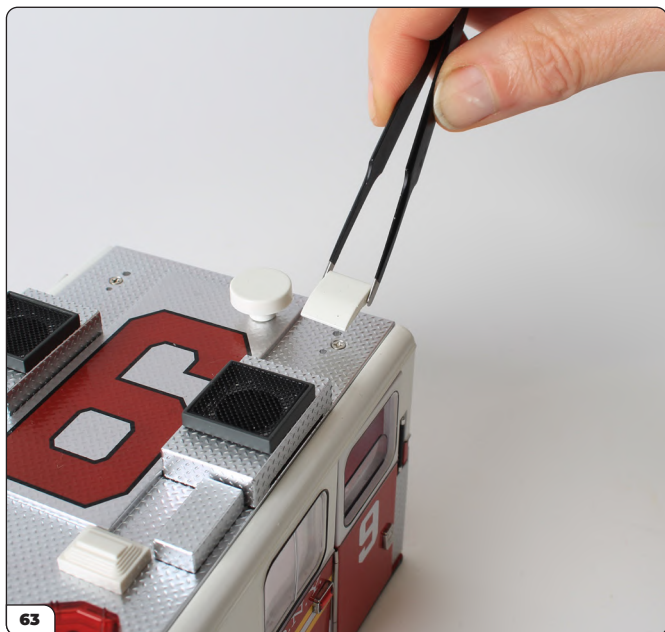

Fit roof component (d) in the same way, covering the screw holes towards the rear of the cab roof.



Push firmly to fit.

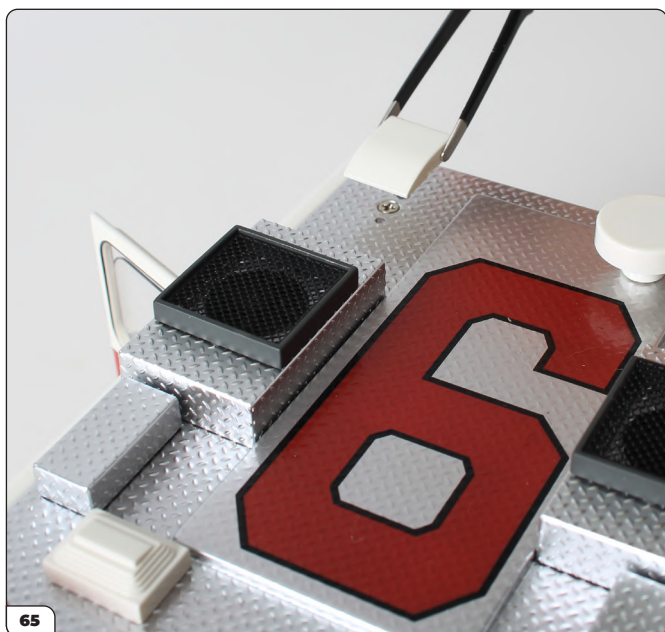

Repeat on the opposite side to fit roof component (d) from Stage 19.



The cab roof has now been fitted to the cab, along with details.

# Stage 21: Main Cab Body & Details, Installing the Rear Cab Doors and Cab Roof

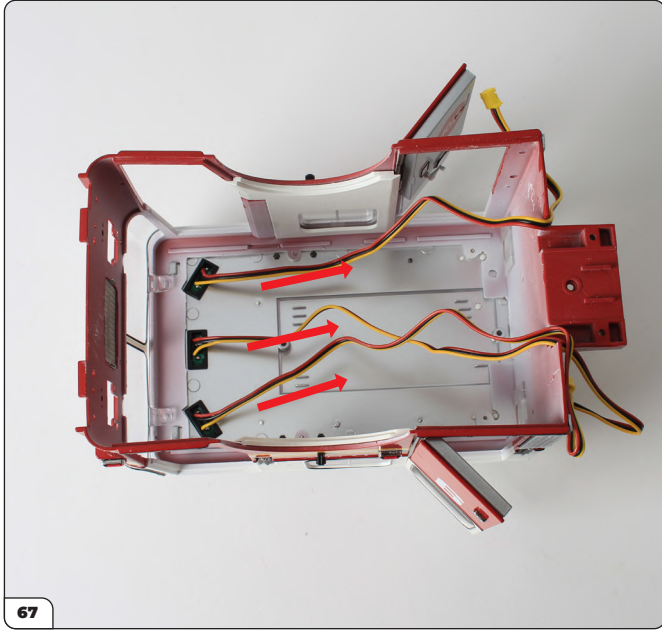

### ATTACHING THE INTERIOR CAB ROOF

Start by placing the cab assembly upside down on your work surface. Lay the light cables from the front of the roof along the length of the cab so that they rest on the upper edge at the rear of the cab.

EXPERT TIP: It will be easier to fit the cab roof if you tape down the cables with masking tape to hold them in the correct position.

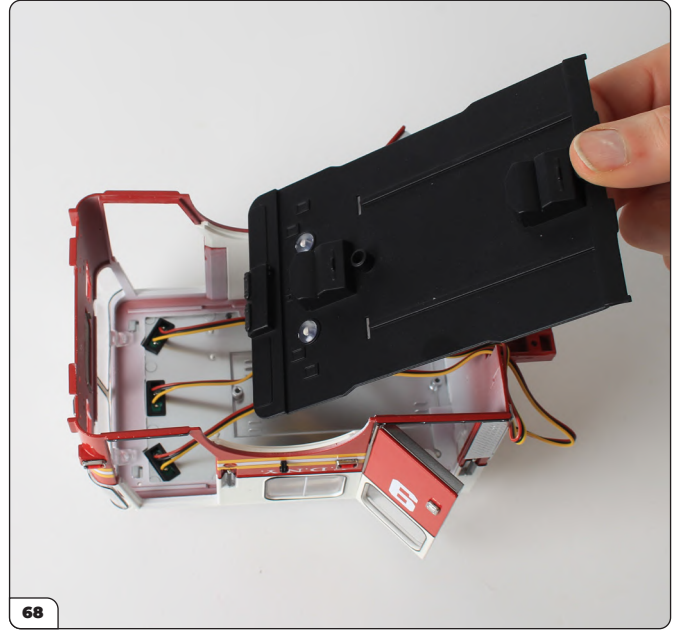

Take the interior cab roof from Stage 16 and position it with the dome lights facing you and towards the front of the cab. Angle the inside roof down towards the underside of the light bars.



Check that the three cables extend to their maximum reach and lay flat underneath the roof as you press the inside roof firmly against the inside of the cab roof.

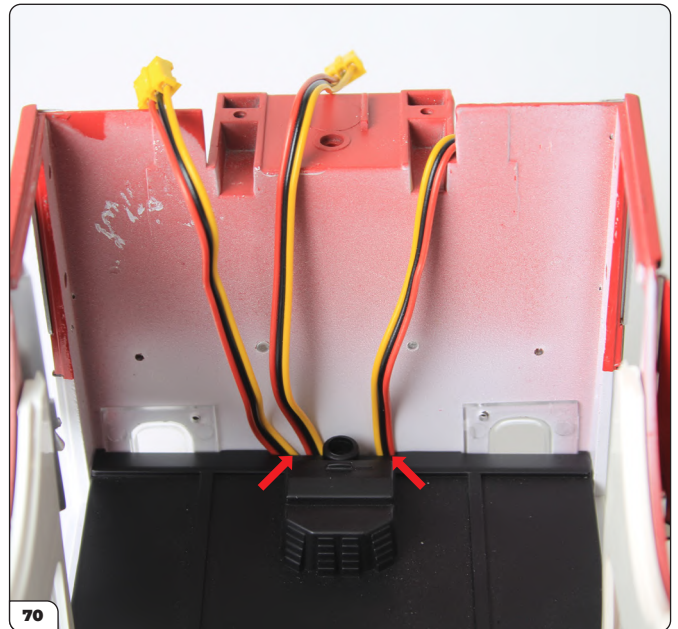

The three cables feed through two cut-out sections of the inside roof (arrows).

## Stage 21: Main Cab Body & Details, Installing the Rear Cab Doors and Cab Roof

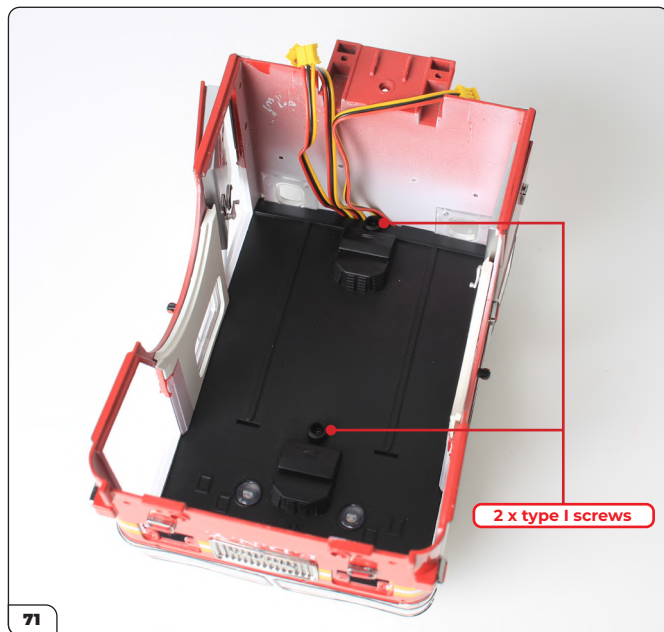

Secure the interior cab roof in place with 2 x type I screws that came with Stage 16.



## Stage 22: Assemble & Fit the Front Left Wheel

You'll now turn your attention back to the chassis, assembling and fitting the front left wheel.



### STAGE 22 PARTS LIST

Name
Front tire
Wheel
Hub cap



## Stage 22: Assemble & Fit the Front Left Wheel

### STEP 1



#### FITTING THE TIRE TO THE WHEEL

The tire fits onto the wheel in the same way as the tires in previous stages. If the tire won't stretch, soak it in a hot water bath for two minutes.



Carefully remove the tire with tweezers and shake off the excess water. Blot the tire on kitchen paper or a cloth. Warning: be careful not to scald yourself on the hot water.



Working quickly while the tire is warm, push the wheel into the tire and stretch it around the outer flange of the wheel.



The wheel should now look like this.



## Stage 22: Assemble & Fit the Front Left Wheel

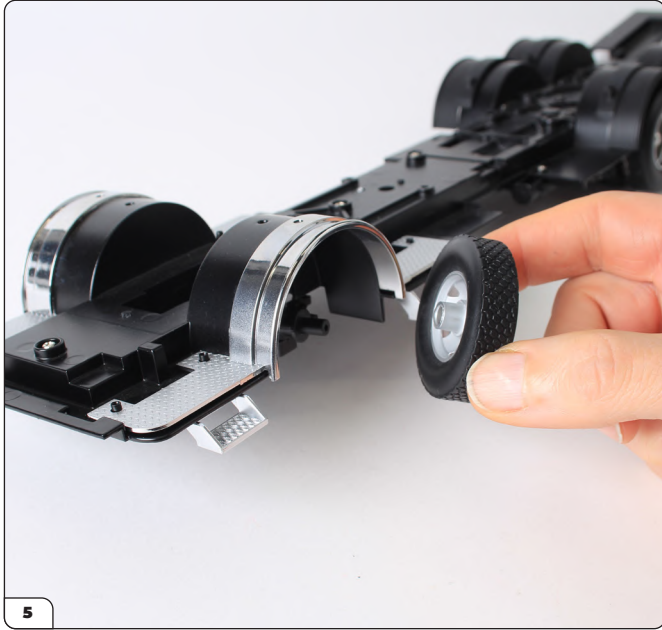

Take the chassis from Stage 12B and align the wheel you have just assembled with the front wheel hub. Check you have the wheel the right way round with the 'wheel nuts' facing outwards.

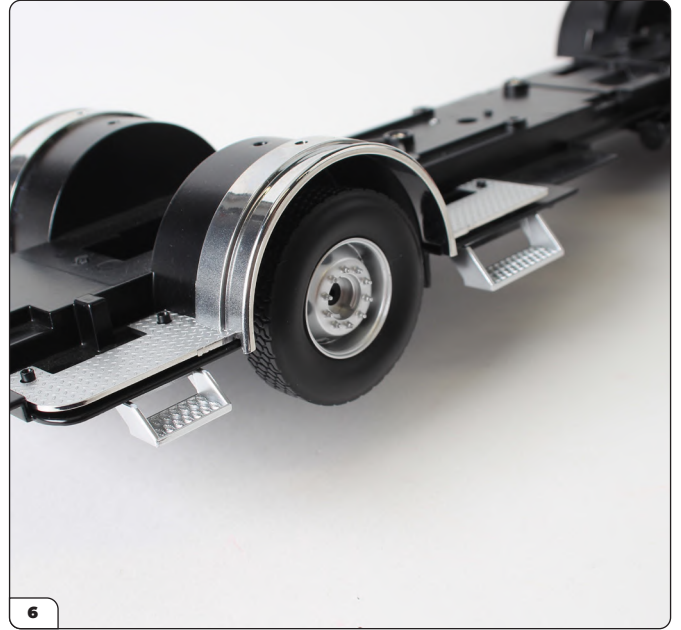

Push the wheel onto the hub.

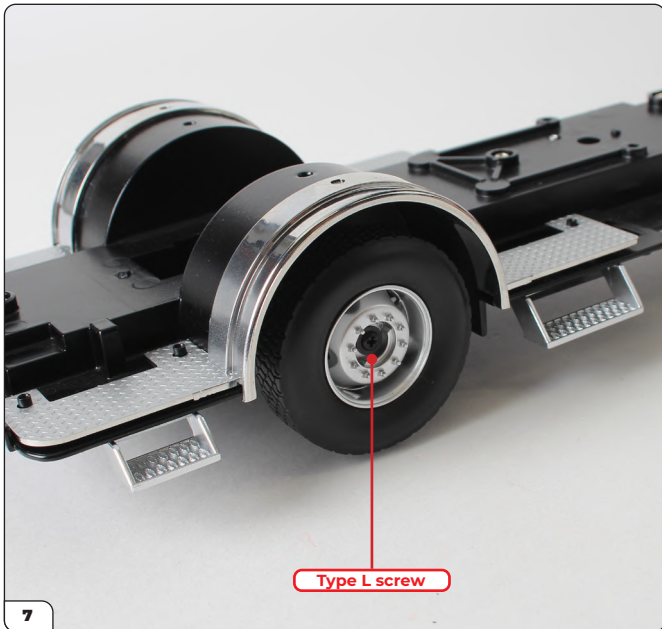

Secure in place with a type L screw from Stage 15.

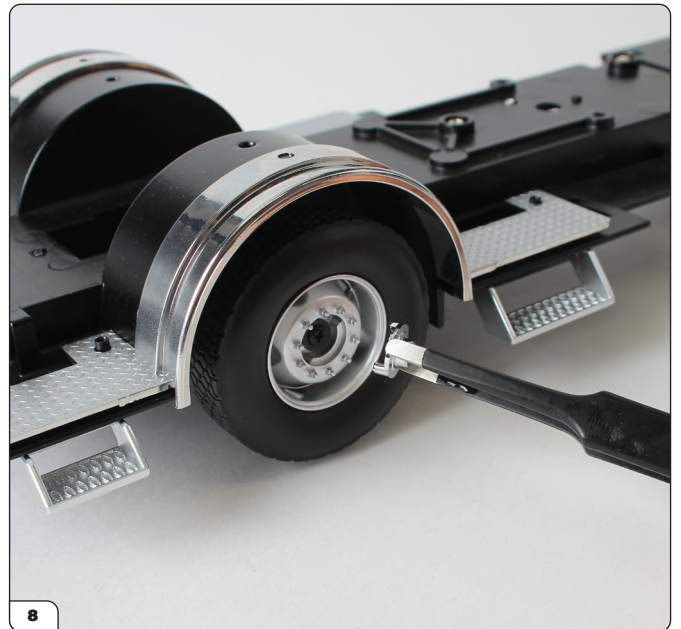

Align the tabs on the hub cap with the notches on the wheel.

# Stage 22: Assemble & Fit the Front Left Wheel

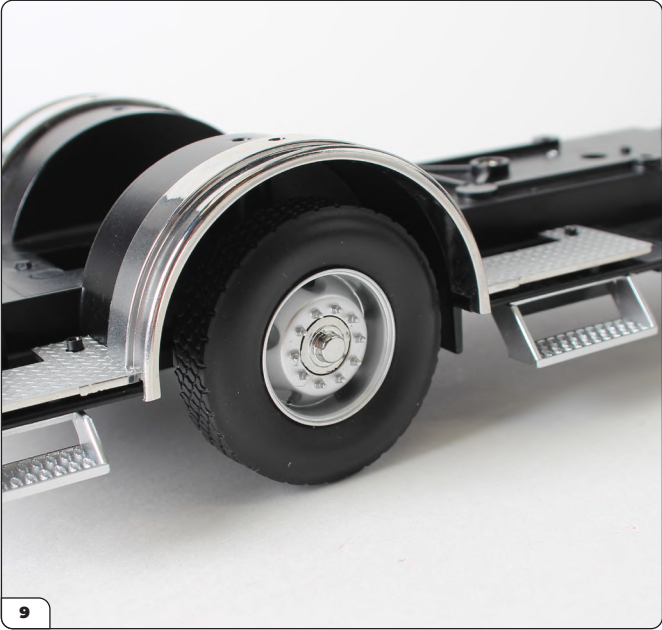

Push firmly to fit.

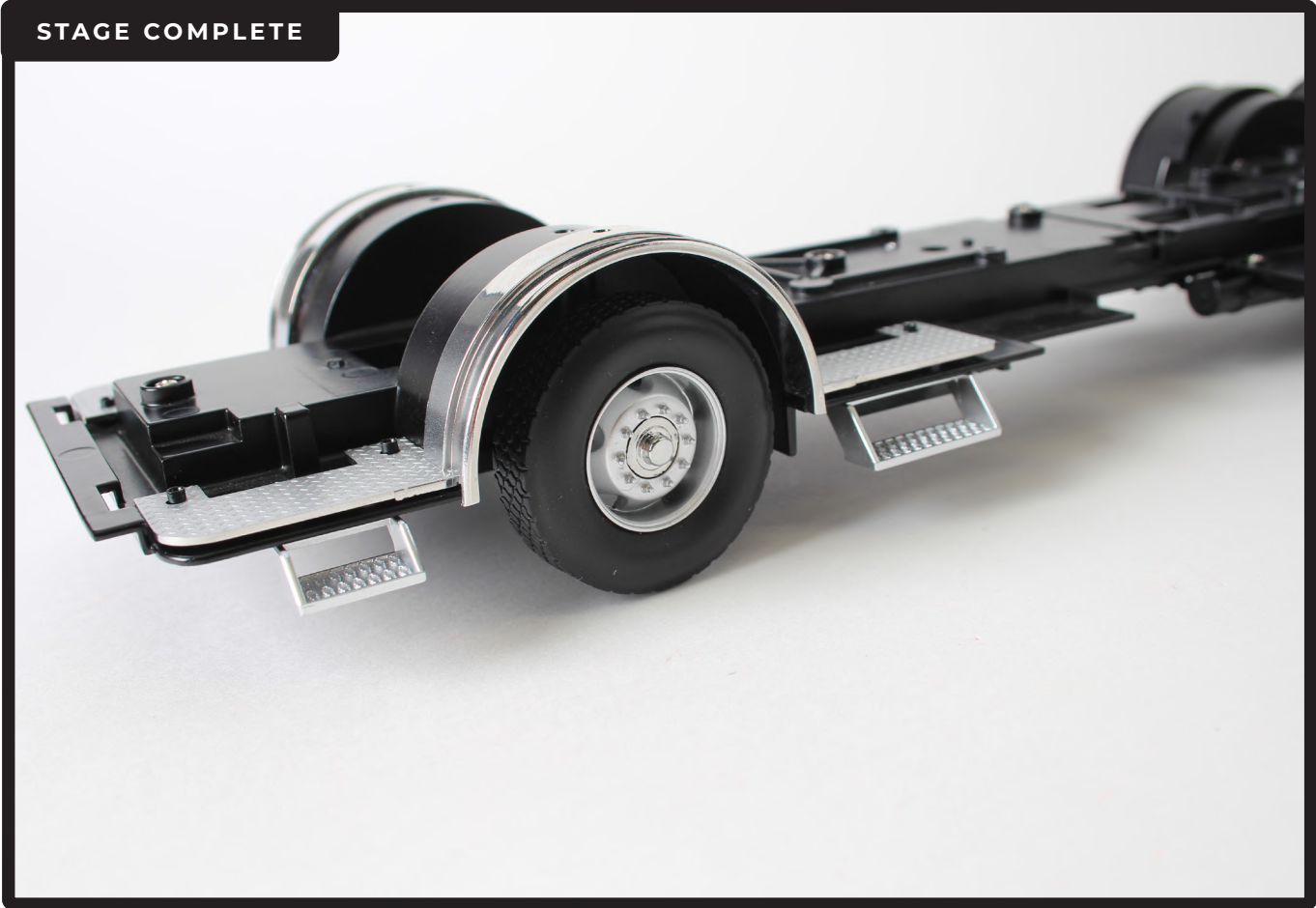

# Stage 23: Fitting a Crew Seat, Installing the Main Circuit Board, Connecting the Dashboard & Lights, and Fitting the Front Cab Doors

Returning to the main cab, in this next stage you'll fit the final seat before installing the main circuit board, connecting up the cables for the speaker and dashboard, and adding the front doors. This is followed by installing the complete center console inside the main cab body and connecting up cables for the lightbars and front light clusters.



## STAGE 23 PARTS LIST

Name
------

Main circuit board
--------------------

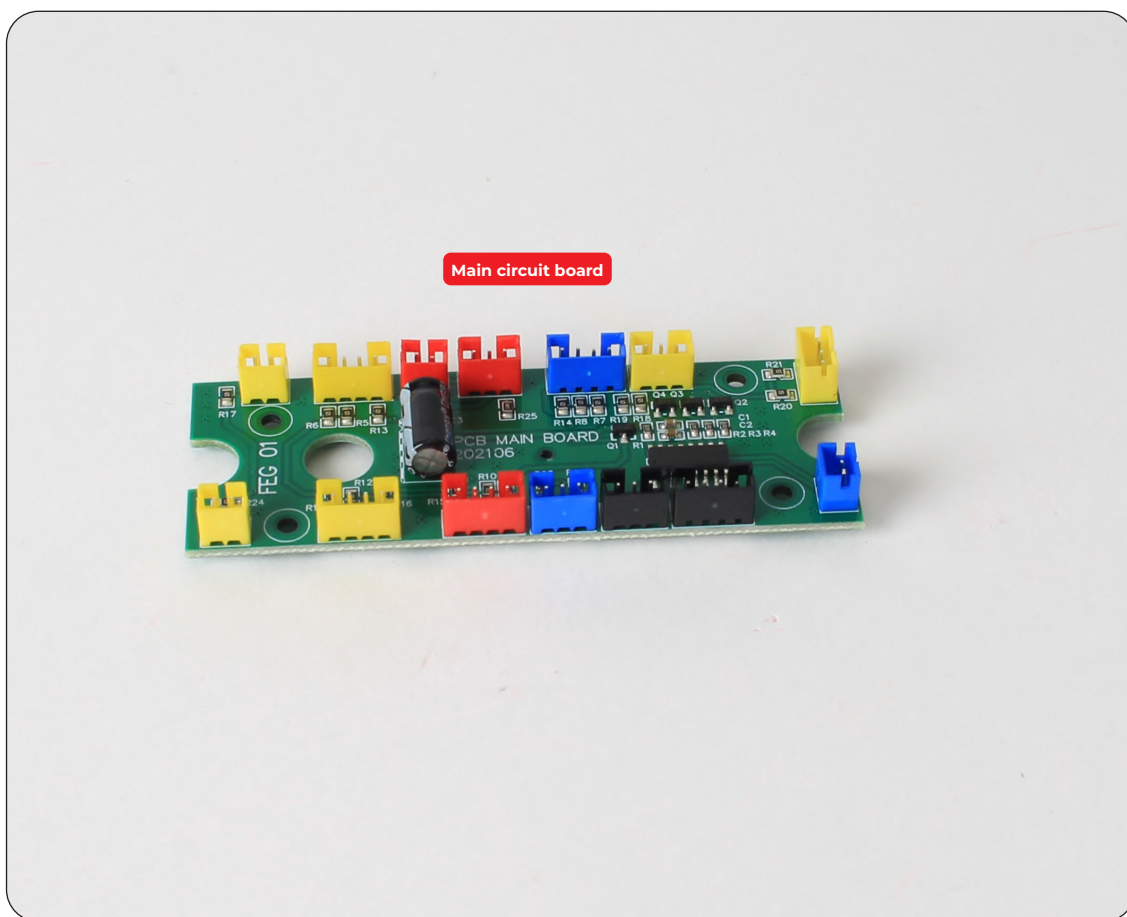

# Stage 23: Fitting a Crew Seat, Installing the Main Circuit Board, Connecting the Dashboard & Lights, and Fitting the Front Cab Doors

## STEP 1

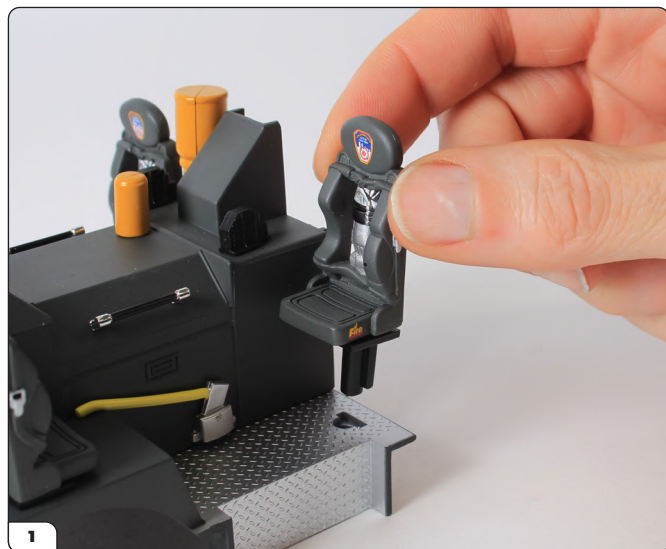

### ATTACHING A CREW SEAT

Take the first seat you assembled in Stage 04, aligning the post on the seat support with the D-shaped hole in the rear of the cab floor.



Push firmly to fit in position.

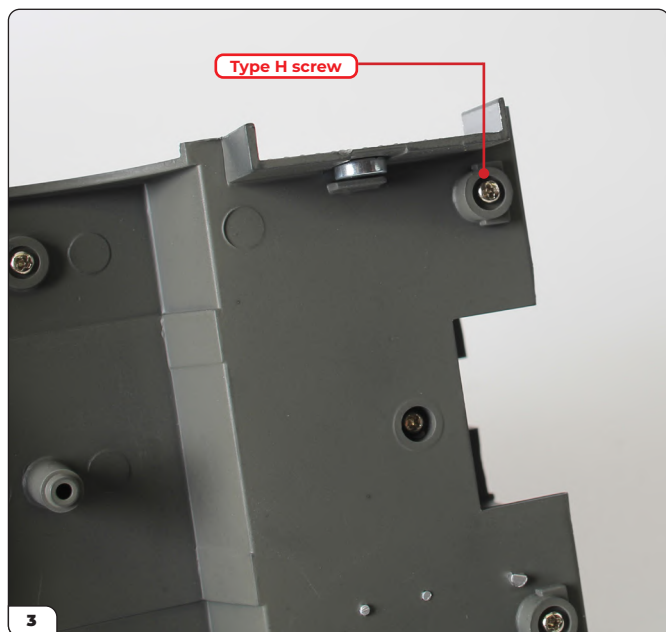

Secure the seat from the underside with a type H screw.

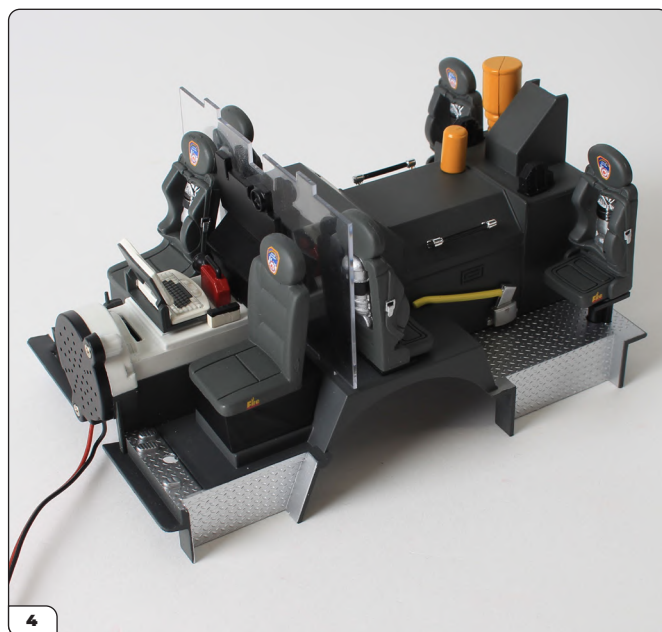

All six seats have now been fitted to the cab.

# Stage 23: Fitting a Crew Seat, Installing the Main Circuit Board, Connecting the Dashboard & Lights, and Fitting the Front Cab Doors

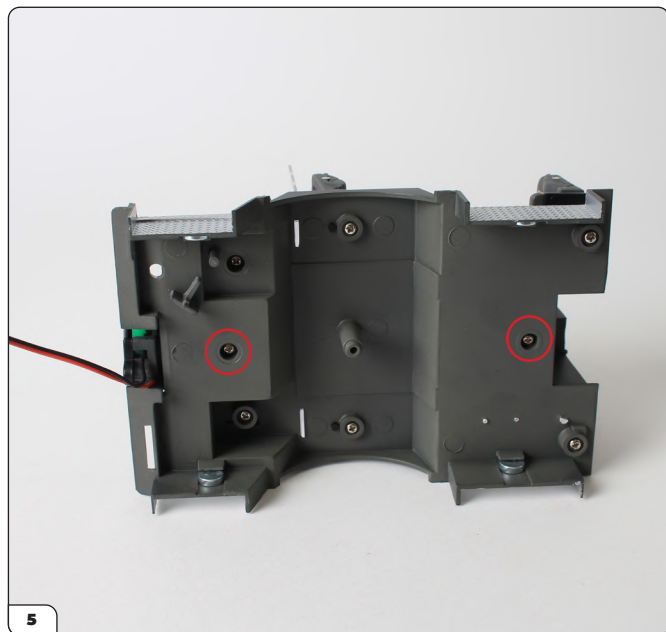

## INSTALLING THE MAIN CIRCUIT BOARD

Before installing the main circuit board, the center console must be separated from the cab floor. Turn the cab floor over to locate the two type H fixing screws (circled). Remove these screws and keep them safe.

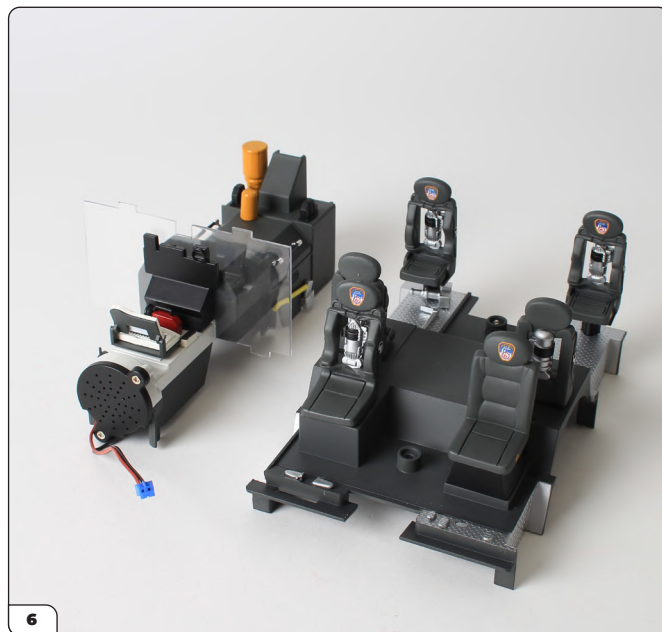

Lift the center console off the cab floor.

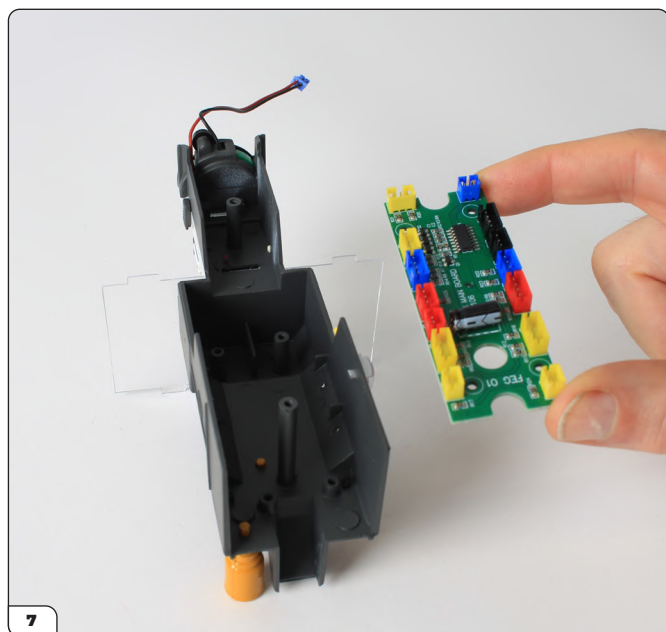

Turn the center console upside down and lower the main circuit board inside the console. The tall raised screw socket projects through the circuit board - see picture 8.

**Warning: take care when handling the circuit board. Hold the circuit board by the edges and avoid touching any of the other components on the board.**

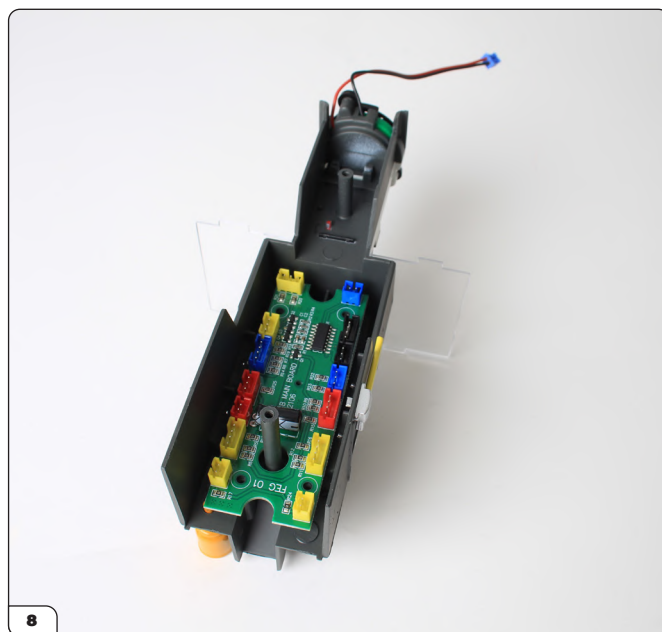

The plug sockets on the circuit board should face upwards.

# Stage 23: Fitting a Crew Seat, Installing the Main Circuit Board, Connecting the Dashboard & Lights, and Fitting the Front Cab Doors

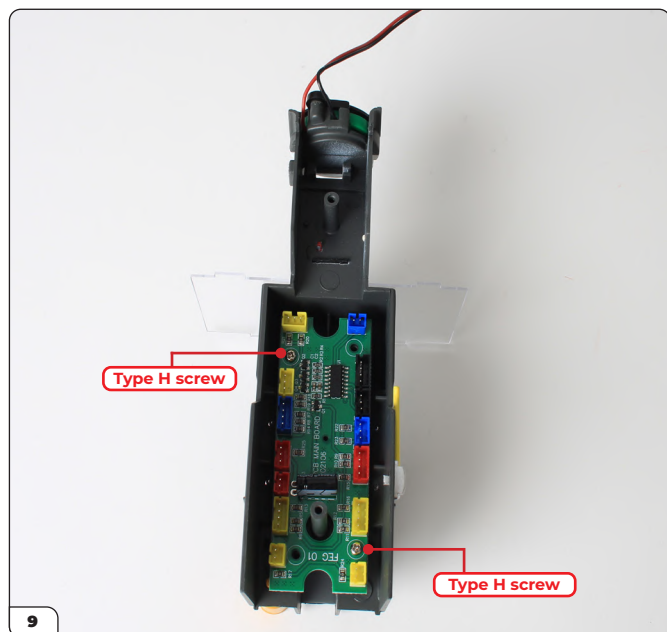

Secure the circuit board to the console with 2 x type H screws.

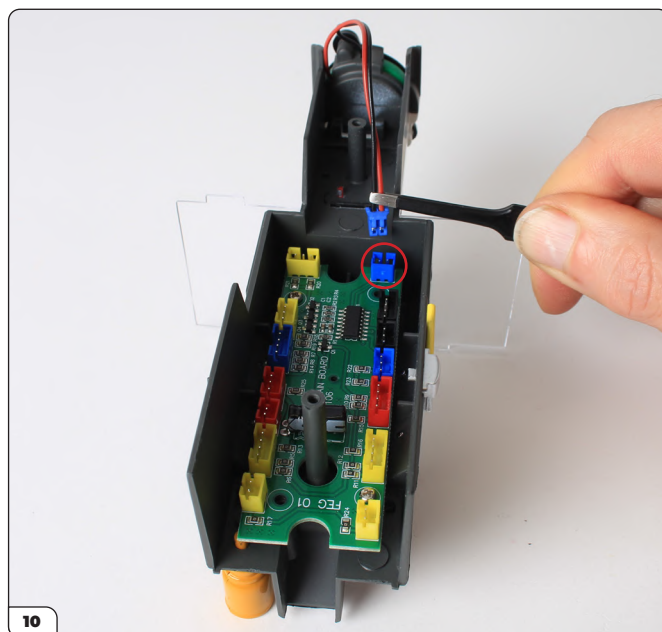

Grip the blue connector attached to the speaker and push it into the blue socket on the circuit board indicated above (circled).

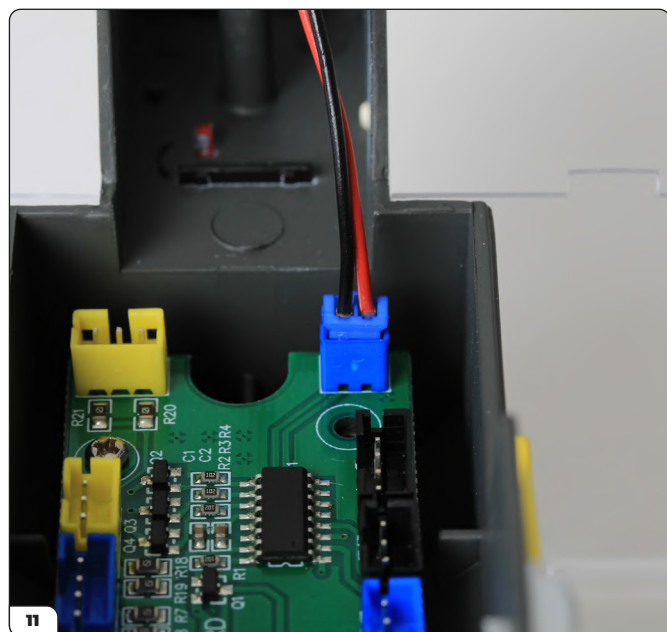

Push the connector firmly into the plug. The connectors will only fit one way round.

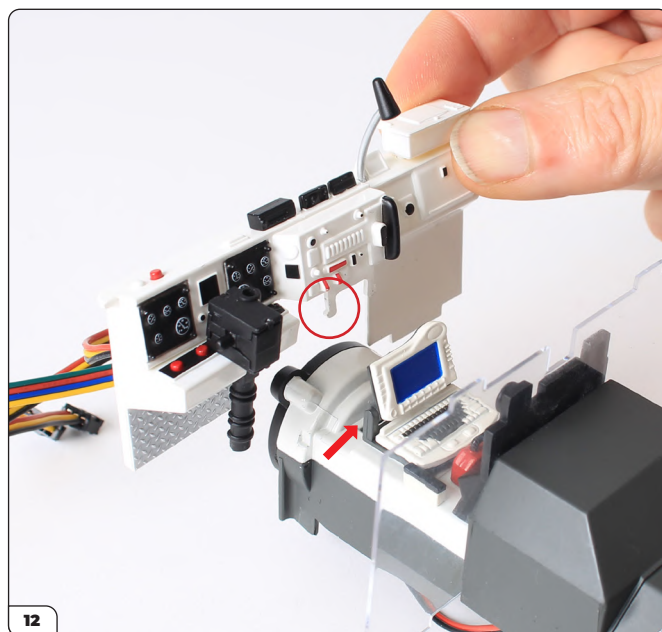

## CONNECTING UP THE DASHBOARD

Take the dashboard from Stage 19, aligning the projecting tabs in the center (circled) with the channel immediately in front of the mobile data terminal (arrow).

# Stage 23: Fitting a Crew Seat, Installing the Main Circuit Board, Connecting the Dashboard & Lights, and Fitting the Front Cab Doors

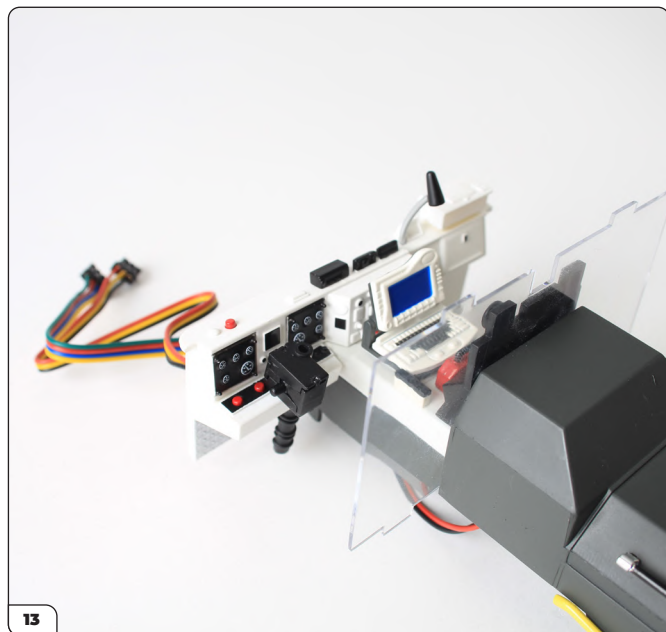

13

Push the dashboard firmly into place on the center console.

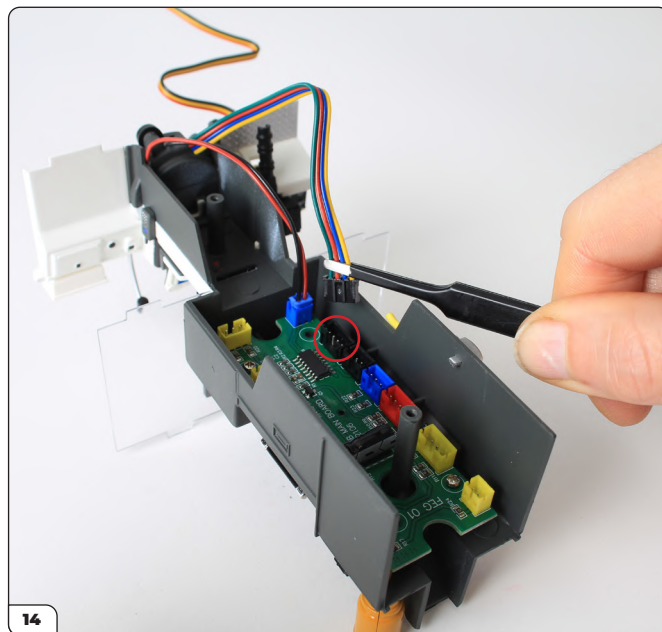

14

Turn the console over to access the main circuit board. Grip the connector from the dashboard with four colored cables (green, red, blue & yellow) and plug it into the nearest 4-pin black socket as shown.

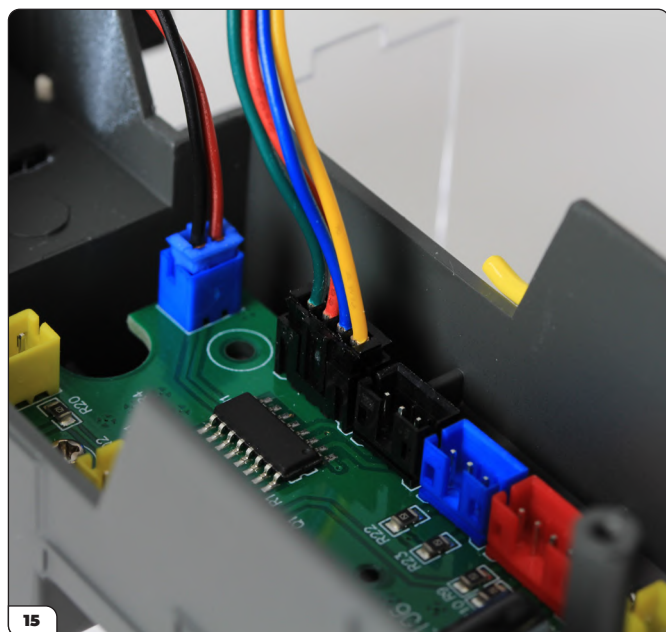

15

Plug the connector firmly into the socket.

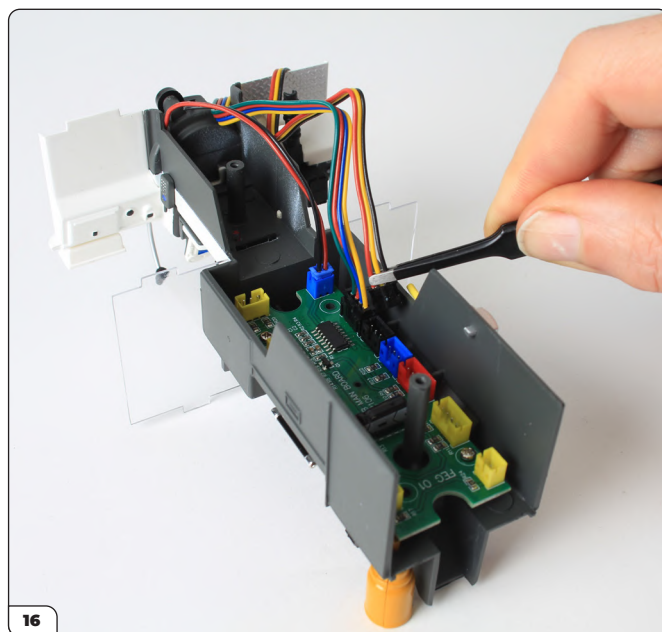

16

Grip the remaining dashboard connector at the end of the three cables (black, yellow and red). Ensure that the wires do not lay across the front of the loud speaker, as the front of the speaker will sit very close to the front grille. See picture 41 on page 71.

# Stage 23: Fitting a Crew Seat, Installing the Main Circuit Board, Connecting the Dashboard & Lights, and Fitting the Front Cab Doors

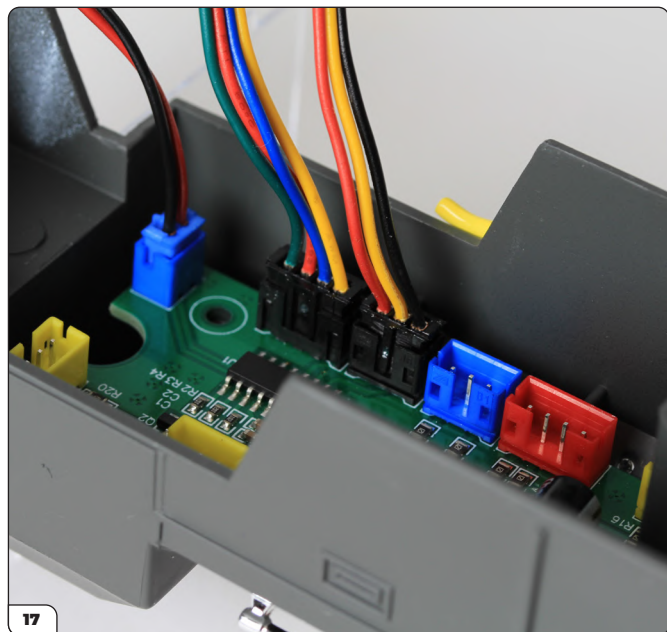

Plug the connector firmly into the 3-pin black socket adjacent to the previous black socket.

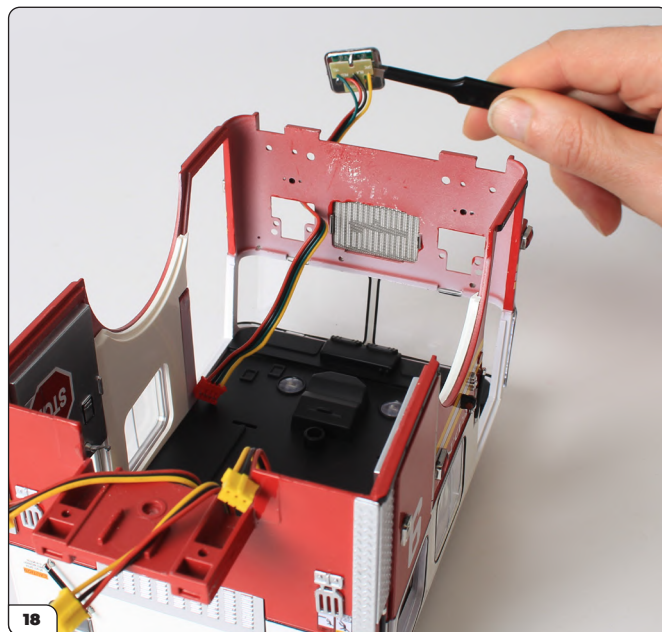

## ATTACHING THE LIGHT CLUSTERS AND FRONT DOORS

With the main cab upside down on your work surface, take the right-hand light cluster assembled in Stage 17. Pass the cable connector through the opening in the front of the main cab body as shown.

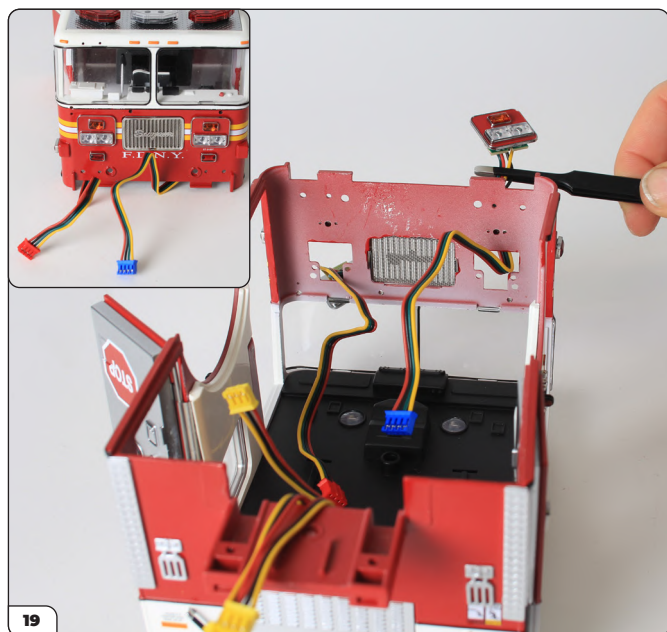

Repeat with the left-hand light cluster assembled in Stage 20. Gently pull the cables through until the lights sit flush on the front of the main cab body (inset).



Take the front-right cab door assembled in Stage 02, holding it upside down, feed the inner cab panel into the cab as shown.



# Stage 23: Fitting a Crew Seat, Installing the Main Circuit Board, Connecting the Dashboard & Lights, and Fitting the Front Cab Doors

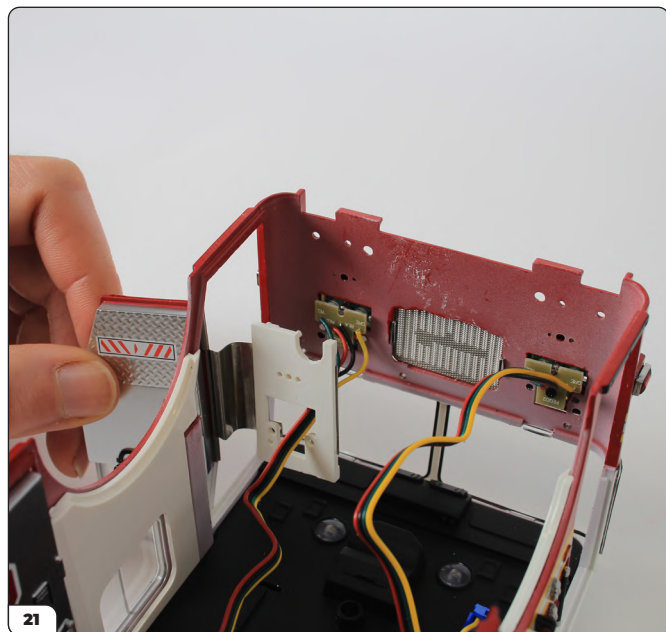

Pass the connector and cable for the front right lights through the opening in the inner door panel.

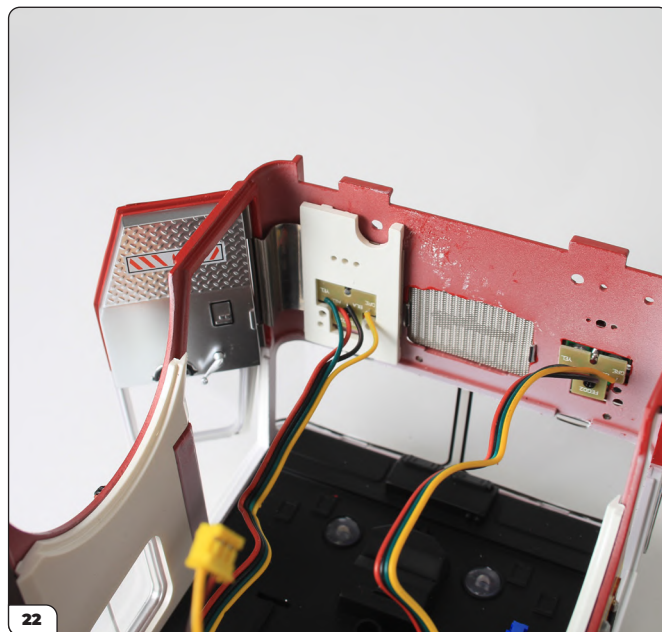

Push the lugs on the inner cab panel into the front wall of the main cab body.



Drive a type C screw from the outside, through the central screw hole to secure the door in place.

# Stage 23: Fitting a Crew Seat, Installing the Main Circuit Board, Connecting the Dashboard & Lights, and Fitting the Front Cab Doors



Fit another emergency light by pressing the lugs into the tiny holes either side of the type C screw.

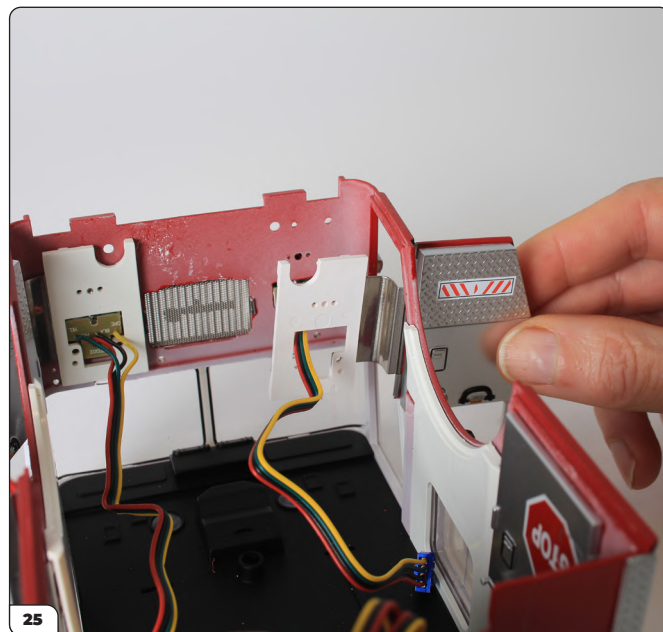

Repeat this process to fit the left-hand front cab door. Feed the cab door inner panel from outside the main cab body to the inside. Pass the connector and cable through the opening in the inner cab panel.

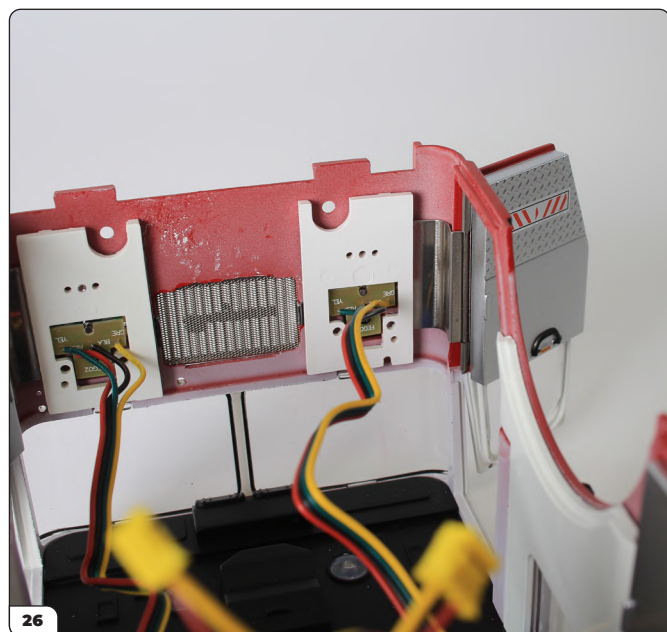

Press the lugs on the inner cab panel into the corresponding holes in the front wall of the main cab.

# Stage 23: Fitting a Crew Seat, Installing the Main Circuit Board, Connecting the Dashboard & Lights, and Fitting the Front Cab Doors

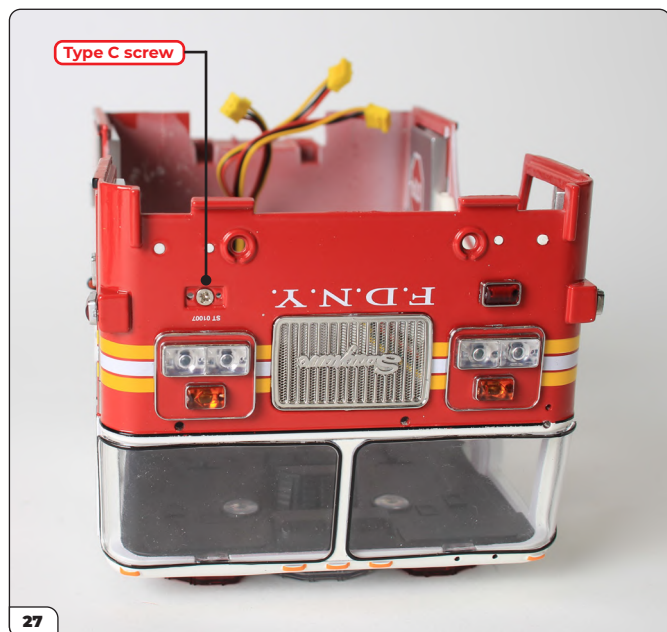

Drive a type C screw into the central screw hole.



Fit the final emergency light to the main cab body by pressing the lugs into the holes on either side of the type C screw.



## REATTACHING THE CENTER CONSOLE

Position the five cables so that they are projecting outside the main cab body. They must not get trapped when the center console is installed in the next steps. Note the two slots in the cab roof (circled).

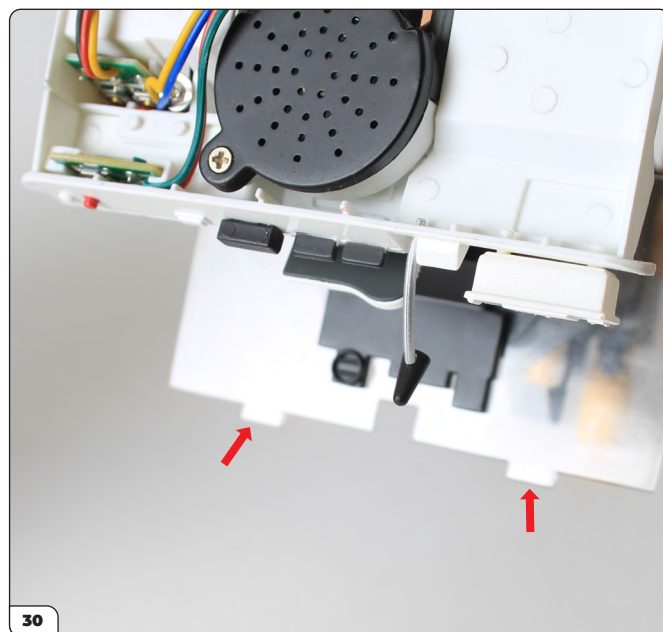

Take the center console and note the two tabs in the top edge of the cab divider glass (arrows – shown here held upside down).

**EXPERT TIP:** If the divider glass is not fitting correctly in the next steps, you can trim the side(s) to get a perfect fit using a craft knife and steel rule.

# Stage 23: Fitting a Crew Seat, Installing the Main Circuit Board, Connecting the Dashboard & Lights, and Fitting the Front Cab Doors

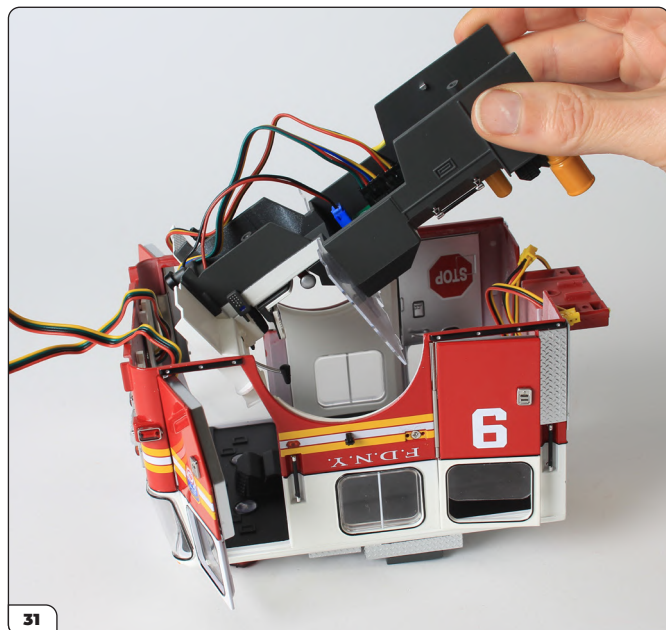

Holding the rear end of the center console, lower the assembly into the main cab body. Ensure the front light cables remain outside the cab. Direct the assembly so that the tabs on the cab divider glass sit in the slots in the cab roof. Thread the three cables at the rear of the cab through the hole in the main circuit board (see picture 33). This is a tight fit so you will need to gradually work the center console down into place.

## TOP TIP



The top of the dashboard aligns with the bottom edge of the front windshield. If it is a tight fit, try filling both corners of the dashboard.

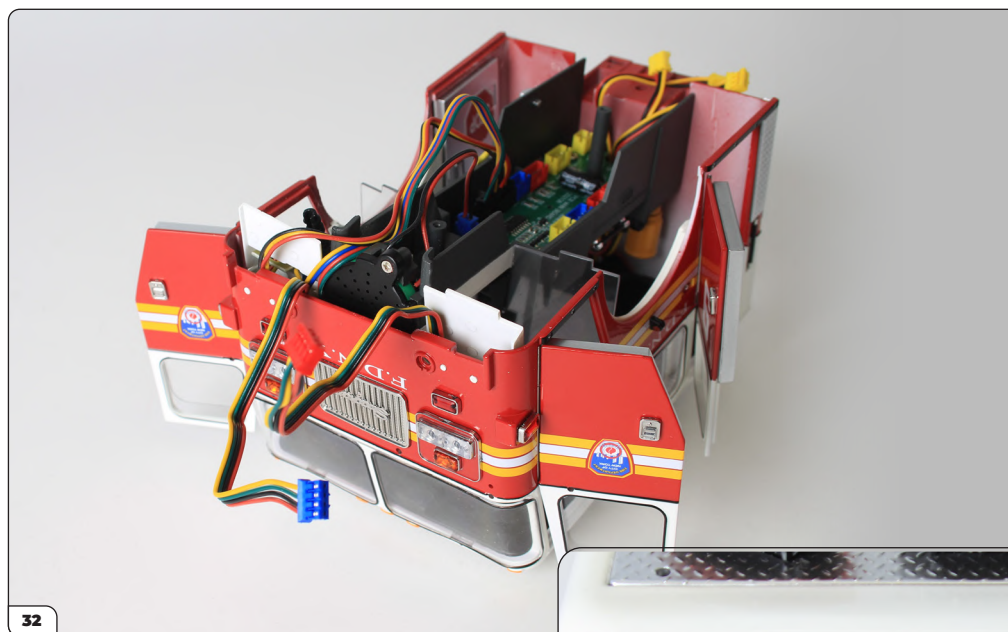

Gently push along the sides of the center console from front to back, then from back to front until the tabs sit in the slots in the roof (see picture 34, inset), and the top of the dashboard is flush with the front windshield (inset).



## Stage 23: Fitting a Crew Seat, Installing the Main Circuit Board, Connecting the Dashboard & Lights, and Fitting the Front Cab Doors

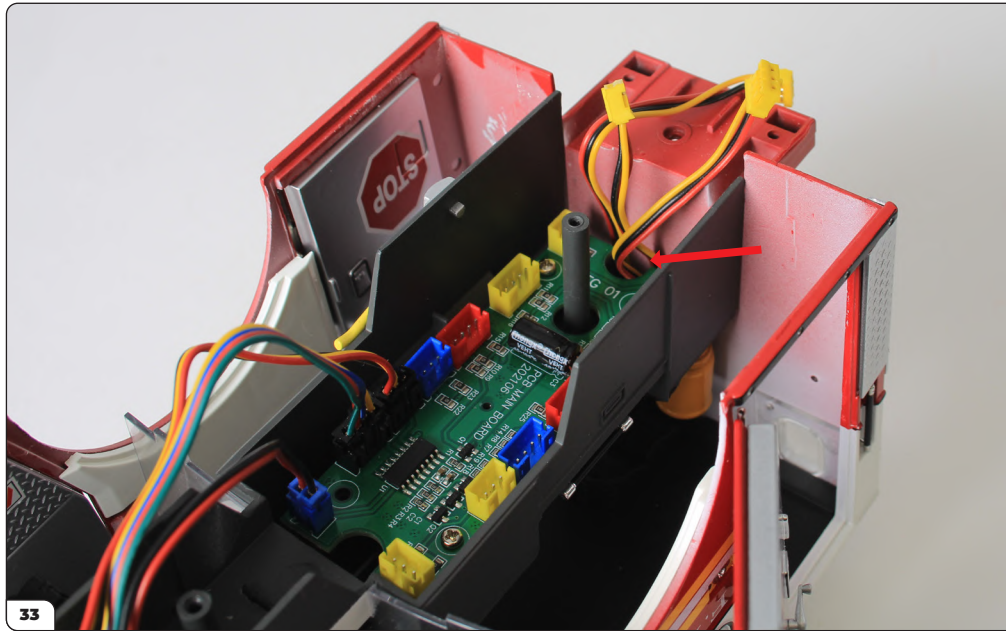

Check that the group of three lightbar cables from the roof (arrow) are threaded through the hole in the main circuit board. Pull them gently, but firmly to obtain maximum reach of the cables.

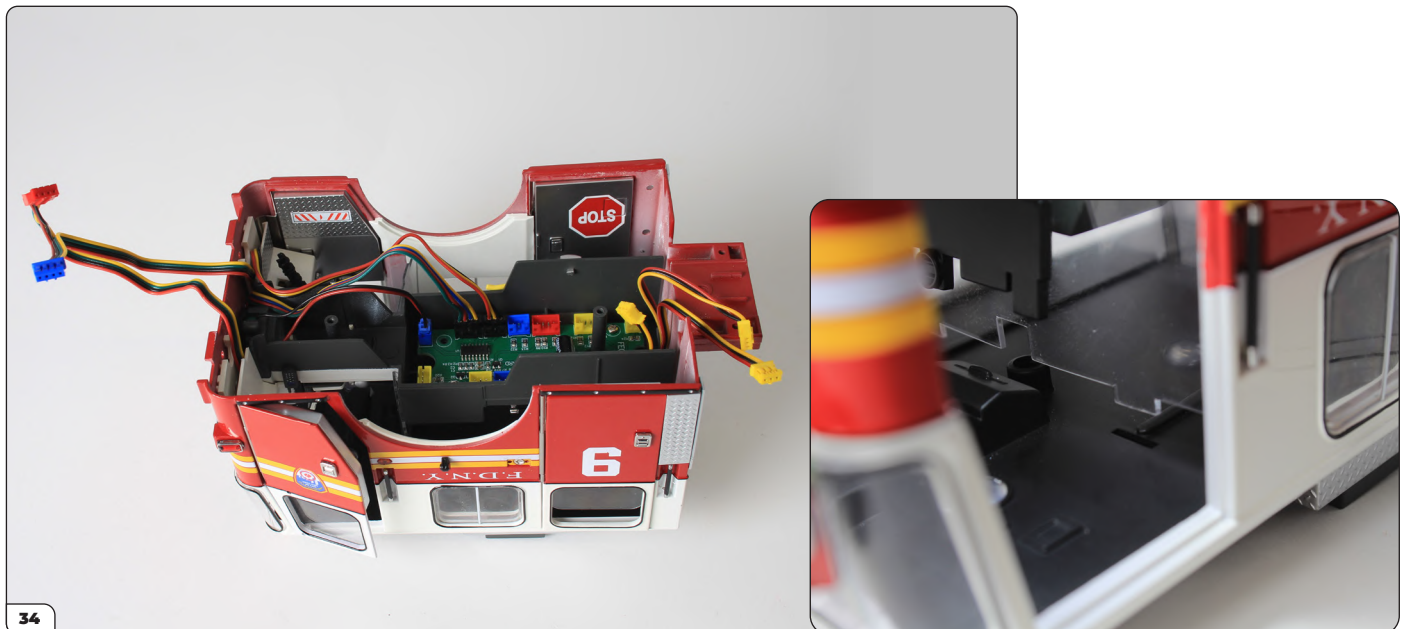

This is how the console should look when correctly in position. The inset picture shows the tabs on the cab divider glass ready to be pushed into the slots in the roof.

# Stage 23: Fitting a Crew Seat, Installing the Main Circuit Board, Connecting the Dashboard & Lights, and Fitting the Front Cab Doors

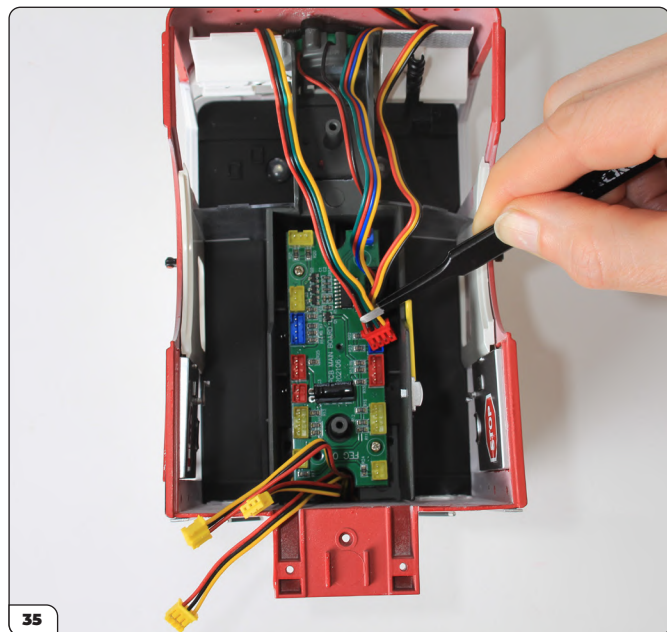

35 Grab the red connector from the front-right light cluster and plug it into the red 4-pin socket as shown.

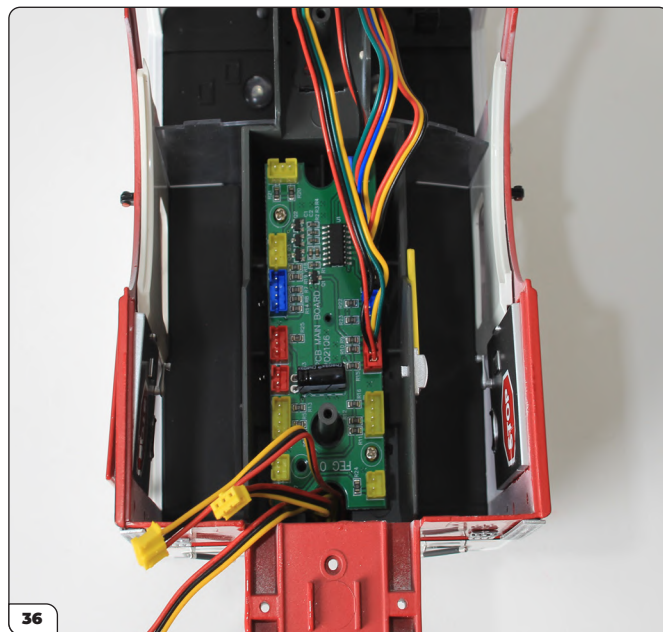

36 Push the connector firmly into the socket.

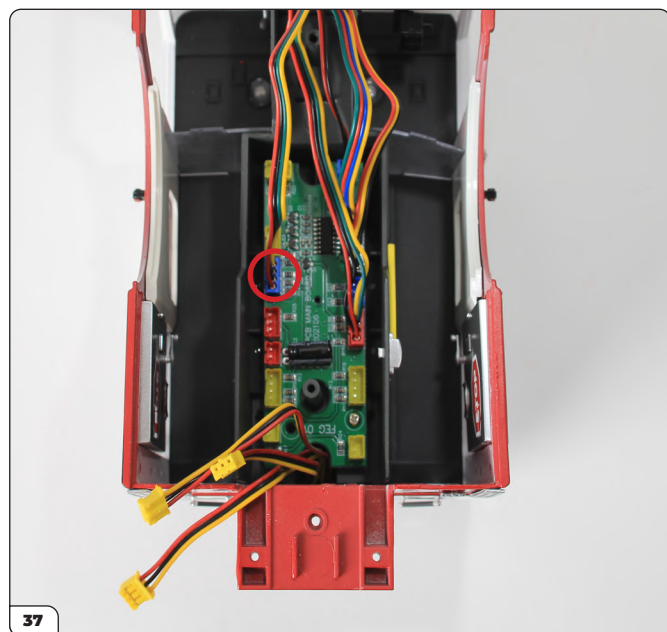

37 Plug the blue connector from the front-left light cluster into the blue 4-pin socket as shown.

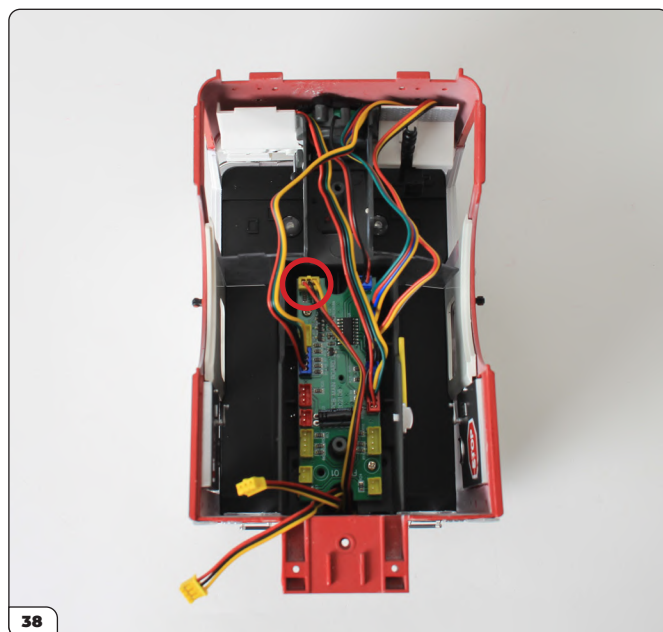

38 Plug one of the three roof LED light bar plugs into the furthest yellow 3-pin socket on the circuit board. Note: You may wish to check the available lengths of the three yellow 3-pin cables, and plug them in from longest to shortest for steps 38-40.

# Stage 23: Fitting a Crew Seat, Installing the Main Circuit Board, Connecting the Dashboard & Lights, and Fitting the Front Cab Doors

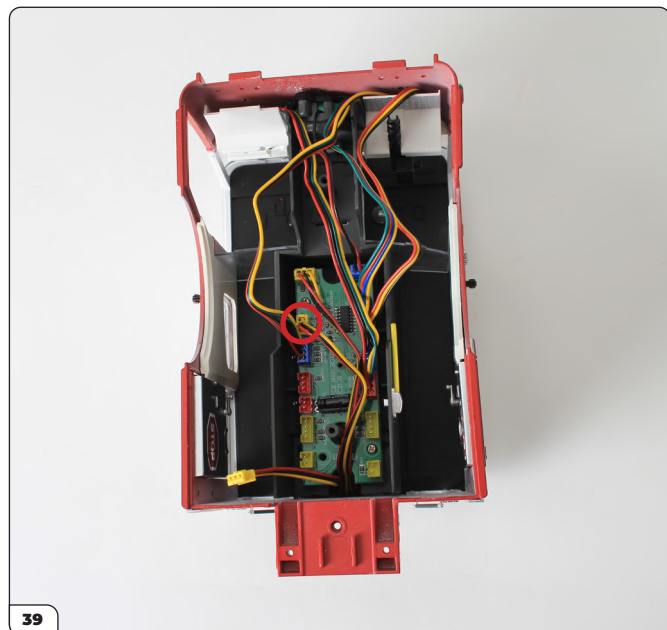

Plug another yellow plug from the group of three roof LED light bar lights into another yellow 3-pin socket as shown.

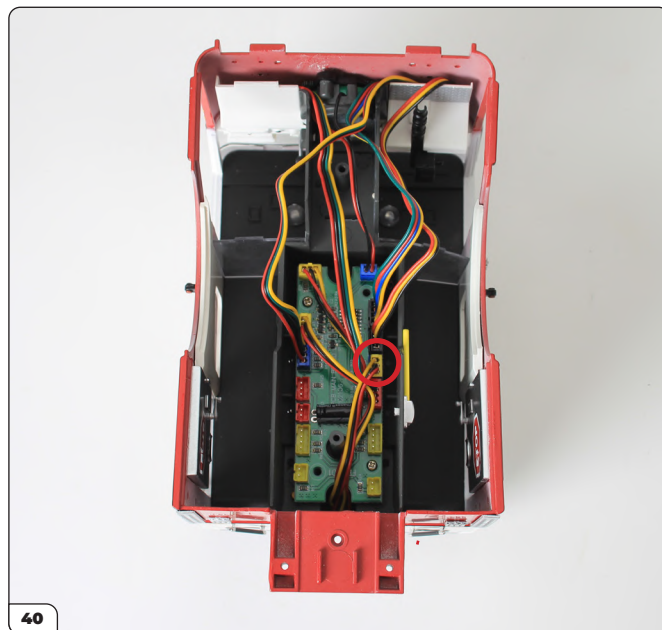

The third yellow plug from the roof LED light bar plugs into the blue 3-pin socket adjacent to the two black sockets. The socket is a different color to the plug, but this is the correct position. Note: Any of the three yellow plugs may be fitted into this blue socket.

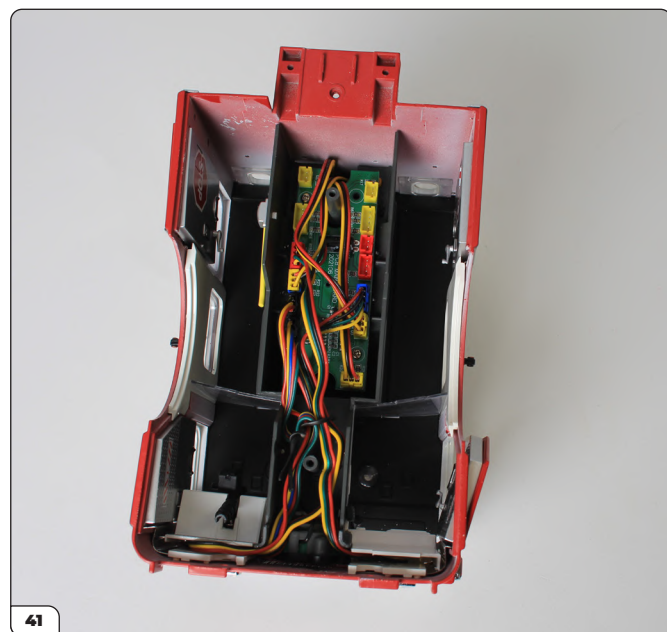

Tidy the cables so that they are all routed in the center console. The cable tidy supplied is useful for this.

# Stage 23: Fitting a Crew Seat, Installing the Main Circuit Board, Connecting the Dashboard & Lights, and Fitting the Front Cab Doors

STAGE COMPLETE

