

1955

MERCEDES-BENZ

300 SL

GULLWING



Pack 01

BUILD INSTRUCTIONS

STAGE 01: GRILLE AND HOOD

STAGE 02: FRONT LEFT WHEEL

STAGE 03: INSTRUMENT PANEL

STAGE 04: LEFT ENGINE BLOCK

"MERCEDES-BENZ" and  are the intellectual property of Mercedes-Benz Group AG.
They are used by Agora Models under license.

AGORA
MODELS®

Advice from the experts

Spare screws are included with each part. Occasionally, you may be instructed to keep spare or unused screws for a later stage. Keep these spares in a safe place and label them correctly.

Please make sure you don't mix up the screws. They look quite similar, but the threads do vary slightly. Using the wrong screws may damage the parts.

When securing parts together using multiple screws, fit each screw loosely to ensure all the parts are correctly aligned before gently tightening them firmly, but not overtight, in the order in which you placed them.

The screwdriver can be magnetized by stroking it with a magnet (fridge magnet, etc.) enabling it to hold the screws and make assembly easier.

If a screw is tight going into a metal part, do not force it as you may shear the head off. Remove it and put a tiny smear of Vaseline, soap or light oil on the thread. That will lubricate it and make it easier to drive home.

During the course of this build, you will receive many pieces that you will assemble immediately – following the instructions in the corresponding stage – and other pieces that you should store safely to one side, for use in future assembly stages.

Left and Right! When building your Mercedes-Benz 300SL, the left or right hand side refers to each side as you are sitting in the car.



WARNING: Some parts are assembled using magnets. These magnets can cause serious injury if they are swallowed. Keep away from children. If you suspect a magnet has been swallowed, seek medical help straight away.

STAGE 1: GRILLE AND HOOD

COLOR CODING

The color coding of the parts shows how they should fit together.

RED indicates screws and the right position.

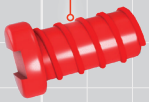

YELLOW indicates new parts.



GRAY-BLUE indicates the modules to which the new parts should be fitted.

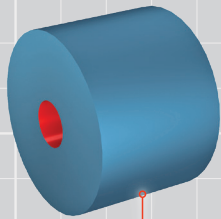

Start building the model by assembling the radiator grille and preparing the hood for assembly.

STAGE 1 - REQUIRED PARTS

Code	Name	Quantity	Material
01A	Engine hood	1	Zinc
01B	Radiator grille	1	ABS
01C	Grille mesh	1	Photo-etched
01D	Support rod	1	Iron
AP	Screws 1.5 x 3mm	7+3*	Iron

* Replacement screws included



01 POSITIONING THE SUPPORT ROD

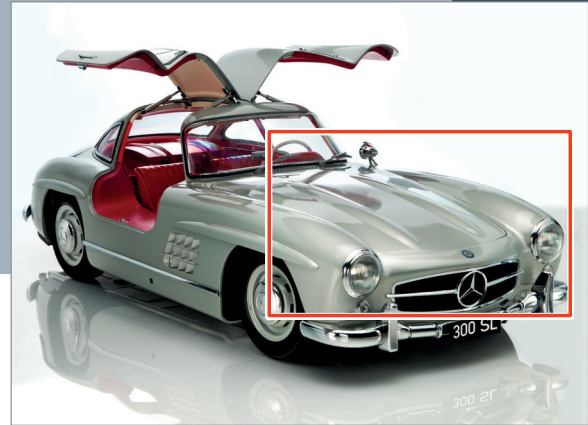
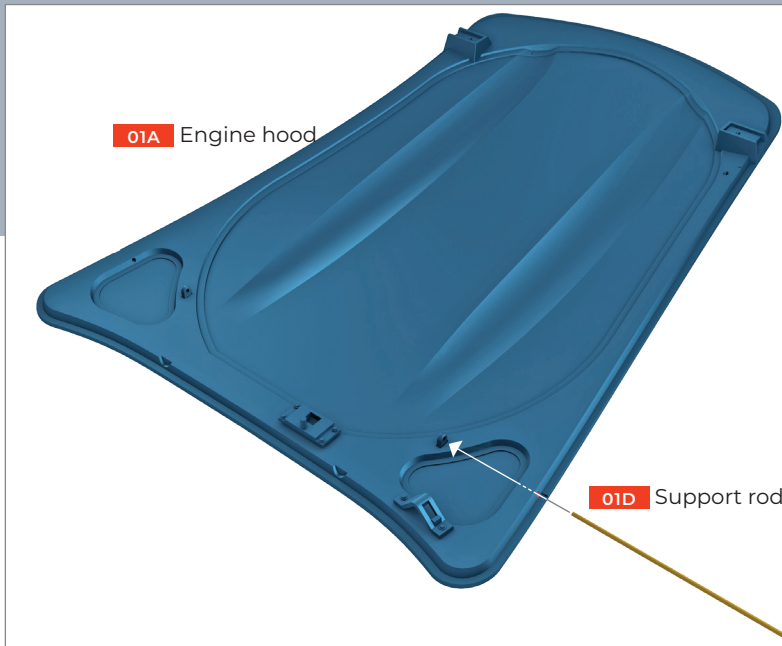

Slide the support rod **01D** through one of the holes on the edge of the hood **01A**, then gently push it through both rings in the supports (fig. 1) until it reaches the hole on the opposite side (fig. 2).

Fig.1

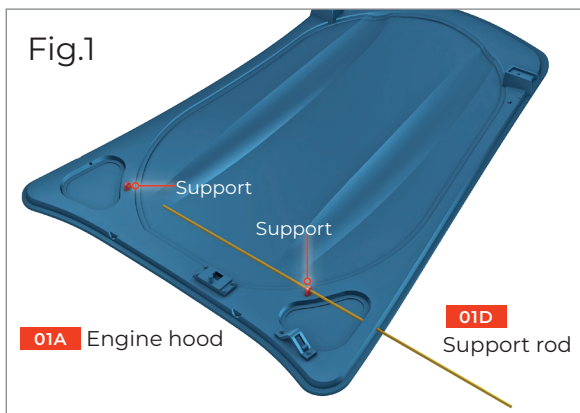

Fig.2



To avoid damage during assembly, place all painted parts on a soft cloth or an assembly mat.

02 ASSEMBLY OF THE RADIATOR GRILLE

Lay the grille mesh **01C** on the inside of the radiator grille **01B** so that the holes of both pieces match. Fix the mesh to the grille with seven **AP** screws (fig. 1). Attention: leave the two holes at the ends free.

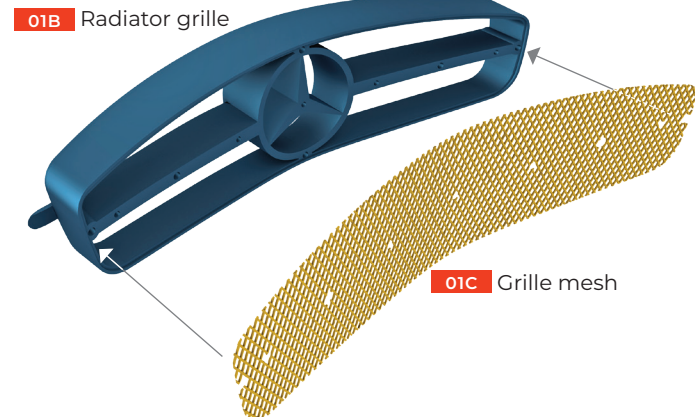
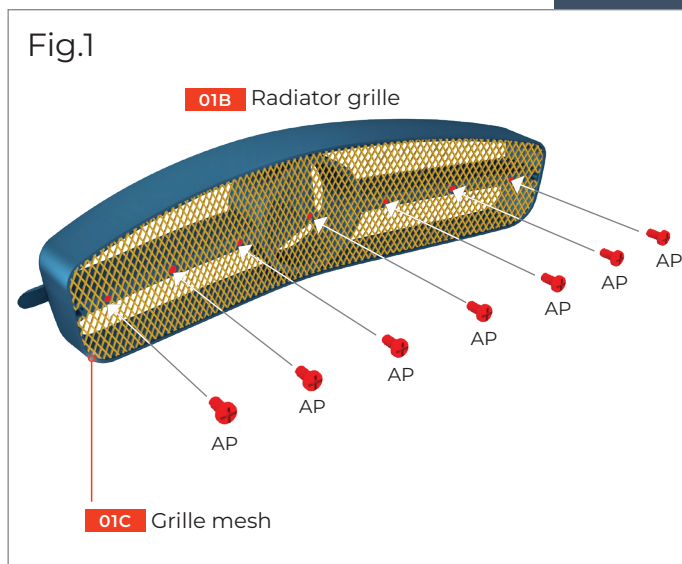

Fig.1



STAGE 2: FRONT LEFT WHEEL

In this stage, you will fit the tire onto the rim of the front left wheel and its brake drum.

STAGE 2 - REQUIRED PARTS

Code	Name	Quantity	Material
02A	Front left tire	1	PVC
02B	Front left rim	1	Zinc
02C	Brake drum	1	ABS
02D	Support plate and brake lines	1	ABS and PVC
02E	Hubcap	1	ABS
MM	Screws 2.3 x 4mm	2+1*	Iron
-	Screwdriver	1	

* Replacement screws included.



01 PREPARING THE TIRE

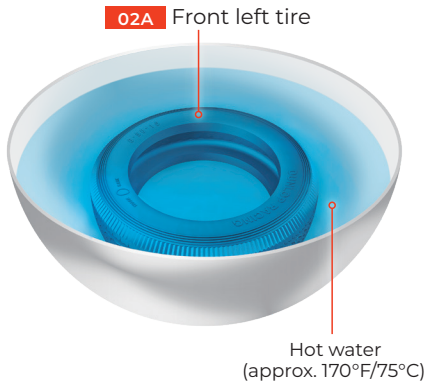

The front left tire **02A** is difficult to bend at room temperature, and it is hard to press onto the rim. We recommend placing it in a container of hot water (approx. 170°F/75°C) for a few minutes. When warm, it will soften for an easy fit.

02 FITTING THE TIRE

Place the rim **02B** inside the tire **02A** as shown in the picture and carefully press the sides to adjust it onto the edge of the rim so that it is evenly distributed. Attention: while fitting the tire be careful with the inflation valve as it is very fragile.

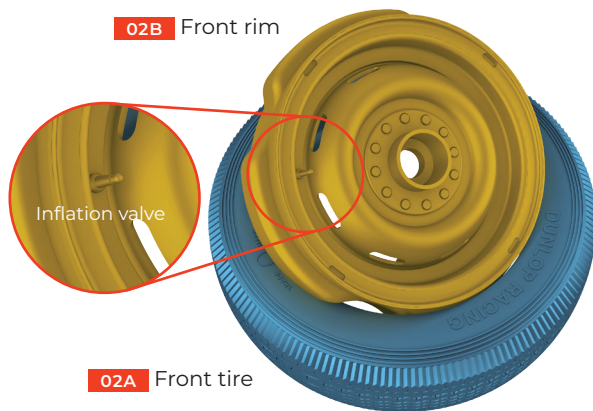

03 ASSEMBLING THE BRAKE DRUM

Place the brake drum **02C** on the inside face of the front rim **02B** as shown below. To fix it in place, use two **MM** screws.

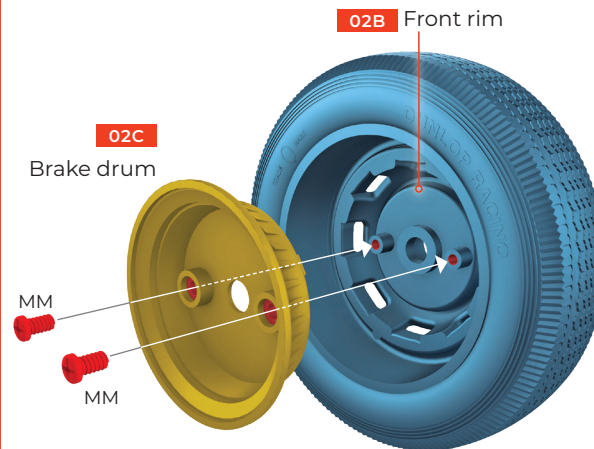

Attention: Hot water may cause burns! Do not remove the tire from the water with your fingers.

04 HUBCAP, SUPPORT PLATE AND BRAKE LINES

The hubcap **02E** will be placed in the center of the left front rim **02B** at a later stage since the rim must first be fixed to the shaft with a screw. This illustration shows how the hubcap will fit on the rim. Later on, the support plate and brake lines **02D** will be assembled. Until you reach that point, keep both pieces safe.

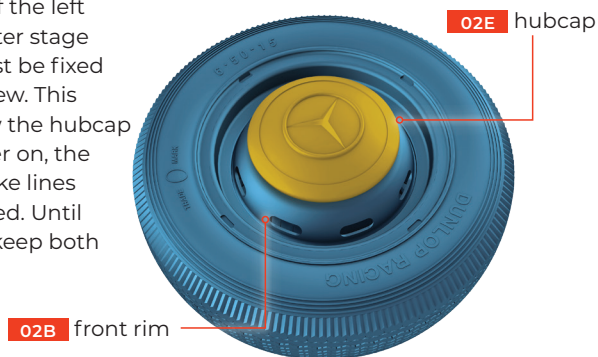

Keep these pieces safe. They will be assembled at a later stage.



STAGE 3: INSTRUMENT PANEL

In this stage, you will assemble your 300 SL's dashboard, which includes the fuel and oil pressure gauges, along with the levers and switches for the air conditioning. You'll also place the discs for the speedometer and tachometer, as well as the steering wheel with its column. Also included are the levers for the windshield wipers and turn signals, but these can be stored away now, as they'll be fitted in a later stage.

COLOR CODING

The color coding of the parts shows how they should be put together.

RED indicates the screws and the correct position.



YELLOW indicates new parts.

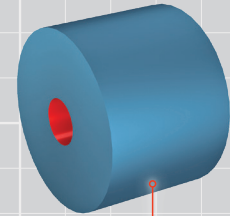

GRAY-BLUE indicates the modules on which the new parts should be assembled.

STAGE 3 - REQUIRED PARTS

Code	Name	Quantity	Material
03A	Dashboard	1	ABS
03B	Decorative instrument panel	1	ABS
03C	Turn signals and windshield wiper stalks	1	ABS
03D	Speedometer and rev counter	1	ABS
03E	Steering wheel	1	Divers
03F	Steering column	1	ABS
EP	Screws 1.7 x 4mm	5 + 2*	Iron

* Replacement screws included

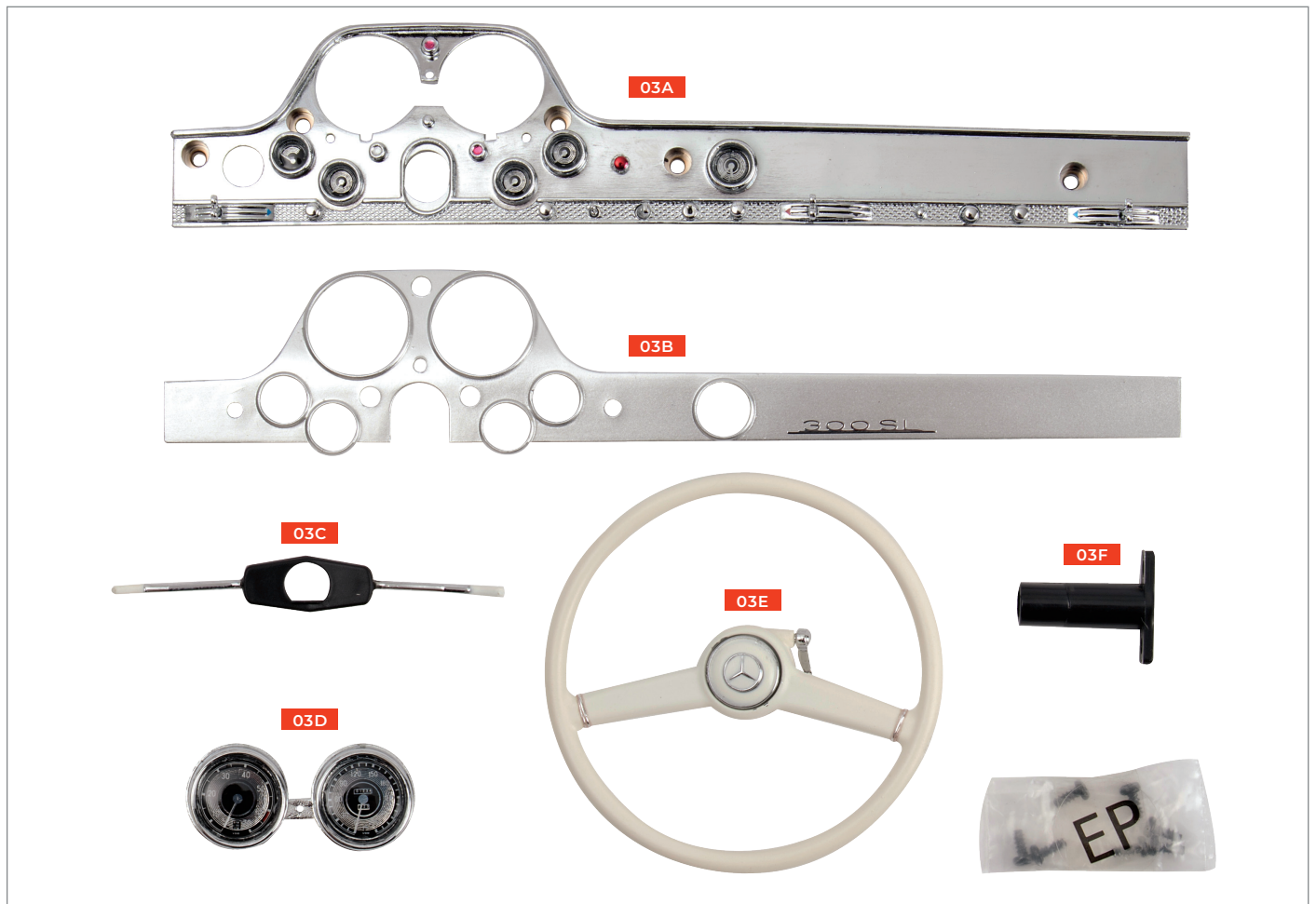

01 ASSEMBLING THE DECORATIVE PANEL PART 1

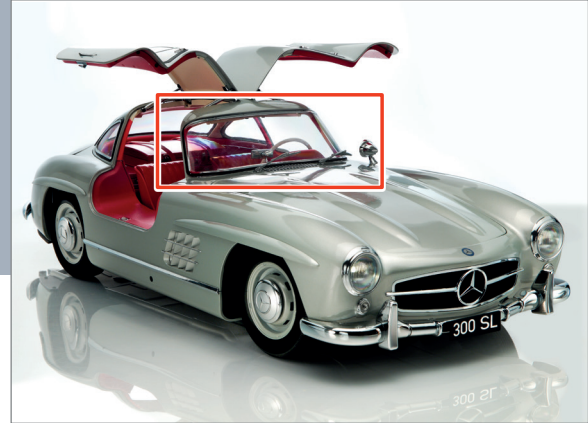
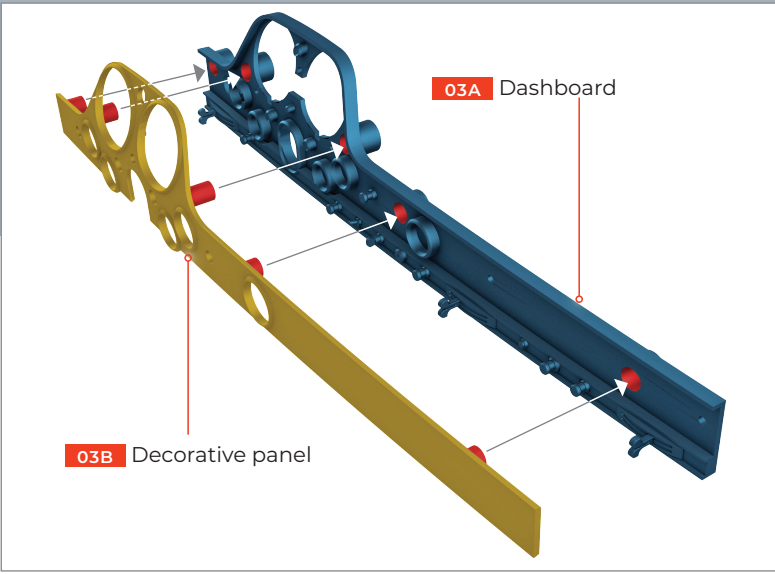

Place the decorative panel of the dashboard **03B** onto the instrument panel **03A**, positioning the five trunnions of the panel to match the holes in the dashboard.

02 ASSEMBLING THE DECORATIVE PANEL PART 2

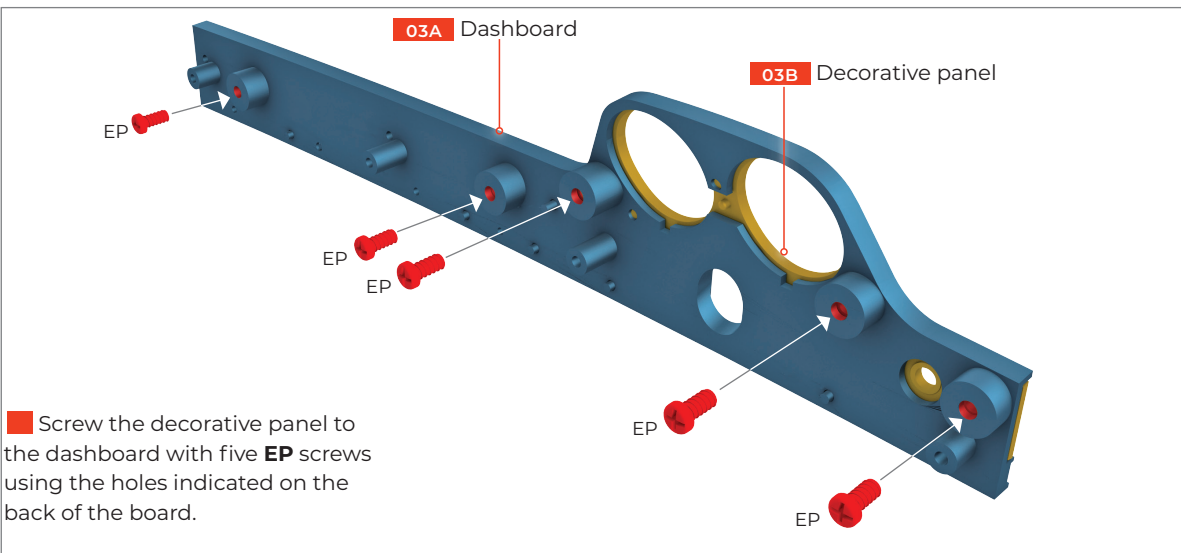

Screw the decorative panel to the dashboard with five **EP** screws using the holes indicated on the back of the board.

Caution!
Tightening screws too much could damage the panel.

The steering wheel is an exact copy of the original, and can also be folded down to facilitate access for the driver when entering and exiting the car. To unlock the steering wheel, move the lever at the center of the steering wheel upwards (fig. 1). Now the steering wheel can be folded down (fig. 2). To fix it in place again, raise the steering wheel to its normal position and move the lever down.

Caution – this is a fragile mechanism, so handle with care.

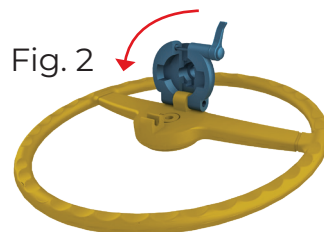
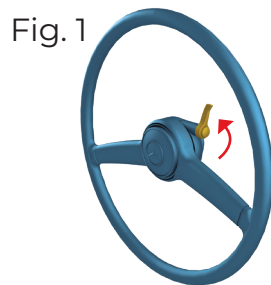

Keep these parts in a safe place.
They will be assembled at a later stage.

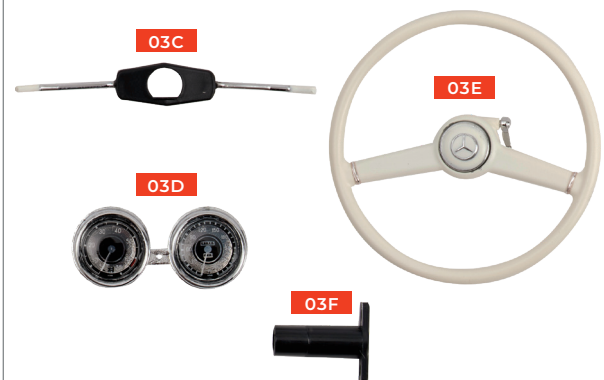

STAGE 4: LEFT ENGINE BLOCK

In this stage, you will assemble the first parts of the engine, and you will also join the fuel injection pump and the injection pipes to the left engine block.



STAGE 4 - REQUIRED PARTS

Code	Name	Quantity	Material
04A	Left engine block	1	Zinc
04B	Fuel injection pump	1	ABS
04C	Flywheel cover	1	ABS
04D	Support	1	ABS
04E	Injection pump linkage	1	ABS
04F	Bearing support	1	ABS
04G	Fuel pump	1	ABS
04H	Injection pipes (cylinders 5 & 6)	1	ABS
04I	Injection pipes (cylinders 3 & 4)	1	ABS
04J	Injection pipes (cylinders 1 & 2)	1	ABS
MP	Screws 0.09 x 0.15in (2.3 x 4mm)	7 + 3*	Iron
-	Tweezers	1	Stainless steel

* Replacement screws included

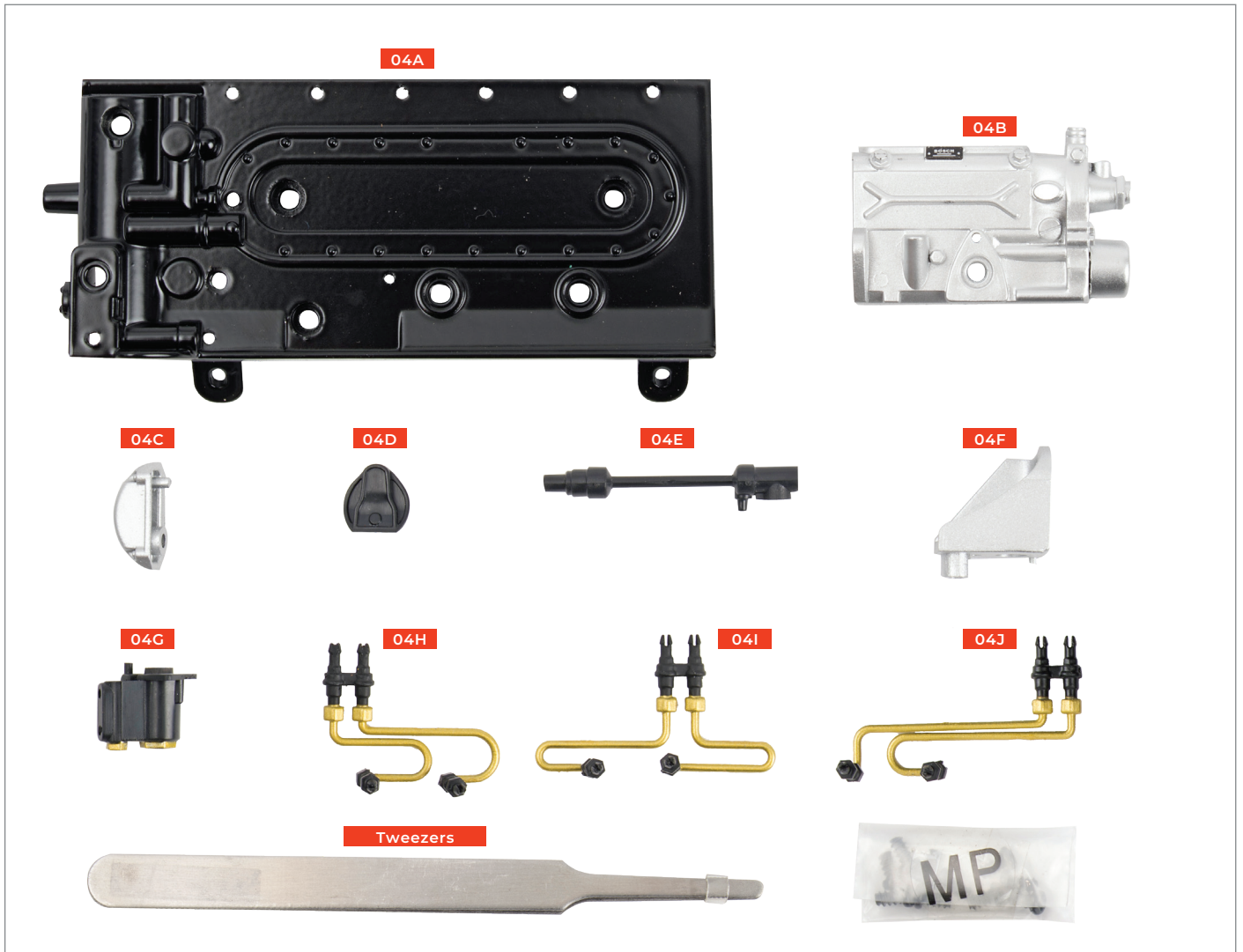

01 FITTING THE FUEL PUMP

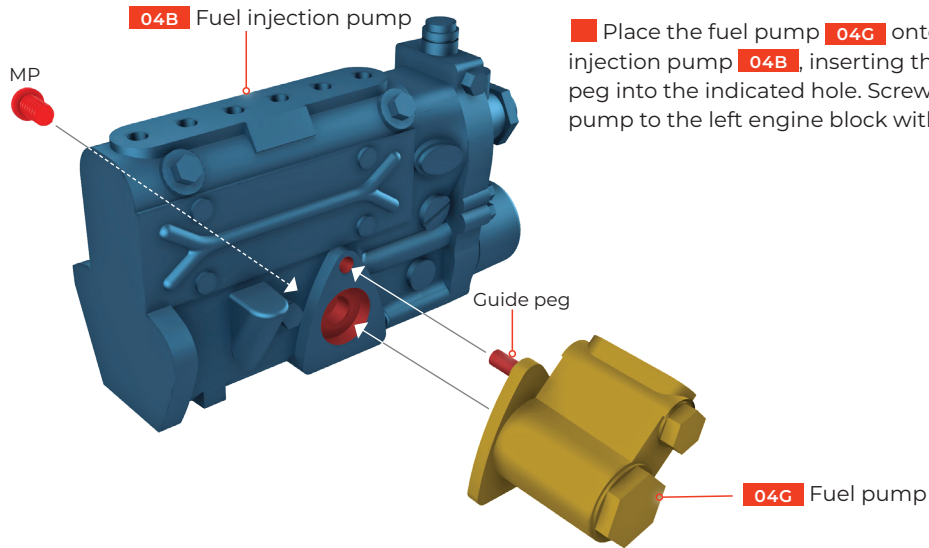

02 FITTING THE FUEL INJECTION PUMP

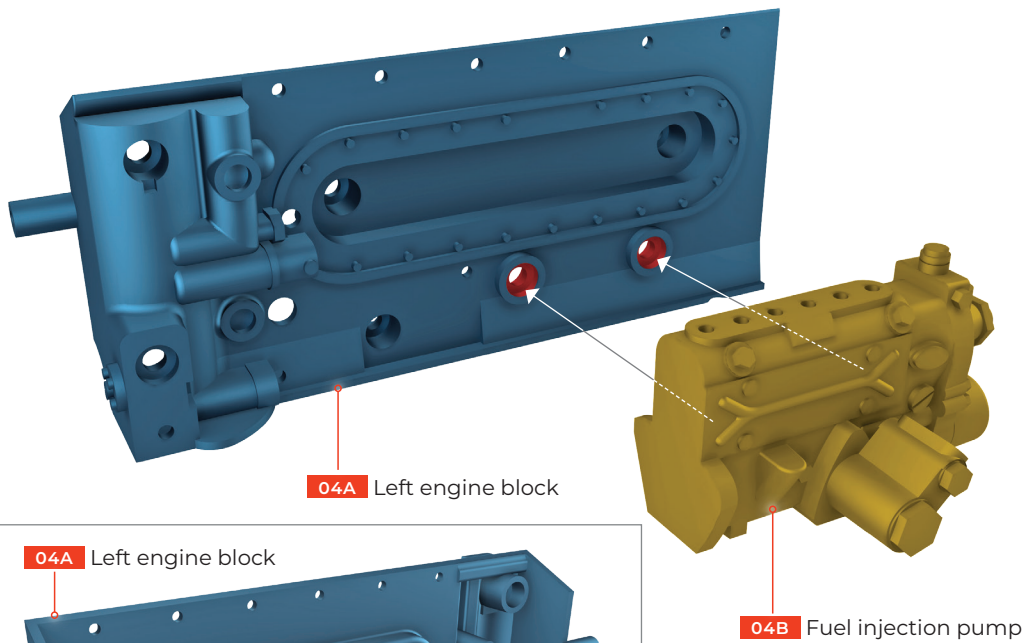
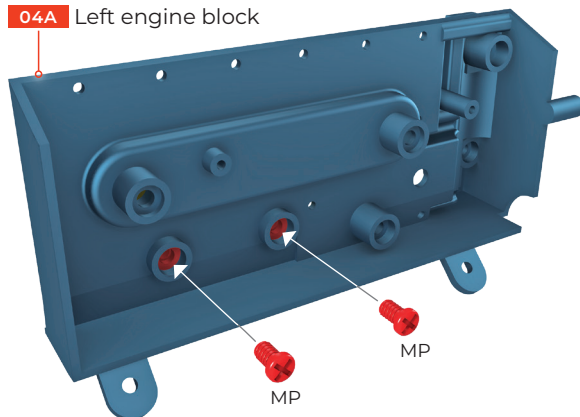

Fig. 1 04A Left engine block



Position the fuel injection pump 04B onto the outside of the left engine block 04A and attach it from the inside with two MP screws (fig. 1).

Between the two pieces, there should be a small space.

03 FITTING THE SUPPORT

Insert the support **04D** into the hole provided for it on the upper left side of the left engine block **04A**. Screw the part in place with an **MP** screw.

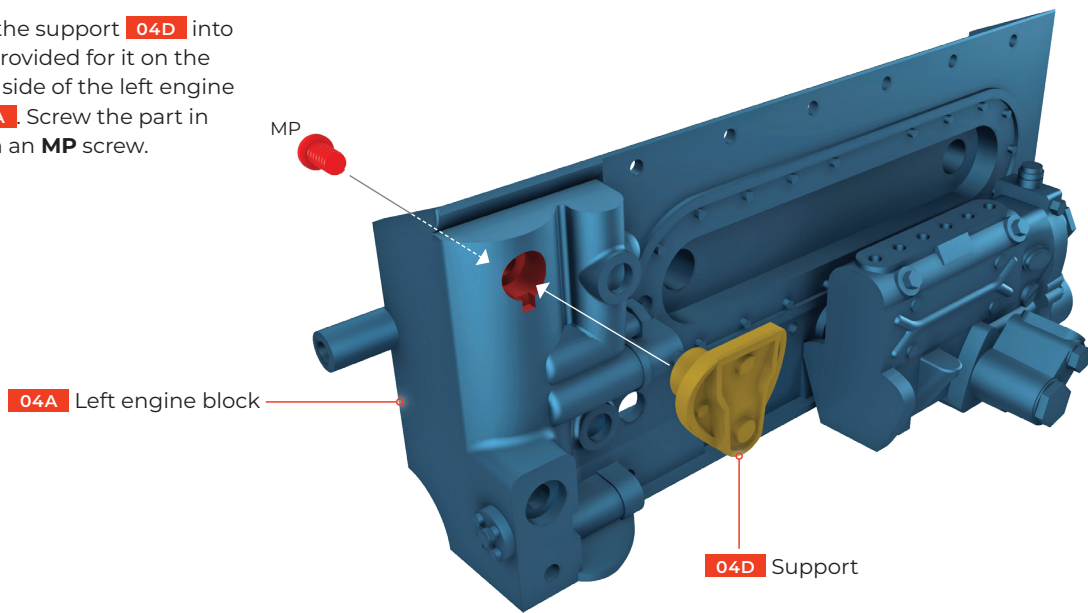

04 FITTING THE INJECTION PUMP LINKAGE

04E Injection pump linkage

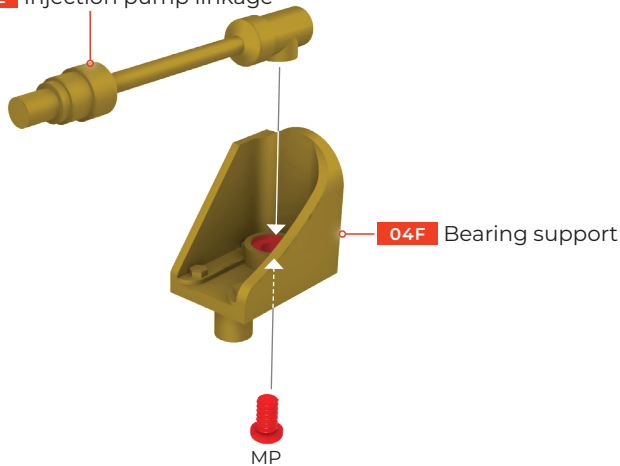

Insert the wide end of the injection pump linkage **04E** into the center hole of the bearing support **04F** and secure it with an **MP** screw. Next, place the bearing support **04F** onto the left engine block **04A**, as shown in Figure 1. The small pin of the bearing support should be inserted into the small hole in front of the injection pump. The free end of the linkage must be located in a small slot in the front left of the engine block (fig. 1). Fix the bearing support in place from the inside of the block with another **MP** screw (fig. 2).

Fig. 1 **04A** Left engine block

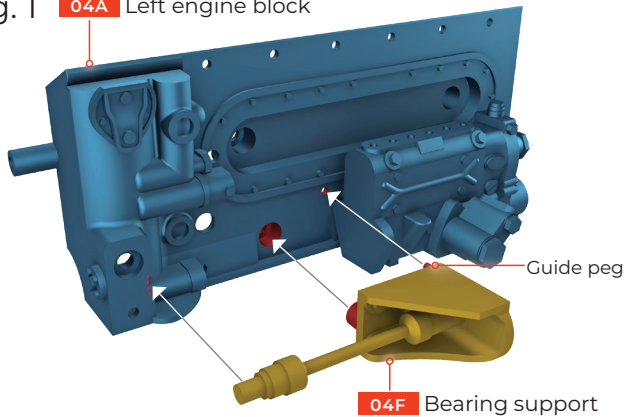
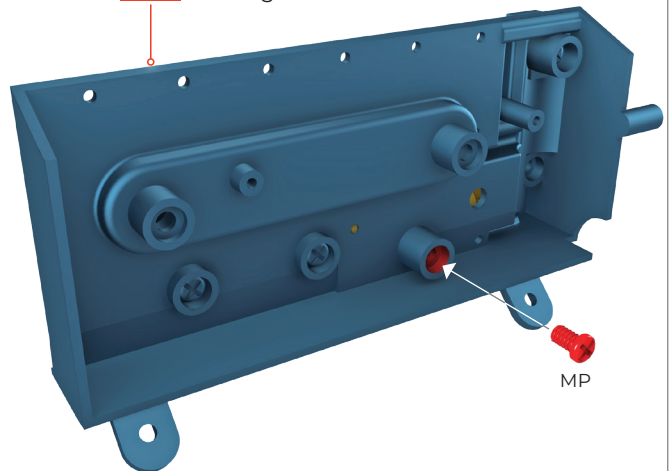
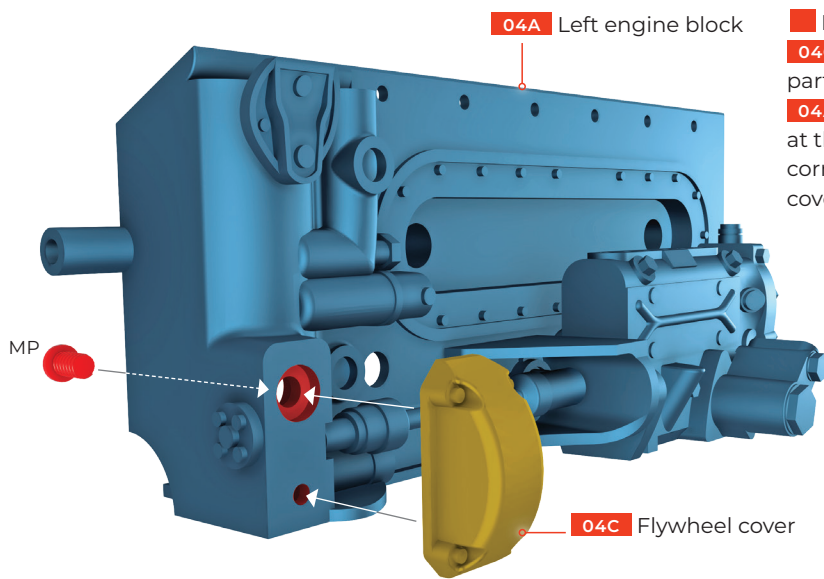

Fig. 2

04A Left engine block



05 FITTING THE FLYWHEEL COVER



Position the flywheel cover 04C onto the base of the front part of the left engine block 04A, making sure the small pin at the bottom is located in the correct hole as shown. Fix the cover in place with an MP screw.

06 CONNECTING THE FUEL INJECTION PIPES

Take the injection pipes 04H and insert the two joined ends into the two rear holes of the upper face of the injection pump 04B. Next, press the two free ends into the indicated holes in the left block of the motor 04A. Repeat this operation to connect the other injection pipes 04I (fig. 1) and 04J (fig. 2), assembling each pair of pipes to the left of the previously connected pair.

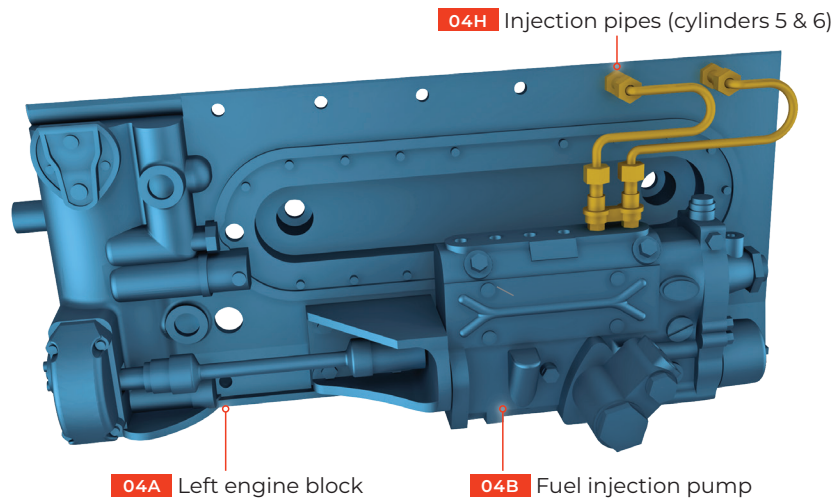

Use the tweezers to connect the injection pipes. Every part has a unique shape so it can only fit in the hole provided for it.

