

# TITANIC

THE SHIP • THE LEGEND

**Pack 10**



# DECKHOUSE AND OTHER DETAILS

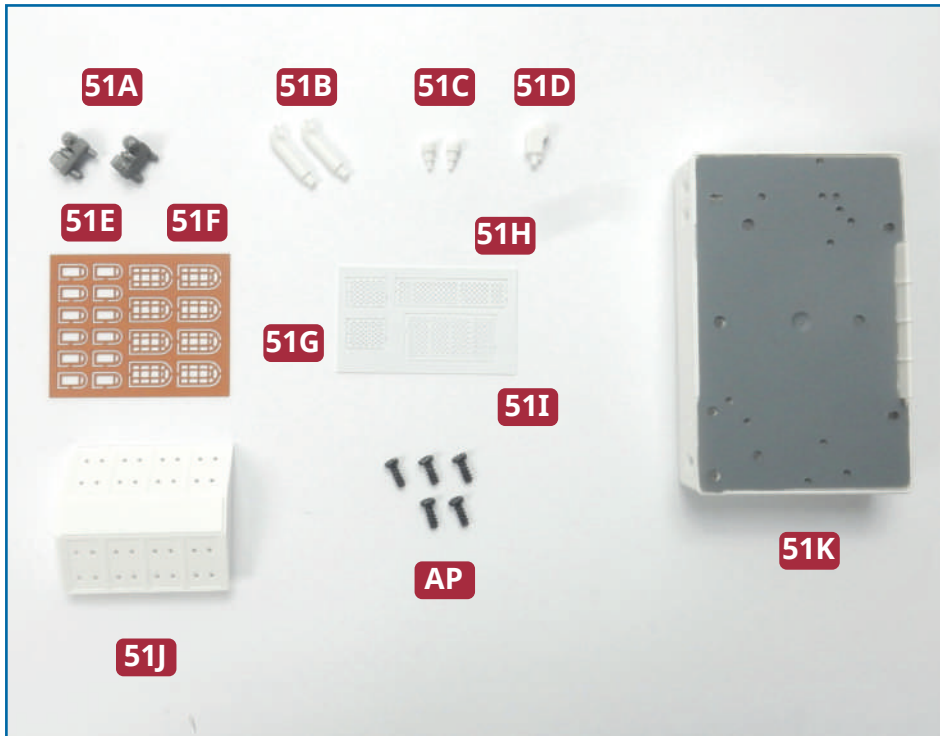

## PARTS IN THIS ISSUE

- 51A** Winches (x 2)
- 51B** Cowls (x 2)
- 51C** Vents (x 2)
- 51D** Hooded vent
- 51E** Small windows (x 12)
- 51F** Large windows (x 8)
- 51G** Grille A (x 2)
- 51H** Grille B
- 51I** Grille C
- 51J** Deckhouse skylight
- 51K** Deckhouse
- AP** Five 2.3 x 5mm PB screws (not used at this stage)

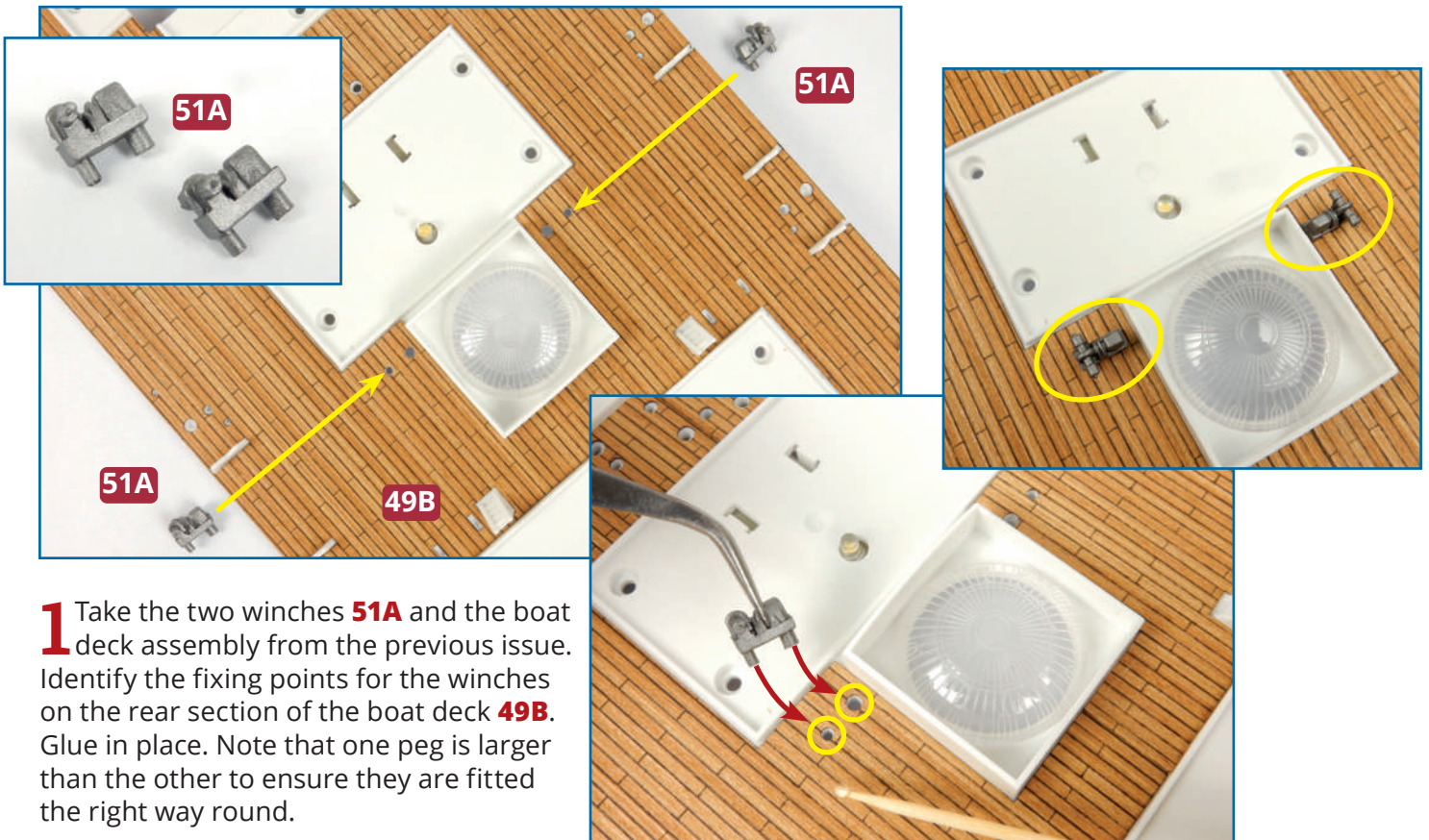

**1** Take the two winches **51A** and the boat deck assembly from the previous issue. Identify the fixing points for the winches on the rear section of the boat deck **49B**. Glue in place. Note that one peg is larger than the other to ensure they are fitted the right way round.

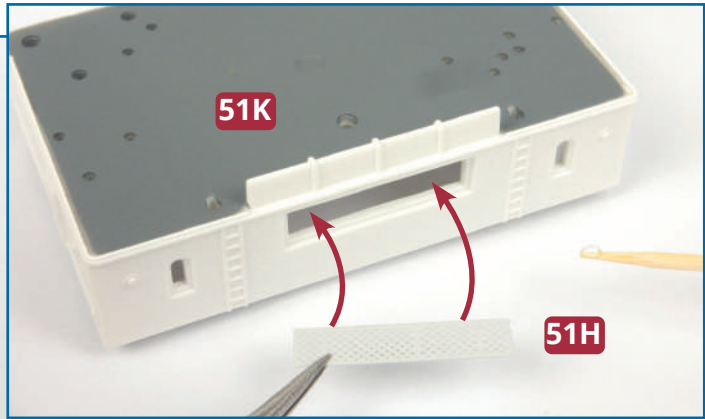
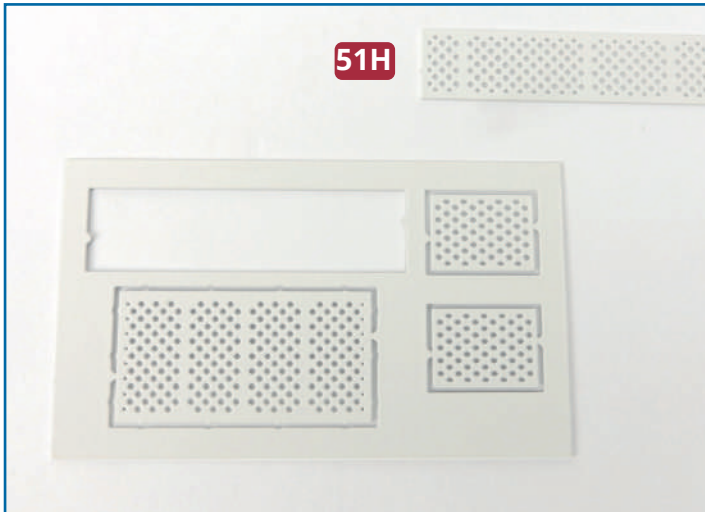

**2** Remove grille B, **51H**, from the frame and check the fit in the rectangular opening of the deckhouse **51K** (top right). Note that the panels of the grille are not symmetrical (right): the panel indicated in blue is shorter than the panel indicated in red. Glue in place.

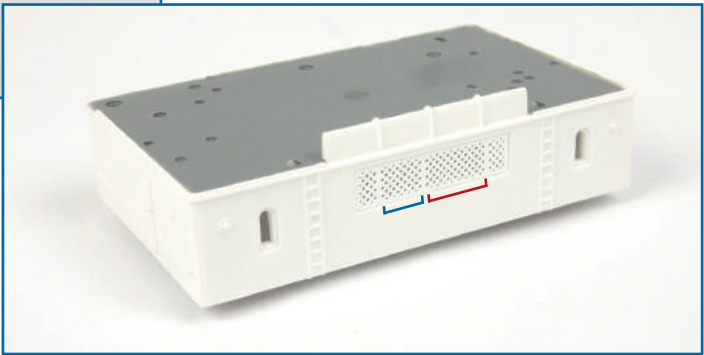

**3** Remove seven small windows **51E** from the frame (below). Cut them carefully so that you do not lose them – they can easily fly off as you cut them. Check how the first four fit in the openings on the aft and starboard sides of the deckhouse **51K**, as shown (right). Glue in place (below right).

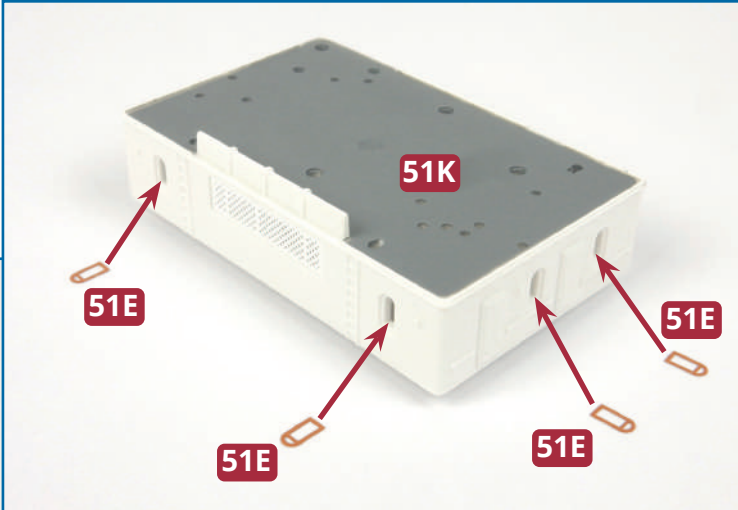
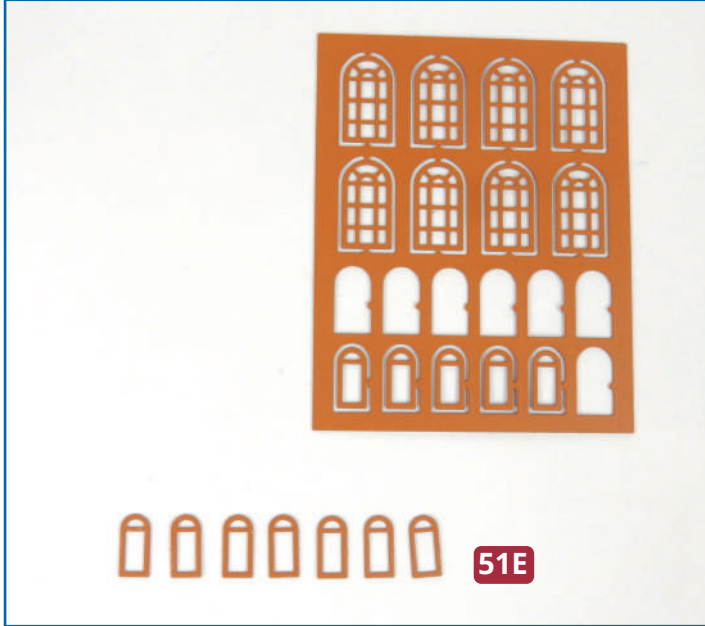

## ★ STEP-BY-STEP INSTRUCTIONS ★

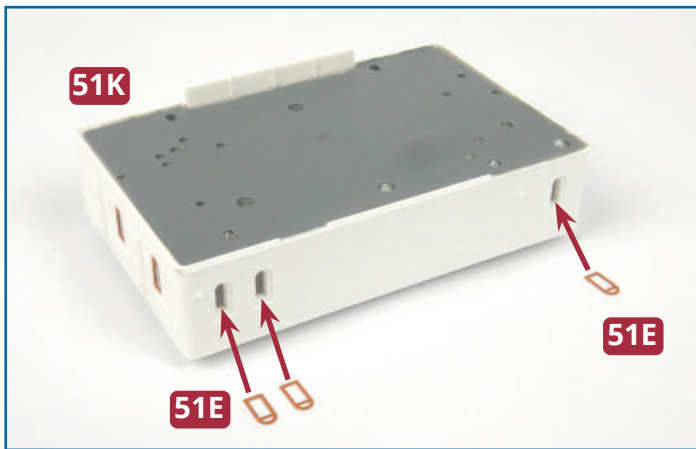

**4** Glue the remaining three small windows **51E** in the openings on the forward side of the deckhouse **51K** (left). Take the skylight **51J** and use a little glue to fix it in place on the top of the deckhouse.

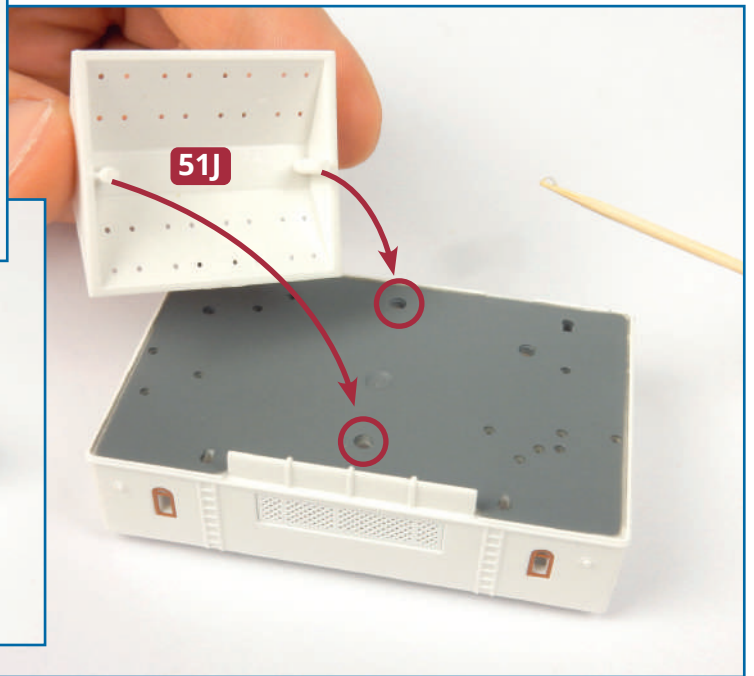

**5** The two cowls **51B** fit in the holes on the roof near the aft edge of the deckhouse **51K**, as indicated. The pegs and holes are shaped to ensure you fit the cowls facing the right way. Use a little glue to hold them in place.

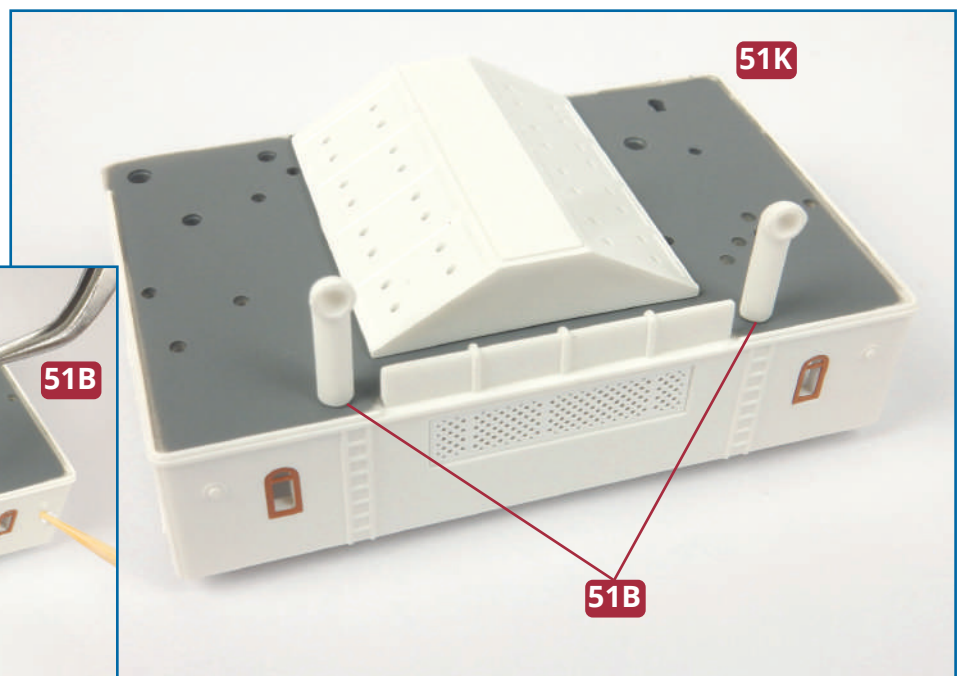
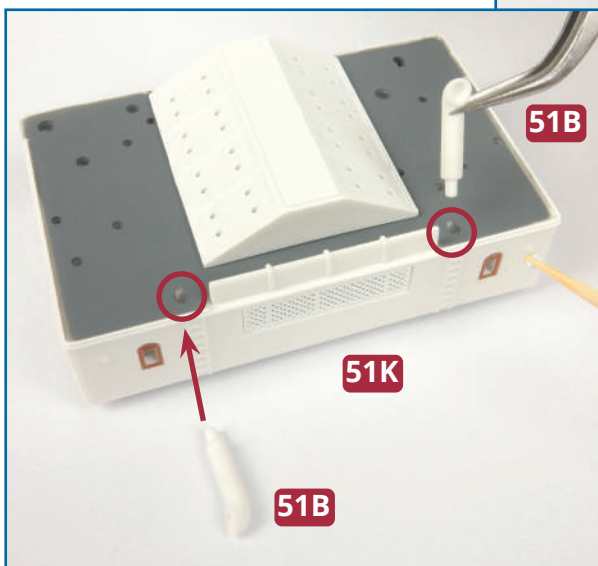

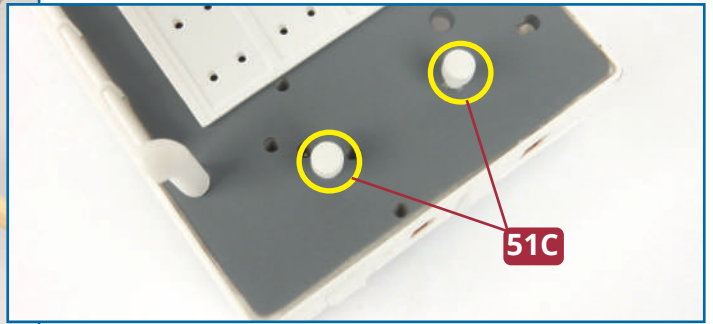
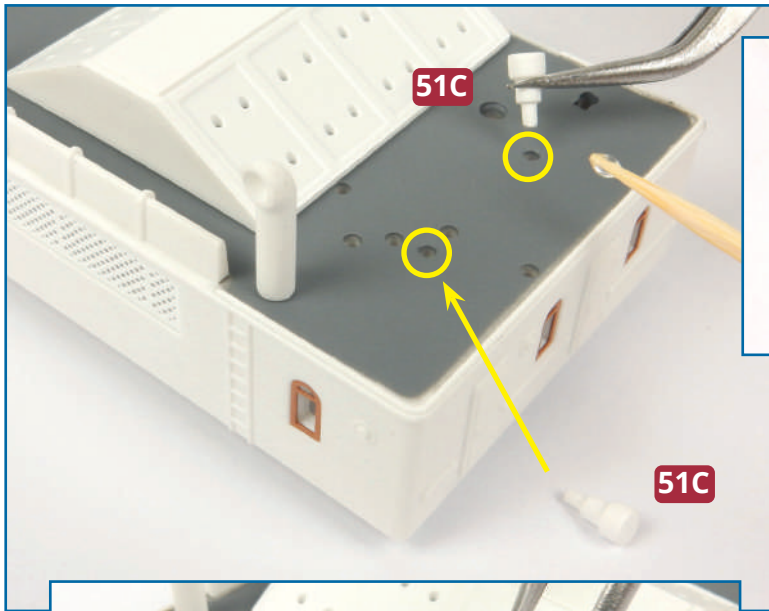

**6** Take care to identify the fixing points for the remaining vents: fit the two vents **51C** in the centre of the starboard side of the deckhouse (above left and above). Fit the hooded vent **51D** near the forward edge of the starboard side of the deckhouse (below left). The peg and hole for the hooded vent are shaped to ensure you fit it facing the right way. Apply a little glue to the pegs to hold them in place.

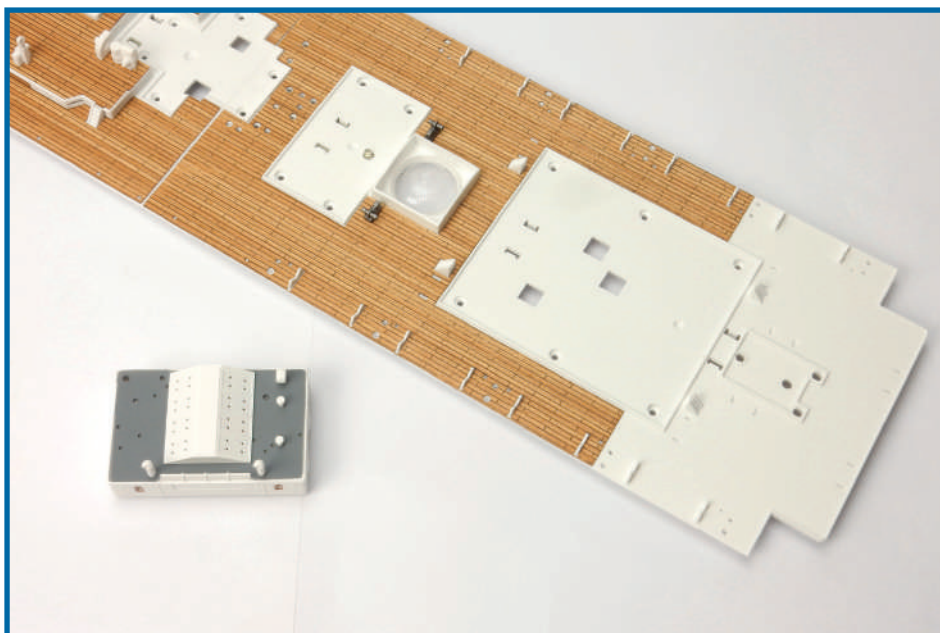
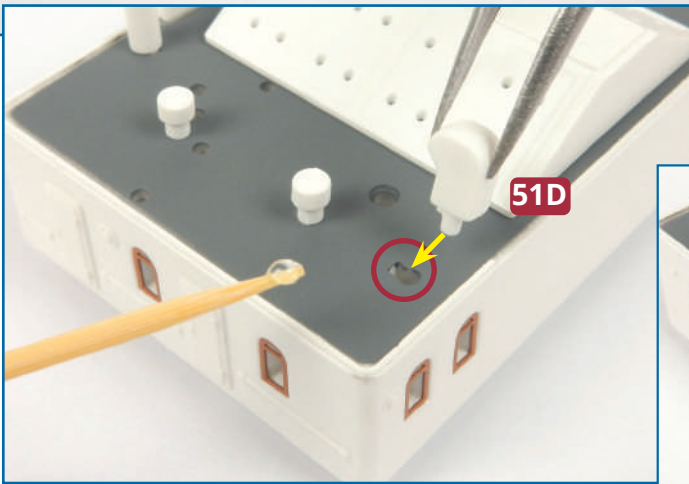

## **Completed work**

Work has begun on the deckhouse above the engine room. Keep the remaining windows, grilles and screws for use in future issues.

# MORE LIFEBOATS AND LIGHTING



## PARTS IN THIS ISSUE

- 52A** LED cable
- 52B** LED strip
- 52C** Lifeboats
- 52D** Cutter
- 52E** Tarpaulin without holes (not used)
- 52F** Tarpaulin for lifeboat
- 52G** Davit base
- 52H** Davit arm
- 52I** Cutter block gear
- 52J** Cutter block gear
- 52K** Lifeboat block gear (x 2)
- 52L** Skylight

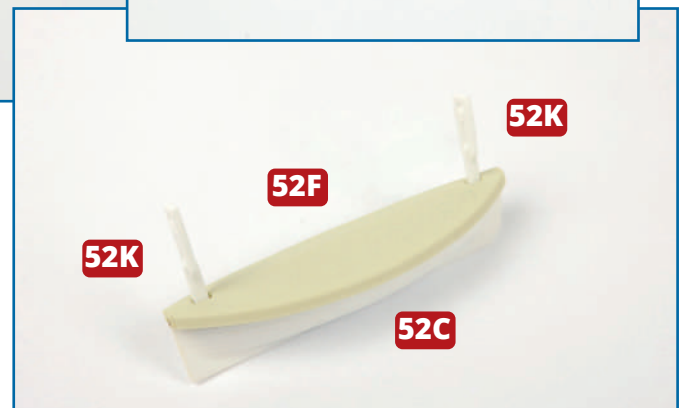
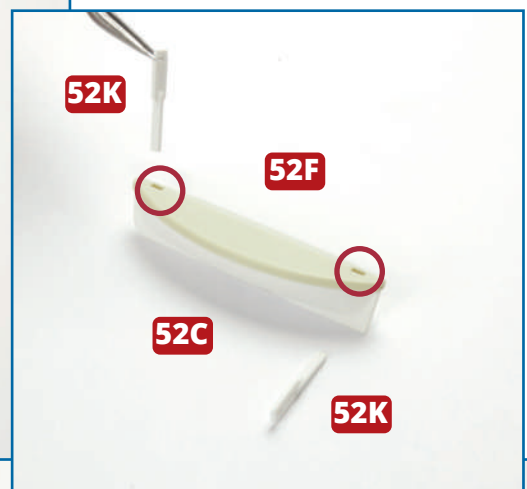

**1** Take one of the lifeboats **52C**. Fit the tarpaulin with holes **52F** on the lifeboat. Insert one of the block gears **52K** into each of the holes in tarpaulin **52F** (circled, above right). Do not use any glue at this stage. A tarpaulin for the second lifeboat will be supplied with a later issue; the tarpaulin without holes is not needed.

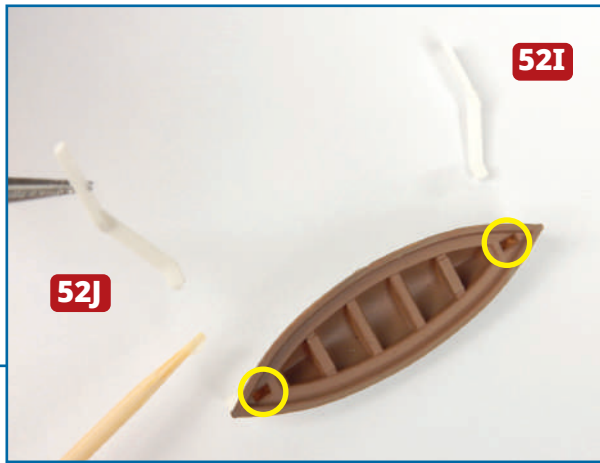

**2** Take cutter **52D**, the smallest of the three boats supplied with this issue, and the two block gears **52I** and **52J**. Check how the block gears fit into the holes at each end of the cutter. Glue in place as shown.

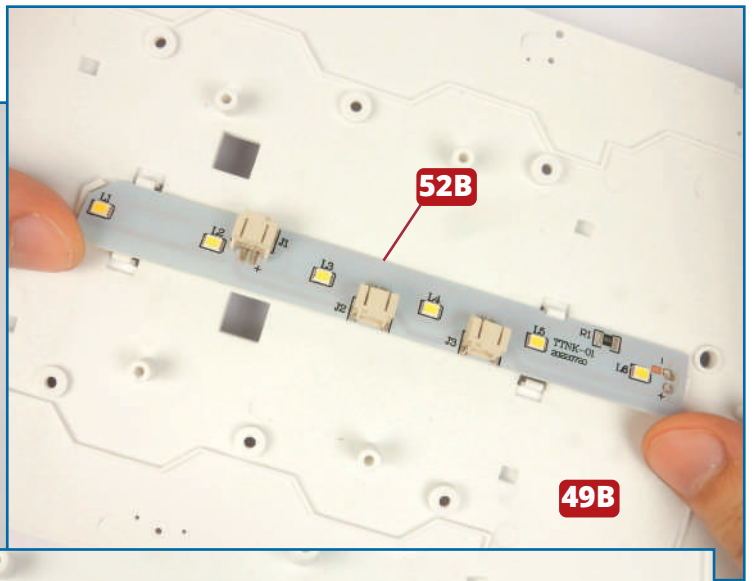
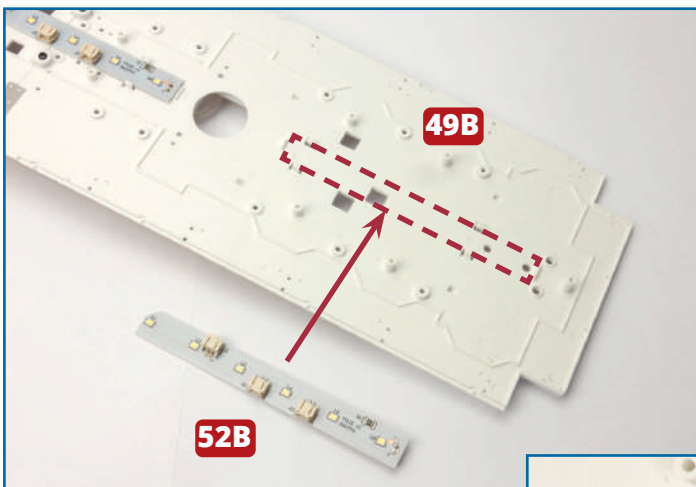
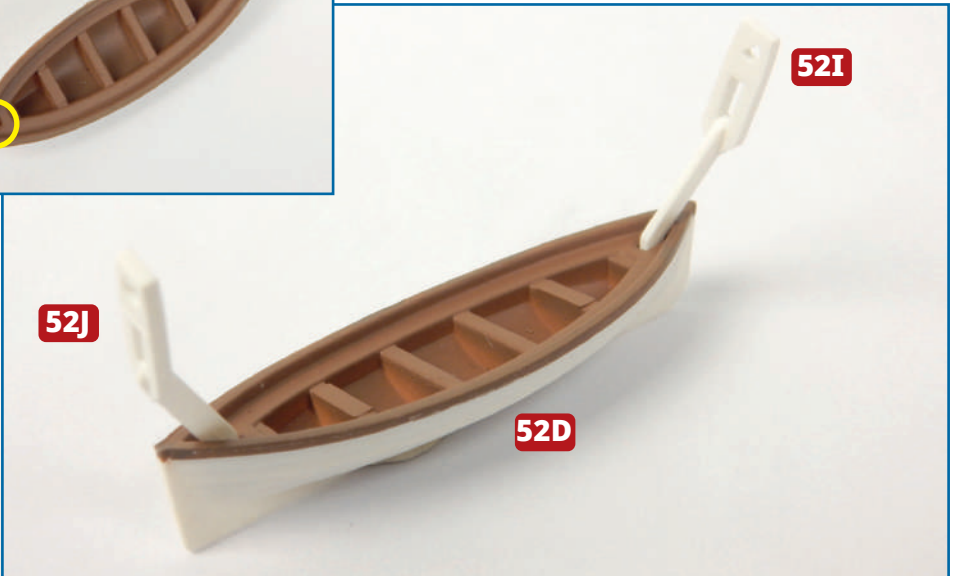

**3** Take the boat deck and carefully position it so that you can access the underside. Identify the position for the LED strip **52B** on section **49B** of the deck. Fix one side of the strip beneath the tabs, then fix the other side in place, using a flat screwdriver to gently lever the tabs if necessary.

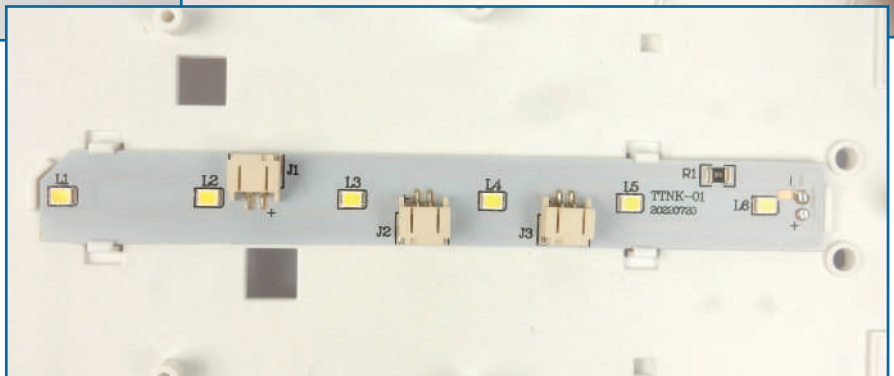

## ★ STEP-BY-STEP INSTRUCTIONS ★

**4** Take the davit arm **52H** and the base **52G**. Glue the two pegs on the arm in place, as shown. Fit the pegs on the base of the davit into the holes in the middle section of the deck **44B**: note that one peg is larger than the other to ensure it faces the right way. When you are happy with the fit, glue in place.

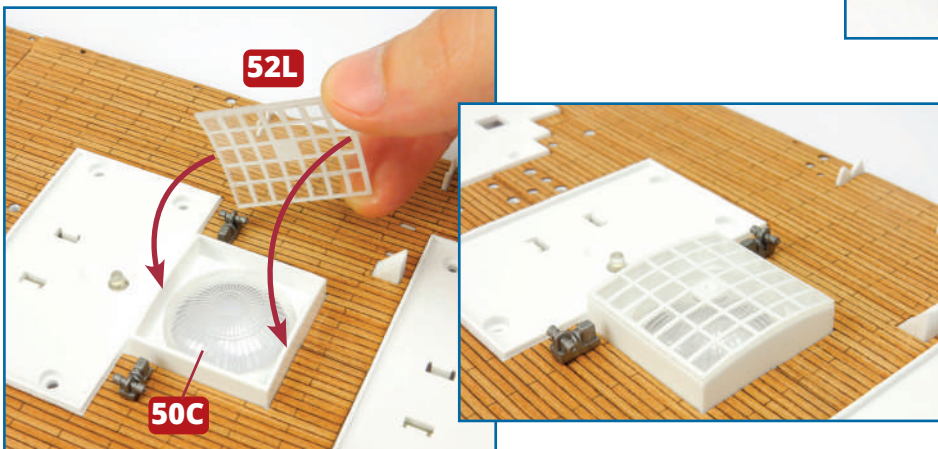
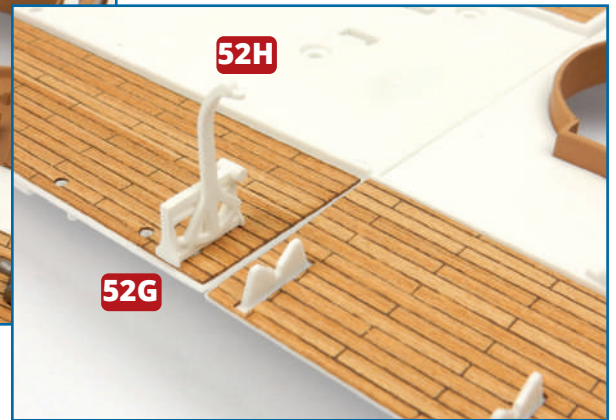
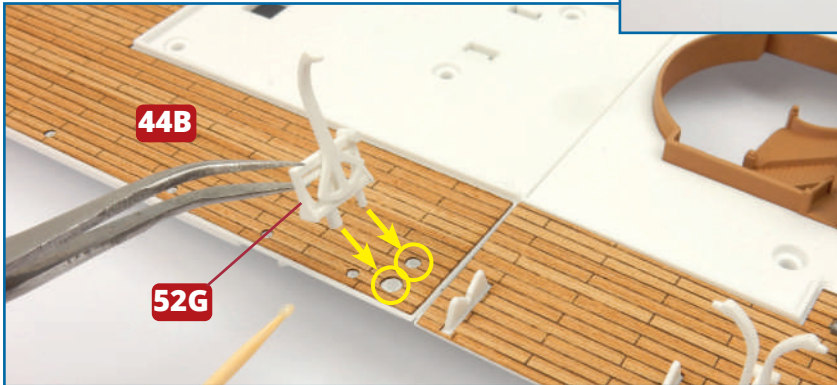

**5** Take the skylight **52L** and position it over the dome **50C**. Do not glue it in place at this stage: if you wish, you can temporarily hold it in place with a piece of masking tape.

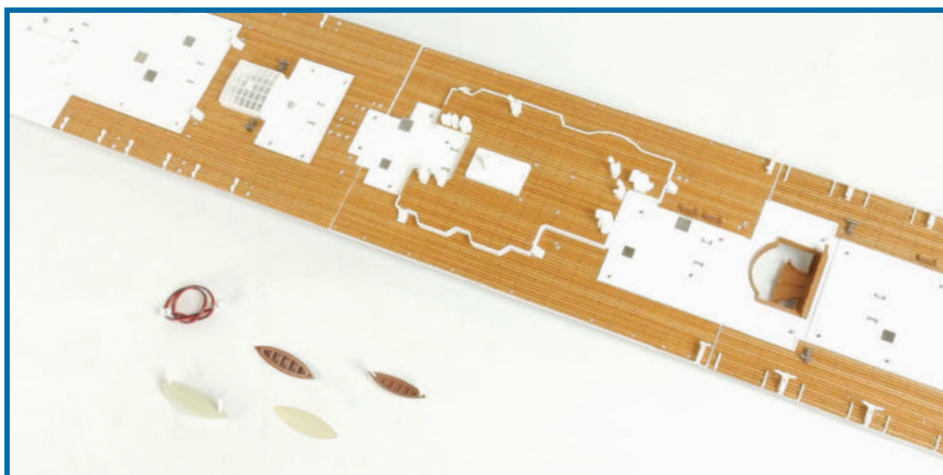

### Completed work

More details have been added to the boat deck. Store the lifeboats, cutter and LED cable **52A** carefully until they are needed.





# BASE FOR THE THIRD FUNNEL

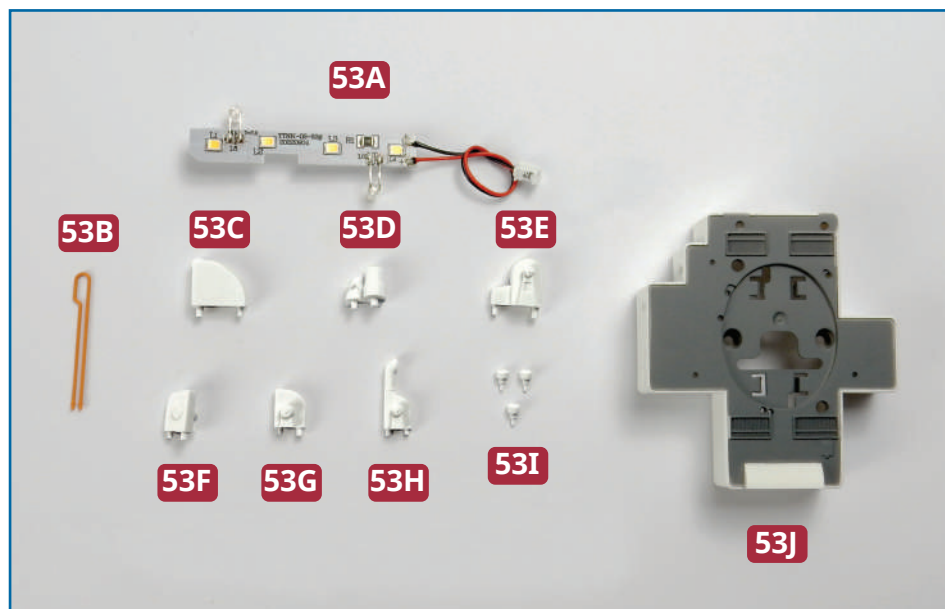

## PARTS IN THIS ISSUE

- 53A** LED circuit board
- 53B** Water pipe for third funnel
- 53C** Ventilator A
- 53D** Ventilator B
- 53E** Ventilator C
- 53F** Ventilator D
- 53G** Ventilator E
- 53H** Ventilator F
- 53I** Vent (x 3)
- 53J** Base of third funnel



**NOTE:** Handle the deck carefully, as it is now very long and delicate.

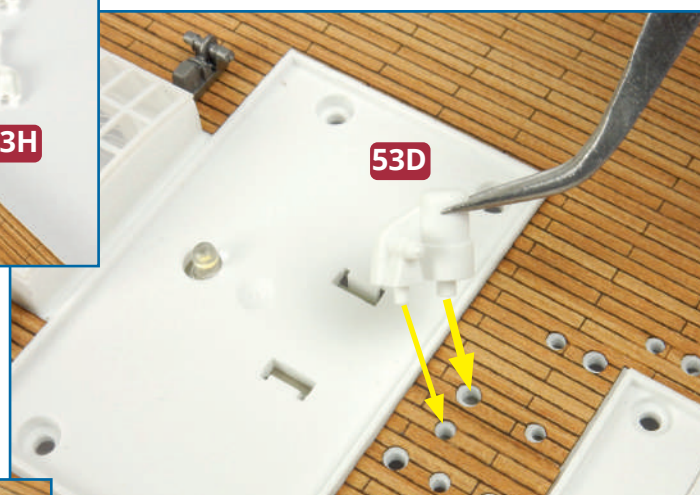

**1** Take the ventilators B, D and F (**53D**, **53F** and **53H**). Check how the pegs fit into the holes in the aft section of the boat deck **49B**. The pegs are different sizes to ensure you fit them the right way round. Fix in place with a little glue.

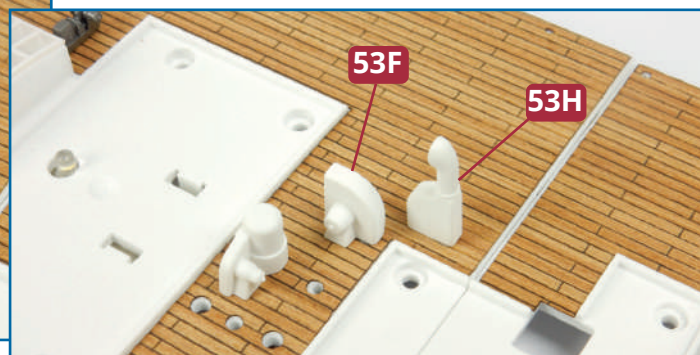
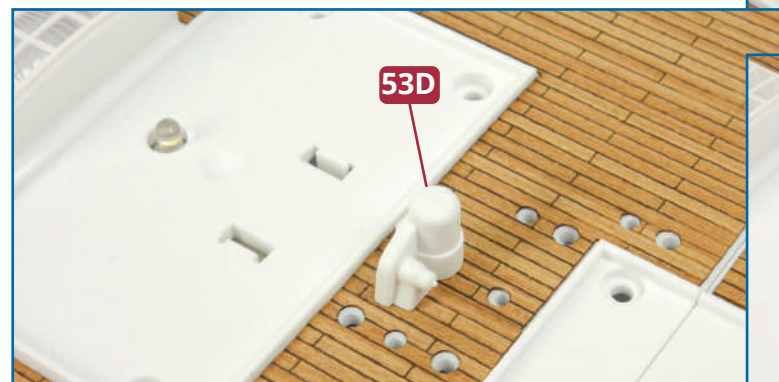

## ★ STEP-BY-STEP INSTRUCTIONS ★

**2** Take the three remaining ventilators A, C and E (**53C**, **53E** and **53G**). Again, check the fit in the holes in the aft section of the boat deck **49B**, as shown. Glue in place. Make sure you have fitted them in the correct mounting holes.

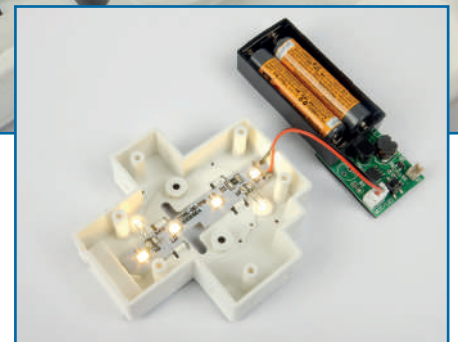
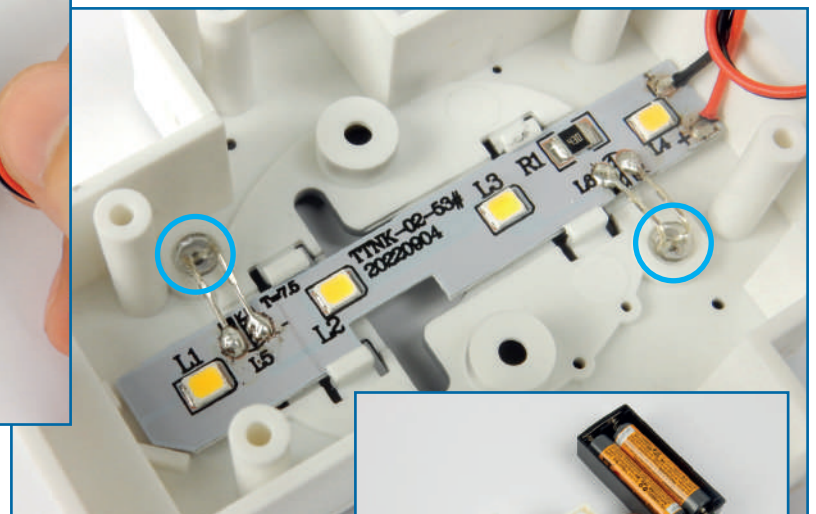
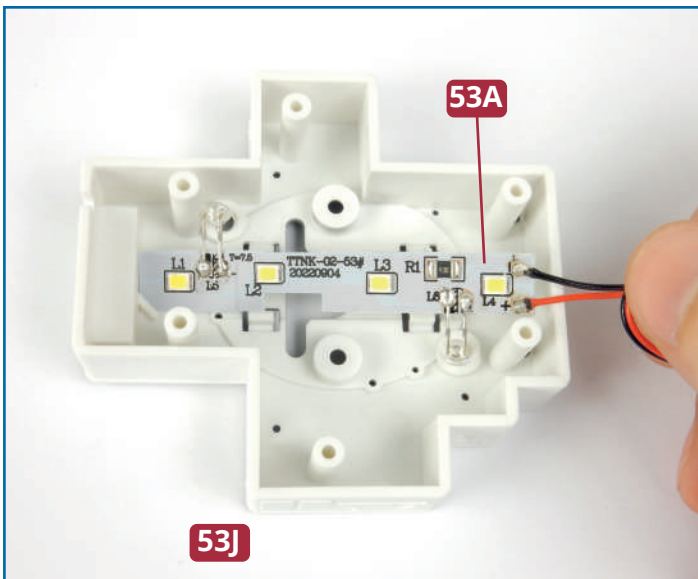
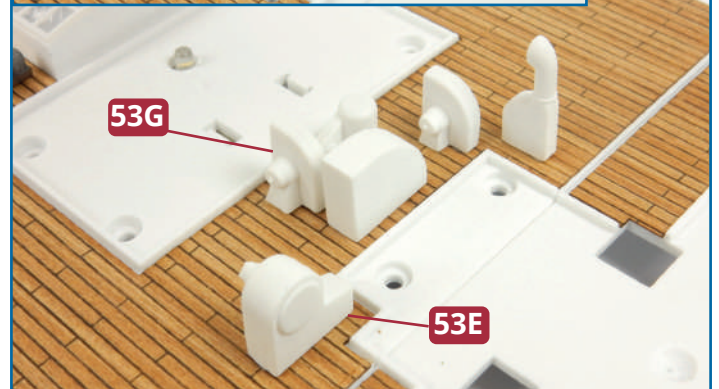
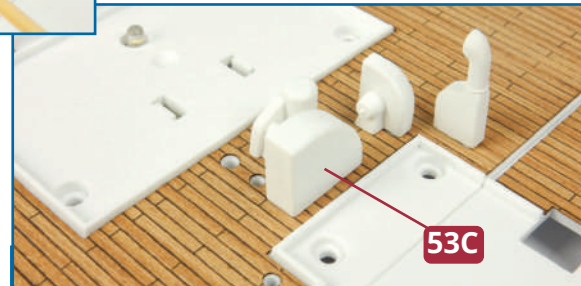
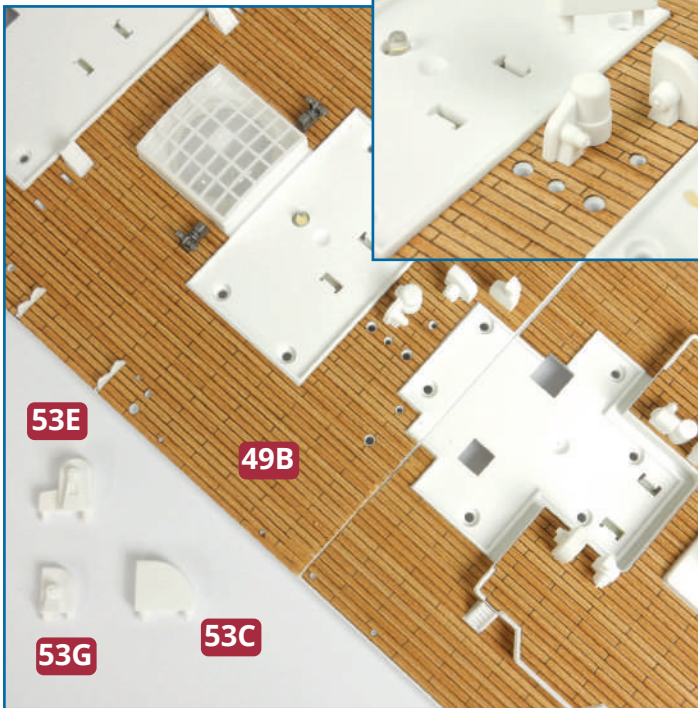

**3** Take the LED board **53A** and check how it fits on the underside of the base of the third funnel **53J**. Insert the two LEDs into the holes (circled in blue), then fit the circuit board beneath the tabs, using a screwdriver to lever them into place if necessary. Take the tester from issue 3 and plug the lighting cable into the socket to check that the lights are working.

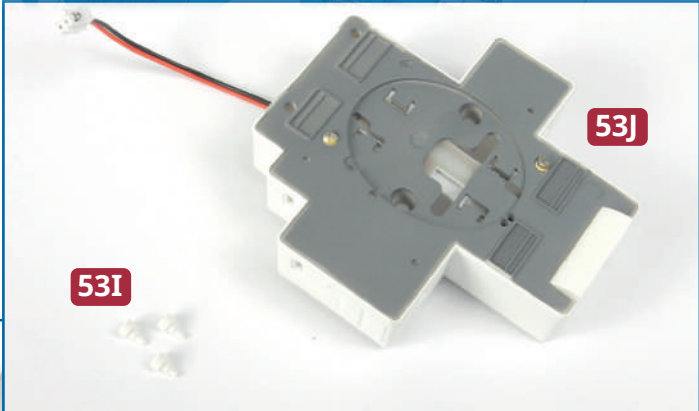
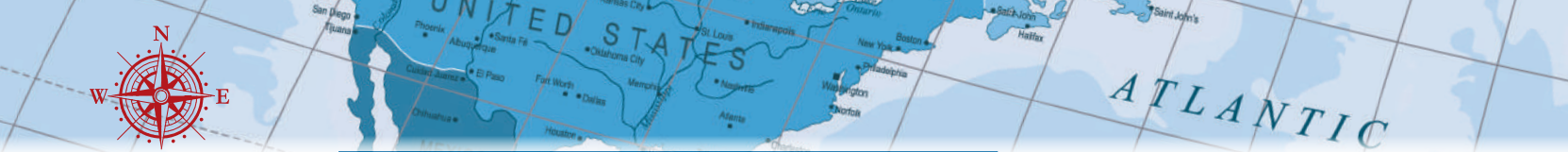

**4** Glue the three vents G (53I) to the roof of the base of the funnel 53J, fitting them into the holes shown. Then glue pipe 53B in place, as shown in the photo below.

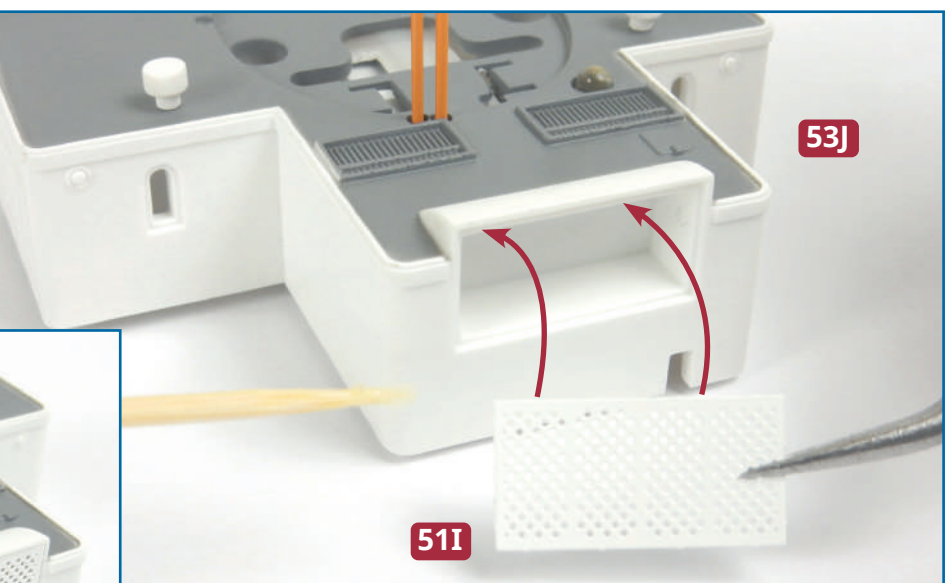
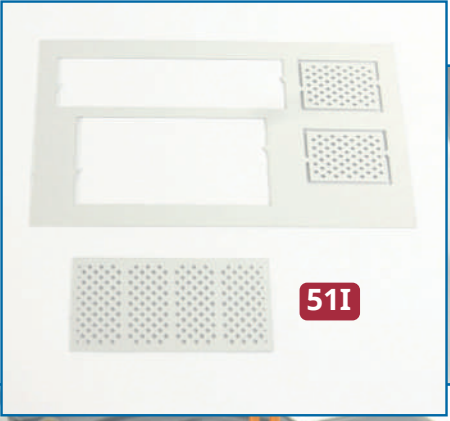
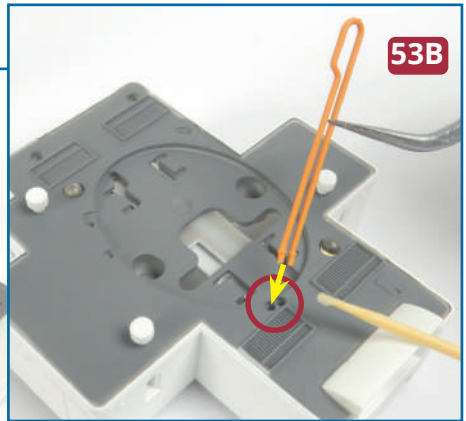
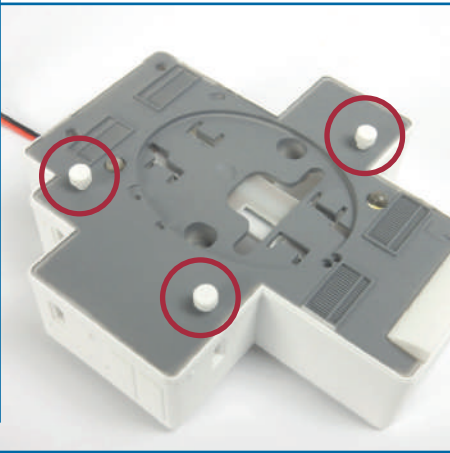

**5** Take grille 51I from the frame supplied with issue 51. Check how it fits in the opening in the base for the third funnel 53J.

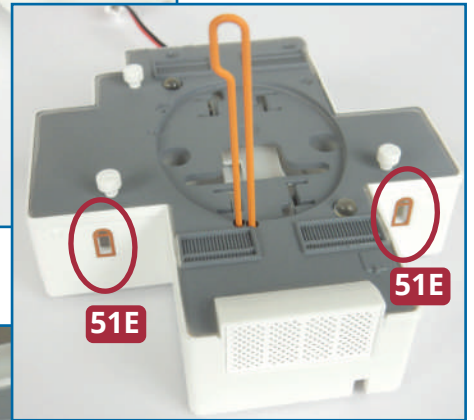
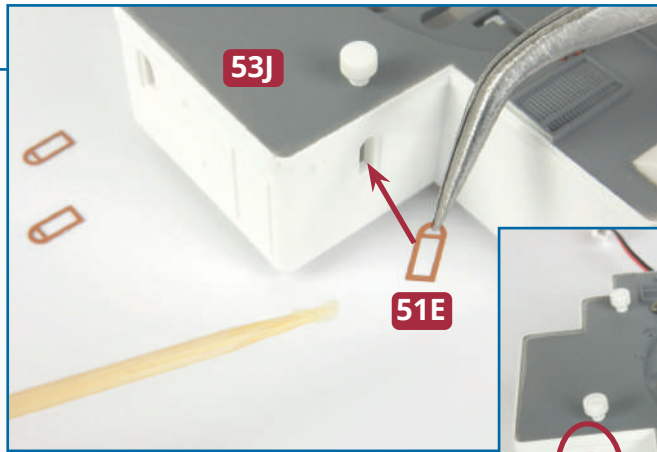

**6** Take four small windows **51E** from the frame supplied with issue 51. Glue the windows into the four openings in the funnel base **53J**.

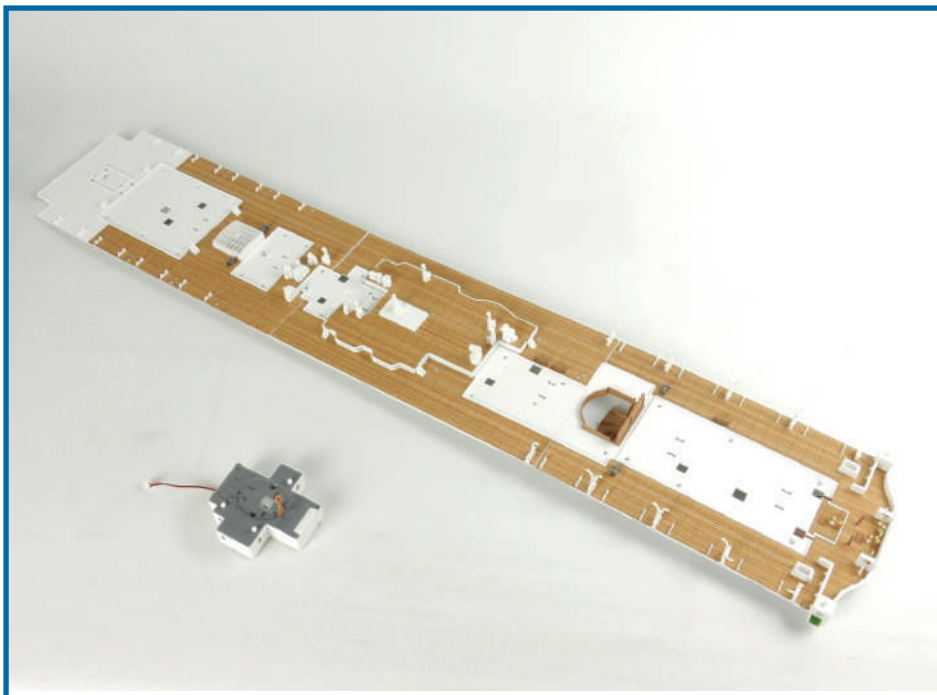
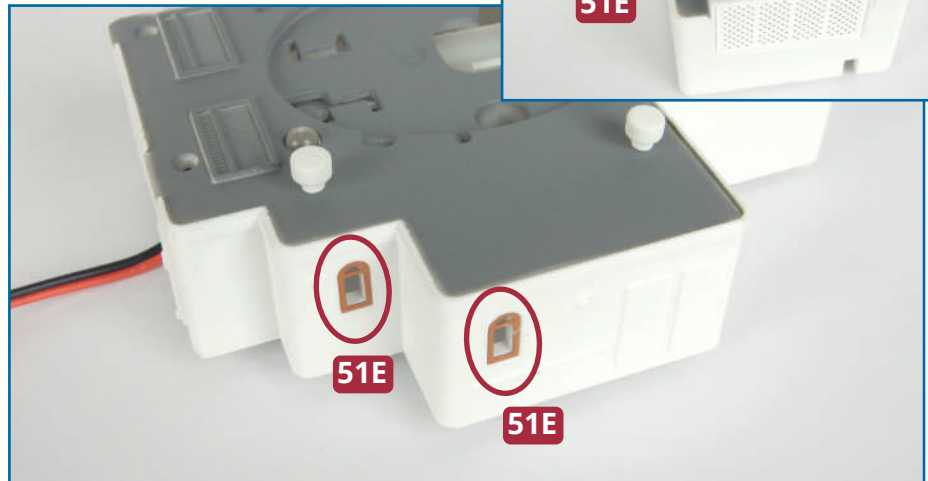

### Completed work

Ventilators have been fitted to the aft of the bridge deck and vents, LEDs, a pipe and windows have been fitted to the base for the third funnel.



# THE THIRD FUNNEL

## PARTS IN THIS ISSUE

- 54A** Funnel plating
- 54B** Funnel interior
- 54C** Top of third funnel
- 54D** Stay collar
- 54E** Platform
- 54F** Aft water pipe
- 54G** Forward water pipe
- 54H** Whistle with steam supply pipe
- 54I** Ladder
- 54J** Extension cable, labelled K3
- DP** Seven 1 x 2mm PB screws (1 spare)
- AP** Nine 2.3 x 5mm PB screws (1 spare)

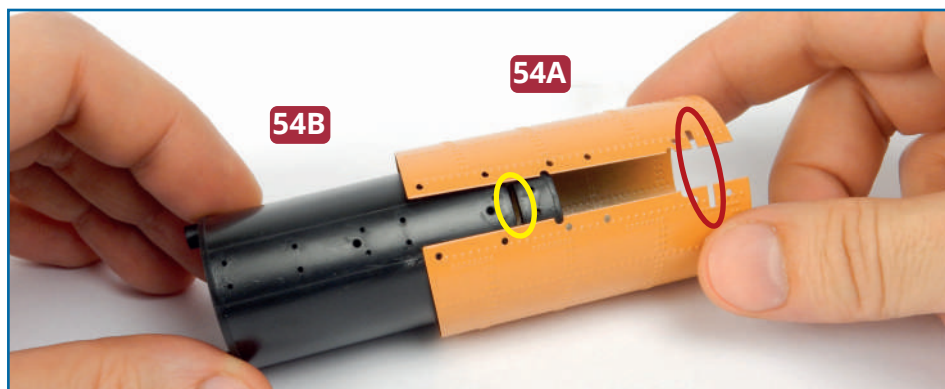

**1** Take the funnel **54B** and fit it inside the plating **54A**. Check that the notches in the plating (circled in red) align with the slot in the funnel (circled in yellow). Fix one side of the plating in place with three **DP** screws (below left), then use three more **DP** screws to fix the other side in place using the screw holes indicated (below centre).

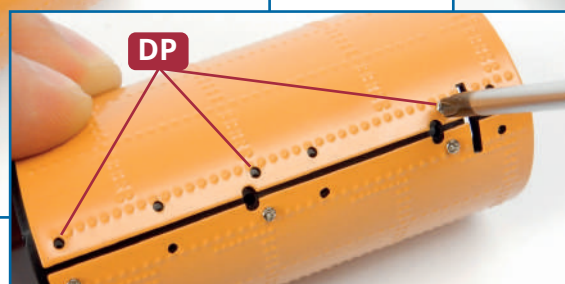
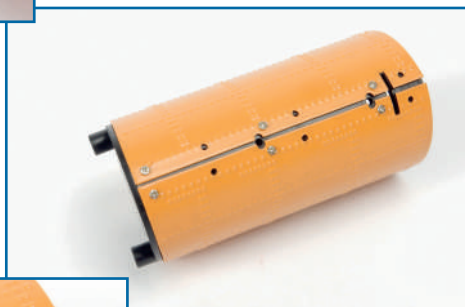
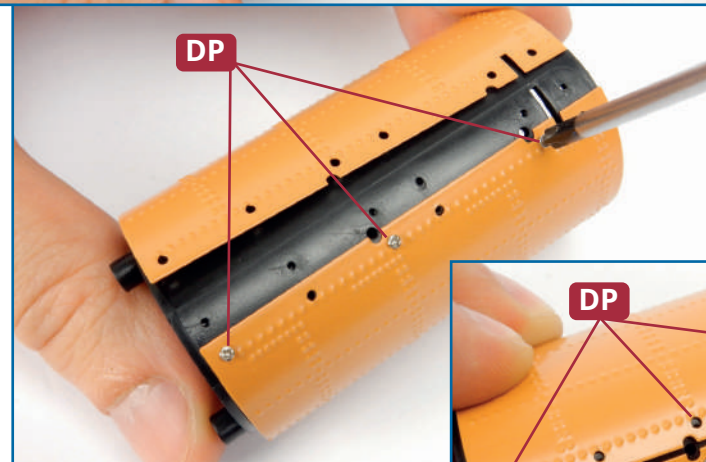

**TIP:** After fixing the first side of the funnel in place, wrap some masking tape around the plating to hold it in firmly while you fix the other edge in place.

**2** Take the stay collar **54D** and fit it on the top of the funnel **54C**, so that the tabs in the collar slide into the slots in the funnel. Note that the tabs are different sizes. The more detailed side of the stay collar faces upwards.

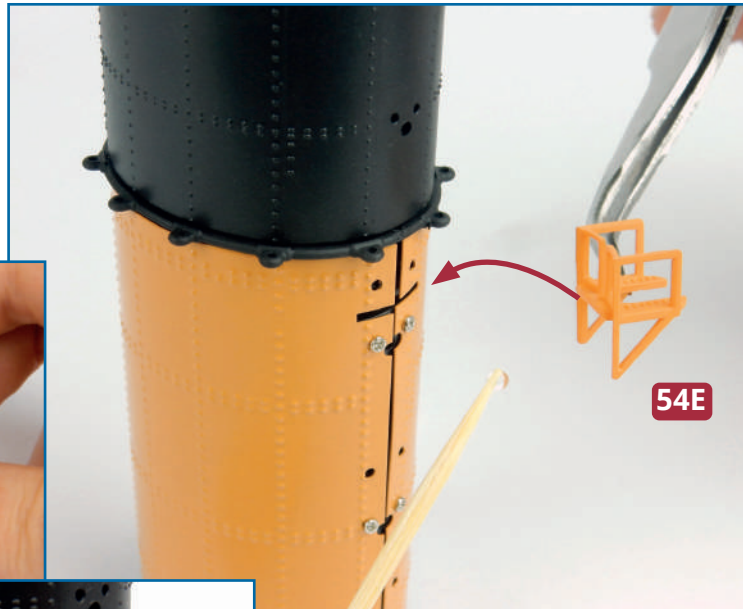
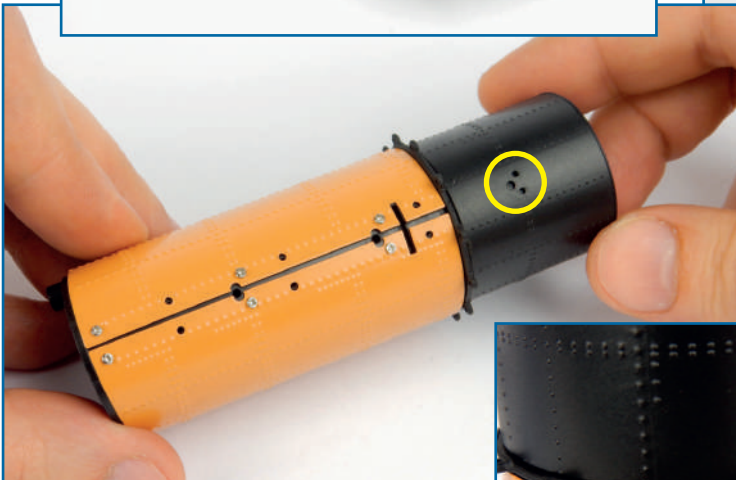
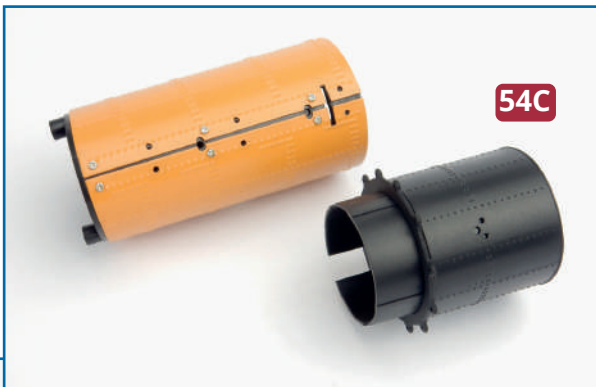
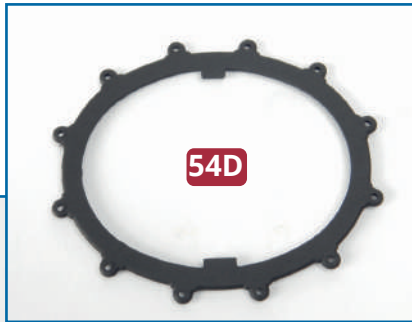
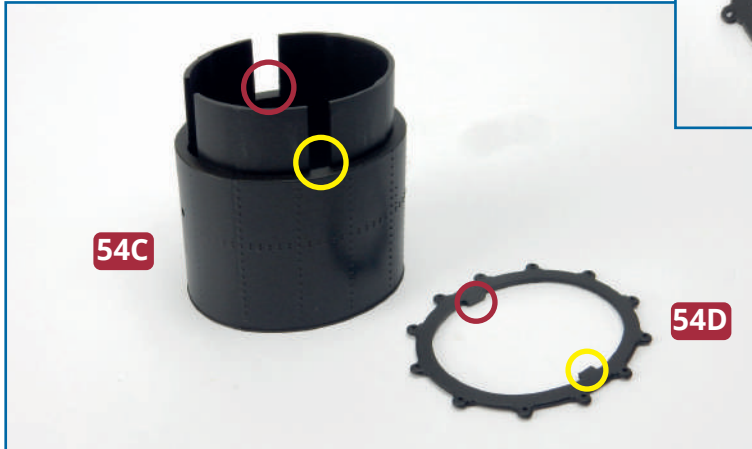

**3** Fit the top of the funnel **54C** into the funnel assembly, pushing it firmly in place. The three holes in part **54C** (circled in yellow) align with the 'seam' in the plating **54A**. Don't use any glue. Then take the platform **54E** and fit the tab into the slot in the funnel as shown on the left. Glue in place.

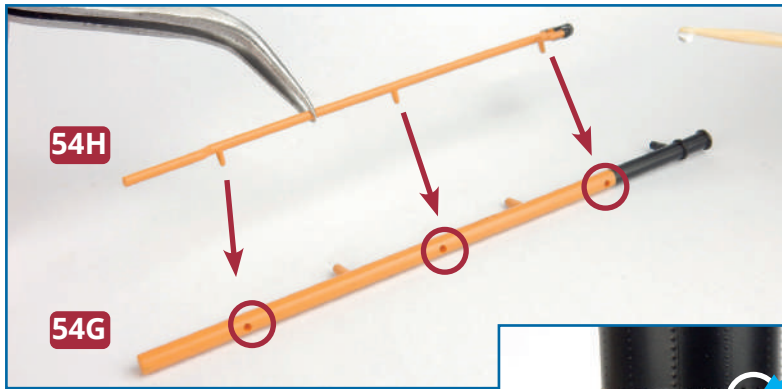

**4** Take the whistle and pipe **54H** and check how the pegs fit into the forward water pipe **54G**, as shown above. Glue the pegs in place. Then apply a little glue to the pins on the front pipe **54G** (circled in blue, right) and insert them into the three holes along the seam in the funnel plating (circled in white, right).

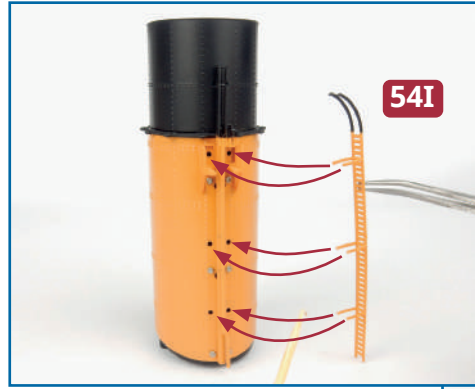
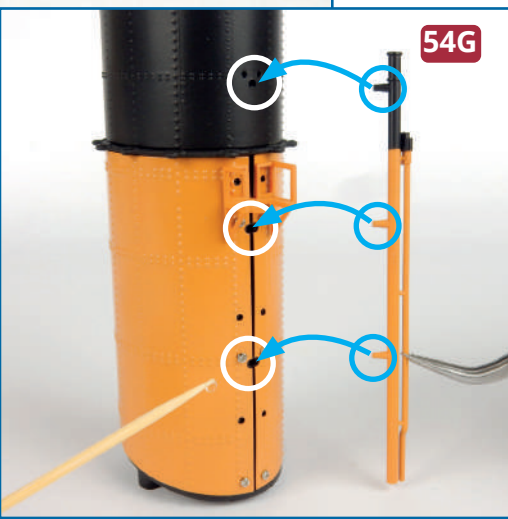

**5** Check the fit of the ladder **54I** over the pipes fitted in the previous step. Glue the pegs on the ladder in place in the holes in the funnel cladding. Then turn the funnel around and glue the aft water pipe **54F** in place.

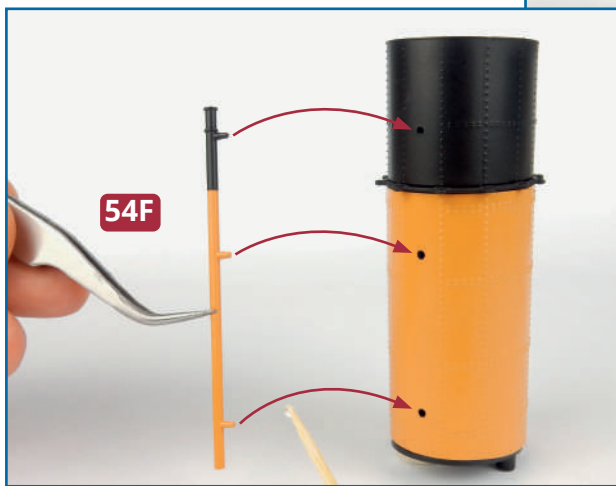

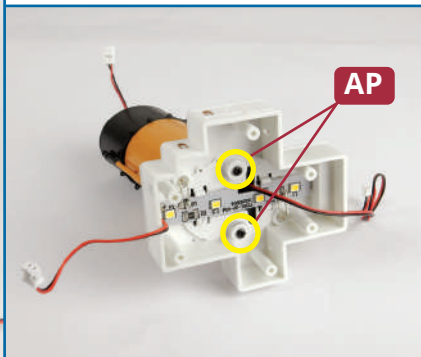
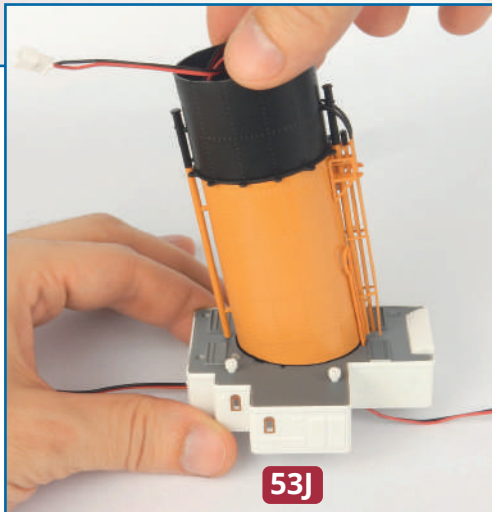
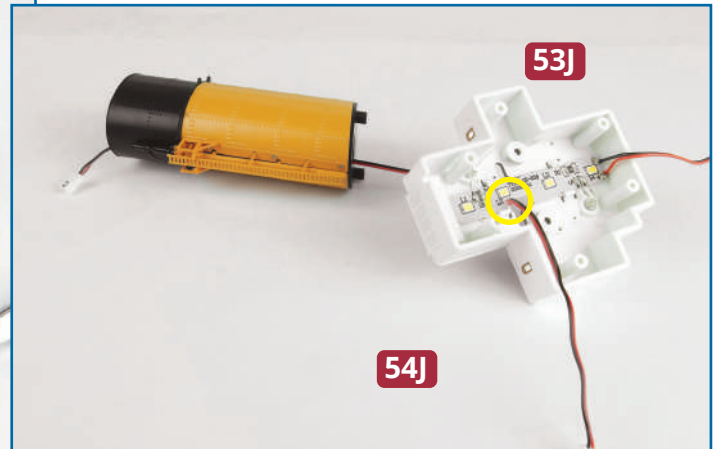
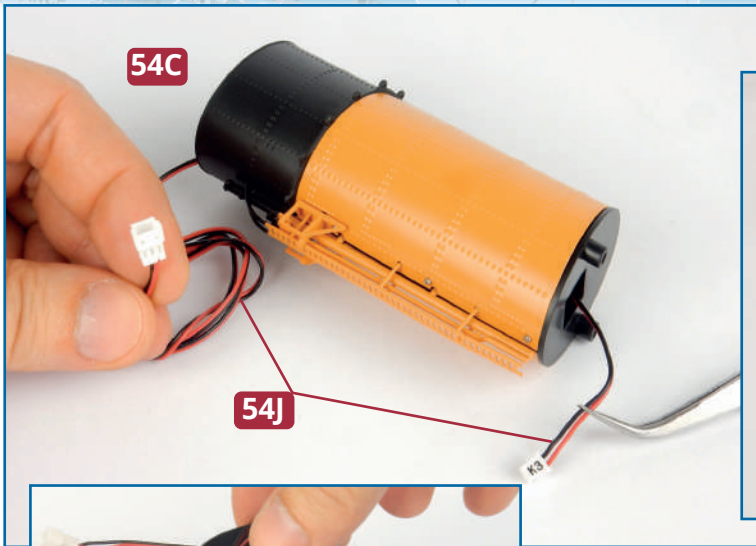

**6** Take the extension **54J** (labelled K3) and feed the smaller connector into the top of the funnel **54C**. Then bring the end of the extension out of the hole at the base of the funnel. Thread the end of the extension into the hole in the base for the third funnel **53J** (circled, above). Fit the raised screw sockets on the bottom of the funnel **54B** on the base **53J** and fix in place with two **AP** screws.

### Completed work

The third funnel has been assembled and fitted to the base supplied with the previous issue.

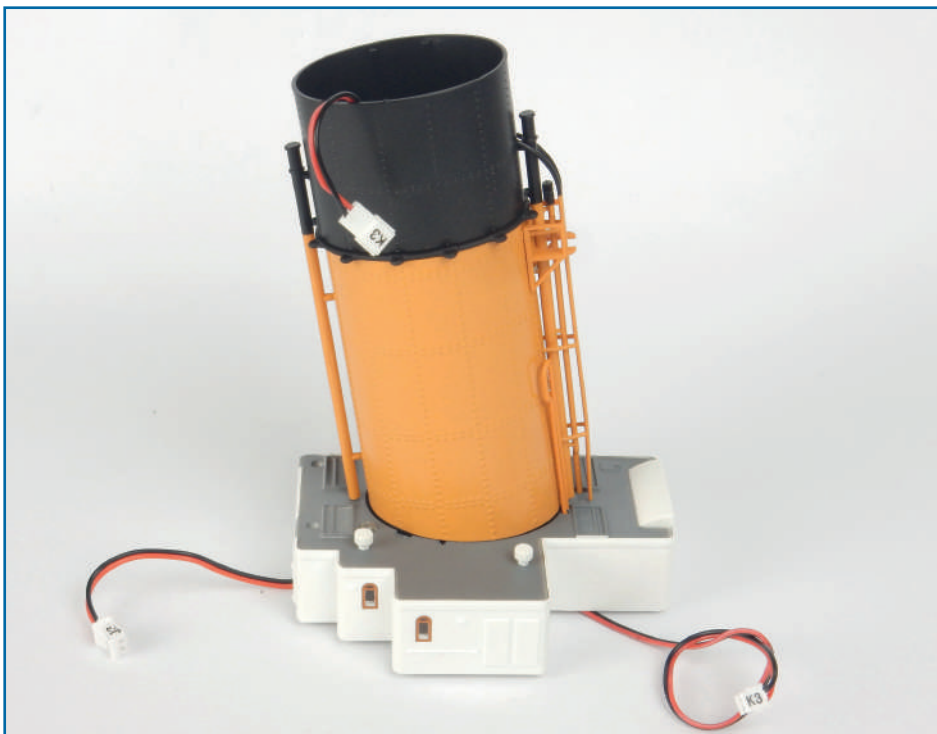





# THE THIRD SMOKE GENERATOR



## PARTS IN THIS ISSUE

- 55A** Interior of third funnel
- 55B** Smoke generator holder
- 55C** Smoke generator
- 55D** Spring
- 55E** Plastic band
- 55F** Grille
- 55G** Filter
- 55H** Tank
- EP** Three 2 x 4mm PH screws (1 spare)

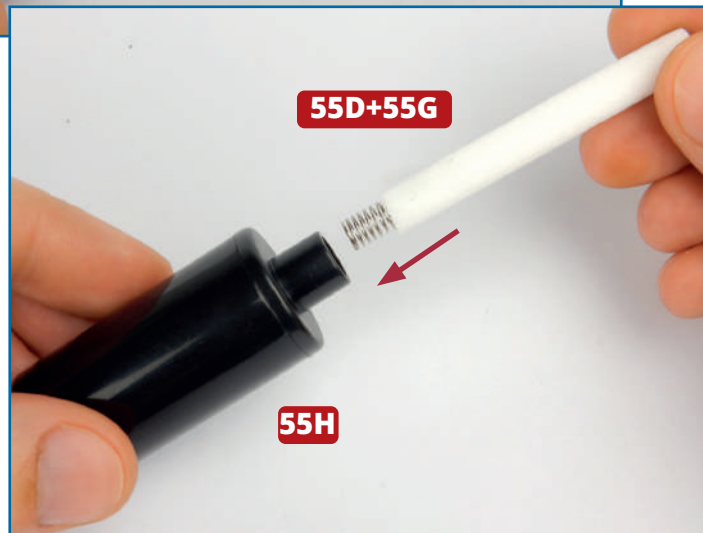
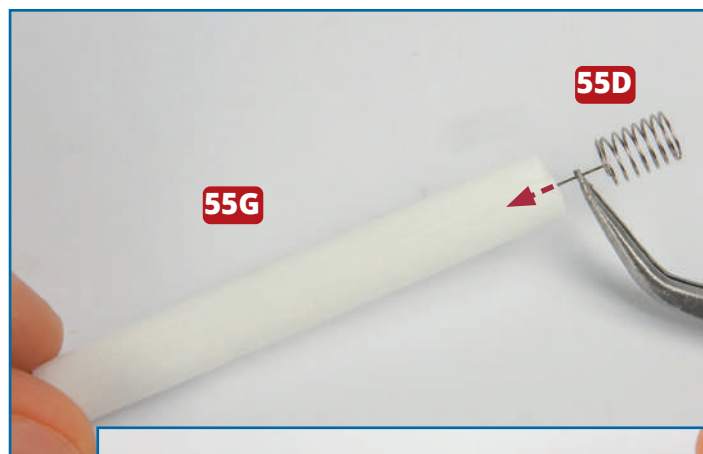

**1** Take the filter **55G** and the spring **55D**. Push the wire end of the spring into the filter, pushing it all the way down. Insert the spring and filter assembly into the tank **55H**, putting the spring into the tank first.



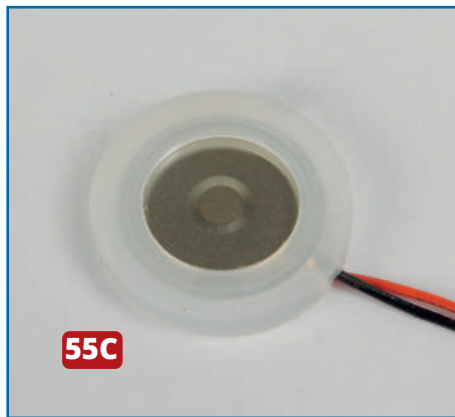

**2** Fit the smoke generator **55C** into the holder **55B**: make sure you fit it the correct way up, with the soldered wires showing (circled in yellow, below) and the wires running through the notch in the holder (circled in red, right).

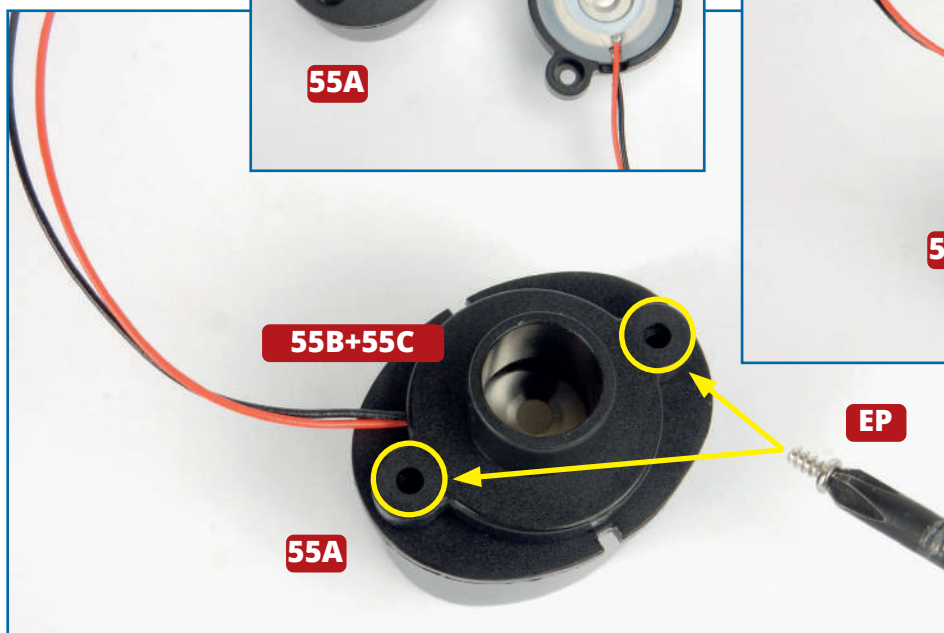
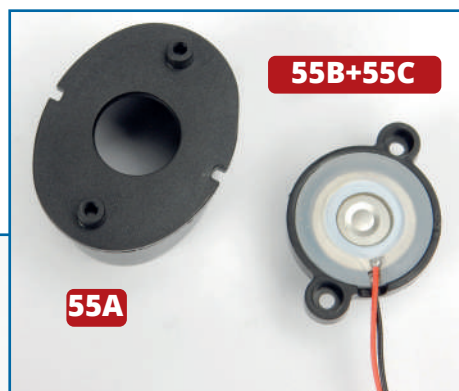
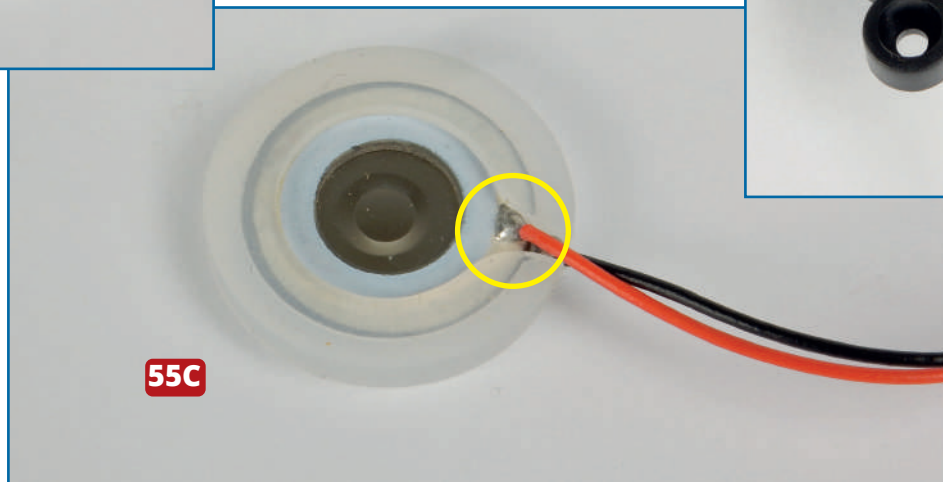
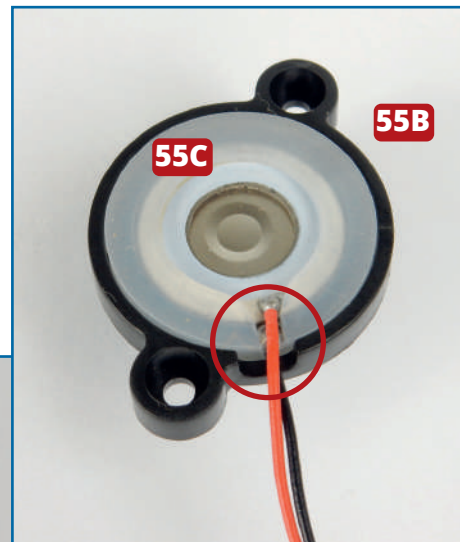

**3** Fit the smoke generator assembly into the funnel interior, part **55A**, where indicated, and fix in place with two **EP** screws.

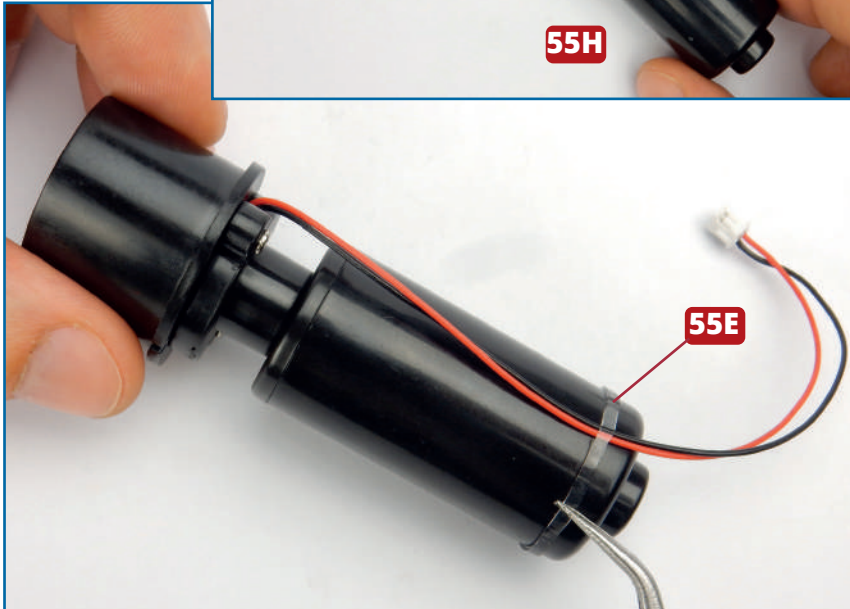

**4** Take the tank assembly from step 2 and insert the tank **55H** into the holder **55B**. The end with the filter goes in first, as shown (above left). Do not put any water in the tank at this stage. Take the plastic band **55E** and fit it on the tank as shown (left) to hold the wire of the smoke generator **55C** in place.

### Completed work

The smoke generator has been fitted to the tanks for the third funnel. Store the assembly and grille carefully until they are needed.

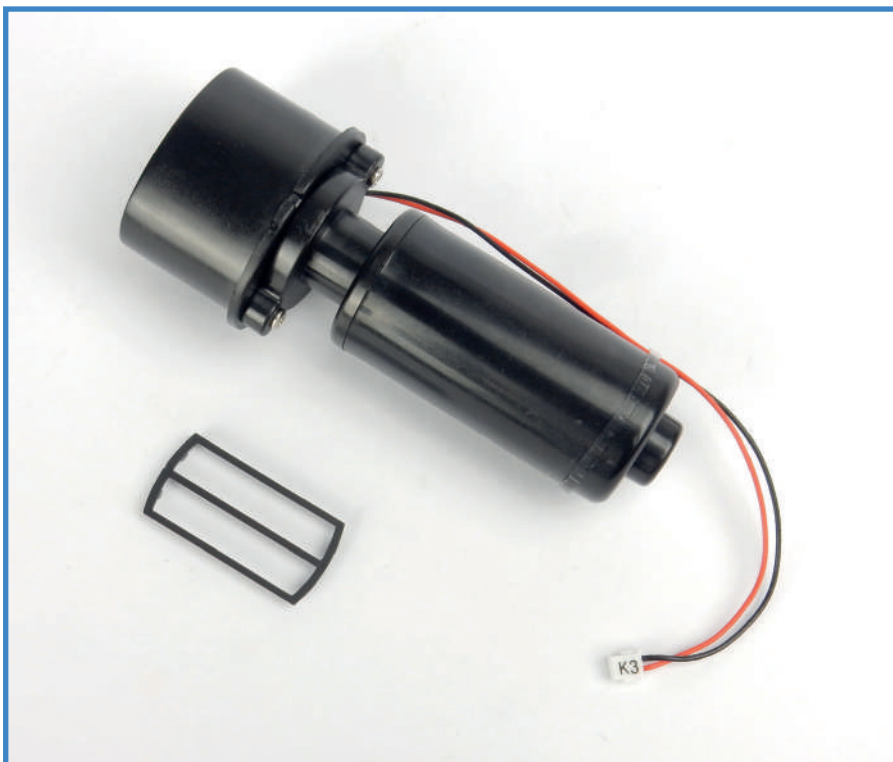

# BASE OF THE FOURTH FUNNEL

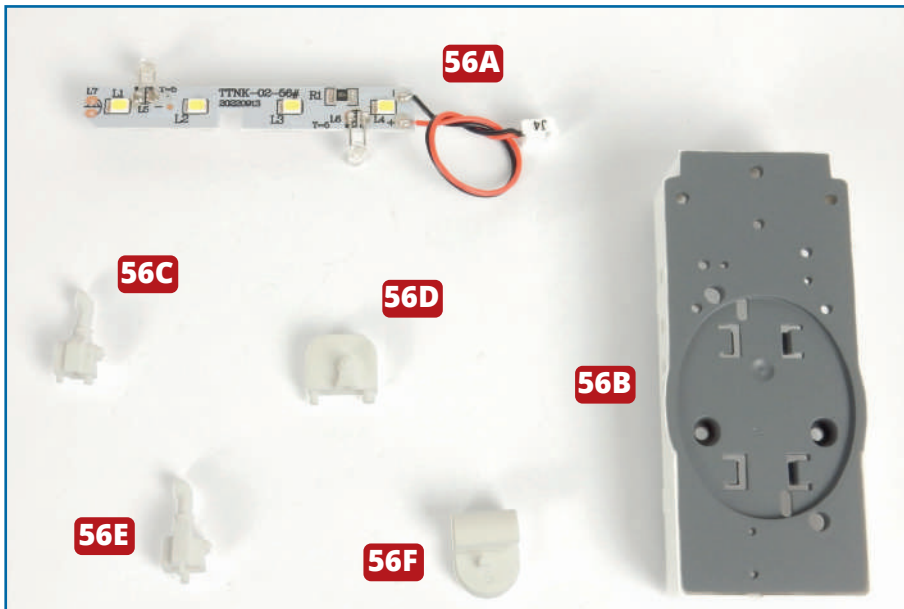

## PARTS IN THIS ISSUE

- 56A** LED circuit board
- 56B** Base of the fourth funnel
- 56C** Ventilator A
- 56D** Motor for ventilator C
- 56E** Ventilator B
- 56F** Ventilator C

**1** Take the base of the fourth funnel **56B**. Fit the LED circuit board **56A** to the underside of part **56B**. Insert one long edge of the circuit board under the tabs (circled in red), then use a small flat screwdriver to lever up the tabs on the opposite side (circled in yellow) so that you can clip the other edge of part **56A** in place.

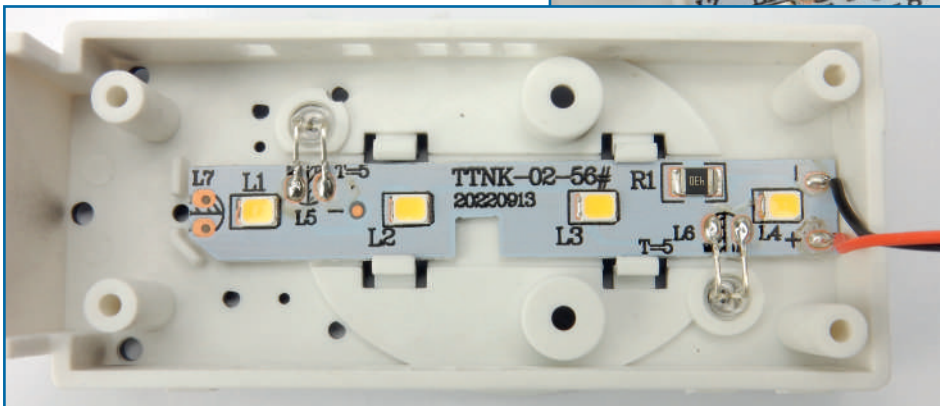
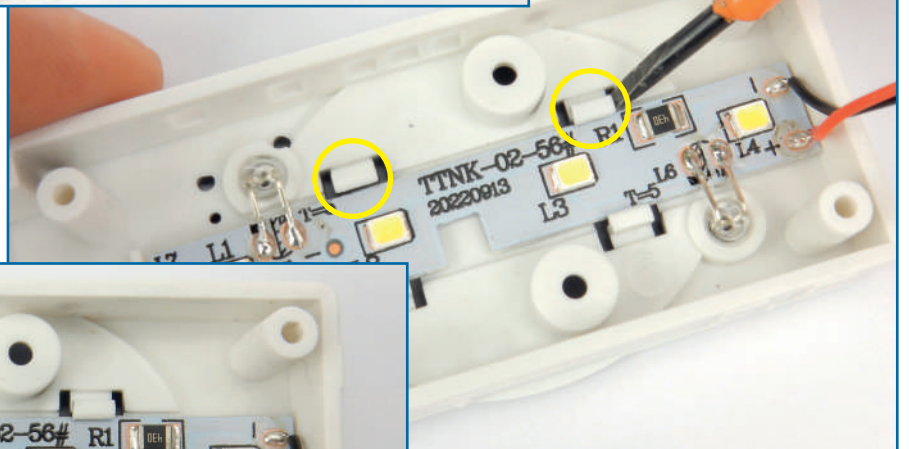
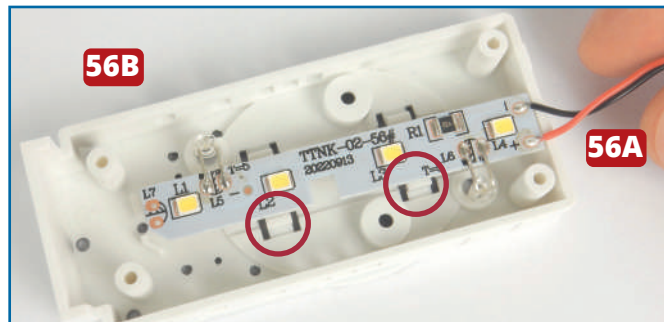

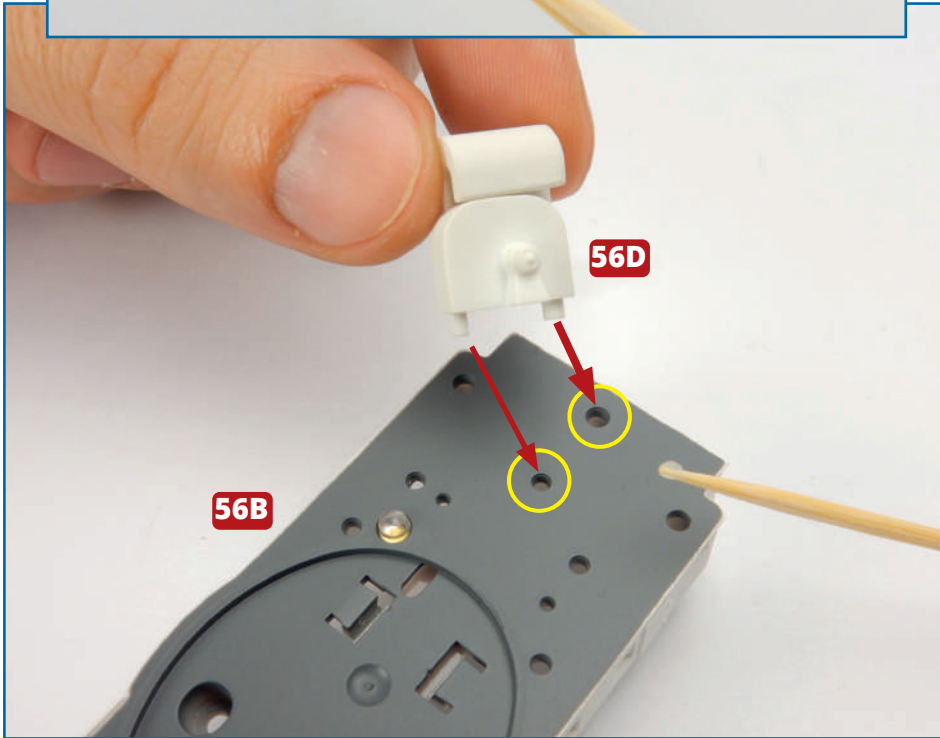
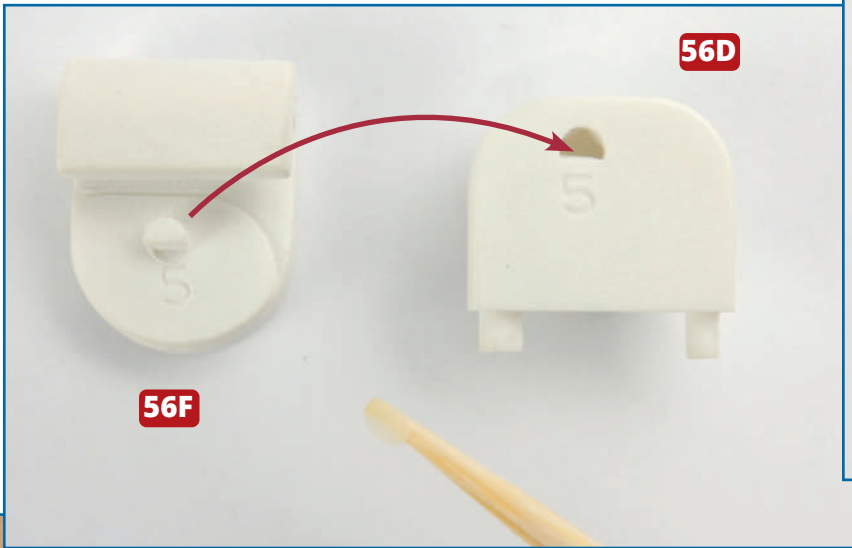

**2** Glue the D-shaped peg on ventilator C, **56F**, into the corresponding hole in the motor **56D**. Then fit the assembled ventilator to the base of the fourth funnel **56B**, as shown. One peg is larger than the other, to ensure it is fitted facing the correct way. Use a little glue to fix the ventilator in place.

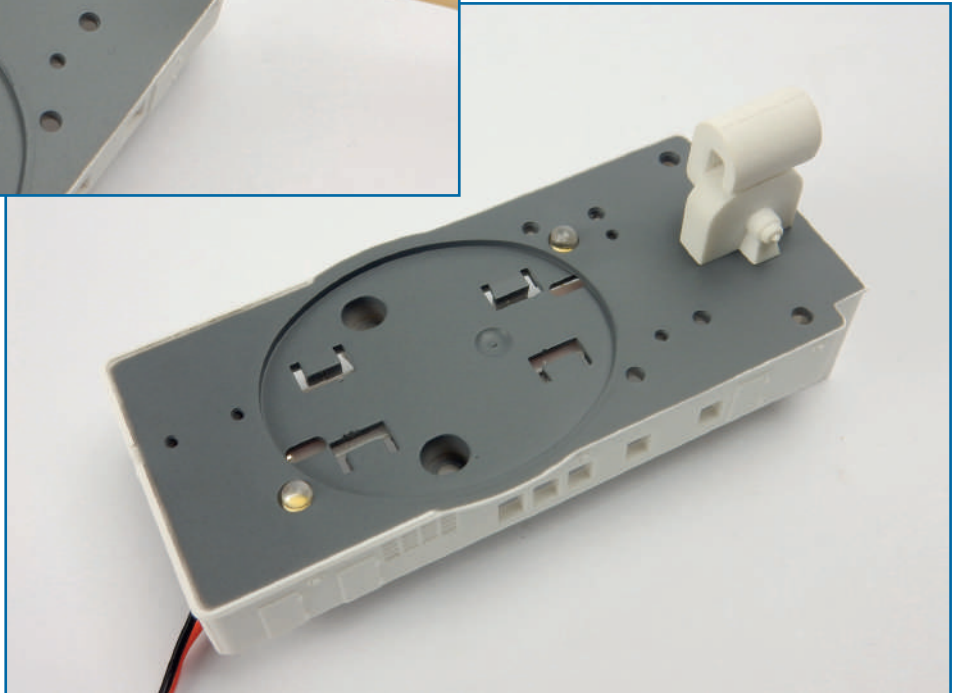

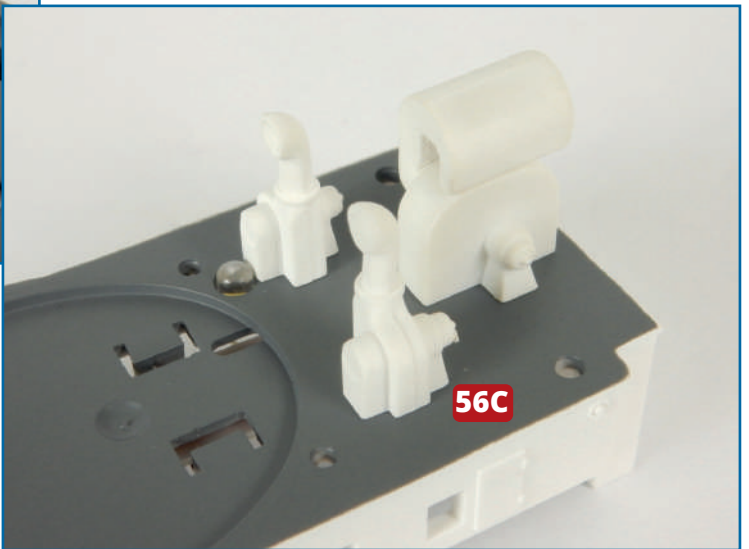
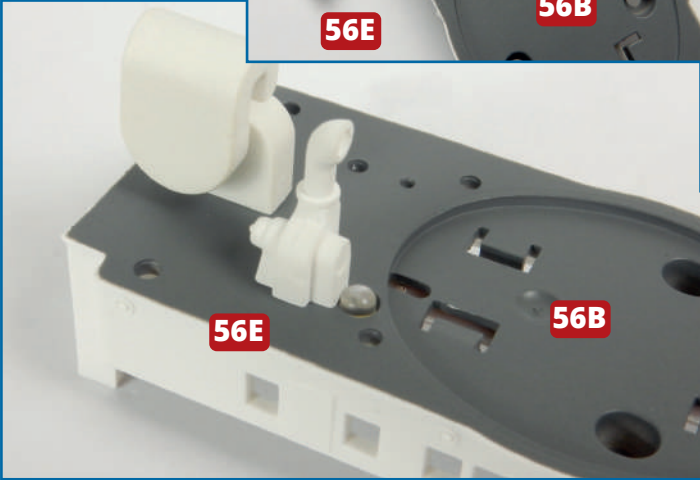
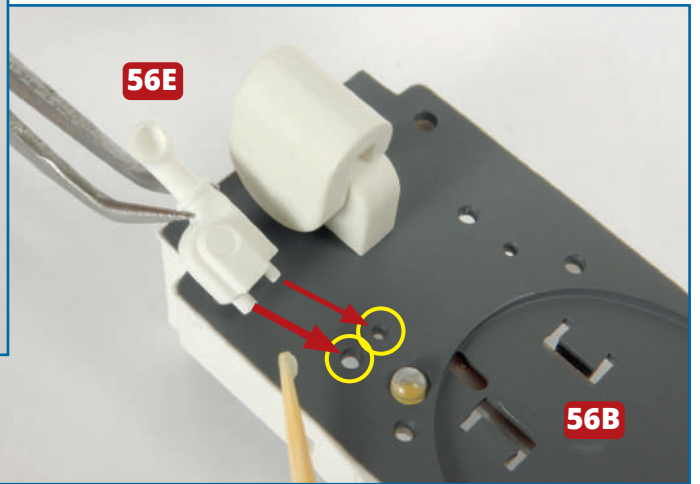
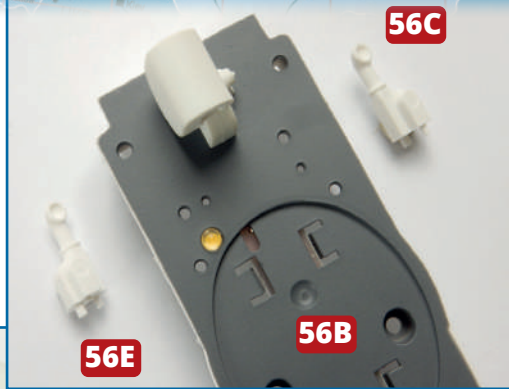

**3** Take the two ventilators A, **56C**, and B, **56E**, and glue them on the base of the fourth funnel **56B**, as shown in the photos above and on the right. The pegs are arranged differently to ensure you fit the ventilators on the correct sides.

### Completed work

LEDs and a circuit board have been fitted to the base of the fourth funnel, along with ventilators.

