

TITANIC

THE SHIP • THE LEGEND

Pack 9



THE FIRST TWO LIFEBOATS



PARTS IN THIS ISSUE

45A Lifeboats 3 and 5

45B Lifeboat block gear (x 4)

45C Tarpaulins (x 2)

45D Winch

45E Davit arm A

45F Davit arm B

45G Davit arms C1 (x 2)

45H Davit arms C2 (x 3)

45I Davit base A

45J Davit base B

45K Davit Base C (x 2)

45L Decking

NOTE: The davits are very similar: the instructions explain how to fit them in the correct positions.

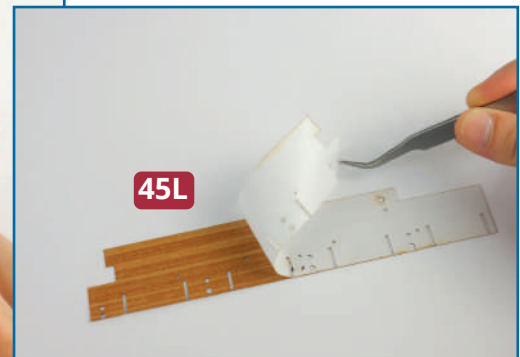
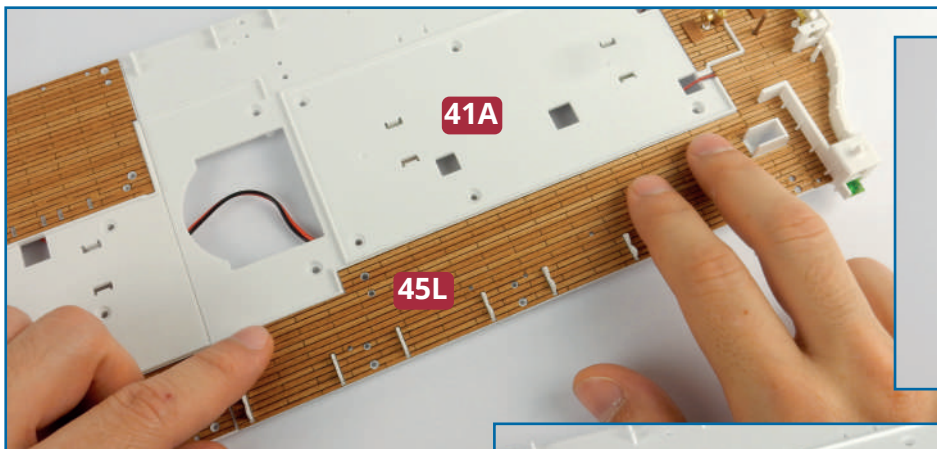

1 Take the front section of the boat deck **41A** and the decking **45L**. Check how the decking fits on the starboard side of the deck (above) then remove the backing (above right). Stick the decking in place, smoothing it down with a soft cloth.

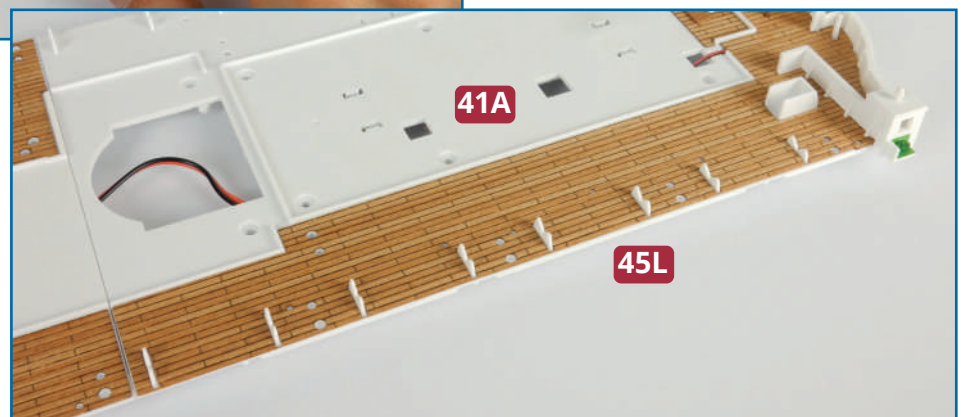



2 Check the fit of the winch **45D** on the deck and fix in place with a little glue. Note that the pegs on the base of the winch are different sizes to ensure you fit it in the correct position.

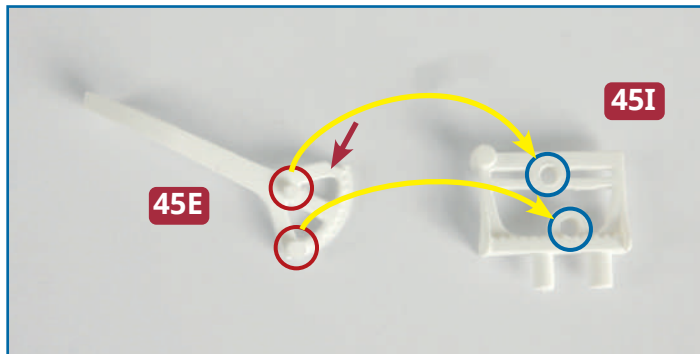
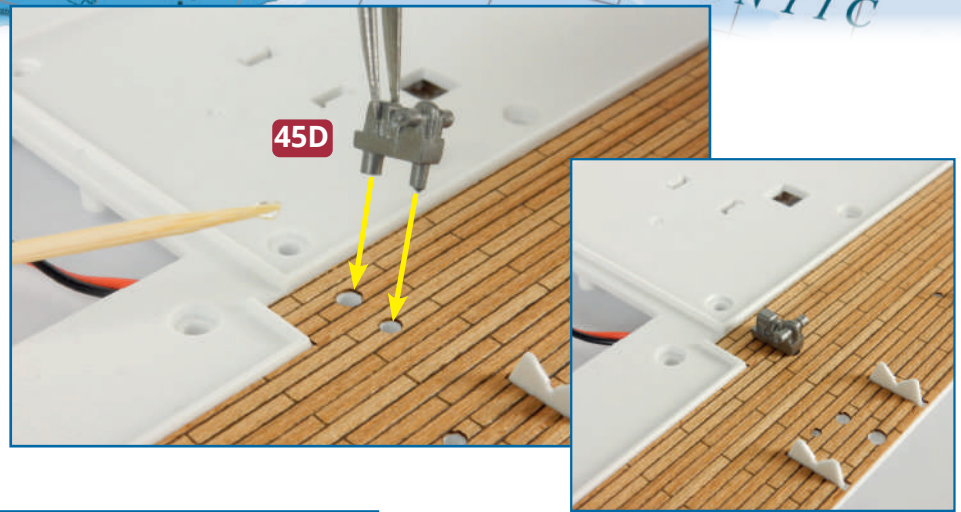

3 Take davit arm **A**, **45E**, and davit base **A**, **45I**. Part **45E** has two pegs (circled in red, above) and a cut-away corner (red arrow); the pegs fit in the holes in part **45I** (circled in blue, above). Glue the davit arm **45E** to the base **45I**, as shown on the right.

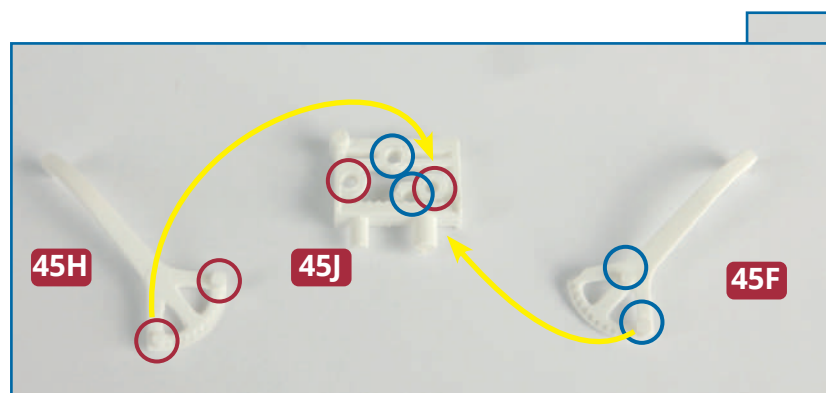
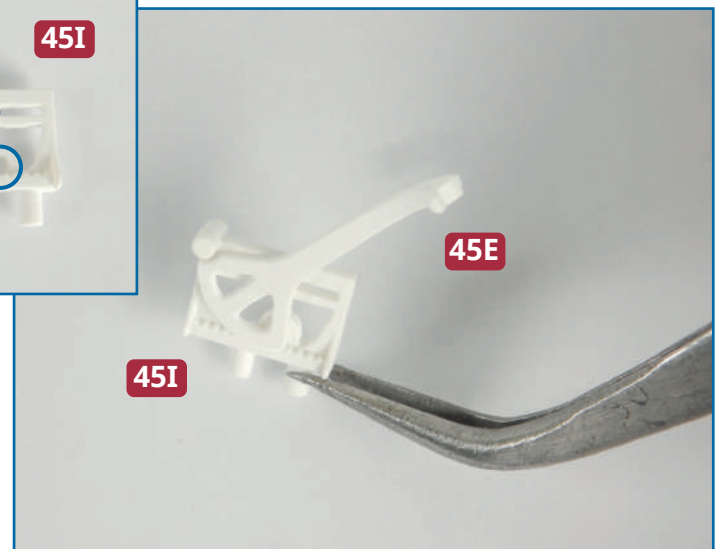

4 Take davit base **B**, **45J**, davit arm **B**, **45F**, and one of the **C2** davit arms **45H**. The photo above shows the positions of the pegs on parts **45H** and **45F** and the corresponding holes in part **45J**. Glue the arms to opposite sides of the base, as shown on the right.

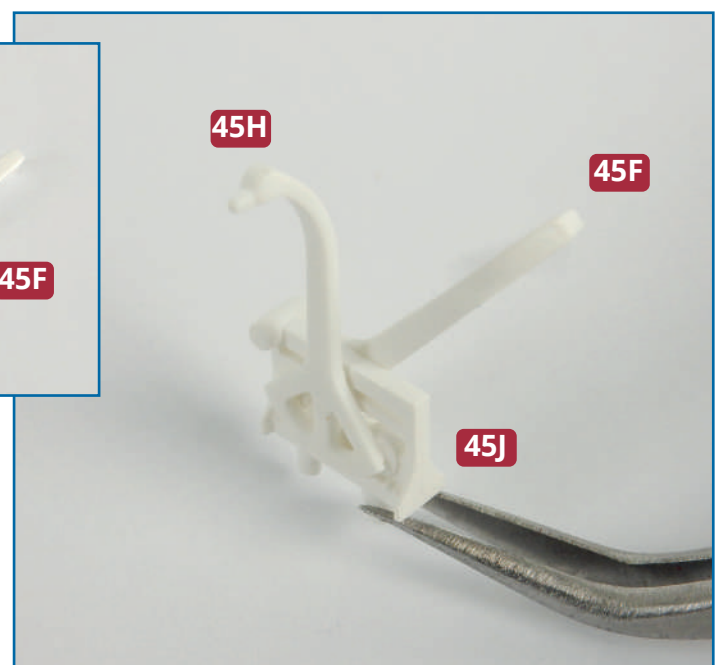

★ STEP-BY-STEP INSTRUCTIONS ★

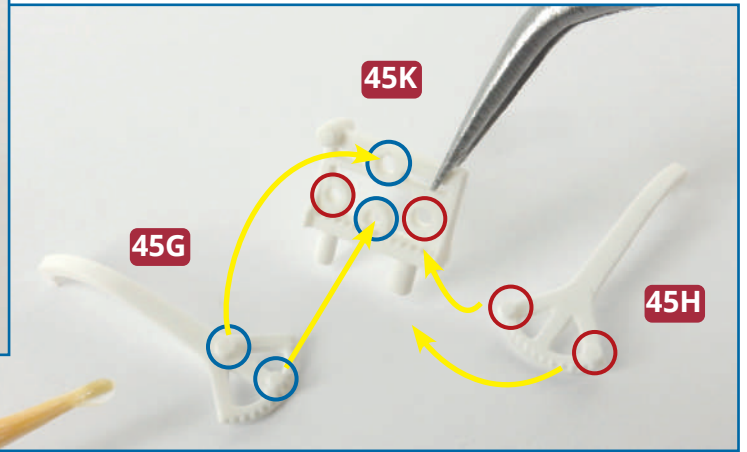
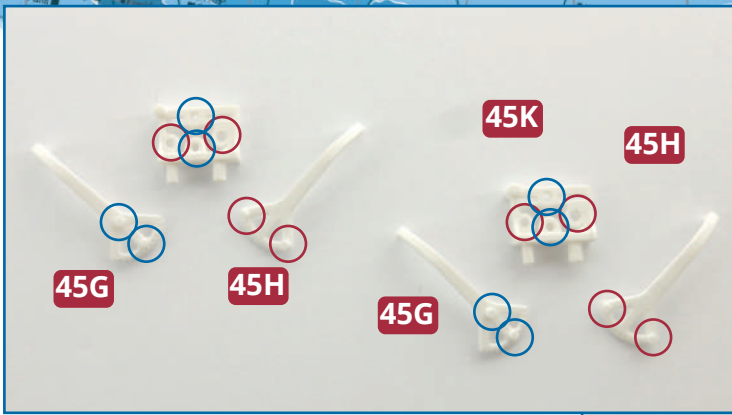

5 Take the two davit bases **C, 45K**, two davit arms **C1, 45G**, and two davit arms **C2, 45H**. The photo above shows the positions of the pegs and holes on each part. Glue the arms to opposite sides of the bases, to complete two davits.

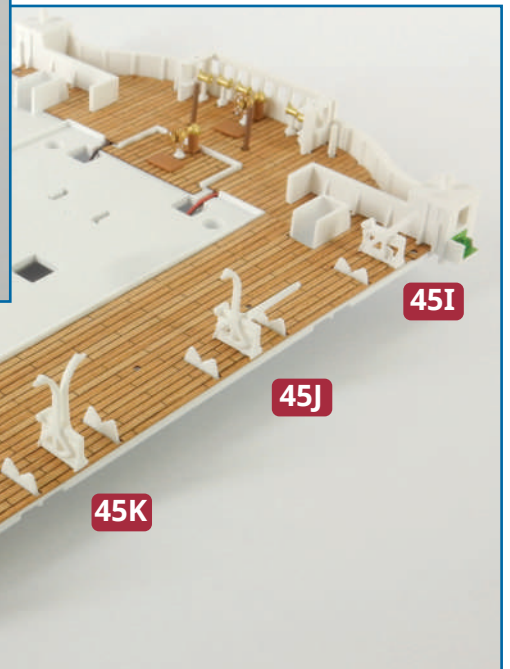
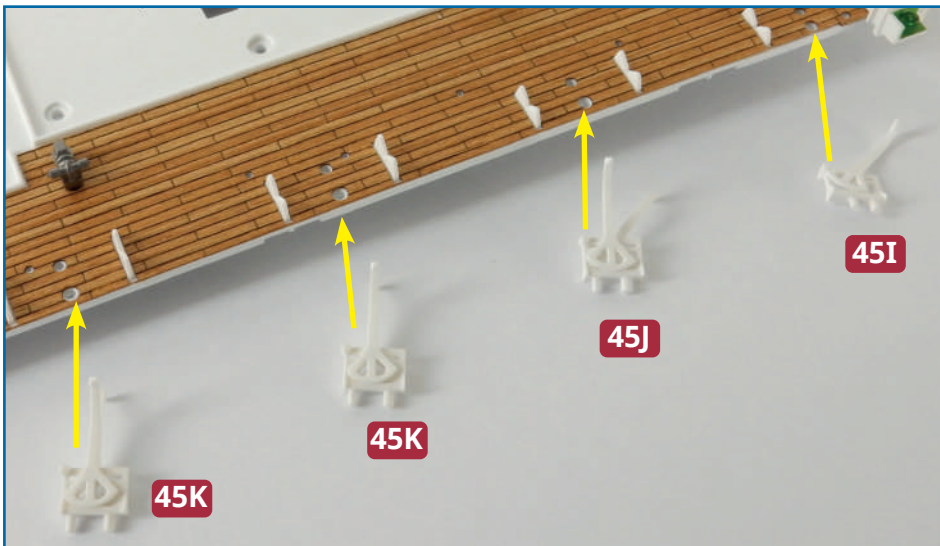
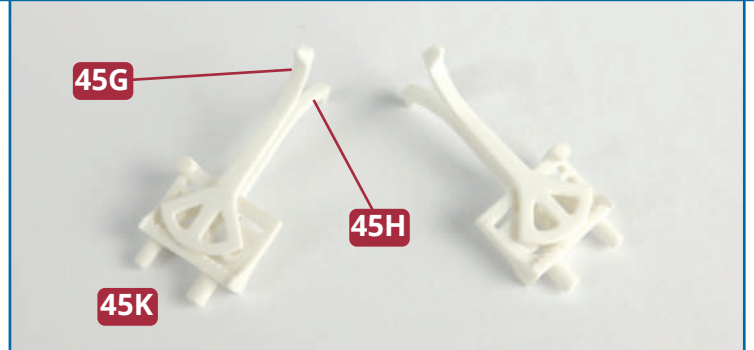

6 Identify the fixing points for the four davits on the deck, as indicated above. One peg on each davit base is larger, fitting into a correspondingly larger hole in the deck. Check that you have the four davits in the right positions, then glue them in place along the starboard side of the boat deck.

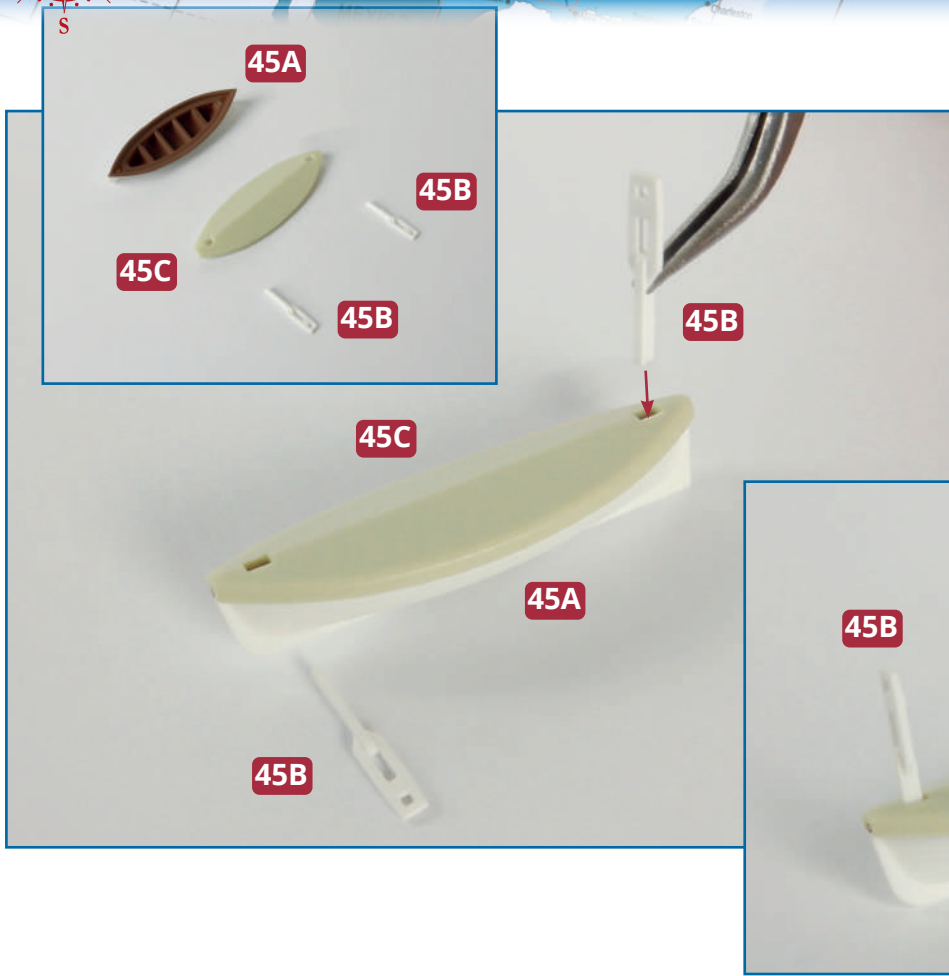

7 Fit a tarpaulin **45C** to each of the lifeboats **45A** and fit a block gear **45B** into the slots at each end of the tarpaulins. Do not use any glue at this stage.

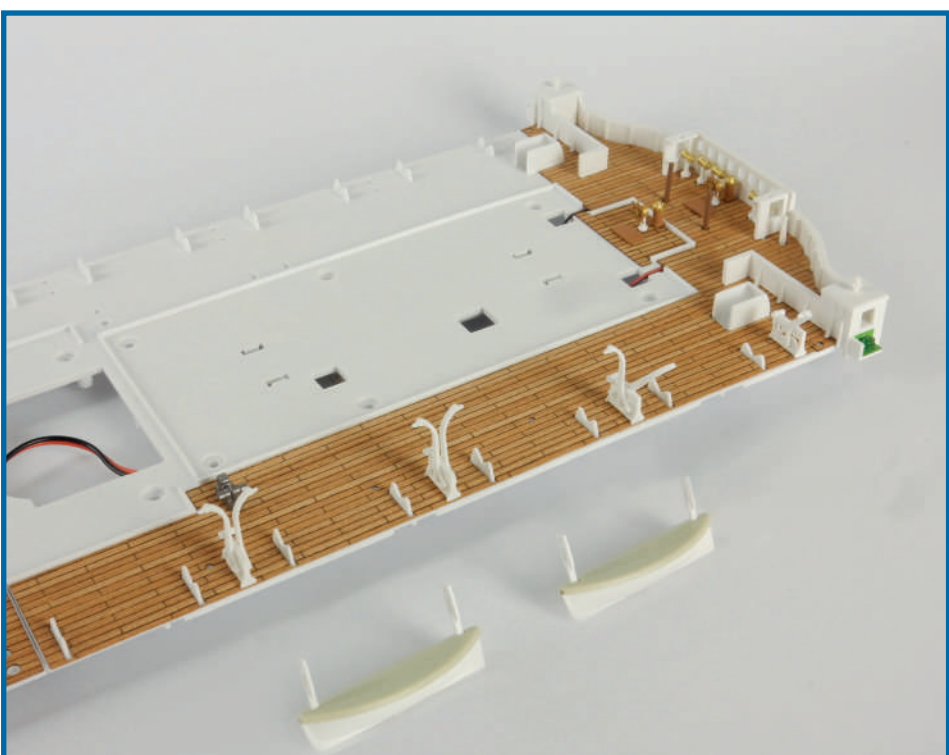
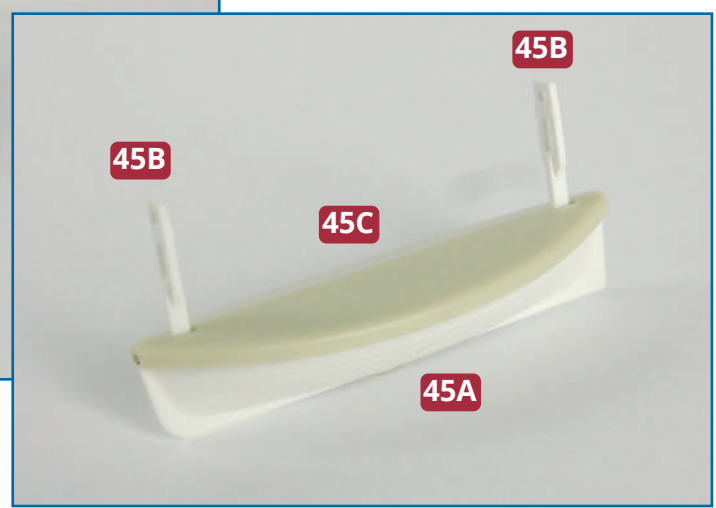

Completed work
The first four davits have been fitted to the boat deck, along with a strip of decking. The first two lifeboats have been assembled. Store them carefully until they are needed.

LIFEBOATS AND DAVITS FOR THE PORT SIDE

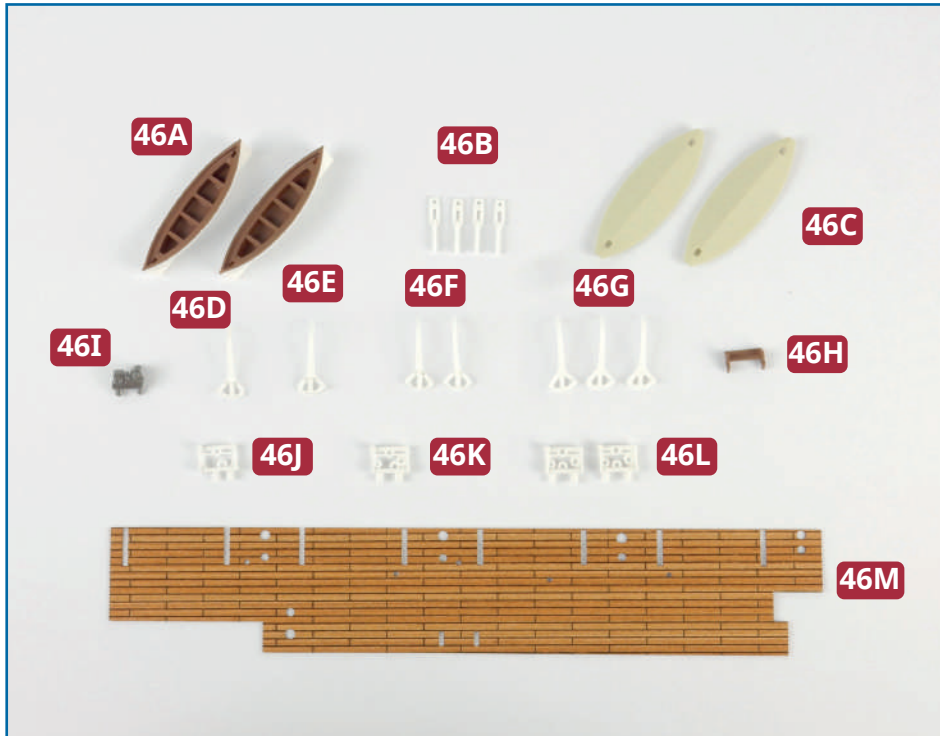

PARTS IN THIS ISSUE

- 46A** Lifeboats 4 and 6
- 46B** Lifeboat block gear (x 4)
- 46C** Tarpaulins (x 2)
- 46D** Davit arm A
- 46E** Davit arm B
- 46F** Davit arms C1 (x 2)
- 46G** Davit arms C2 (x 3)
- 46H** Bench
- 46I** Winch
- 46J** Davit base A
- 46K** Davit base B
- 46L** Davit Base C (x 2)
- 46M** Decking

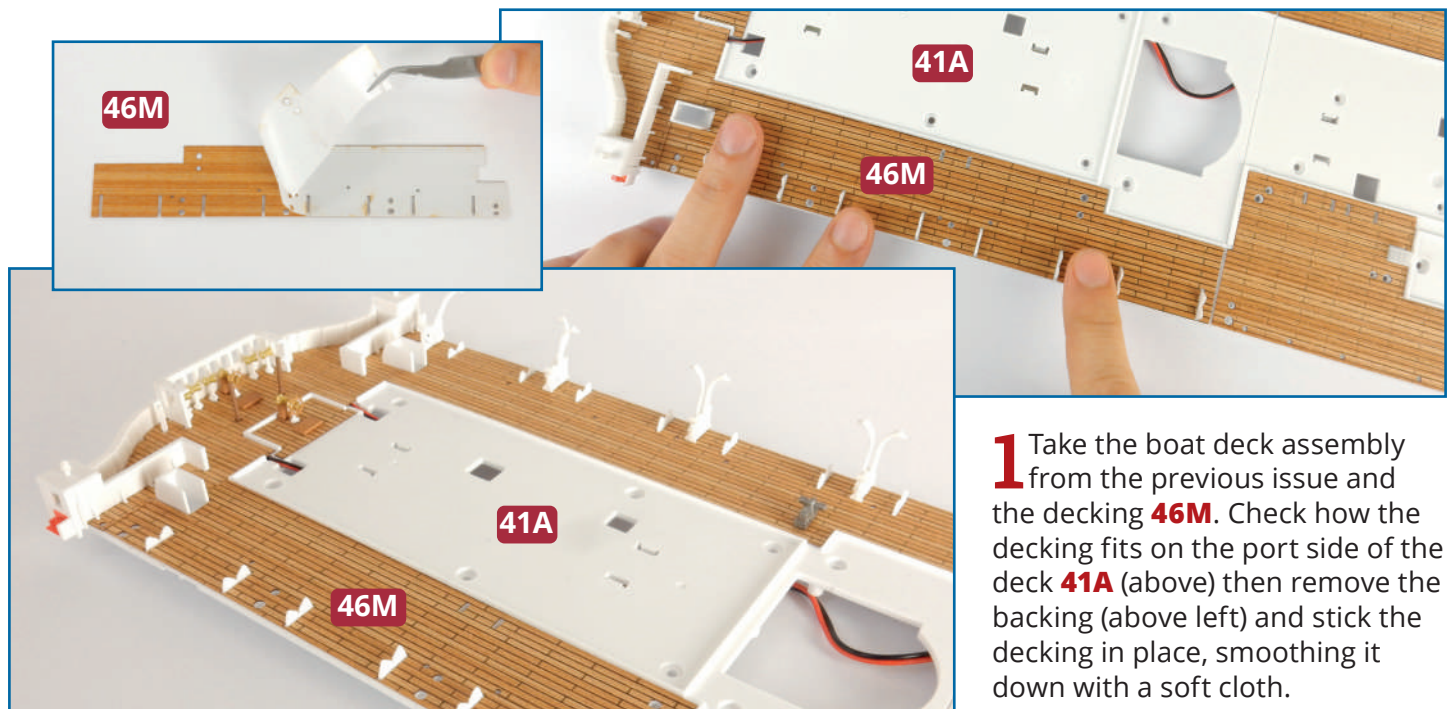

1 Take the boat deck assembly from the previous issue and the decking **46M**. Check how the decking fits on the port side of the deck **41A** (above) then remove the backing (above left) and stick the decking in place, smoothing it down with a soft cloth.

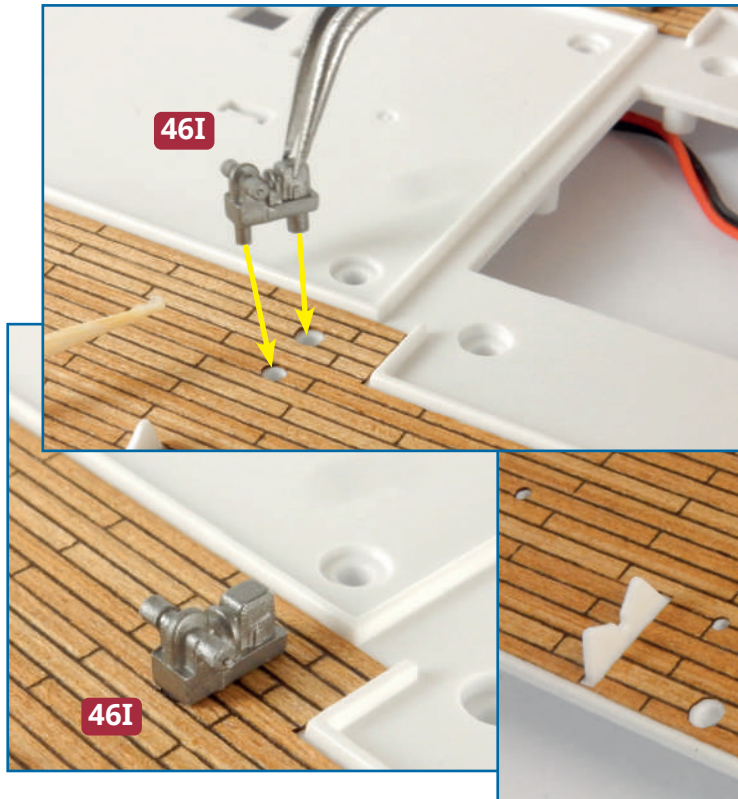

2 Check the fit of the winch **46I** on the deck and fix in place with a little glue. Note that the pegs on the base of the winch are different sizes to ensure you fit it in the correct position. Fit the bench **46H** in place as shown below, using a little glue.



3 Take davit arm **A**, **46D**, and davit base **A**, **46J**. Part **46D** has two pegs (circled) and a cut-away corner (arrow); the pegs fit in the holes in part **46J** (circled), as shown in the photo, near right. Glue the davit arm **46D** to the base **46J**, as shown in the photo far right.

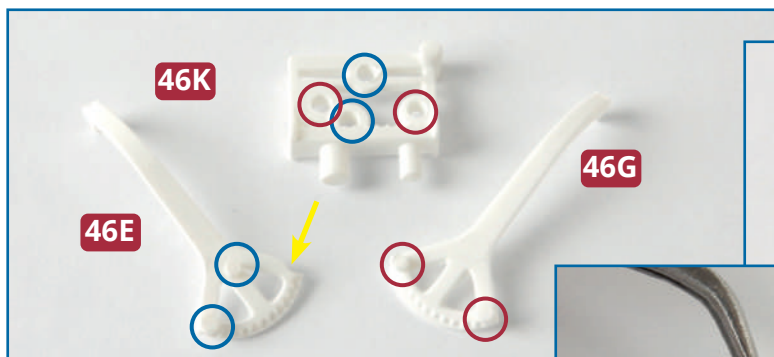
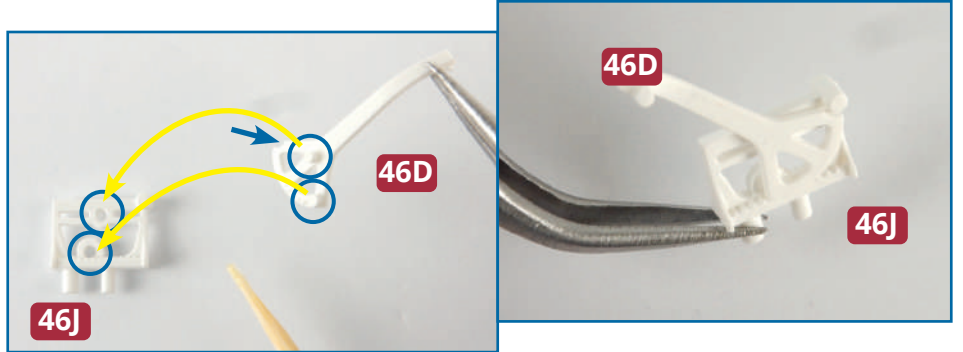

4 Now take davit base **B**, **46K**, davit arm **B**, **46E**, and one of the **C2** davit arms **46G**. Glue one of the arms to each side of the base (right).

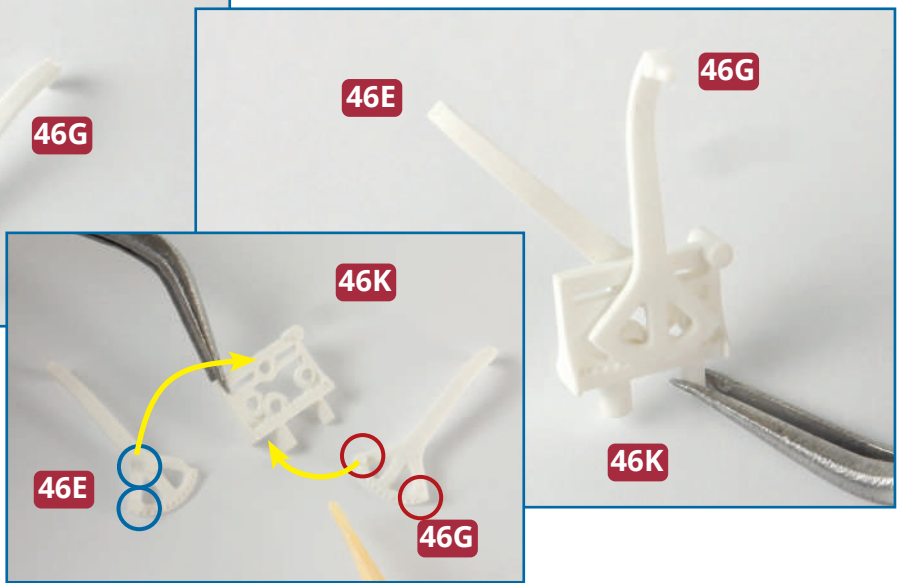

★ STEP-BY-STEP INSTRUCTIONS ★

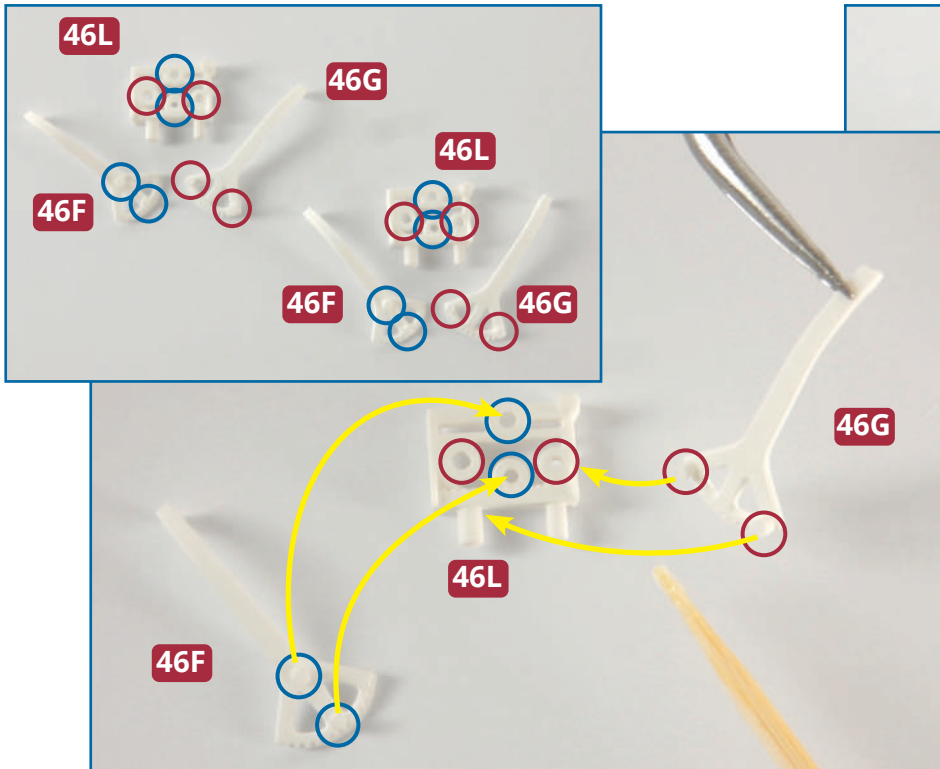

5 Take the two davit bases **C**, **46L**, two davit arms **C1**, **46F**, and two davit arms **C2**, **46G**. Glue one of the arms to each side of each of the bases, to complete two davits.

6 Identify the fixing points for the four davits, as indicated, right. Note that one peg on each of the davit bases is larger than the other to ensure you fit them the correct way round. Check that you have the four davits in the right positions, then glue them in place along the port side of the boat deck.

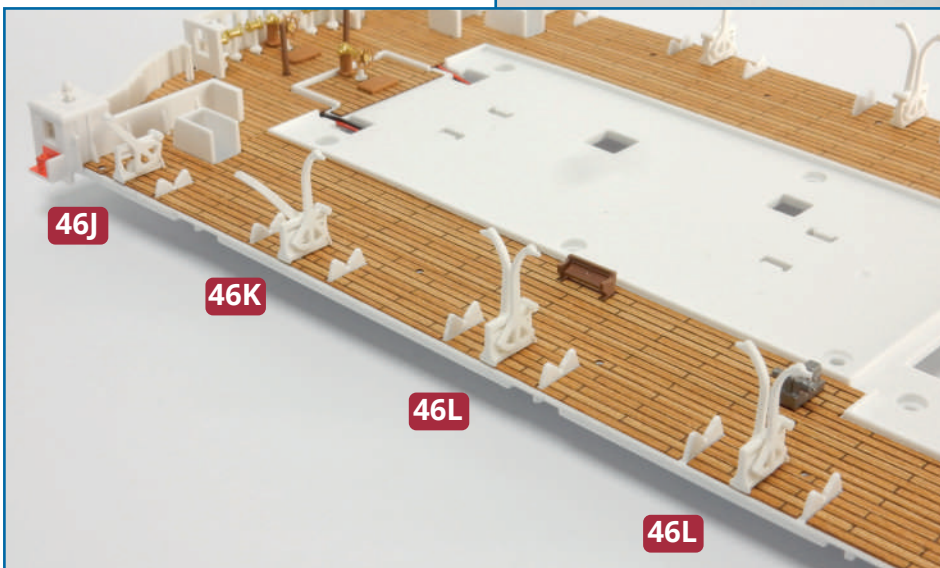
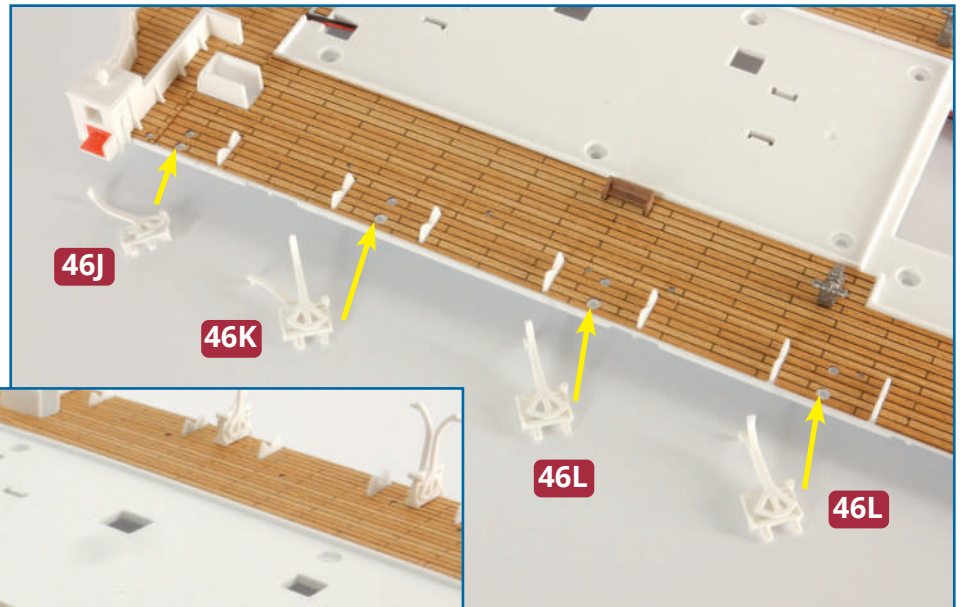

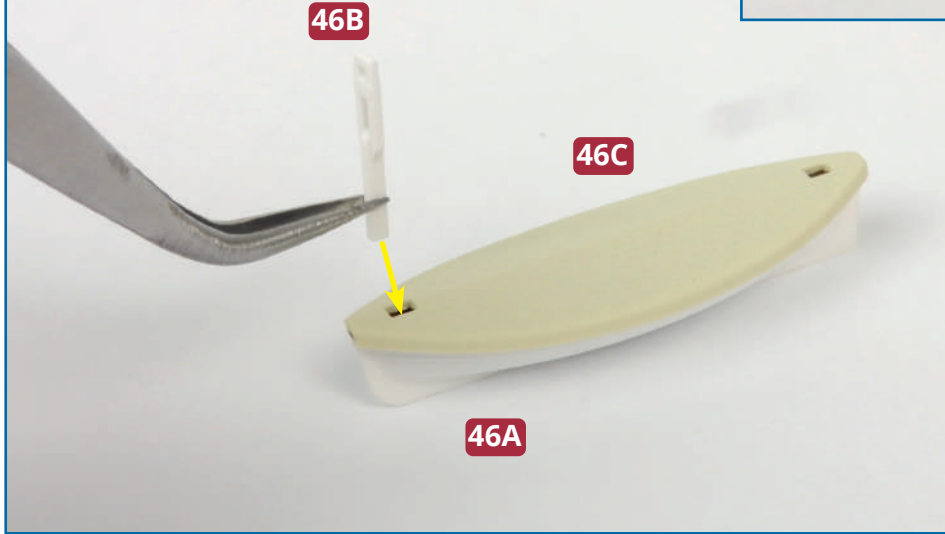
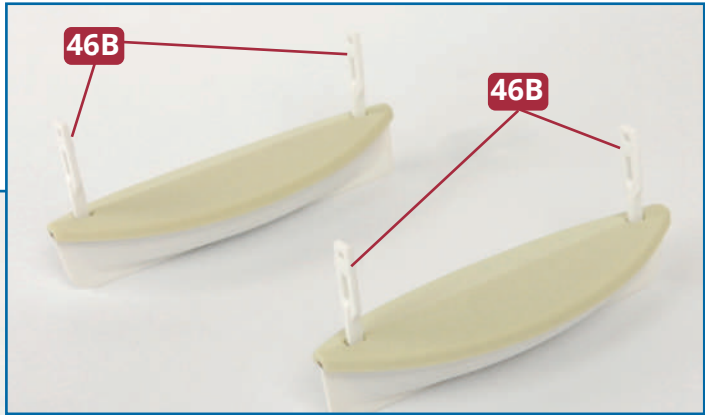
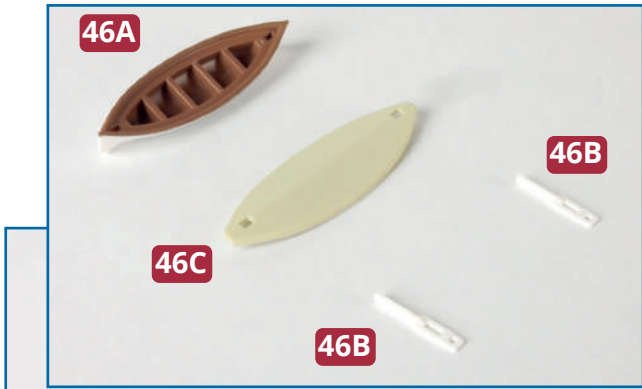

7 Fit a tarpaulin **46C** to each of the lifeboats **46A** and fit a block gear, **46B** into the slots at each end of the tarpaulins. Do not use any glue at this stage.

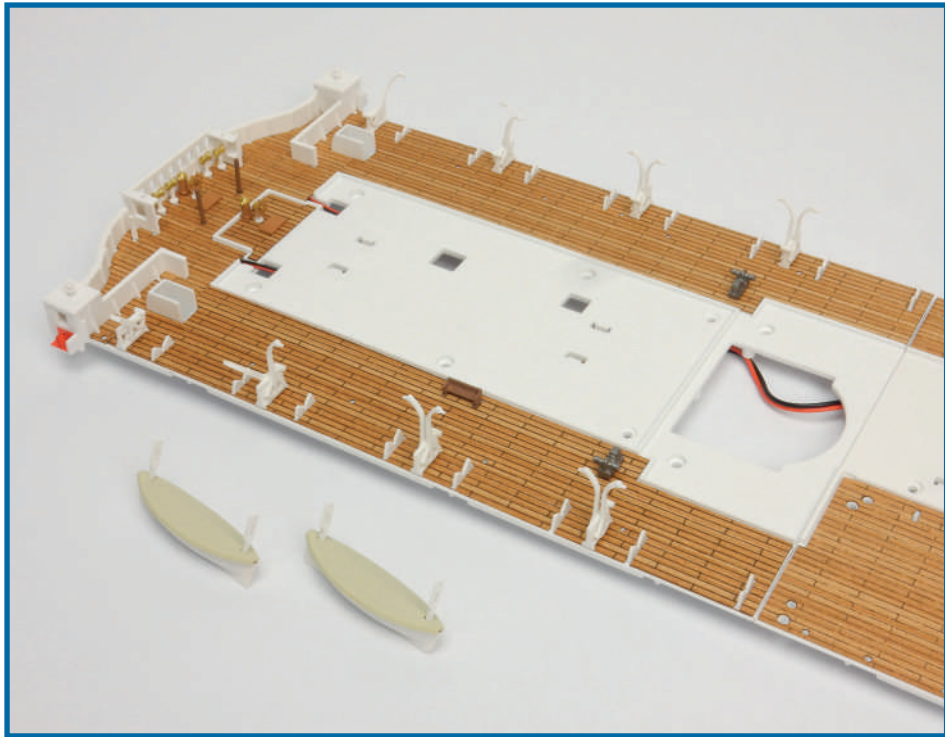

Completed work

Four more davits have been fitted to the boat deck, along with a strip of decking. The next two lifeboats have been assembled. Store them carefully until they are needed.

DECK OVER THE FIRST-CLASS LOUNGE

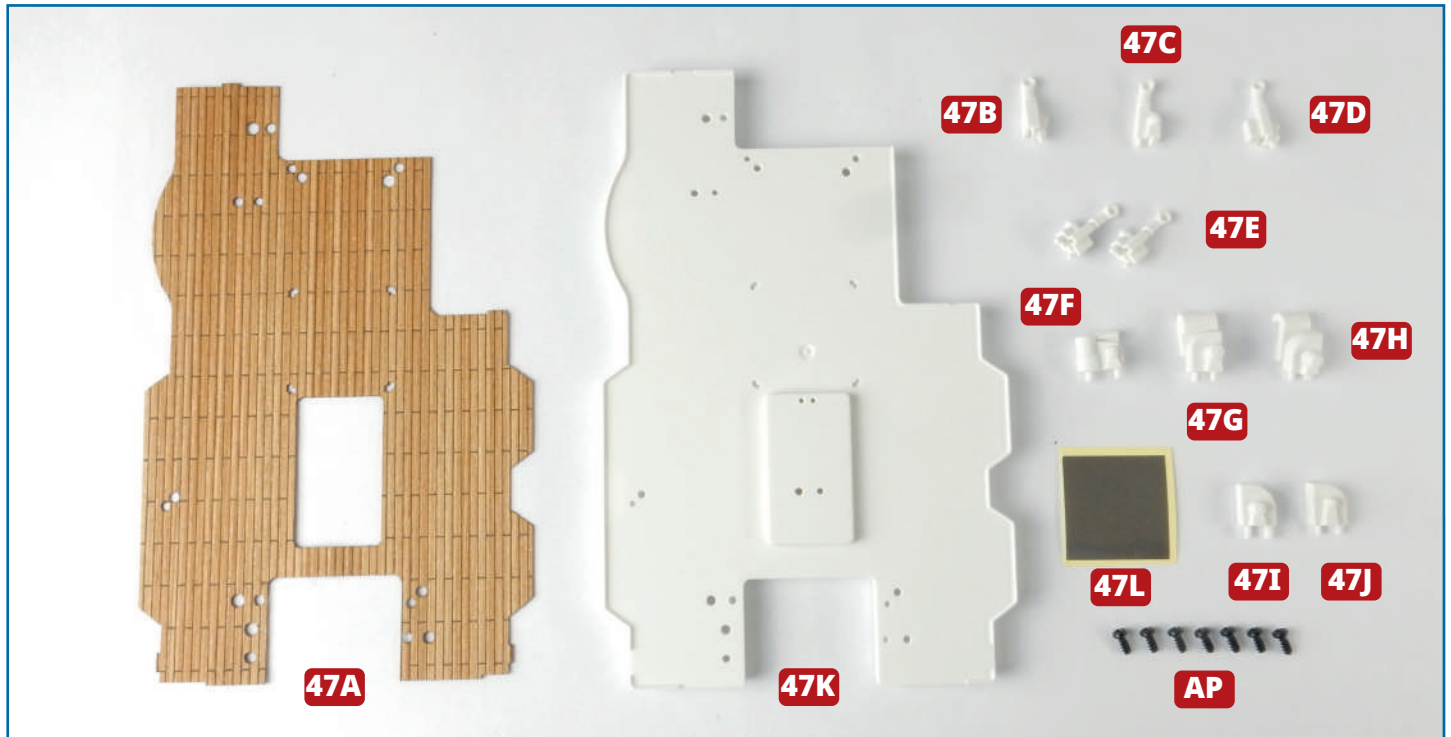

PARTS IN THIS ISSUE

47A Decking

47B Cowl A

47C Cowl B

47D Cowl C

47E Cowl D (x 2)

47F Vent A

47G Vent B

47H Vent C

47I Vent D

47J Vent E

47K Deck over the first-class lounge

47L Foil sticker

AP Seven 2.3 x 5mm PB screws (1 spare)

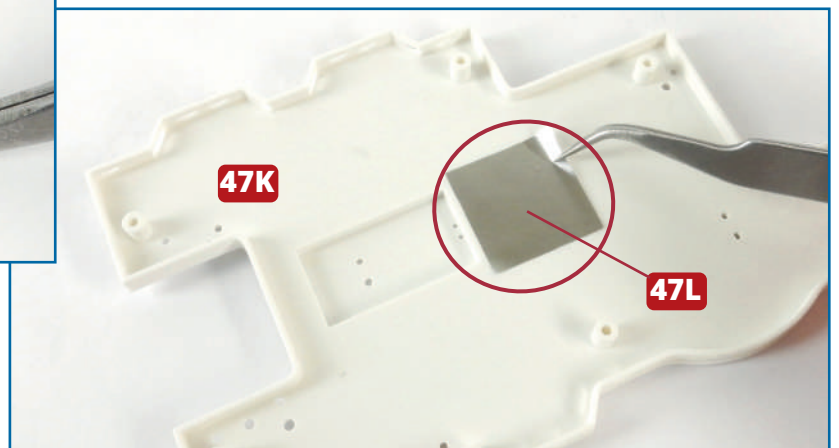

1 Remove the protective film from the foil sticker **47L**, then apply it to the inside of the roof of the first-class lounge **47K**, in the position indicated by the red circle. Rub down carefully with a soft cloth.

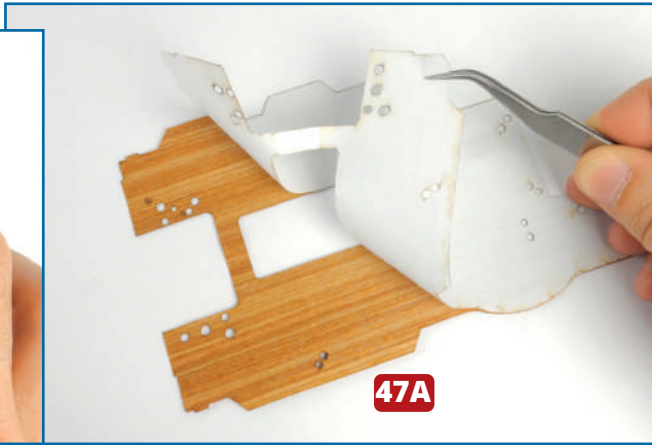
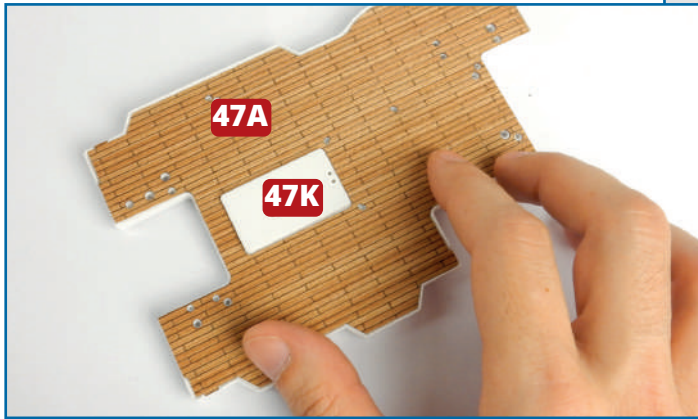

2 Take the deck over the first-class lounge **47K** and the decking **47A**. Check the fit, then remove the backing from the decking and fix it in place over part **47K**, ensuring that all the holes are correctly aligned. Smooth it down with a soft cloth; you may find it helpful to use a cotton bud to smooth the edges into place against raised parts of the deck.

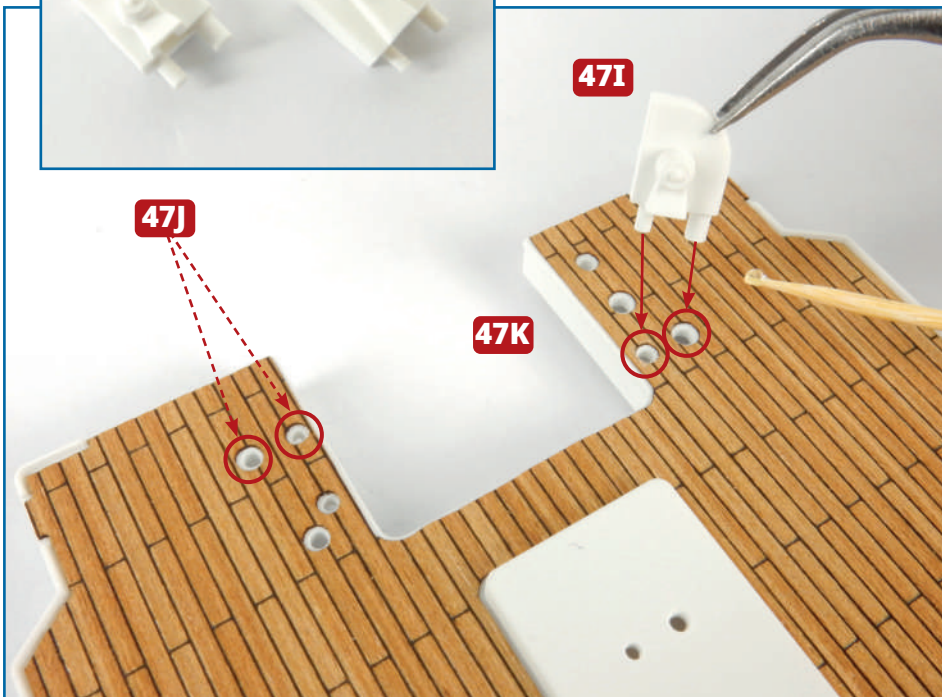
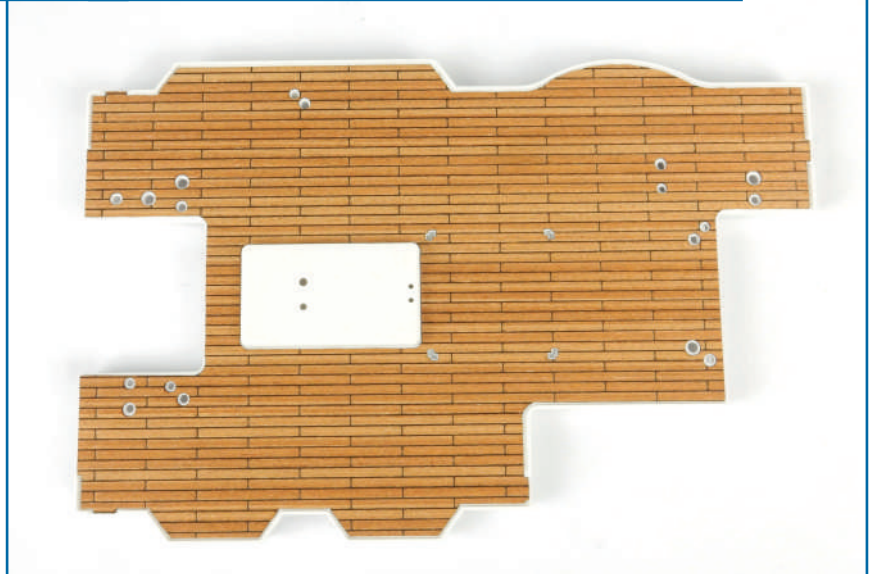

3 Take the two vents D and E, **47I** and **47J**. Identify the holes where they fit on the roof **47K** (circled, left): note that one peg on each vent is larger than the other to help you position them correctly. Glue them in place, as shown below.

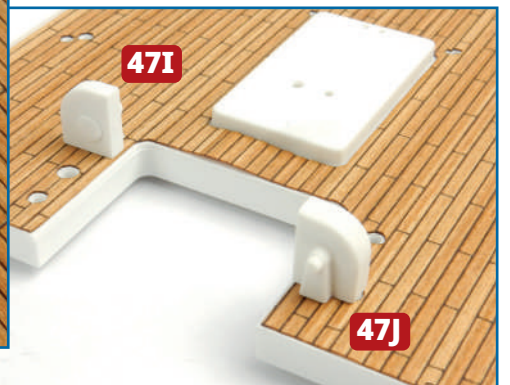

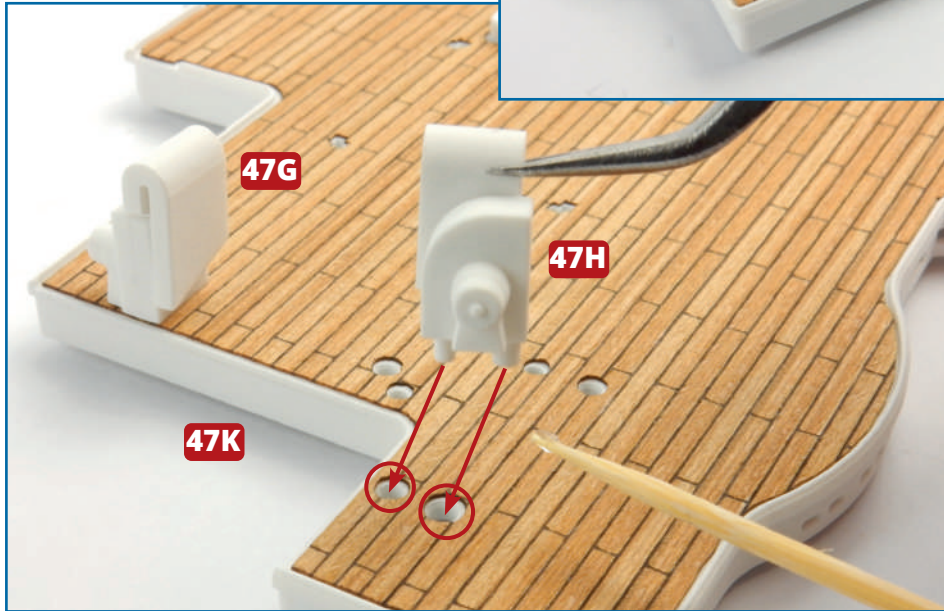
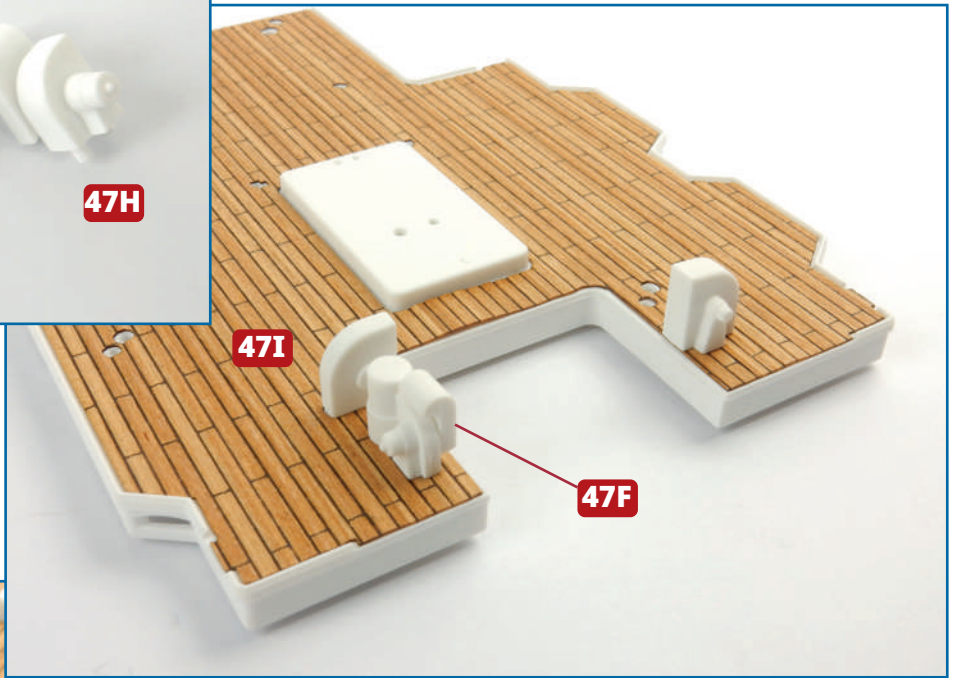

4 Next, take the three vents A, B and C (**47F**, **47G** and **47H**). Vent A **47F** fits behind Vent D **47I**. Glue in place, as shown. Vents B and C (**47G** and **47H**) are glued in place at the forward end of the roof **47K**. Again, note the pegs on the vents are different sizes.

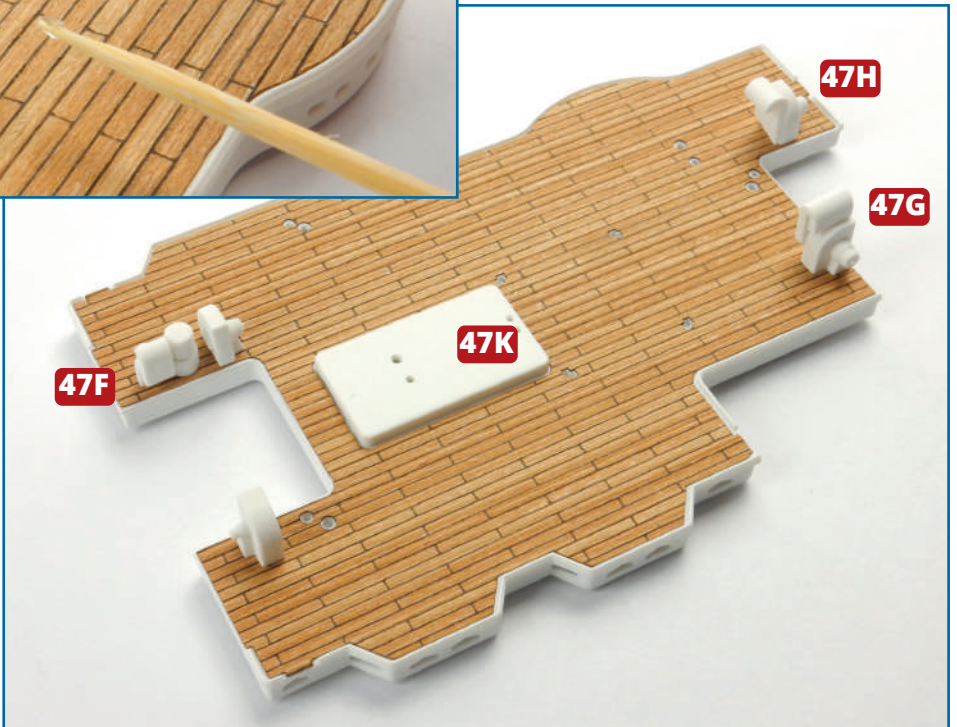

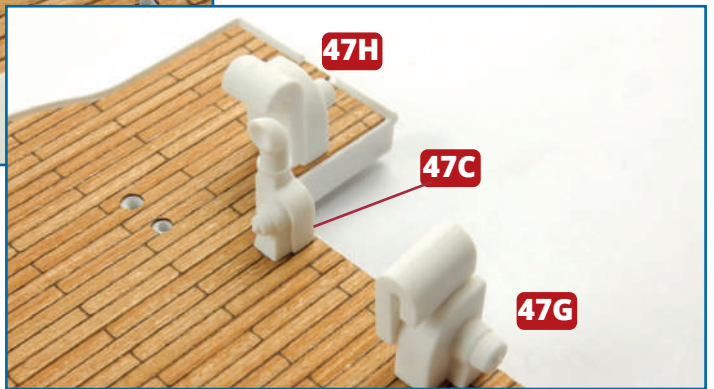
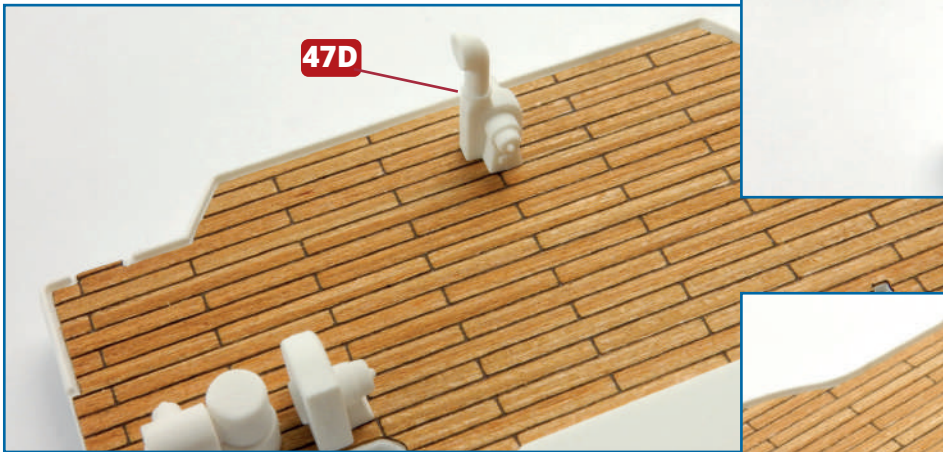
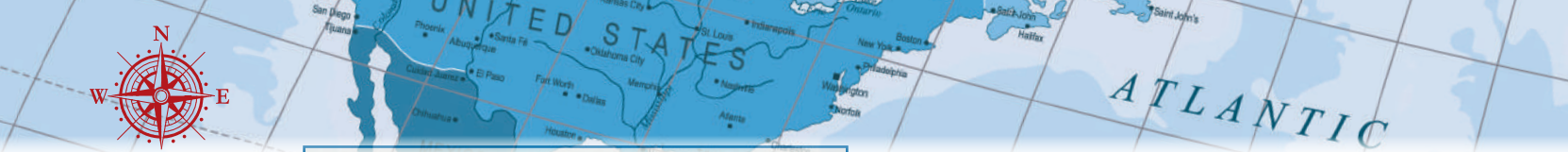

5 Take cowls A, B and C (**47B**, **47C** and **47D**). Check the fit of each one around the edges of the decking. Again, the pegs on the vents are different sizes. Fix each one in place with a little superglue.

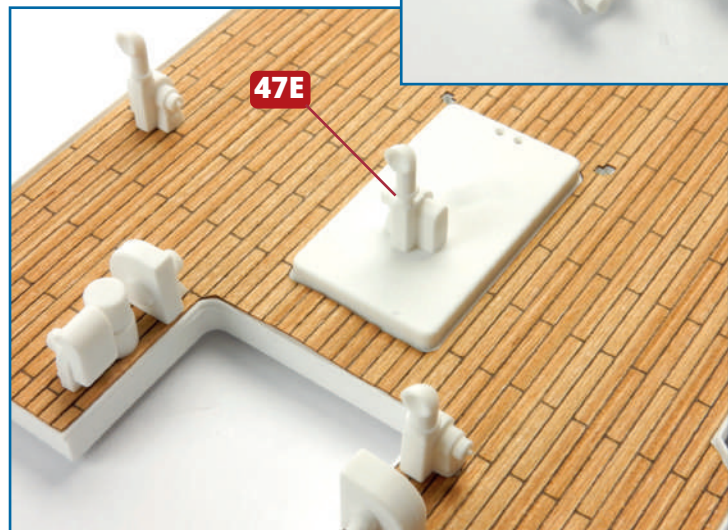

6 Next, fit the two cowls D (**47E**) in place: one fits in the centre of the raised rectangular area and the second fits behind vent **47H**. The different sized pegs on the cowls ensure they are fitted facing the right way.

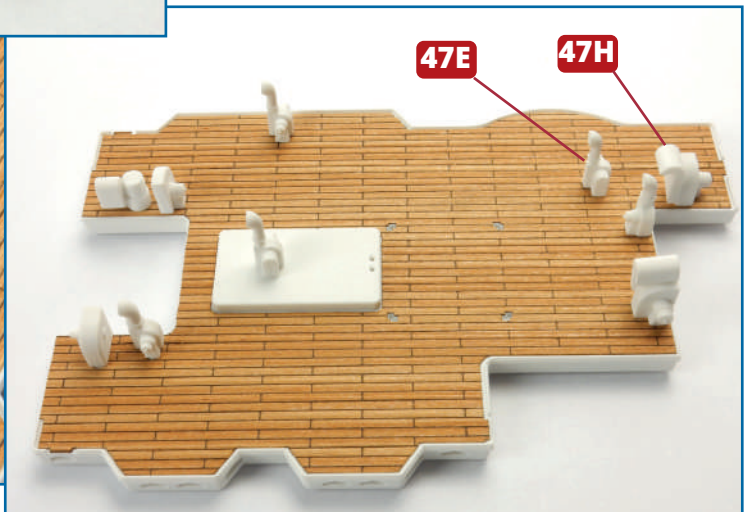

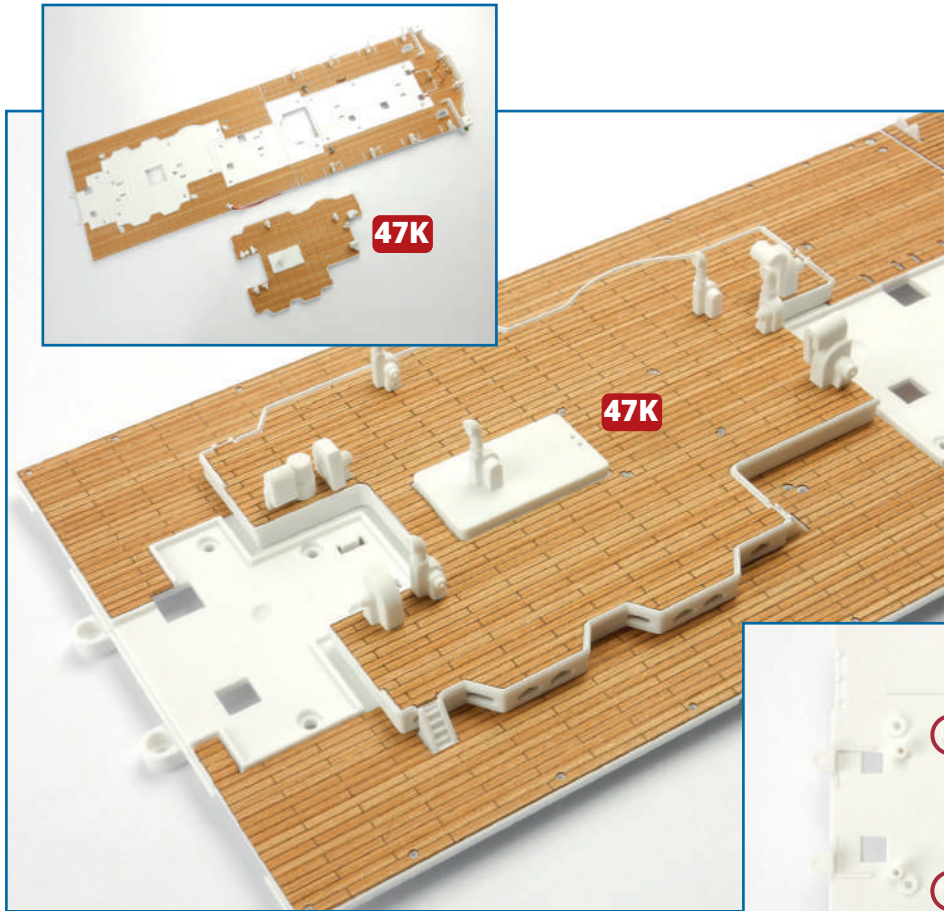

7 Take the boat deck from the previous issue and check how the roof of the first class lounge **47K** fits at the aft end of the assembly. Carefully turn the assembly over and rest it on something soft, such as a towel, to avoid damaging any of the details that have been fitted. Fix the roof of the lounge in place with six **AP** screws (below).

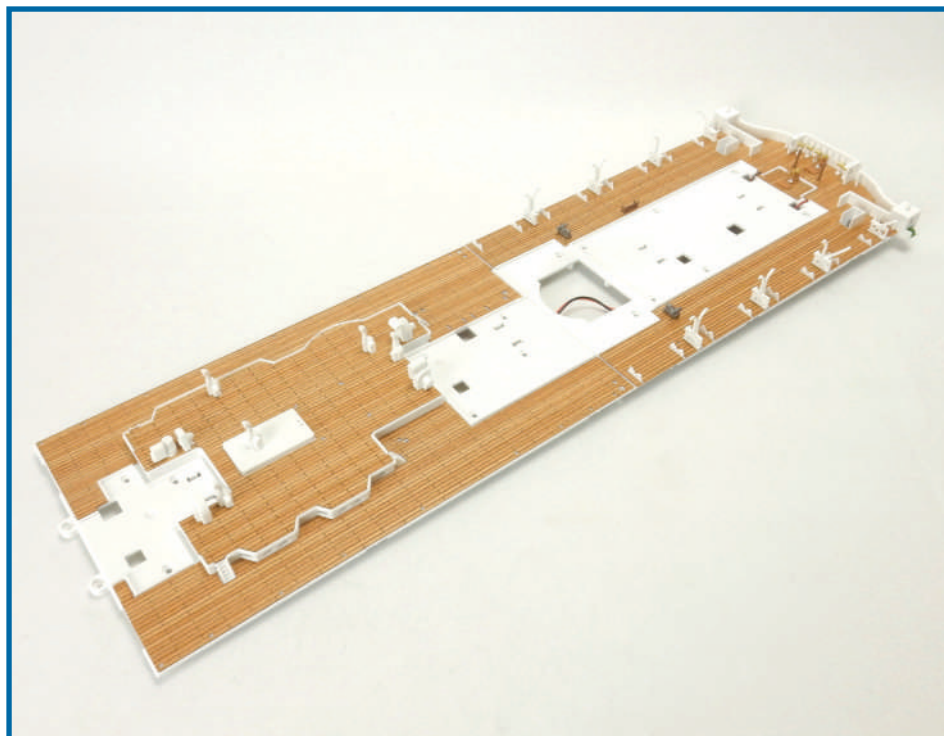
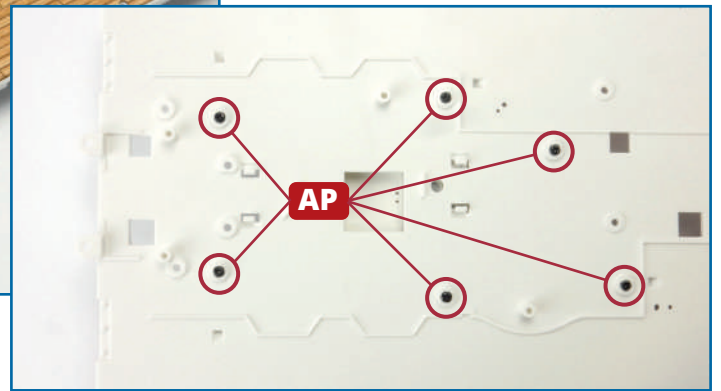

Completed work

Cowls and vents have been fitted to the deck over the first-class lounge and the roof has been fixed in place on the boat deck.



THE FORWARD FIRST-CLASS STAIRCASE

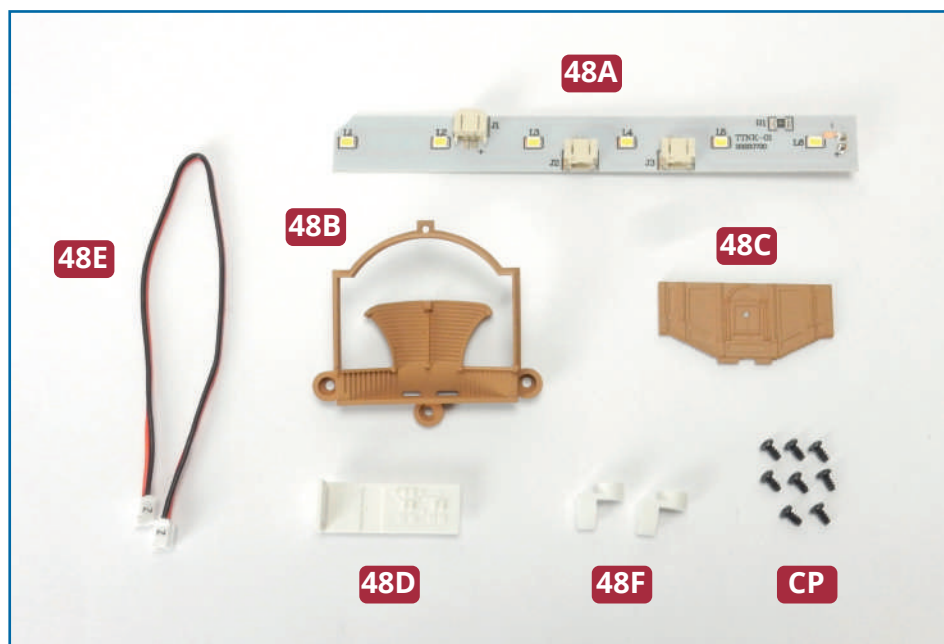

PARTS IN THIS ISSUE

- 48A** LED Strip
- 48B** Forward staircase
- 48C** Forward staircase wall
- 48D** Wheelhouse bulkhead
- 48E** LED cable
- 48F** Corner joint (x 2)
- CP** Eight 2.3 x 5mm PB screws (1 spare)

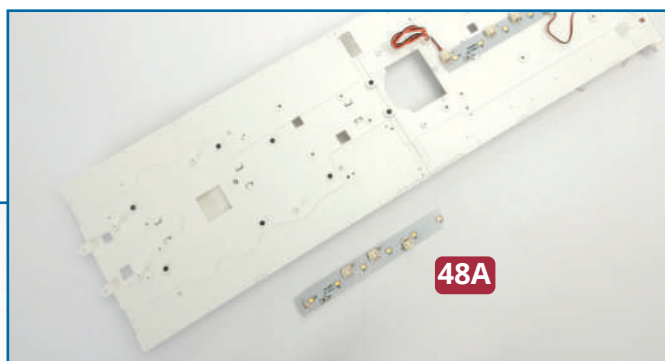

1 Take the boat deck **41A** from the previous issue and place it upside down on your work surface, taking care not to damage the assembly. (It may help to rest the centre of the deck on a couple of the packaging boxes so that the davits are not damaged.)

Identify the fixing point for the LED strip **48A**. Fit one long edge beneath the two tabs (circled, left) then fit the other edge in place, levering the tabs up with a small flat screwdriver (circled, below).

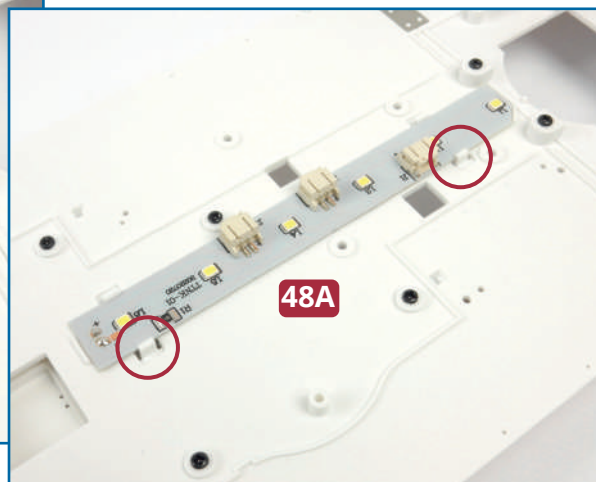
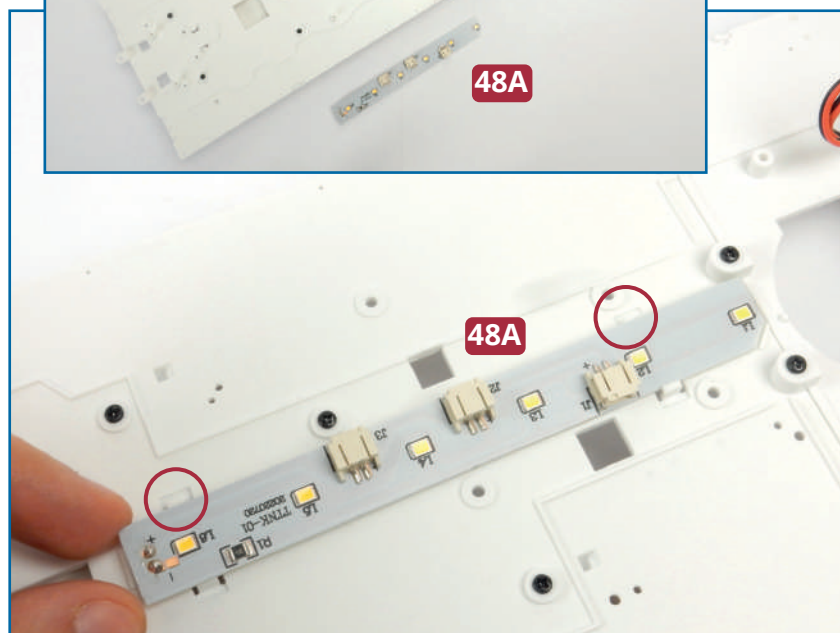

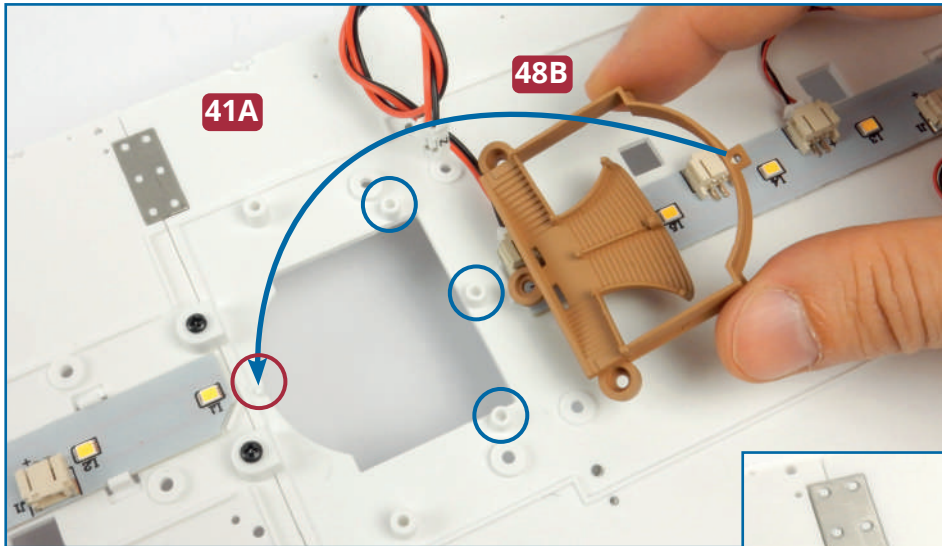

2 Fit the forward staircase **48B** in the opening in the boat deck **41A** as shown. A hole in the tab on the rim of the staircase fits over a peg on the underside of the deck (arrow, above). Screw holes on the edge of the staircase fit over raised screw sockets (circled in blue). Fix in place with three **CP** screws (right).

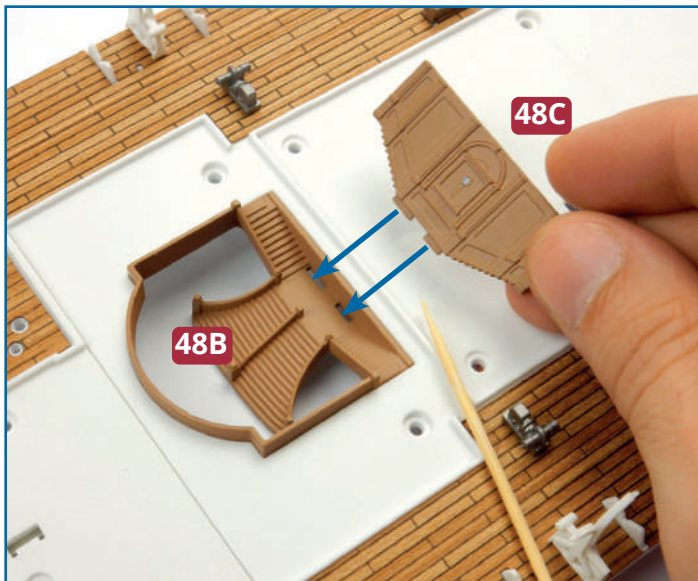
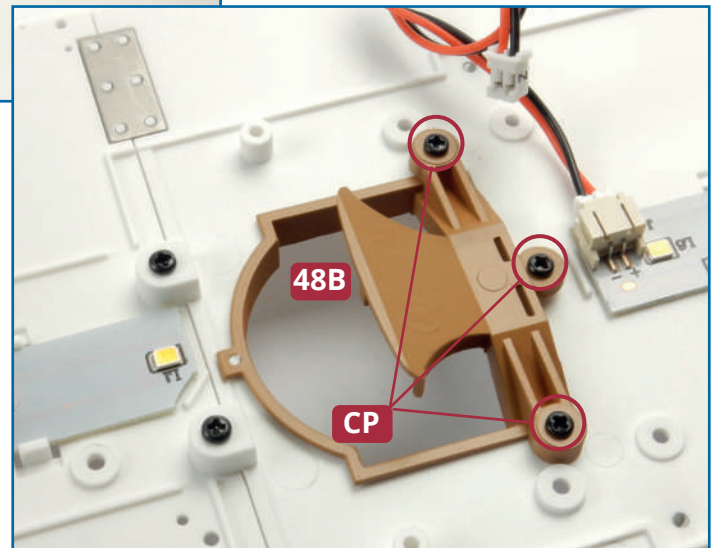

3 Turn the assembly the right way up and check the fit of the tabs on the lower edge of the forward staircase wall **48C** in the two slots in the staircase, as indicated (above). Glue in place.

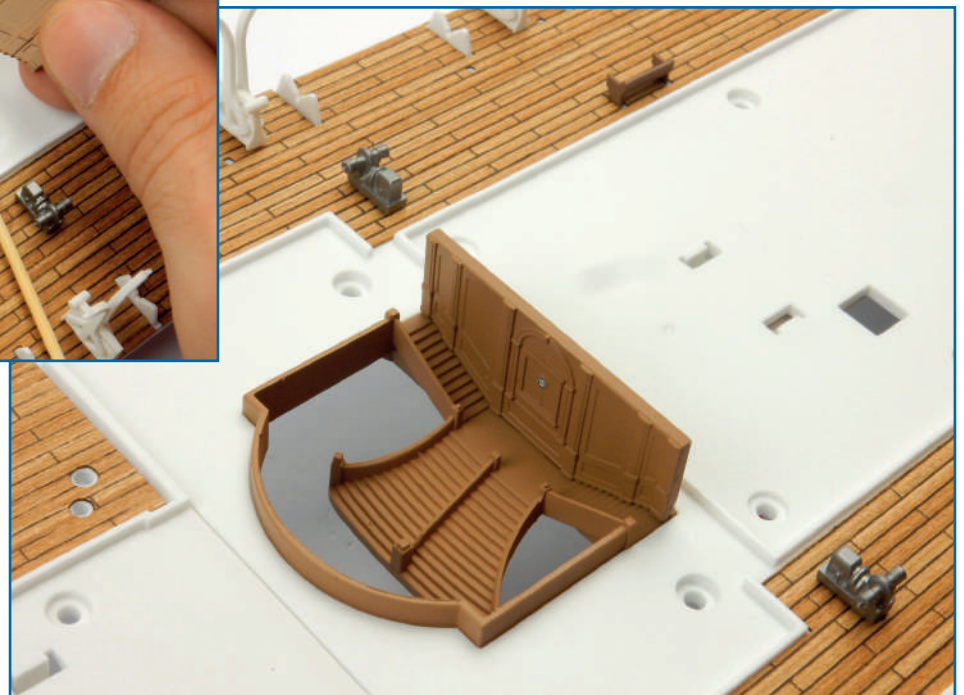

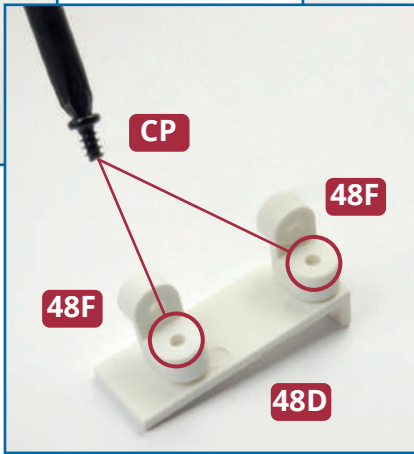
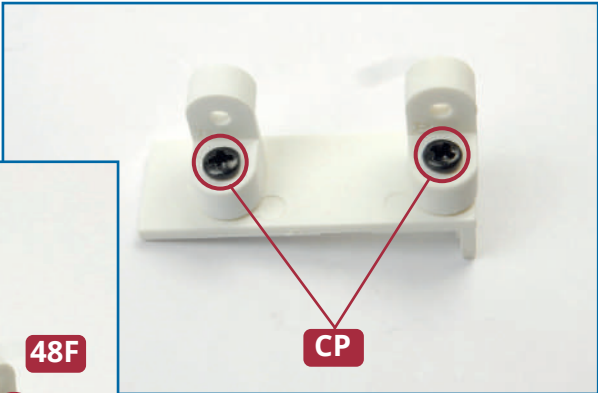
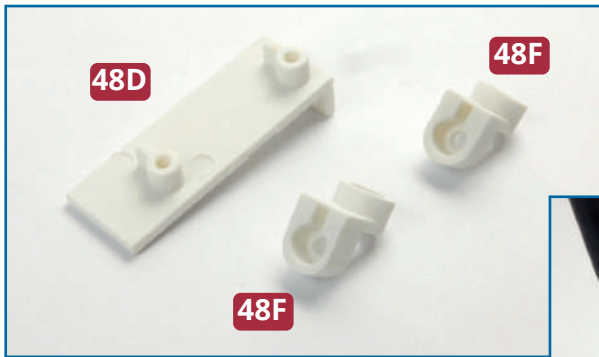

4 Take the wheelhouse bulkhead **48D** and the two corner joints **48F**. Position the two joints on the aft side of the bulkhead so that the raised screw sockets with tabs on part **48D** fit into the recesses in parts **48F**. Fix in place with two **CP** screws.

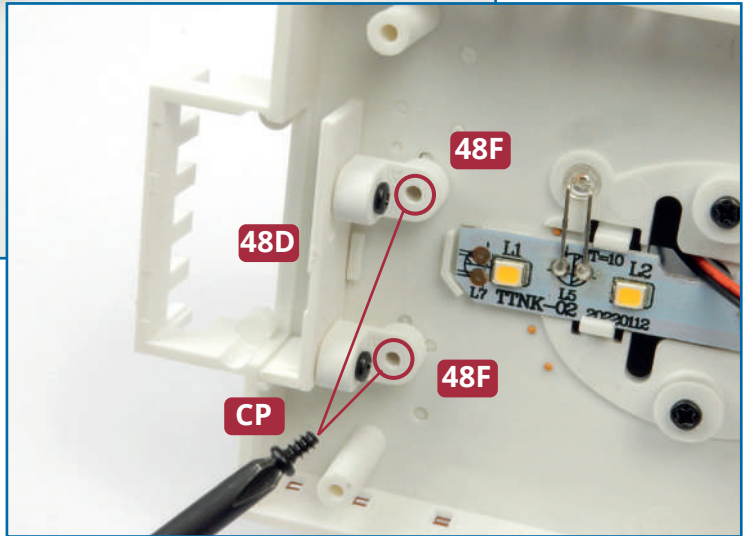
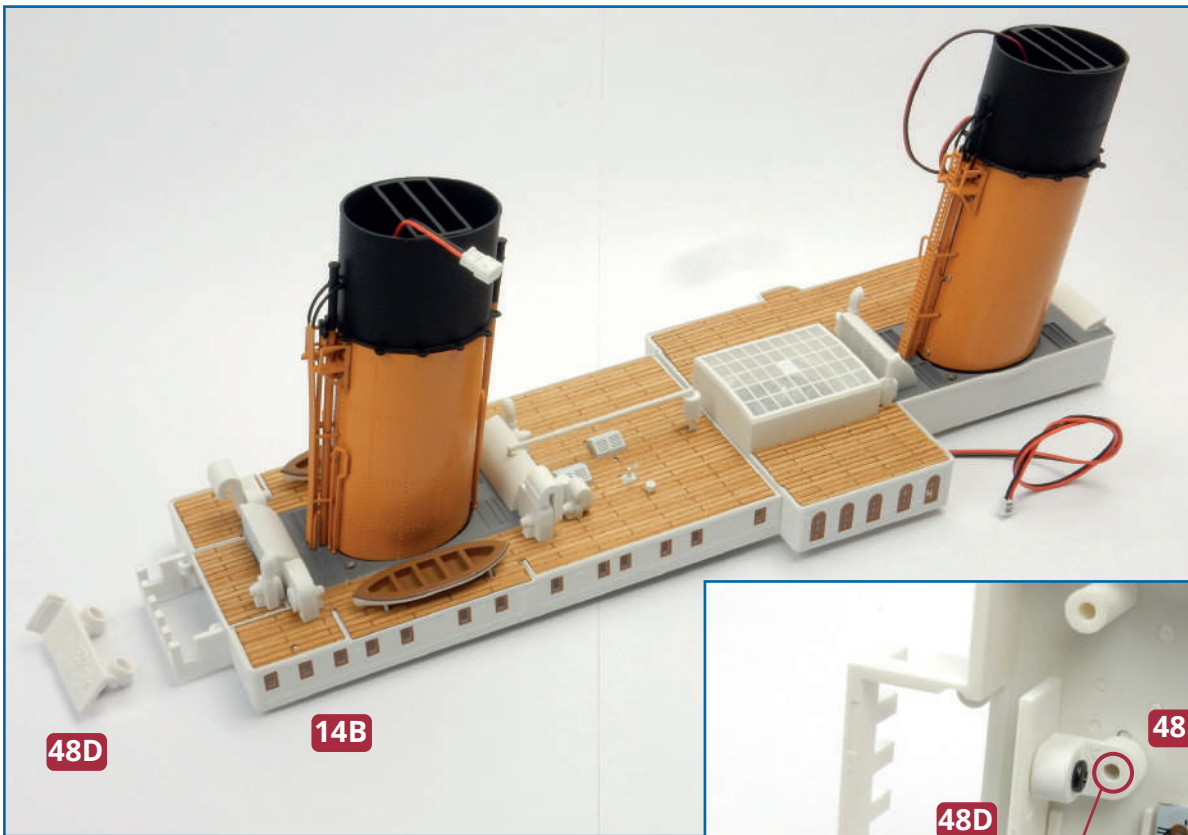

5 Take the superstructure and funnel assembly from issue 44. Check where the wheelhouse bulkhead fits inside the assembly, at the forward end. Fix the two corner joints in place with two **CP** screws, as indicated (right).

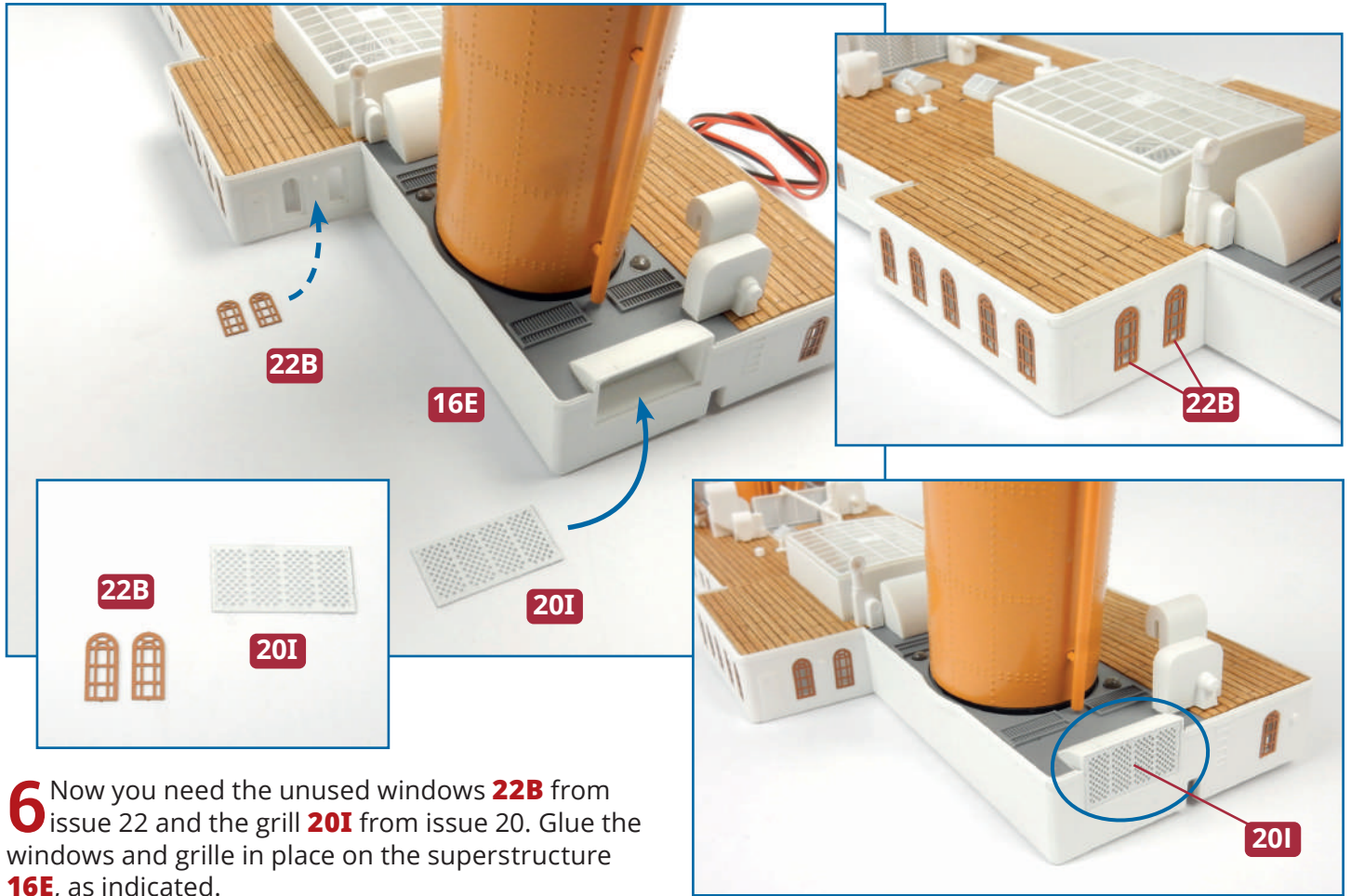

6 Now you need the unused windows **22B** from issue 22 and the grill **20I** from issue 20. Glue the windows and grille in place on the superstructure **16E**, as indicated.

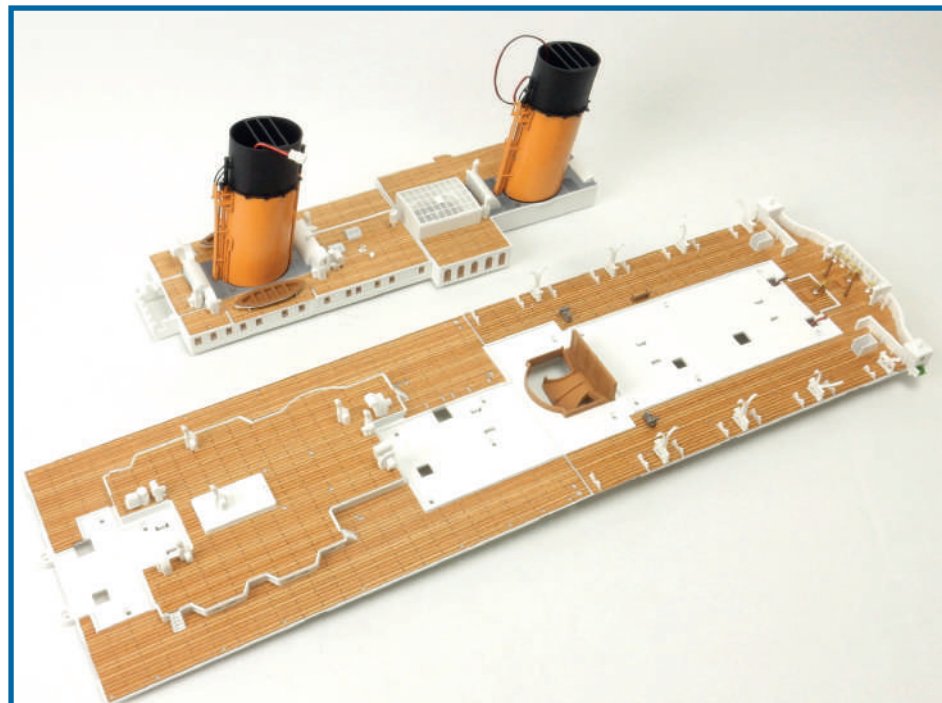

Completed work

Lighting and the famous first-class staircase have been fitted in place and details have been added to the superstructure.

The cable **48E** will be fitted at a later stage.



AFT SECTION OF THE BOAT DECK

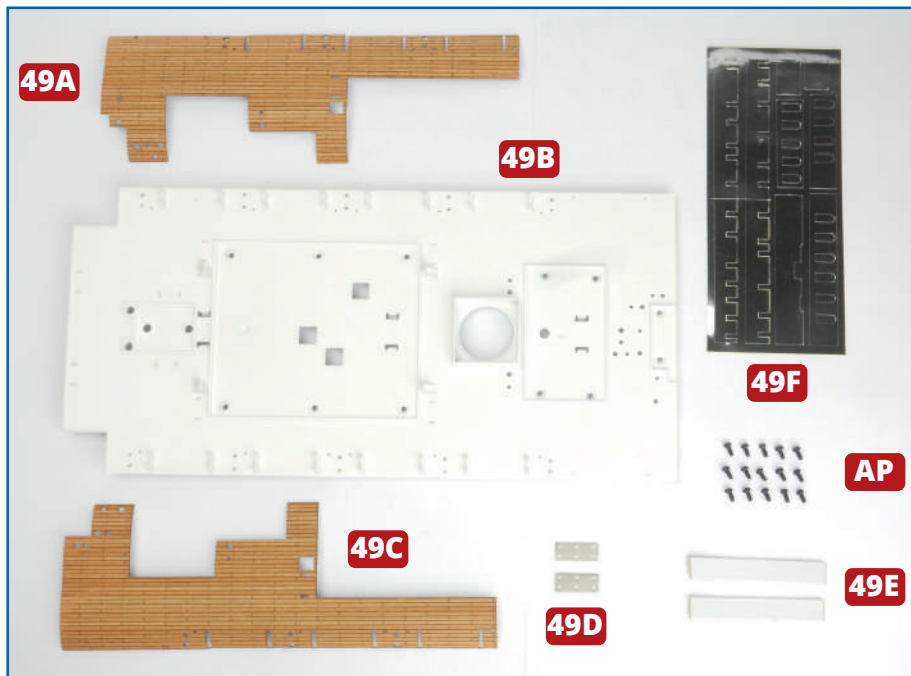

PARTS IN THIS ISSUE

- 49A Starboard decking
- 49B Boat deck (aft)
- 49C Port decking
- 49D Connector (x 2)
- 49E Self-adhesive strips (x 2)
- 49F Self-adhesive reflectors
- AP Fifteen 2.3 x 5mm PB screws (1 spare)

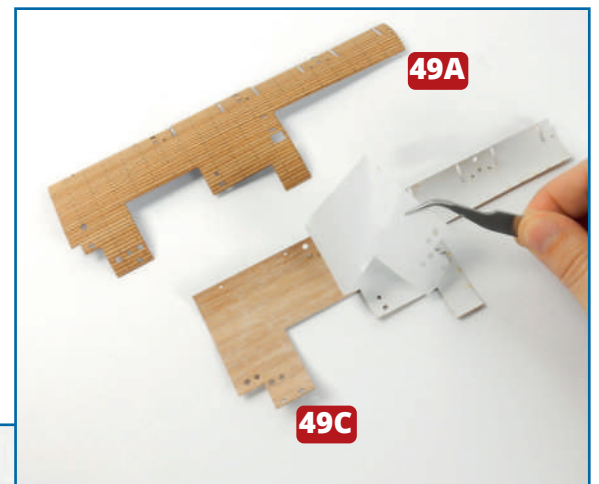
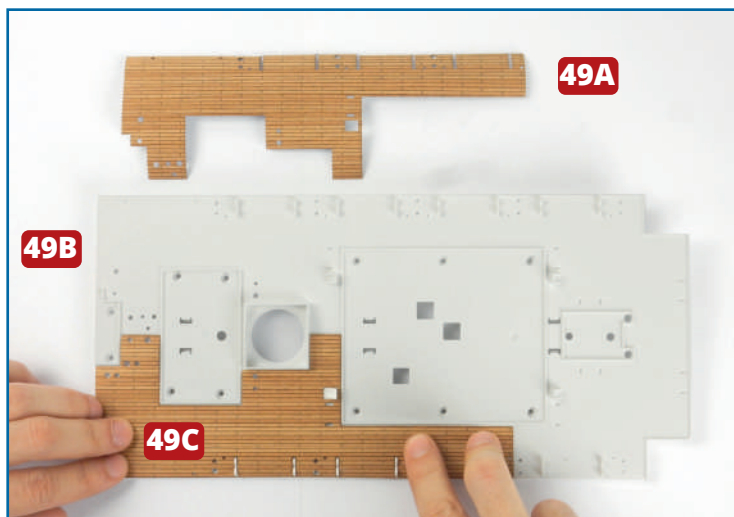

1 Take the aft section of the boat deck **49B** and the two decking sections, **49A** and **49C**. Check how each section fits (above), then, one at a time, remove the backing (above right) and fix them in place on the boat deck **49B**. Check that all the holes are aligned, and smooth the decking down with a soft cloth.

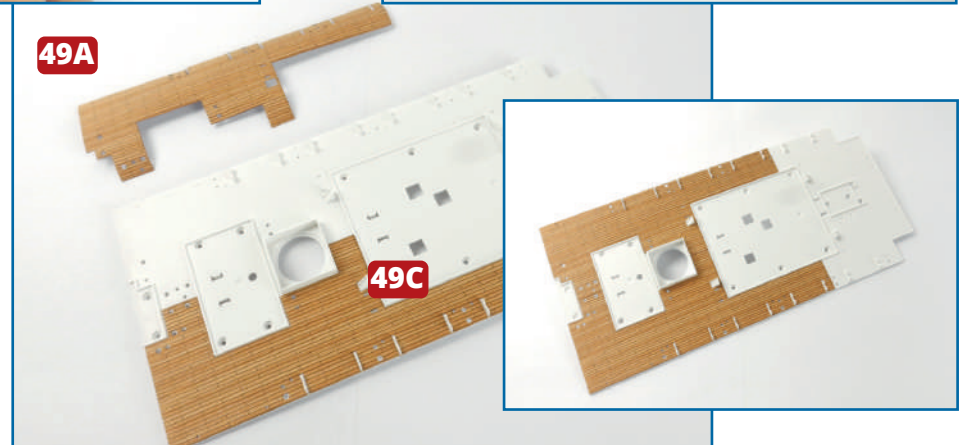

★ STEP-BY-STEP INSTRUCTIONS ★

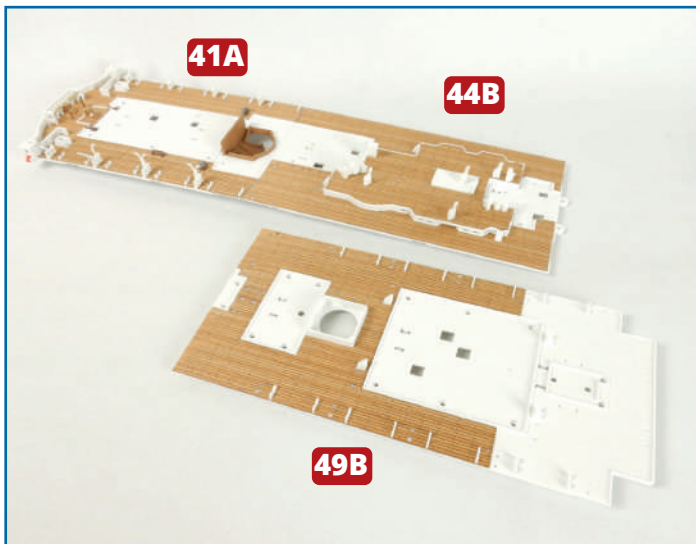

2 Take the boat deck assembly from issue 48. Taking care not to damage any of the parts fitted to the deck, turn it upside down and check how the deck sections **44B** and **49B** fit together. Use two **AP** screws to fix the deck sections in place (below) and then take the two connectors **49D** and glue them in place, as indicated (below left and bottom), to strengthen the joint.

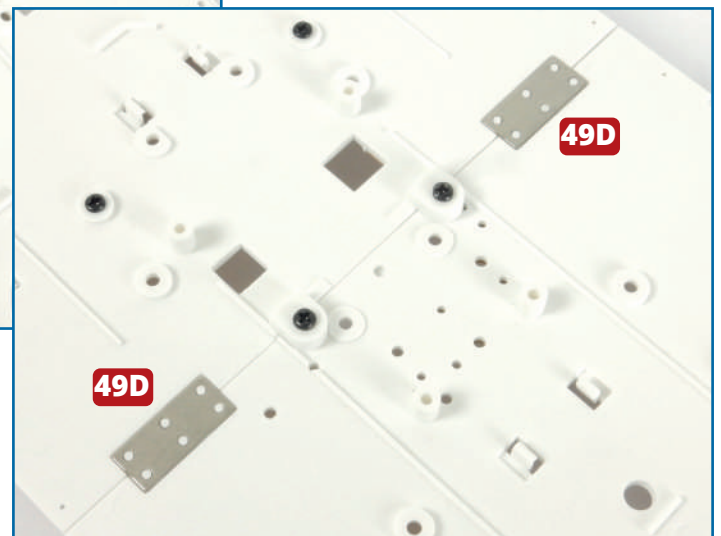
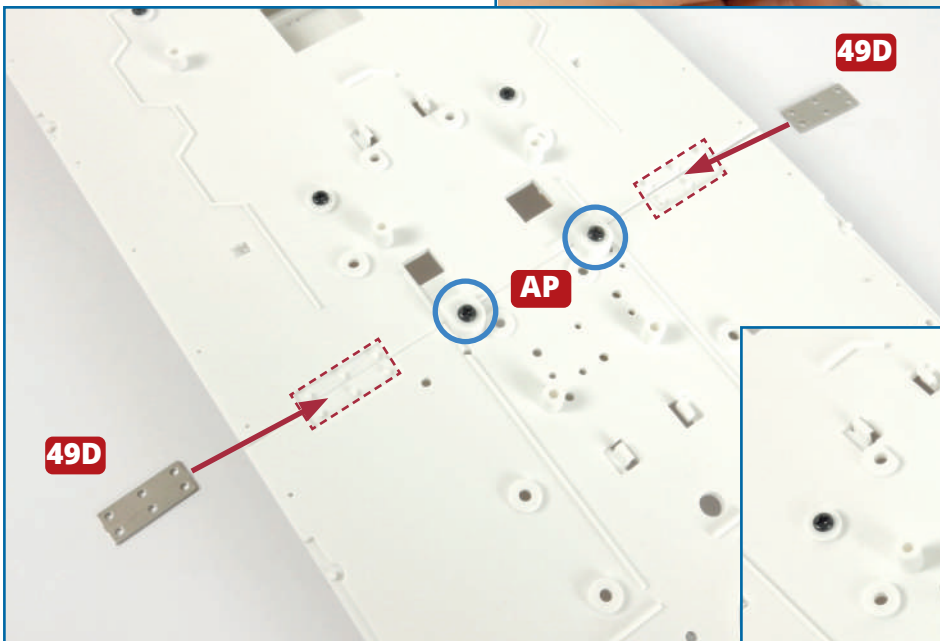
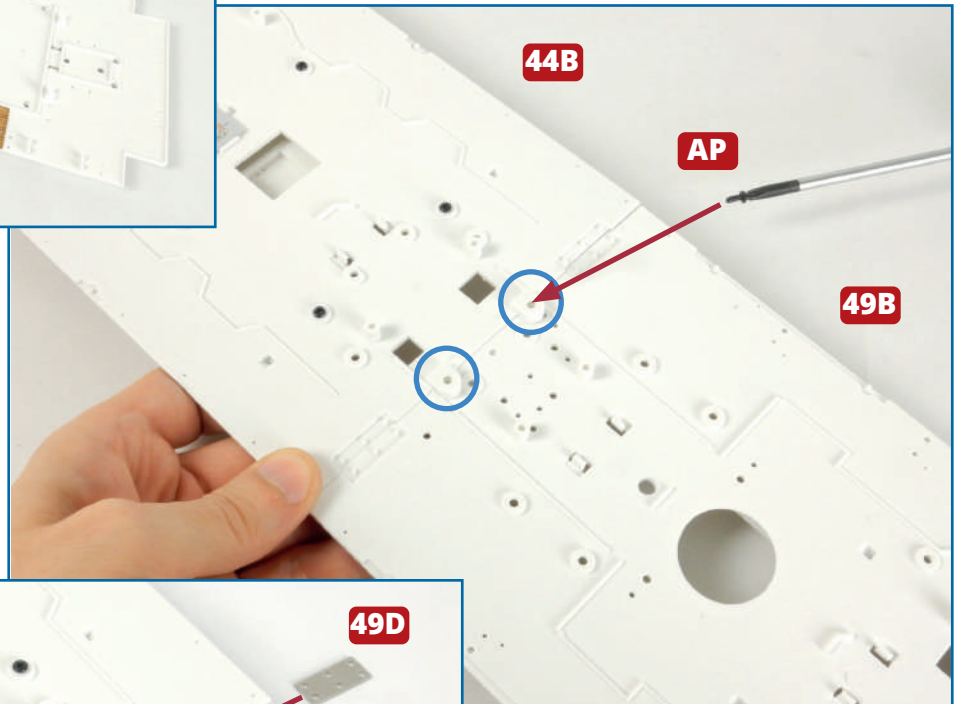



3 Take the bow superstructure and position it so that you can access the underside. One at a time, remove the backing from the adhesive strips **49E** and stick them on top of the LED strips **20B** and **22D**, as shown.

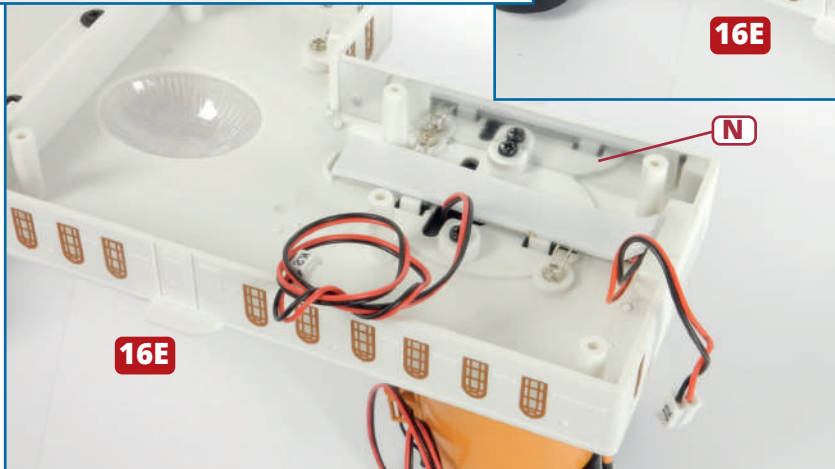
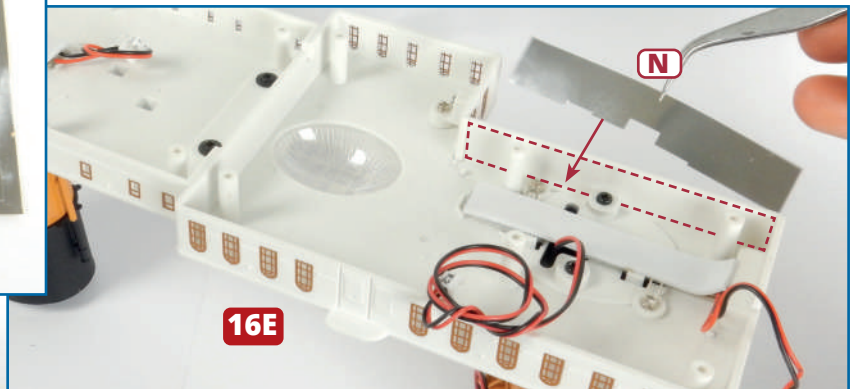
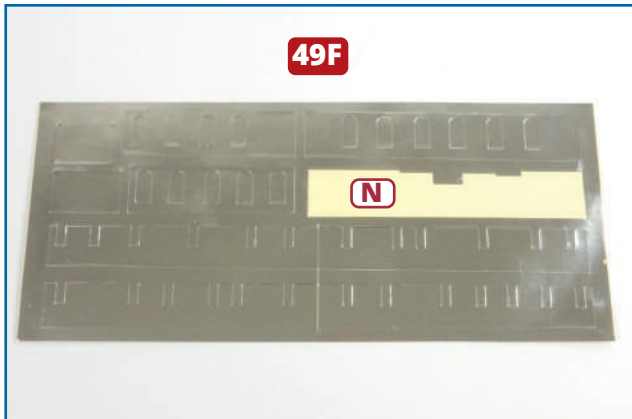
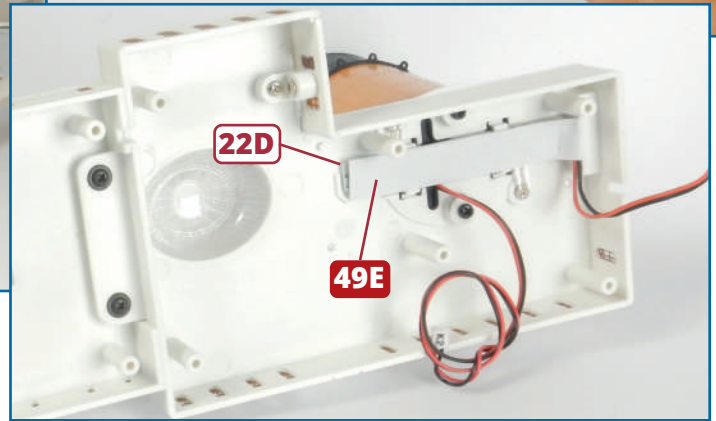
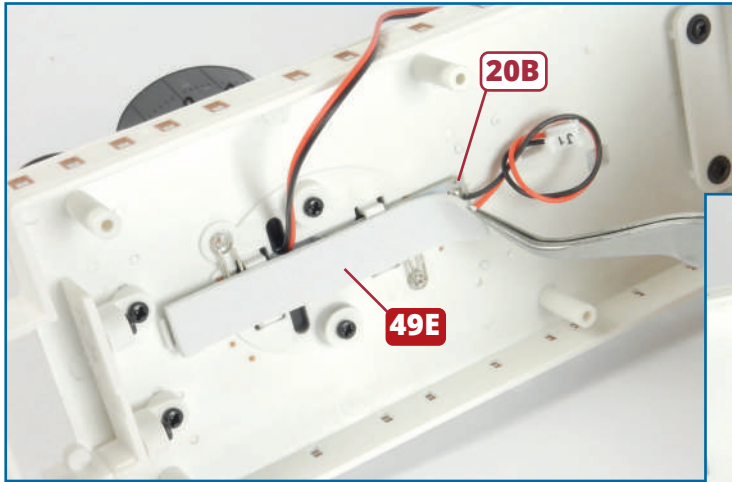
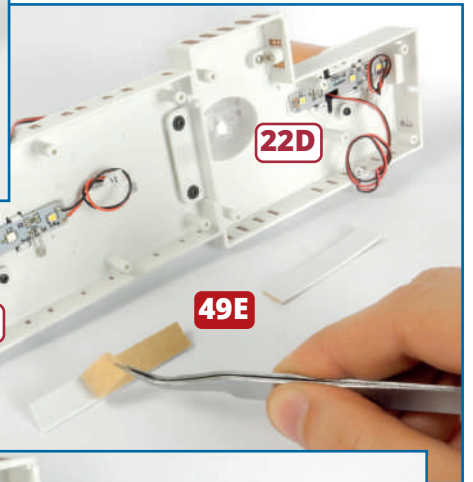
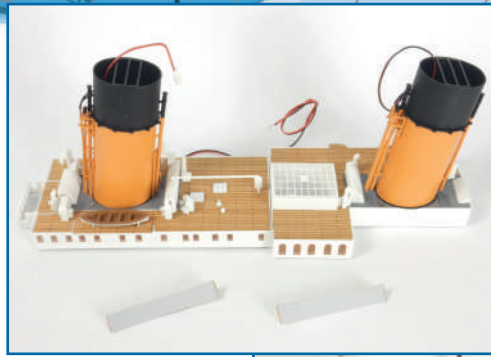

4 Identify strip **N** on the sheet of self-adhesive reflectors **49F** (above left). Identify the fixing point on the inside of the port wall of the superstructure **16E** (above). It runs behind the two columns. Fix it in place as shown (left).

★ STEP-BY-STEP INSTRUCTIONS ★

49F

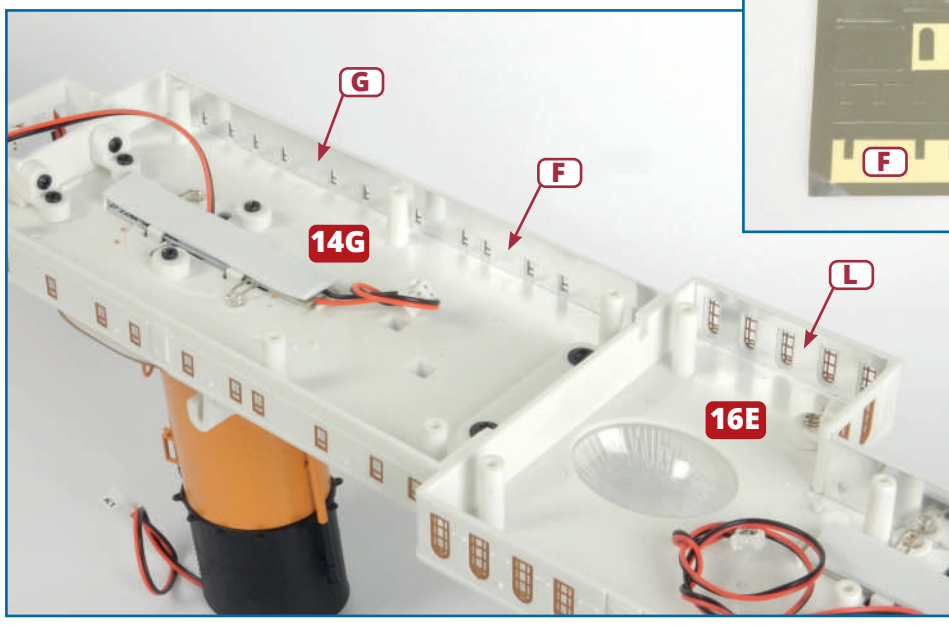
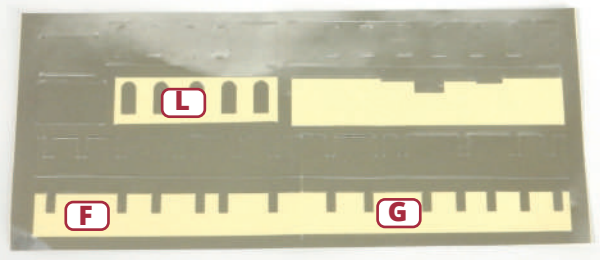

5 Similarly, identify and apply the strips **F**, **G** and **L** inside the port walls of the superstructure, as indicated in the photo on the left. Take care to align the reflective strips with the windows.

49F

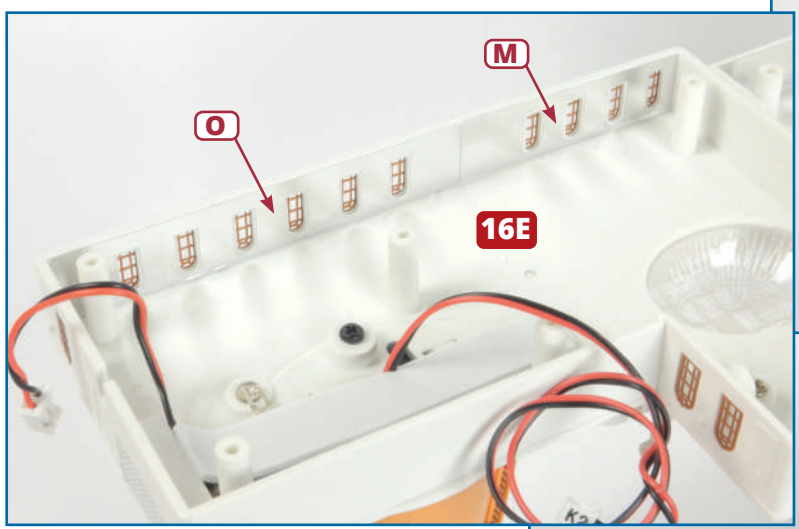
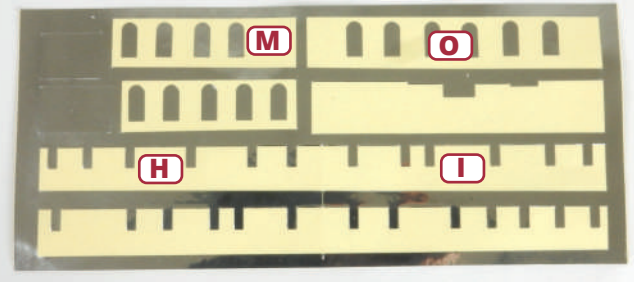

6 Strips **M** and **O** are fixed to the inside of the starboard wall of section **16E** of the superstructure. Strips **H** and **I** fit along the inside of the starboard wall of section **14G** of the superstructure.

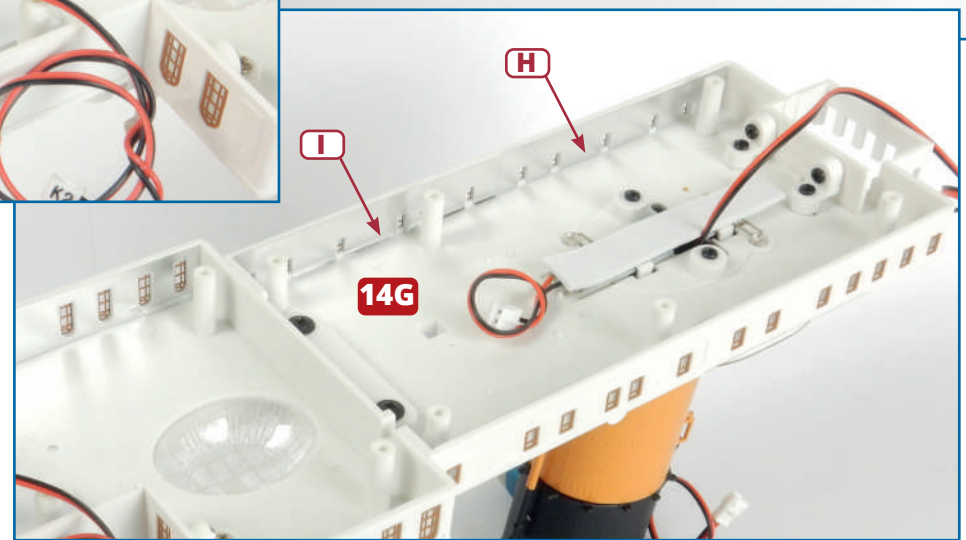

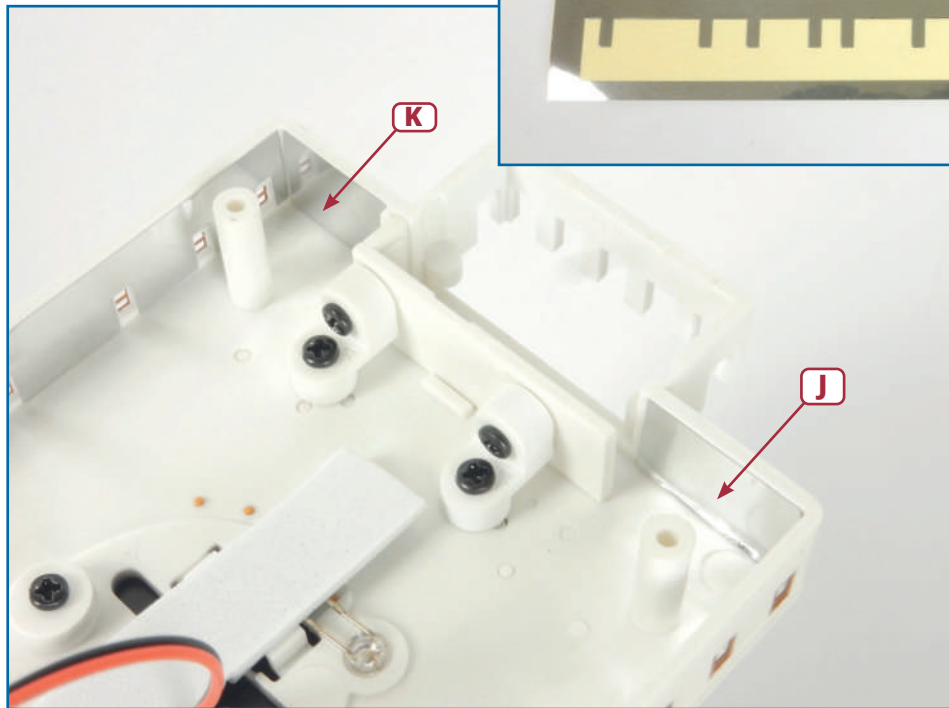
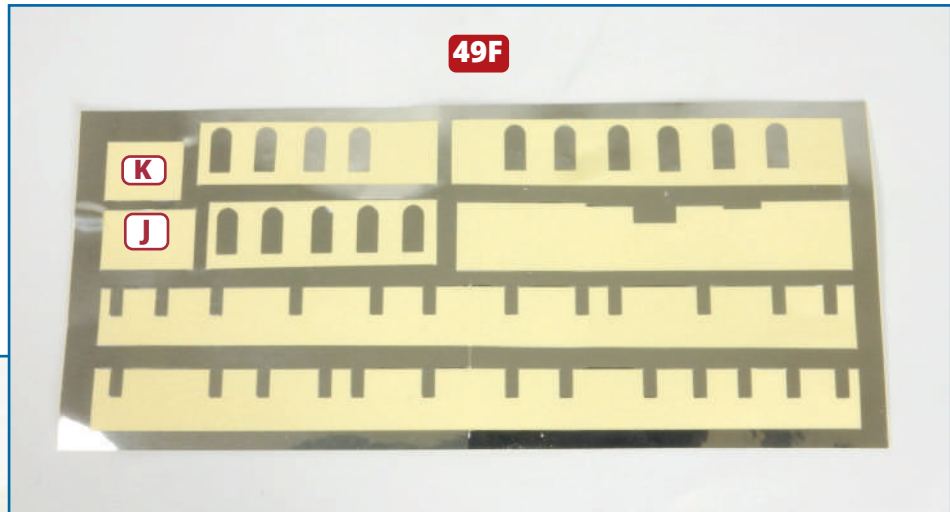

7 The last two short strips **K** and **J** are fitted inside the walls at the front of the superstructure on either side of the bridge.

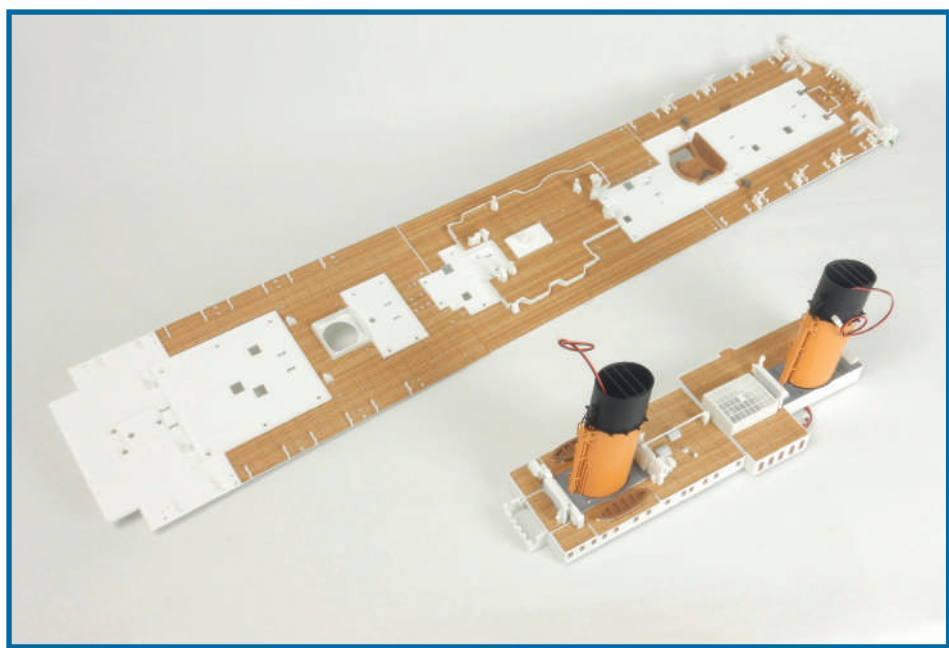

Completed work

The last section of the boat deck has been joined to the previous sections and reflective strips have been fitted inside the superstructure.

TWO LIFEBOATS AND A CUTTER



PARTS IN THIS ISSUE

- 50A** LED cable
- 50B** Bench (x 2)
- 50C** Dome
- 50D** LED Strip
- 50E** Davit arm
- 50F** Lifeboats
- 50G** Cutter
- 50H** Boat support
- 50I** Boat support
- 50J** Tarpaulin for lifeboat
- 50K** Tarpaulin (not used)
- 50L** Lifeboat block gear (x2)
- 50M** Davit base

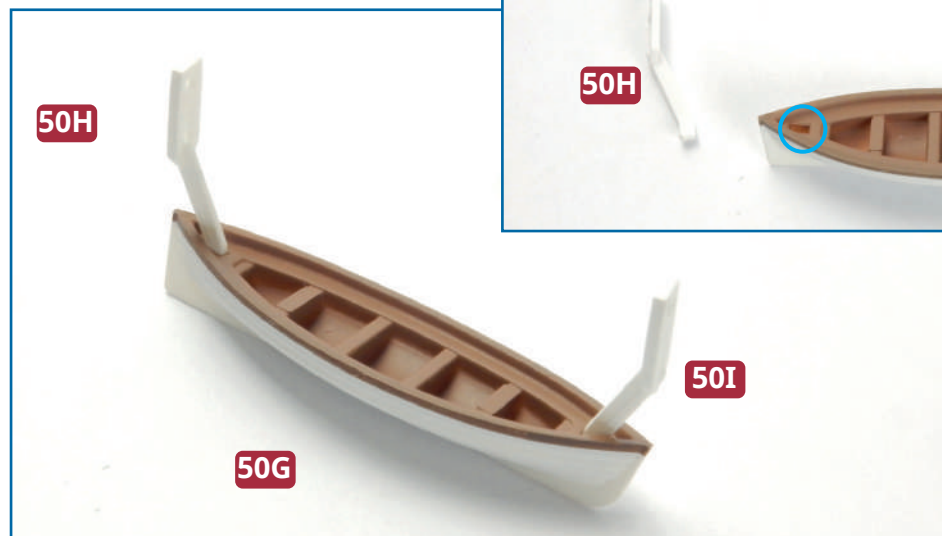
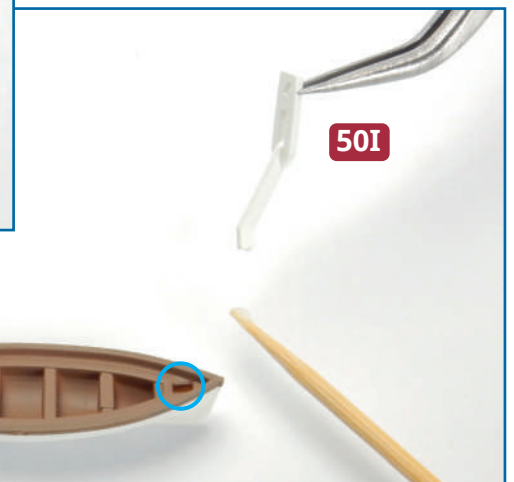

1 Take the cutter **50G**, the smallest of the three boats supplied with this issue, and the two supports **50H** and **50I**. Fit the supports into the holes at each end of the cutter as shown, but do not to glue the supports until the cutter is fitted to the model to ensure the best fit.

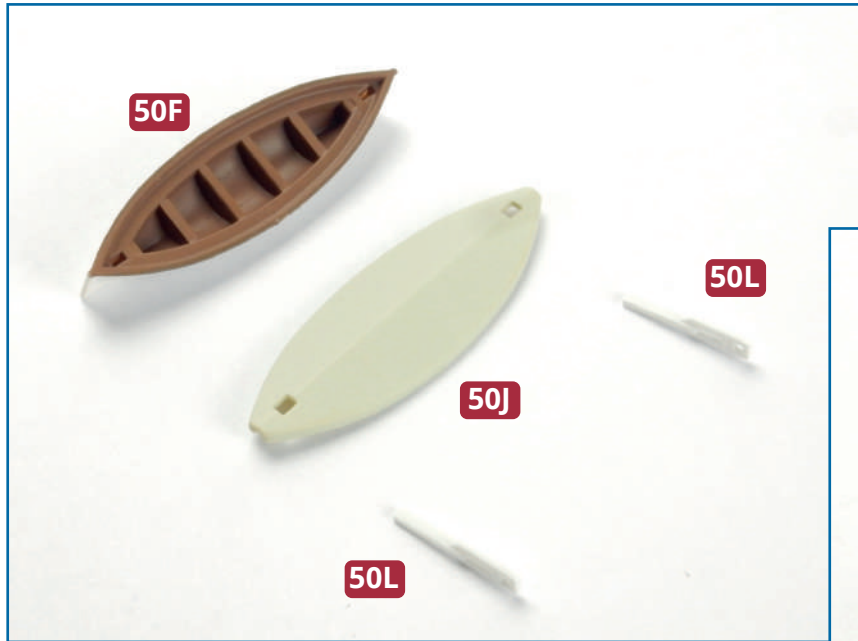

2 Take one of the lifeboats **50F** and the tarpaulin **50J**. Fit the tarpaulin onto the boat. Fit a block gear **50L** into the holes at each end of the tarpaulin **50J**. Do not use any glue at this stage.

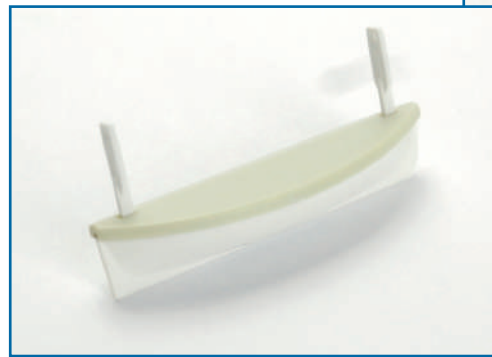
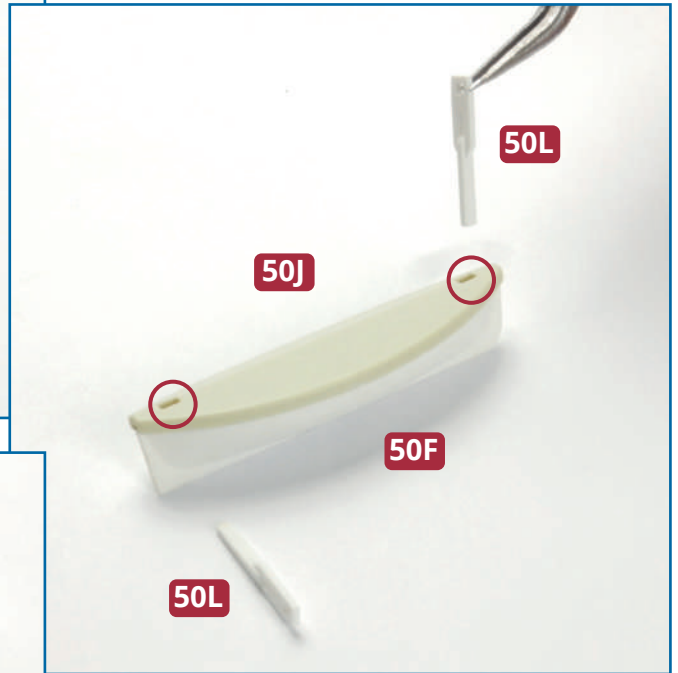

3 Take the boat deck assembly from the previous issue and position it carefully so that you can access the underside. Identify the position for the LED strip **50D**, across the join between **44B** and **49B** of the deck.

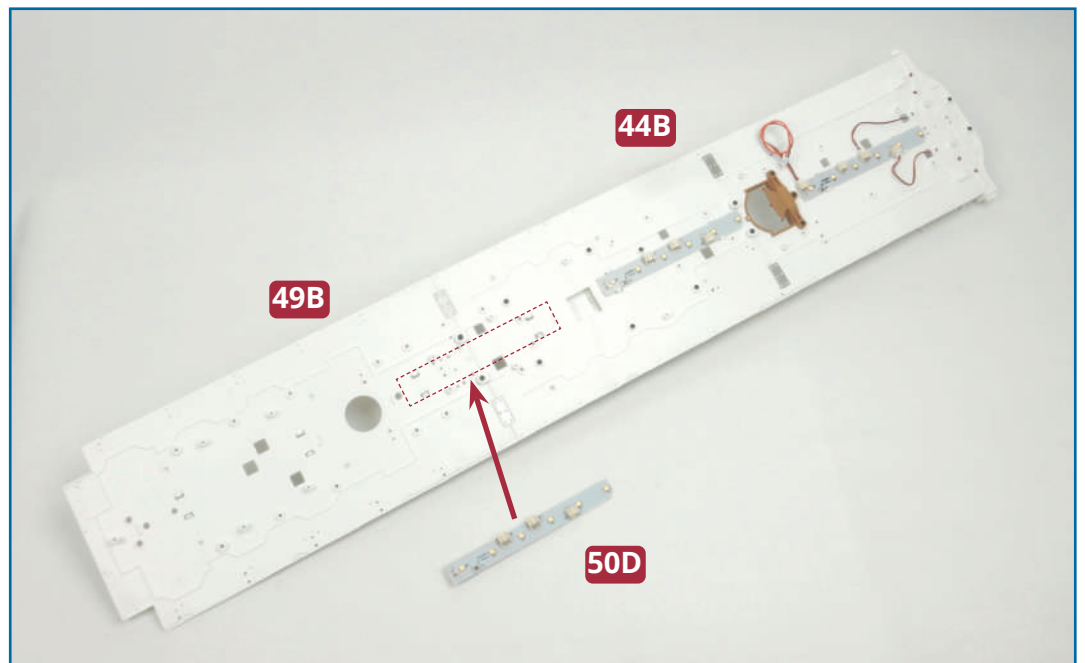

4 As with previous strips, fit one edge beneath the tabs and then, if necessary, use a flat screwdriver to lever up the tabs on the opposite side so that you can fit the strip beneath them.

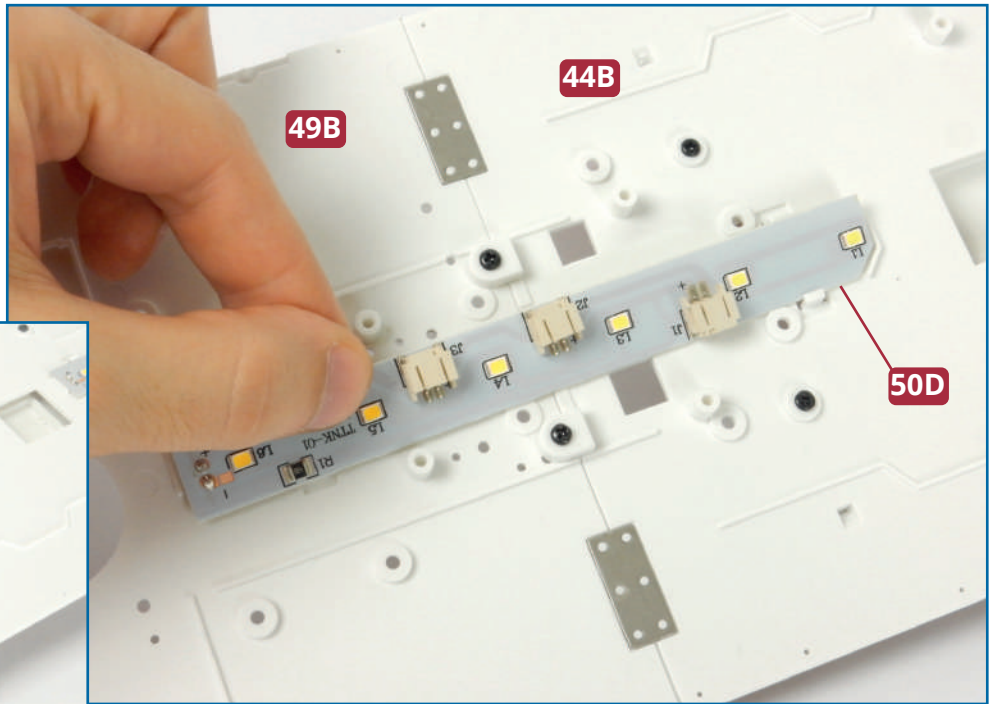

5 Take the davit arm **50E** and the davit base **50M** and check how they fit together: pegs on part **50E** fit into holes in the base **50M** (right). Glue in place. Identify the fixing point for the davit base on the boat deck, on the middle section **44B**, near the join (below). One peg (yellow arrow) is larger than the other, to ensure the davit faces in the right direction. Glue the pegs on the base of **50M** in place (below, right).

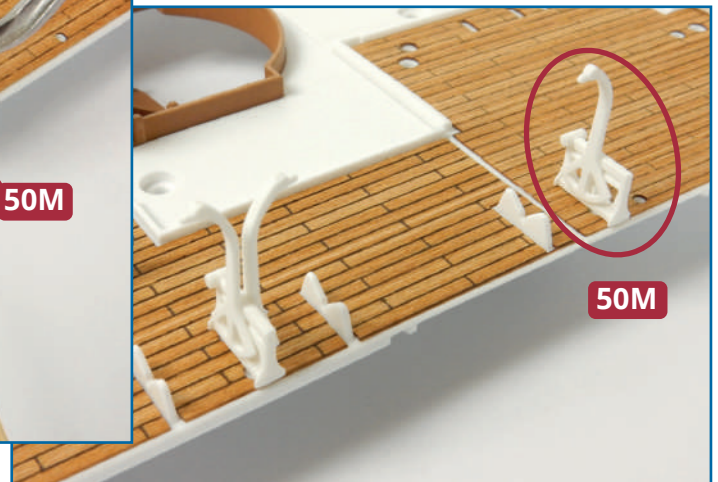
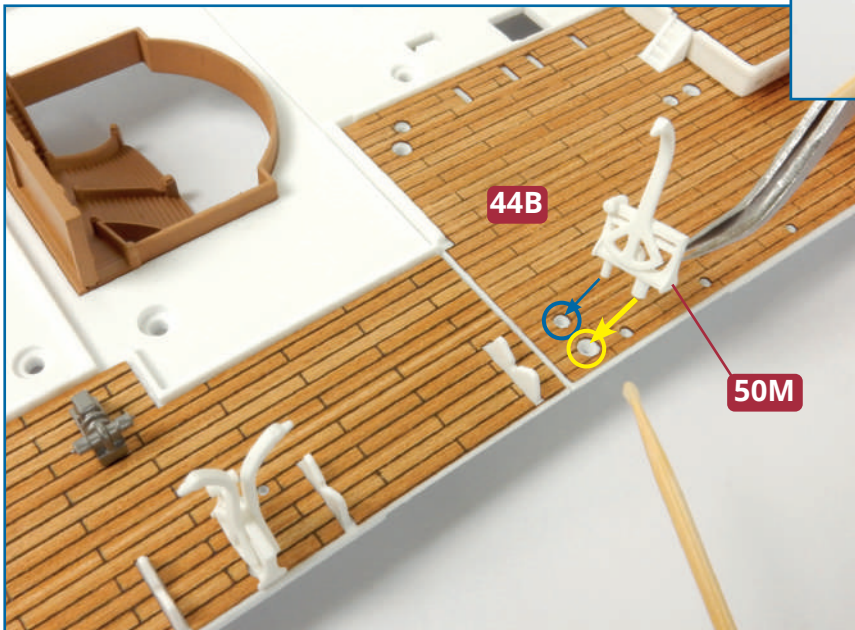
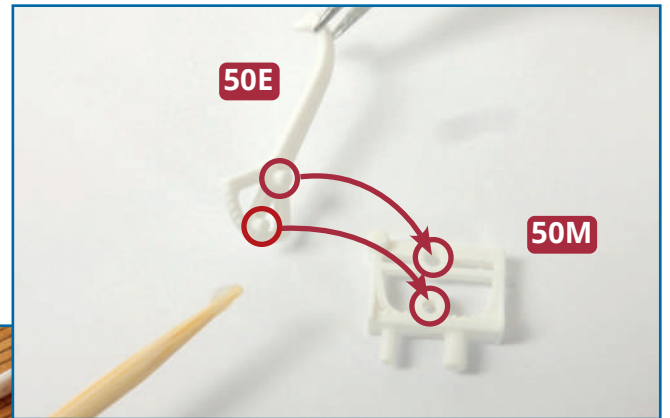

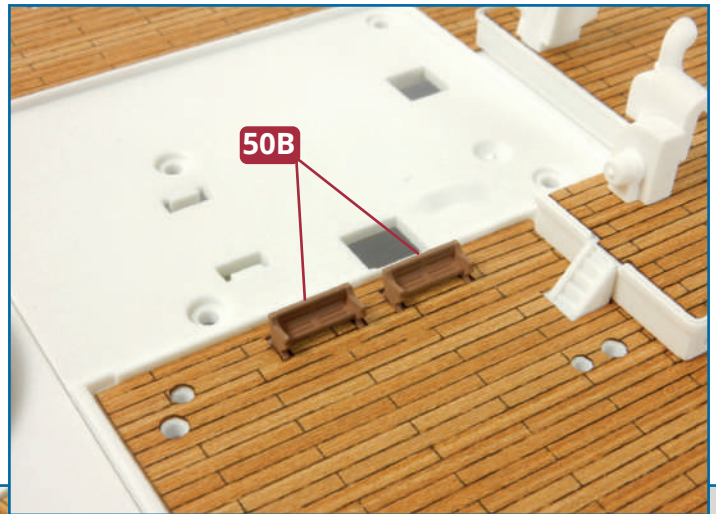
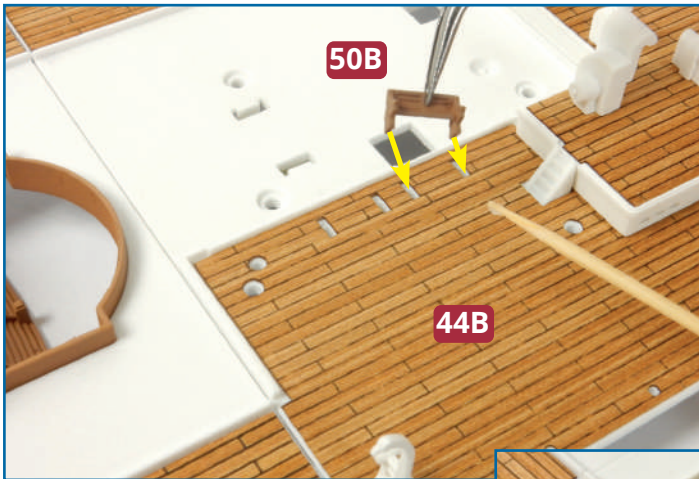

6 Take the two benches **50B** and identify the fixing point on the central section of the boat deck **44B**. Glue the tabs on the base of the benches in place, as shown. Position the dome **50C** inside the square surround on the aft section of the deck **49B**. Do not use glue for the dome.

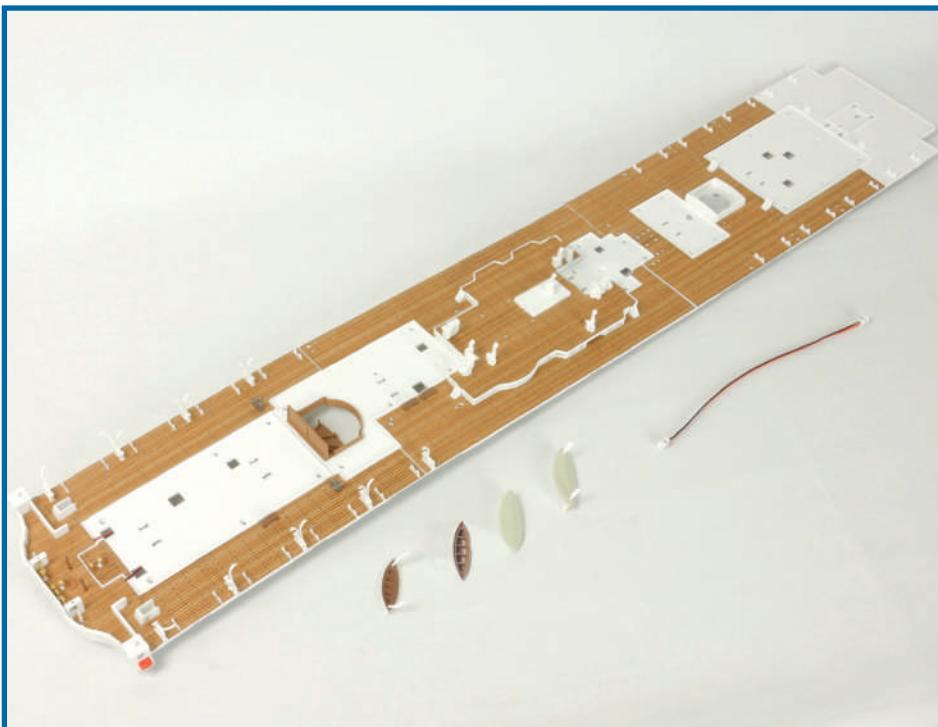
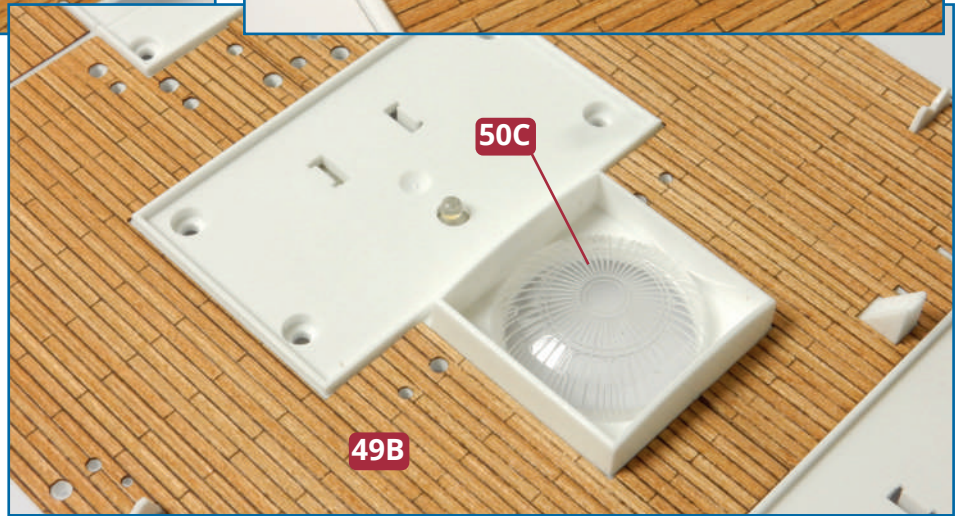

Completed work

Details have been added to the boat deck. Store the lifeboats, cutter and LED cable carefully until they are needed.